

# FM CONSTRUCTION

---

## C O M P A N Y

---



*Attention to Detail Sets Us Apart*

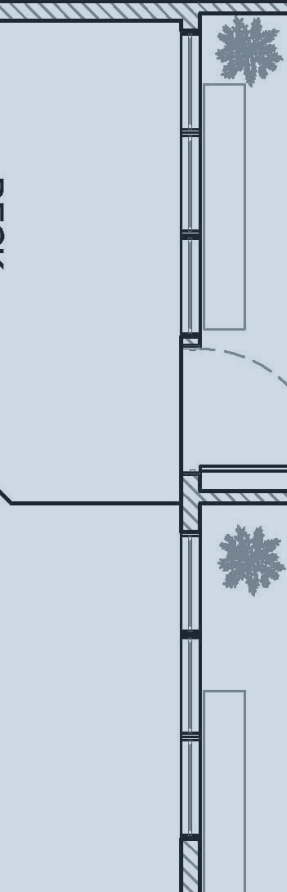
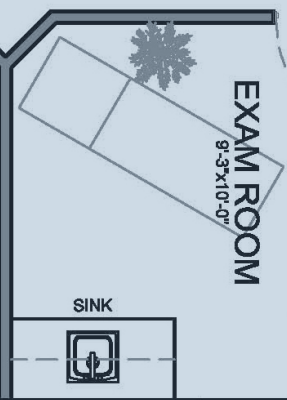
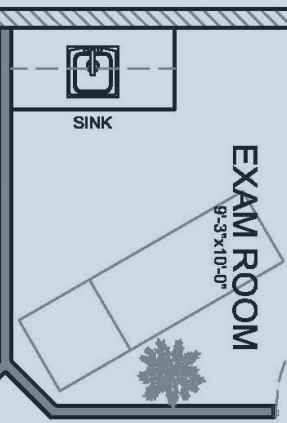

**F**M Construction Company of Elkhart wants to be more than just your builder -- we want to be your building partner. Whether the job is a remodeling or expansion project, construction of a brand new facility or something in between, we want to give you exactly what you want. In order to be your partner, we listen to your needs, make recommendations based on almost 30 years of experience and provide you with honest answers.

Understanding your goals, understanding your business and understanding you is the key to turning your project into the very best building experience. We want you to truly enjoy working with us and we want you to recommend our services to your friends and colleagues.

Since 1982 we have served as a builder of commercial and industrial properties all over the Midwest. Our focus is on design/build services, rehabilitation of old buildings, remodeling of existing buildings and new construction.

### **FM CONSTRUCTION:**

- Offers unique and valuable perspectives on the market
- Helps customers navigate alternatives
- Provides ongoing advice and consultation
- Helps clients avoid potential problems
- Educates our clients on new trends, issues and potential outcomes

## **OUR SERVICES**

### **DESIGN/BUILD**

FM Construction Company simplifies complex building projects. By uniting owner, architect and contractor to create a unique team for each project. Our Design/Build program uses the fast track construction method which compresses the time required for the completion of a construction project as it permits the simultaneous execution of many construction activities. And that means lower interim financing costs and reduced financing risks.

When the FM Construction Company team serves you, we bring together vast expertise, estimating know-how, cost control procedures, management systems, purchasing power and years of solid construction experience.

Project scheduling is utilized to arrive at a realistic time line. FM Construction uses the critical path method to track the logical progression of activities. Here milestones are identified and the interrelationship and independence of activities are considered.

During the planning phase, FM Construction establishes a scope of work and generates enough of the design to develop an accurate project cost. This total project cost is guaranteed by FM Construction to be the maximum cost to the owner. An in-depth proposal is presented to the client to document everything in FM Construction Company's project cost.

All risks of cost overrun are assumed by us. Guaranteeing costs permits financial plans to be formulated early and eliminates unpleasant surprises which occur after considerable engineering dollars have been spent.

## **Quality Workmanship. Competitive Pricing. Timely Response to Client Needs. Integrity. Responsibility.**

*These are the hallmarks of FM Construction Company. These are the standards business and industry have come to expect. These are the standards which our staff is firmly committed to.*

*Our collective capabilities enable us to handle every phase of your project from conception to completion.*

*We respond to the needs of our clients, both large and small, striving to create working environments that combine quality, operating efficiency, and esthetic appeal inside and out.*

*By doing so we build opportunities for our clients and associates.*

*We welcome the opportunity to serve you.*

**T**hrough our affiliated company, Tiedemann Realty Services, we can also perform the following services:

### **REPAIR**

- We repair roof leaks, flashing, building damage, overhead door damage, pass doors and hardware, concrete slabs and sidewalks

### **OTHER SERVICES**

- Site Selection and Site Design
- Land Use Consulting
- Pre-Engineered Steel Buildings
- Conventional Construction Projects
- Manufacturing, Office and Retail Renovations
- HVAC and mechanical system operations, repair and maintenance
- Electrical systems operation repair and maintenance
- General light maintenance
- Preventative maintenance of systems
- We can also assist with financial planning, tracking, reporting, billing consolidation and cost accounting for maintenance services

# FM CONSTRUCTION COMPANY'S PARTIAL LIST OF CLIENTS:

## PAST

1<sup>st</sup> National Bank  
Absolutely Fabulous  
Accra Pac  
Advantage Mortgage  
Airborne Express  
Allied Domecq  
American Red Cross  
B100 Radio  
Buffalo Wild Wings  
City of Elkhart  
Concord Mall  
Christiana Creek Country Club  
Crowe Chizek  
CTS Corp.  
Federated Media  
Flexco  
Himco  
H&R Block  
Lucchese's Italian Restaurant  
Manpower  
Marriott International  
Mrs. Fields Cookies  
Oaklawn

Penski Trucking  
Perkins Family Restaurant  
Roadway Packaging  
Seton Hall University  
Sturgis Hospital  
Truth Publishing Company  
US Business Systems  
YMCA  
W.W. Grainger  
Walgreens  
Wings Etc.  
WSJV-TV

## PRESENT

Atlas Chemical  
Accessa Coatings  
AutoZone  
Bimbo Bakeries  
Bodek & Rhodes  
Boling Vision Center  
Borger Group, LLC  
Chalet Party Shoppe  
Cheng USA  
Continental AG

Copper & Brass Sales Inc.  
Dayton Freight  
Dollar General  
Edison Centre Corp.  
Elkhart Clinic  
Elkhart FOP  
Elmer's Body Shop  
Griffen Plumbing & Heating  
Inova Federal Credit Union  
Kruggel Lawton CPA  
Lexington Business Centre  
Martin Marketing  
McCormick & Company  
McDonald's  
Miles Lab Restaurant  
New Generation Caterers  
Panzica  
Pletcher Farms  
Shipshewana Elementary  
SimplexGrinnell  
Southern Cross Investments, LLC  
Summit Planners  
Wells Cargo

# FM CONSTRUCTION C O M P A N Y

*a member of the*

**TIEDEMANN**  
GROUP

530 E. Lexington Avenue, Suite 175

Elkhart, IN 46516

**574-522-0390**

[www.fmconstruction.com](http://www.fmconstruction.com)



*Attention to Detail Sets Us Apart*

# THE FM CONSTRUCTION COMPANY TEAM:



## **A. CARL TIEDEMANN, SIOR, CPM, CRE | PRESIDENT & CEO**

Carl Tiedemann is the President and Chief Executive Officer of The Tiedemann Group and its subsidiary, FM Construction Company. Carl got his start in commercial real estate in 1978 as a founding partner in FM Property Management, Inc. (which became FM Stone Commercial in 2001). In 1982 he formed FM Construction. Carl has spent his entire career in the ownership, development and management of commercial and industrial real estate. His areas of expertise include property acquisition, construction, development and facility asset management of commercial and industrial real estate. Additional capabilities include property analysis, small business incubator development and management.

Carl has received the Certified Property Manager (CPM) Designation awarded by the Institute of Real Estate Management (IREM), the SIOR designation awarded by the Society of Industrial and Office Realtors and the CRE designation awarded by the Counselors of Real Estate. He is the past President of the Indiana SIOR Chapter and has served on SIOR national committees including Admissions, Budget and Financial & Global Affairs. As a Charter Member of the Northern Indiana Chapter of the Institute of Real Estate Management, Carl has served in various chapter offices, including its presidency. Carl is also a member of the Indiana Commercial Board of Realtors and National Association of Realtors.



## **TONY CAMPANELLO | PROJECT MANAGER & ESTIMATOR**

Tony Campanello started at FM Construction in September 2011. He joined the FM Construction team with more than 30 years experience in the construction industry in Elkhart County. As a Project Manager and Estimator, Tony is responsible for developing new client relationships in addition to working with past and future clients on developing a scope of work for their projects, and cost estimating and scheduling related to those projects. His specialties are renovations and retrofitting construction projects.

Tony's experience and dedication to providing outstanding customer service for his clients make him a valuable asset to the FM Construction team. In addition to his 30 years of experience, his education includes the completion of leadership and management classes at Goshen College. Tony is a board member on the Elkhart County Plan Commission and Board of Zoning Appeals.



## **JOHN BABCOCK | PROJECT MANAGER & ESTIMATOR**

John Babcock joined FM Construction in 2004 as a Project Manager and Estimator. His responsibilities include preparing bids for a variety of commercial construction projects and managing the project from beginning through completion. John has a wealth of experience in interior construction.

Prior to joining FM Construction, John worked as a project manager for an interior construction company in Mishawaka, Indiana. He was responsible for estimating and managing the construction and renovation of commercial construction projects. John has experience in the structural steel industry and has worked in construction management. John has a degree in management from Purdue University.

# THE FM CONSTRUCTION COMPANY TEAM:



## DOUG ZACHARY | SUPERINTENDENT OF OPERATIONS

Douglas Zachary joined FM Construction in 2007 as Superintendent of Operations. In addition to having 17 years experience as a construction superintendent, Doug's other qualifications include being a team member and instructor in the Army Special Forces, earning a degree in Business Management from the University of Maryland and being awarded the highly coveted 'Master Carpenter' designation from the Bavarian Technical School of Carpentry located in Wurzburg, Germany, in 1993.

Examples of past projects are the Hampton Inn in Warsaw, Indiana, American Axle in Three Rivers, Michigan, South Bend Orthopedic Center, in South Bend, Indiana and an 1100-unit apartment complex in Berlin, Germany.



## MINDY LEHMAN | CONTROLLER

Mindy Lehman joined the FM Stone Commercial team in June 2011 as the company's Accounting Manager and was promoted to Controller in January 2012. Mindy is responsible for oversight of all accounting practices including accounts receivable and accounts payable, performing bank reconciliations, making deposits and ledger postings, and overseeing human resources for all of the companies in the Tiedemann Group.

A resident of Elkhart, Mindy earned a Bachelor of Science degree in accounting from Indiana University in May 2008. She previously worked as a staff accountant for a public accounting practice in Goshen and is currently studying in preparation to sit for the exams to attain her CPA license.



## MELISSA HINER | MARKETING & CREATIVE DIRECTOR

Melissa Hiner joined FM Stone Commercial in May 2011 as the Marketing & Creative Director. She came to the team with over 11 years of experience working for two other commercial real estate companies in the Michiana market. Melissa's vast knowledge of the local commercial real estate market allows her to successfully plan campaigns and marketing strategies that put the FM Commercial team one step ahead of its competition.

Melissa is in charge of developing and implementing all marketing concepts and creative direction for FM Stone Commercial and its partner companies. She is responsible for all company websites, newsletters, press releases, advertisements, commercials, brochures and all other marketing pieces. Melissa has over 19 years experience as a writer, editor and graphic designer.



## KRISTY NUSH | COMMUNICATIONS COORDINATOR

Kristy Nush joined the FM Stone Commercial team in February 2011 with more than 12 years of office administration experience, including three years in commercial real estate/development. Her former employers include Ingersoll Rand, Lauth Property Group and CB Richard Ellis. She has a special interest in marketing, human resources and accounting. She is actively involved in Tri Kappa, as a member of the Mishawaka Beta Gamma Chapter, and is serving her second term as Assistant Recording Secretary.