

- 1 *Porte cochere*
- 2 *Atrium*
- 3 *Meeting room*
- 4 *Copy room*
- 5 *Future treatment facility area*

Located outside of Philadelphia in Western Delaware County, the Crozer Medical Plaza serves the community as an outpatient comprehensive ambulatory care facility. The new +/-66,000 s.f. medical office building is three-stories with brick and glass as its primary exterior building materials. Large curtain wall panels spanning two floors were used to provide large day lighting areas. The visitors' enter the building under the glass porte cochère and travel through the large double doors of the vestibule to the two-story atrium. Wood paneling was selected to provide a warm feeling in the atrium. An information desk was added to increase the feeling of being welcomed and to provide information for the arriving patients. Flamed granite was selected as the floor material for its endurance, cleanability and non-slip characteristics. Its colors are in contrast to the wood paneling and recall the exterior colors of the building. A square pattern reflects the volume of the atrium space.

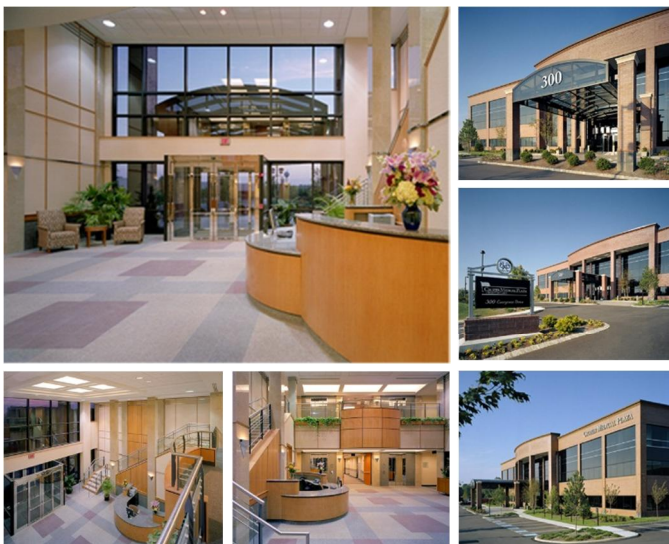

Project: Crozer Medical Plaza at Brinton Lake
Owner: Crozer Keystone
Location: Glen Mills, PA
Completed SF: 66,000
Use: B (Business)
Construction Cost: \$5.8 million
Completion Date: 2005