



RIBAG

LIGHT
IN SHAPE.

Collection 15/16

LUNIK

Design Daniel Kübler



Brilliance, combined with style in all its diversity.

The timelessly elegant LUNIK LED downlight is impressive for its simplicity and powerful versatility. LUNIK anti-glare elements in various colours lend a special note to any room and blend perfectly into a very varied range of circumstances. With a choice of three reflectors (25°, 35° or 45°), this high-class LED downlight guarantees superlative light quality and precise illumination for brilliant lighting accents.







Lichtplanung: Licht & Form Heiko Heimrich KG, Bensheim
Fotos: Marcus Zumbansen/Architekt Daniel Ringwald



Lichtplanung: Licht & Form Heiko Heimrich KG, Bensheim
Fotos: Marcus Zumbansen/Architekt Daniel Ringwald







LUNIK

Recessed spotlights with trim ring



- Mounting: Suitable for installing in cavity ceilings and concrete ceilings with Kaiser concrete moulded housing Halox-0 No. 1290
- Lamp housing: Cast aluminium, metallic grey RAL 9006, white semi-mat RAL 9003, black semi-mat 9005 or pearl beige semi-mat RAL 1035, with passive cooling
- Optics: Reflector unit with bayonet fitting 25°, 35° or 45° (order separately)
- Lamps: LED CRI 95, 2700 K, 3000 K or 4000 K, integrated
- Service life: 50,000 hrs with 70% luminous flux
- Control gear: PS 230 V/50 Hz, constant current 350 mA (order separately)
- Lamp protection class: III
- Lamp protection level: IP 54
- Energy efficiency class A to A++, includes built-in LED lamps, unexchangeable lamps

LED MINERGIE®

Metallic grey

Item No.	Watt	Lumen	Kelvin
4300.005.27.8	12	1300	2700
4300.005.30.8	12	1350	3000
4300.005.40.8	12	1400	4000

White semi-mat

Item No.	Watt	Lumen	Kelvin
4300.005.27.3	12	1300	2700
4300.005.30.3	12	1350	3000
4300.005.40.3	12	1400	4000

Black semi-mat

Item No.	Watt	Lumen	Kelvin
4300.005.27.2	12	1300	2700
4300.005.30.2	12	1350	3000
4300.005.40.2	12	1400	4000

Pearl beige semi-mat

Item No.	Watt	Lumen	Kelvin
4300.005.27.9	13	1300	2700
4300.005.30.9	13	1350	3000
4300.005.40.9	13	1400	4000

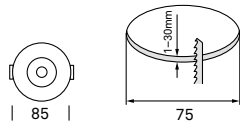
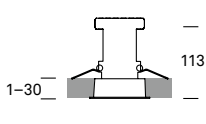

Recessed spotlight for rimless installation



- Mounting: With plastering edge for rimless installations in plaster ceilings (flush plaster ring to be ordered separately)
- Lamp housing: Cast aluminium, with passive cooling
- Optics: Reflector unit with bayonet fitting 25°, 35° or 45° (order separately)
- Lamps: LED CRI 95, 2700 K, 3000 K or 4000 K, integrated
- Service life: 50,000 hrs with 70% luminous flux
- Control gear: PS 230 V/50 Hz, constant current 350 mA (order separately)
- Lamp protection class: III
- Lamp protection level: IP 54
- Energy efficiency class A to A++, includes built-in LED lamps, unexchangeable lamps

LED MINERGIE®

White semi-mat

Item No.	Watt	Lumen	Kelvin
4300.010.27.3	12	1300	2700
4300.010.30.3	12	1350	3000
4300.010.40.3	12	1400	4000

Flush plaster ring to LED recessed spotlights

- for rimless flush-mountend in plaster ceiling, white semi-mat RAL 2003

Item No.
4300.010.00.3

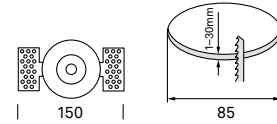
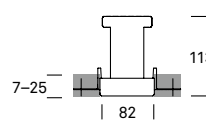

PLANNING NOTES

Not suitable for installation in heat-insulating material

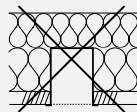

Installation in concrete ceilings

When installing LUNIK LED spotlights with trim ring in concrete we recommend using a Kaiser or Agro concrete moulded housing Halox-0 No. 1290 with the appropriate accessories from an electrical retailer.

LUNIK

Downlight reflector



- Simple assembly without tools
- Suitable for colour filters
- Inclusive diffuser transparent

Metallic grey

Item No.	Δ
4300.000.25.8	25°
4300.000.35.8	35°
4300.000.45.8	45°

White semi-mat

Item No.	Δ
4300.000.25.3	25°
4300.000.35.3	35°
4300.000.45.3	45°

Black semi-mat

Item No.	Δ
4300.000.25.2	25°
4300.000.35.2	35°
4300.000.45.2	45°

Pearl beige semi-mat

Item No.	Δ
4300.000.25.9	25°
4300.000.35.9	35°
4300.000.45.9	45°



- Simple assembly without tools
- Suitable for colour filters
- Inclusive diffuser transparent

Shiny chrome

Item No.	Δ
4300.000.25.1	25°
4300.000.35.1	35°
4300.000.45.1	45°

Shiny gold

Item No.	Δ
4300.000.25.6	25°
4300.000.35.6	35°
4300.000.45.6	45°

LUNIK

Accessories for LUNIK recessed spotlights

Diffuser/Colour filters for reflector unit



Item No.	Colour
4065.000.00.4	Red
4065.000.00.5	Blue
4065.000.00.7	Green

Control gear

- Control gear 230V/50-60 Hz, 350/700 mA
- With short-circuit and overload protection

Item No.	Watt	Dimmable	Dim. in mm
915.019.350	19	No	120/52/22
915.040.700	34	No	210/35/25
915.035.350 DIG	15	DALI ¹	103/67/21
915.035.700 DIG	32	DALI ¹	103/67/21

Legend

¹ Control with DALI-light regulator

PLANNING NOTES

Number of lamps per operating device

Item No.	No. lamps
915.019.350	1
915.040.700	2
915.035.350 DIG	1
915.035.700 DIG	2

Wiring diagram with external LED converter

Several lights without an distributor terminal

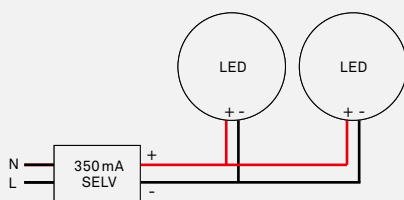

Never connect lights in serial

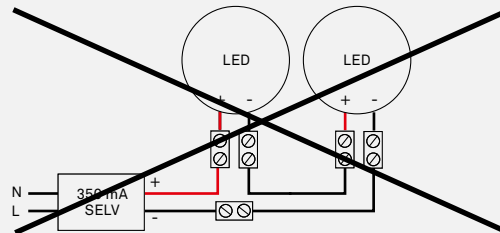

Beam spread

25°

Distance (m) Illuminance (lx)
2700/3000/4000K

1.0	0.46	3930/4080/4240
2.0	0.92	980/1020/1060
3.0	1.38	430/460/470
4.0	1.83	240/260/270
5.0	2.29	160/170/180

Cone diameter (m)

35°

Distance (m) Illuminance (lx)
2700/3000/4000K

1.0	0.63	2630/2730/2830
2.0	1.26	660/690/710
3.0	1.90	300/310/320
4.0	2.53	160/170/180
5.0	3.16	110/110/110

Cone diameter (m)

45°

Distance (m) Illuminance (lx)
2700/3000/4000K

1.0	0.79	1720/1790/1860
2.0	1.58	430/450/460
3.0	2.36	190/200/210
4.0	3.15	100/110/110
5.0	3.94	70/70/80

Cone diameter (m)

RIBAG

ribag.com

Art. 961.019.15