



SECUR SP-4007A
8-in-1 Auto Tool and Power Bank

USER'S MANUAL

Your new SECUR SP-4007A is a multi-featured auto emergency tool with power bank. Please read these instructions fully before using and keep them for future reference.

PRODUCT DESCRIPTION:

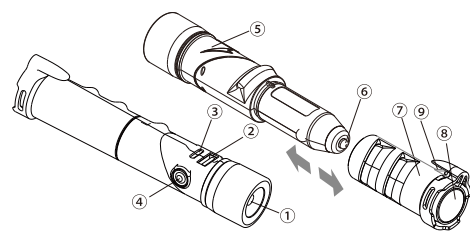

- ① LED Flashlight – LO, HI, Red
- ② USB output & input port
- ③ Battery level indicator/Charging indicator light (Blue)
- ④ Capacity Check / Power ON-OFF
- ⑤ Rotatable Flashlight (top section)
- ⑥ Car charger plug (12 VDC input)
- ⑦ Cylindrical cover with magnetic base (bottom)
- ⑧ Magnet
- ⑨ Seat belt cutter

PRODUCT SPECIFICATIONS:

1. Size: 5.53" x 1.12" diameter (3.6 ounces)
2. Built-in lithium ion battery: 1400mAh
3. DC output (Car charger) : 5V/2A
4. DC output (Power bank) : 5V/1.5A
5. DC input: 12V~24V/10A
6. LED brightness: 150 Lumens
7. Charging Time by car 12VDV power outlet: 3-4 hours
8. Device should be charged for at least 2 hours before first use
9. Materials: ABS & Aluminum

OPERATING INSTRUCTIONS:

• CHARGING THE BUILT-IN BATTERY IN YOUR CAR'S POWER OUTLET

Step 1. Hold the SECUR Auto Tool device and pull off the bottom cover (the part with the magnet and seat belt cutter) to expose the 12VDC power socket plug. Insert fully into your car's power outlet. See below picture:

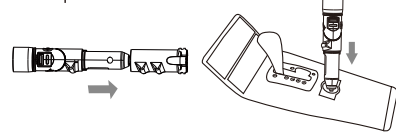

Step 2. If needed, you can rotate the top half of the device (the part with the LED light) so that it fits better in the space your car allows. See picture:

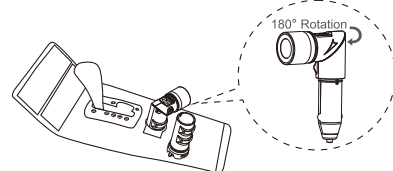

Step 3. If the device is fully inserted and connected, the Energy Indicator will flash blue. When fully charged the indicator will stop flashing and all blue lights in the line of the indicator will remain lit.

• CHARGING THE BUILT-IN BATTERY USING THE SUPPLIED USB CABLE

If preferred you can charge the SECUR SP-4007A using the supplied USB cable, by connecting it to your laptop or suitable household USB wall charger (see picture).

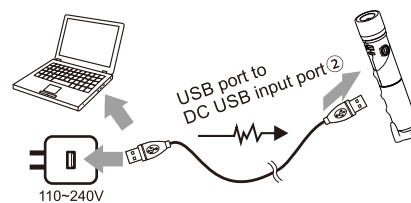

• CHARGING YOUR IPAD OR OTHER DEVICE FROM THE SECUR SP-4007A WHILE IT IS PLUGGED IN TO THE CAR POWER OUTLET

Step 1. Insert Secur Auto Tool into your car's 12VDC Power Outlet as described above.

Step 2. Connect your device and the Secur Auto Tool using your own cable as needed. Maximum output is 2 amp.

Step 3. Once charging begins, your device will indicate its charging status. (See picture)

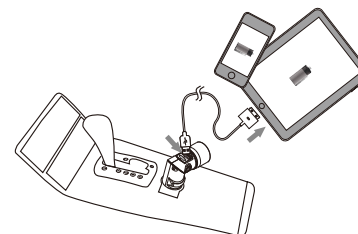

• CHARGING YOUR MOBILE PHONE DIRECTLY FROM THE SECUR SP-4007A's INTERNAL BATTERY

Step 1. Fully charge your SECUR Auto Tool as above. Connect your device and the Secur Auto Tool using your own cable as needed.

Step 2. Press the ON/OFF button once, and verify the blue LED indicator is lit. (If not enough charge in the SECUR internal battery, after 5 seconds the device will shut down and the blue LED will turn off.)

Step 3. Once charging begins, your device will indicate its charging status. (see picture)

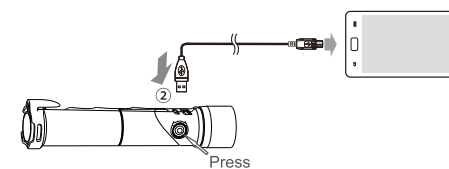

• USING THE FLASHLIGHT AND EMERGENCY LIGHT MODE

Step 1. PRESS AND HOLD the ON/OFF switch FOR ABOUT 2 SECONDS to turn on LO flashlight. Release when lit.

Step 2. Press again (do not hold) to switch to HI flashlight.

Step 3. Press again (do not hold) to switch to RED flashing light.

Step 4. PRESS AND HOLD the ON/OFF switch FOR ABOUT 2 SECONDS to turn OFF.

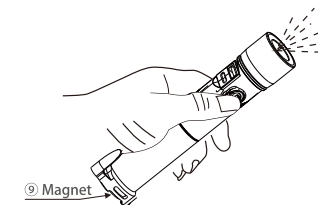

• USING THE WINDOW-BREAKER SAFETY HAMMER

In an emergency you can use the safety hammer to break a side or rear window and escape from the vehicle. The hammer is inside the tip of the 12VDC power plug point. To use, hold the SECUR device in one hand and hit hard into the car window, preferably near a corner of the window, and the glass will be broken. (see picture)

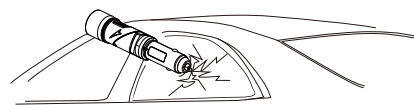

• USING THE SEAT BELT CUTTER

In an emergency you can use the seat belt cutter to cut the seat belt and exit the vehicle. The cutter is located in the magnet end of the SECUR SP-4007A. With the device assembled, slide the belt into the cutter area and pull back and forth as needed to cut through the belt. (see picture)

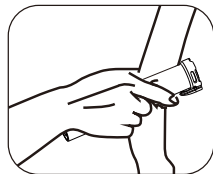

• USING THE MAGNET

The magnet is located in the bottom of the device. With the device assembled, you can place the SECUR Auto Tool onto any flat steel surface such as your car's roof or hood or door, and rotate the top flashlight section as needed to aim LO or HI light, or RED emergency flashing light in the desired direction. (see picture)

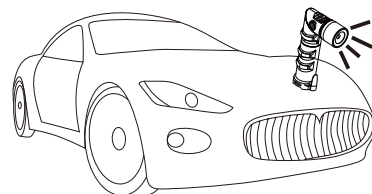

• CHECKING BATTERY CAPACITY CHARGED STATUS

To check the internal battery's status: while the flashlight is OFF, press and release the ON/OFF button.

-If 4 indicators are lighting blue, the battery is fully charged

-If 3 indicators are lighting blue, the battery is 75% charged

-If 2 indicators are lighting blue, the battery is 50% charged

-If 1 indicator is lighting blue, the battery is 25% charged

-If no indicators, the battery needs charging.

(see picture)



-Do not attempt to break windshield which is typically hardened laminated glass.

-Keep this device in a handy accessible place in your car so you don't need to search for it in an emergency.

-This product does feature intelligent overcharge protection feature, short circuit protection, and discharge protection to ensure long battery life. The battery is a Lithium Ion battery.

-If this device does not charge your phone or device:

- Check whether your device is compatible with this device.
- Make sure this device is charged by checking the BATTERY CAPACITY STATUS lights.
- Make sure you have turned this device ON

-If this device has not been used in 6 months or more, the internal battery may be fully discharged.

-This device is not a toy and is not intended for use by very young children.

SECUR PRODUCTS

A division of Maverick Industries Inc.

94 Mayfield Avenue, Edison NJ 08837 USA

www.securproducts.com

IM SP-4007A rev 07-18

WARNINGS AND OTHER INFORMATION

-Keep the product's surface clean and free of scratches or damage.

-The charger is NOT waterproof, do not allow it to get wet. If accidentally wet, dry thoroughly with cloth and hair dryer and do not use until fully dried out.

-Do not leave on dashboard in direct sunlight where temperatures can rise to 68C (150F) or more as this will damage the internal battery.

Size: 280x110mm

Double sides printing