

STORAGE

scale^{1:1}

Mobile Pedestal

- **Cushion Top Mobile Pedestal Files** - 15"w x 18"d x 23.75"ht (plus cushion)
- Includes 4 black plastic casters - 2 locking, 2 non-locking (casters ship detached)
- Counterweight included
- Cushion top comes standard in a solid-colored (non-patterned) black polyester fabric. Other fabric options are available – call for more details.
- Extra lead times may apply for non-standard and COM fabric choices.
- Compatible with Rail System.



STORAGE

scale^{1:1}

Hanging **Drawers**



Hanging Box Drawer
SKU: HDBW



Hanging Box & Box Drawer
SKU: HDBBW



Hanging File Drawer
SKU: HDFW



Hanging Box & File Drawer
SKU: HDBFW

Support **Pedestals**



Supporting Box & File Pedestal
SKU: SPBBF27-MA



Supporting Combination Pedestal
SKU: PLCBBF27OT-MA
PLC2F27OT-MA

Mobile **Pedestals**



Mobile Pedestal Box Drawer
SKU: MBBFPED27-MA



Mobile Pedestal Box Drawer w/ Cushion
SKU: MPBFCT27-MA



STORAGE

scale^{1:1}

Hanging Drawers



Hanging Box Drawer
SKU: HDBW

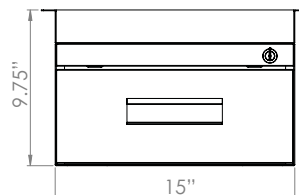
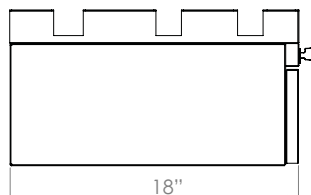

Hanging Box & Box Drawer
SKU: HDBBW

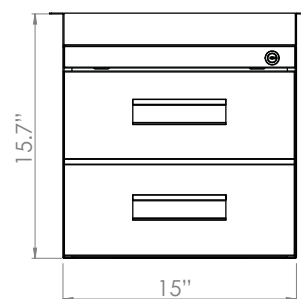
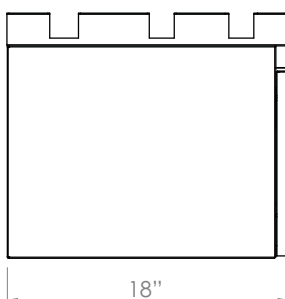

Hanging File Drawer
SKU: HDFW

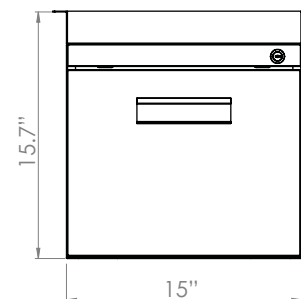
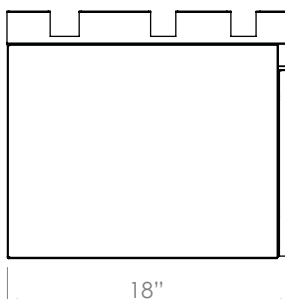

Hanging Box & File Drawer
SKU: HDBFW

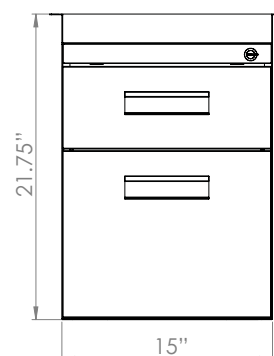
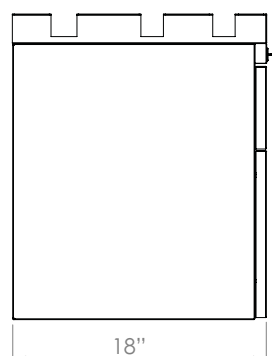

STORAGE

scale^{1:1}

Hanging Drawers



Proudly designed and
fabricated in California.



STORAGE

scale^{1:1}

Support Pedestals



Supporting Box & File Pedestal
SKU: SPBBF27-MA

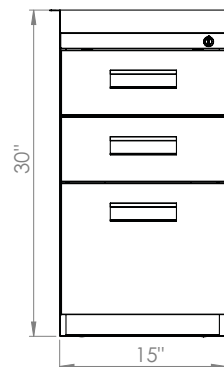
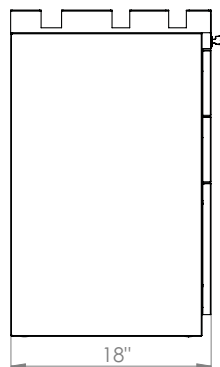

Supporting Combination Pedestal
SKU: PLCBBF27OT-MA
PLC2F27OT-MA

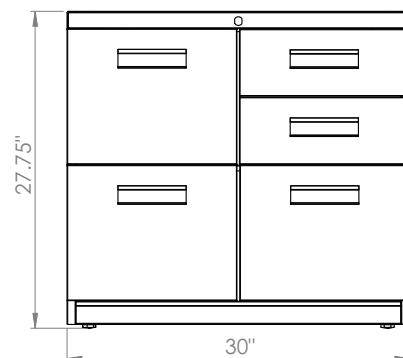
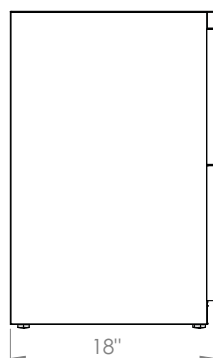

Satisfying user needs is important. Supporting Combination Cabinet is designed for desktop support and workspace efficiency at the same time.

Different configurations provide solutions for different needs.



STORAGE

scale^{1:1}

Support Pedestals



STORAGE

scale^{1:1}

Lateral Files

- Full-extension, ball-bearing drawer slides
- Safety interlock system allows only one drawer to be opened at a time
- Drawer bodies with double-wall sides
- Leveling glides with 1" adjustability



Proudly designed and
fabricated in California.



STORAGE

scale^{1:1}

Lateral Files

Scale 1:1 files provide a durable and attractive means of file storage. Constructed from prime-grade steel, all Scale 1:1 lateral files meet or exceed ANSI-BIFMA standards for safety and reliability.

Scale 1:1 lateral files feature full-width “overlay” drawer fronts that sit in front of the cabinet frame.

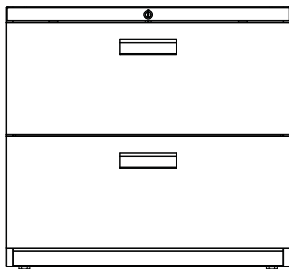

2-High (27.5" tall)
two roll-out drawers
SKU: LF2DW-MA

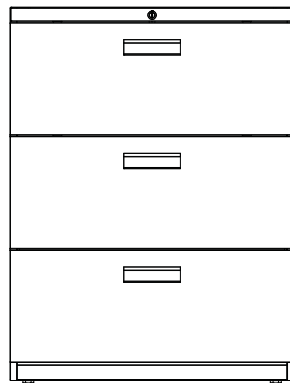

3-High (39.5" tall)
three roll-out drawers
SKU: LF3DW-MA

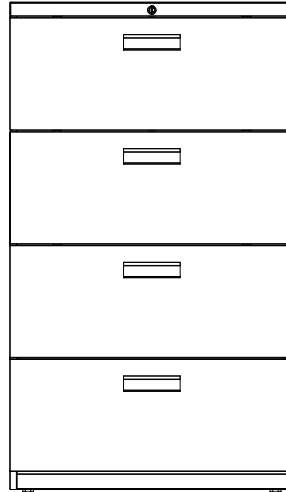

4-High (51.5" tall)
four roll-out drawers
SKU: LF4DW-MA

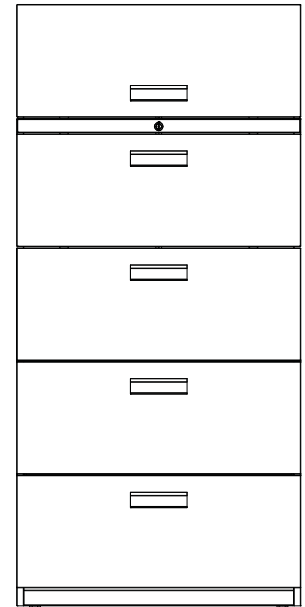

5hB (67.5" tall)
four roll-out drawers with
a fixed shelf in the top
position and a flip up door
SKU: LF5DW-MA

Product No.	H	W	D	Pkg Wt
2-High Lateral Files				
OLF02h30w	27 1/2	30	18	89 lbs
OLF02h36w	27 1/2	36	18	100 lbs
OLF02h42w	27 1/2	42	18	112 lbs
3-High Lateral Files				
OLF03h30w	39 1/2	30	18	120 lbs
OLF03h36w	39 1/2	36	18	136 lbs
OLF03h42w	39 1/2	42	18	151 lbs
4-High Lateral Files				
OLF04h30w	51 1/2	30	18	152 lbs
OLF04h36w	51 1/2	36	18	171 lbs
OLF04h42w	51 1/2	42	18	190 lbs
5hB Lateral Files				
OLF5hB30w	67 3/8	30	18	185 lbs
OLF5hB36w	67 3/8	36	18	208 lbs
OLF5hB42w	67 3/8	42	18	231 lbs



STORAGE

scale^{1:1}

Mobile **Storage** Tower

- 55.5" ht 24"w 24"d
- 75mm black plastic casters - 2 locking, 2 non-locking
- Right and Left designate the side of the cabinet with the coat closet
- Wardrobe includes a side to side coat rod (no shelves)
- Cabinet includes three locks, keyed alike



Proudly designed and
fabricated in California.



STORAGE

scale^{1:1}



Proudly designed and fabricated in California.

