

Bracket installation

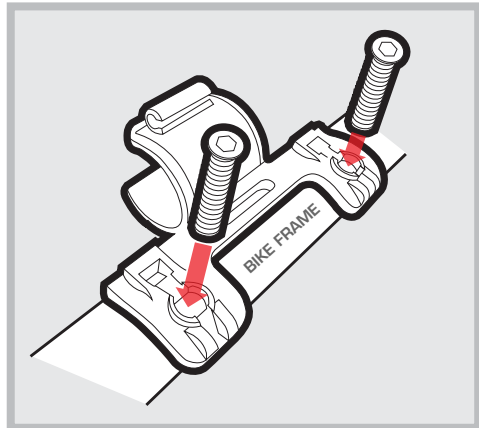

Use included screws to mount to frame using existing water bottle location on non-drive / left side of bicycle. For use with water bottle cages.

Operating Instructions

Identify your valve stem type

SCHRADER



PRESTA

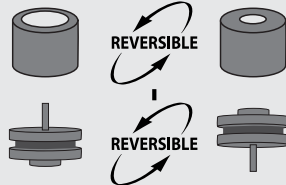

This Zefal mini pump comes factory set for Schrader valves

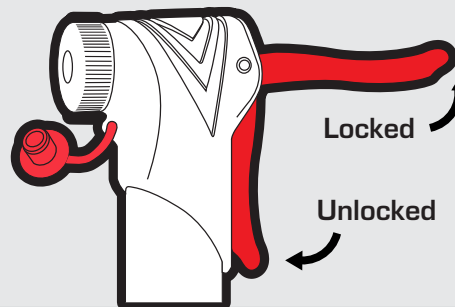

First identify what style valve stem the bicycle has. Then set the internals of the pump head to match the bicycle's valve. Unthread the metal cap on the pump head opening and remove the internal parts. Arrange the internal parts to match your valve type as shown. Insert the internal parts and thread the metal cap back onto the pump head.

1. Remove dust cover.
2. Slide pump head onto valve stem
3. Flip thumb lever into "locked" position
4. Fold out T-handle
5. Pump tire to desired pressure (psi)
6. Flip thumb lever to "unlocked" position
7. Slide pump head off valve stem
8. Compress pump
9. Fold in T-handle and replace dust cover