

The Meeting

interactive public art proposal
Settlers Green | New American Public Art | 2017

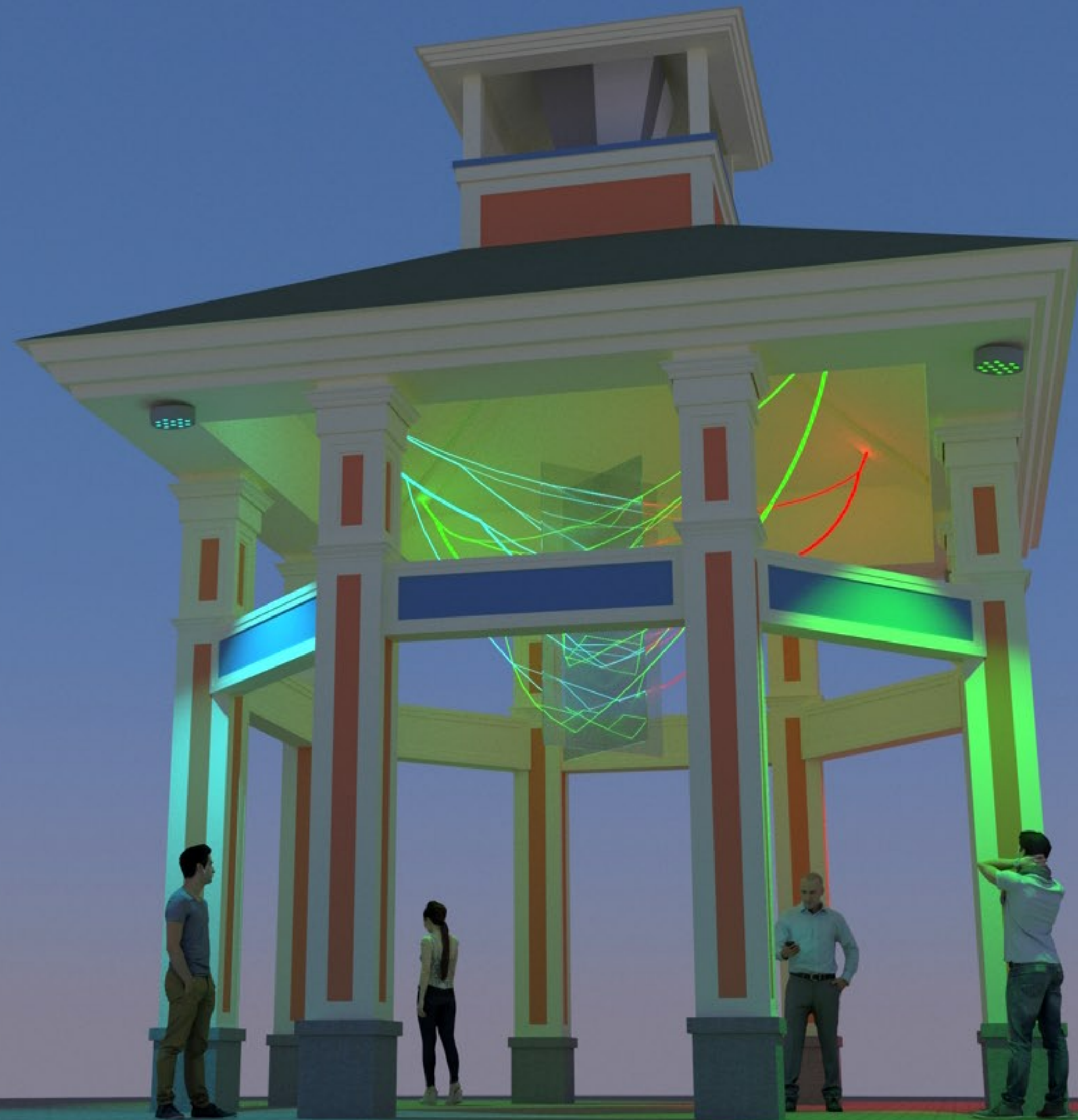

Statement

New American Public Art believes that interactive art connects people to each other. True interactivity happens between people, not between people and objects.

The Meeting is a site-specific interactive artwork which allows participants to collectively affect the colors of the installation and surrounding architecture through text messages. Inspired by the gazebo as a symbolic gathering place of communication and discussion, *The Meeting* visualizes a conversation of color between participants.

Participants can either use rapid-fire text messages to take over the installation with their favorite color, or collaborate deliberately to create experimental mixes and color combinations.

The project functions in a simple and intuitive way. Simply text a color to *The Meeting*'s phone number and one light quadrant will turn that color. The next text message will change the subsequent quadrant, and so on in a continual loop.

Each light quadrant is equipped with powerful LED lights illuminating the architecture of the gazebo, the ground, and 1/4th of a dendritically forked fiber optic sculpture hanging in the middle of the gazebo. The forked paths of the fiber optic cable are an allegory of the many decisions and directions that are possible at *The Meeting* in this gazebo.

If no text messages are received after a set time, the lights' behavior will default into a fade into a pre-programmed show of softly shimmering greens.

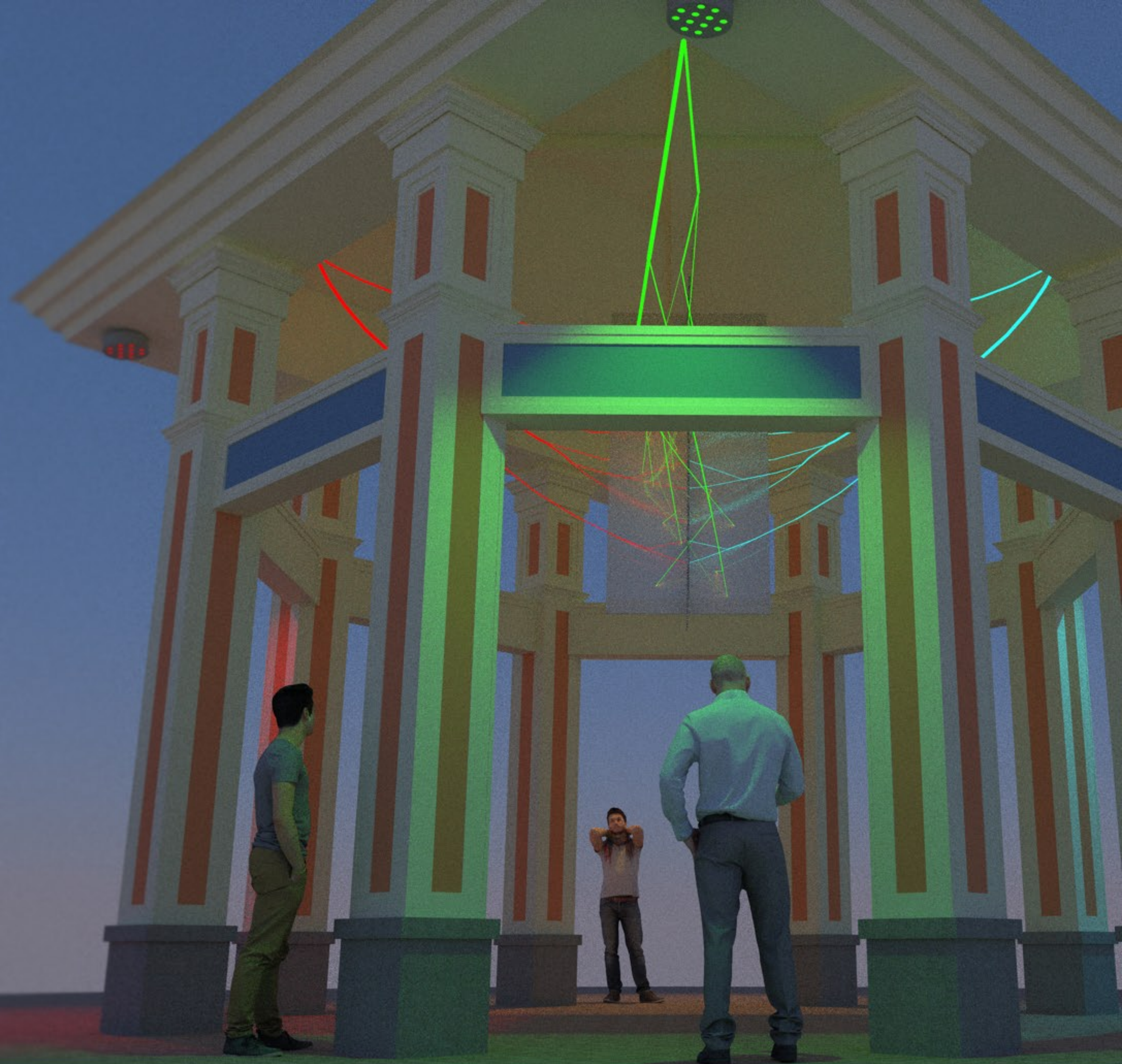

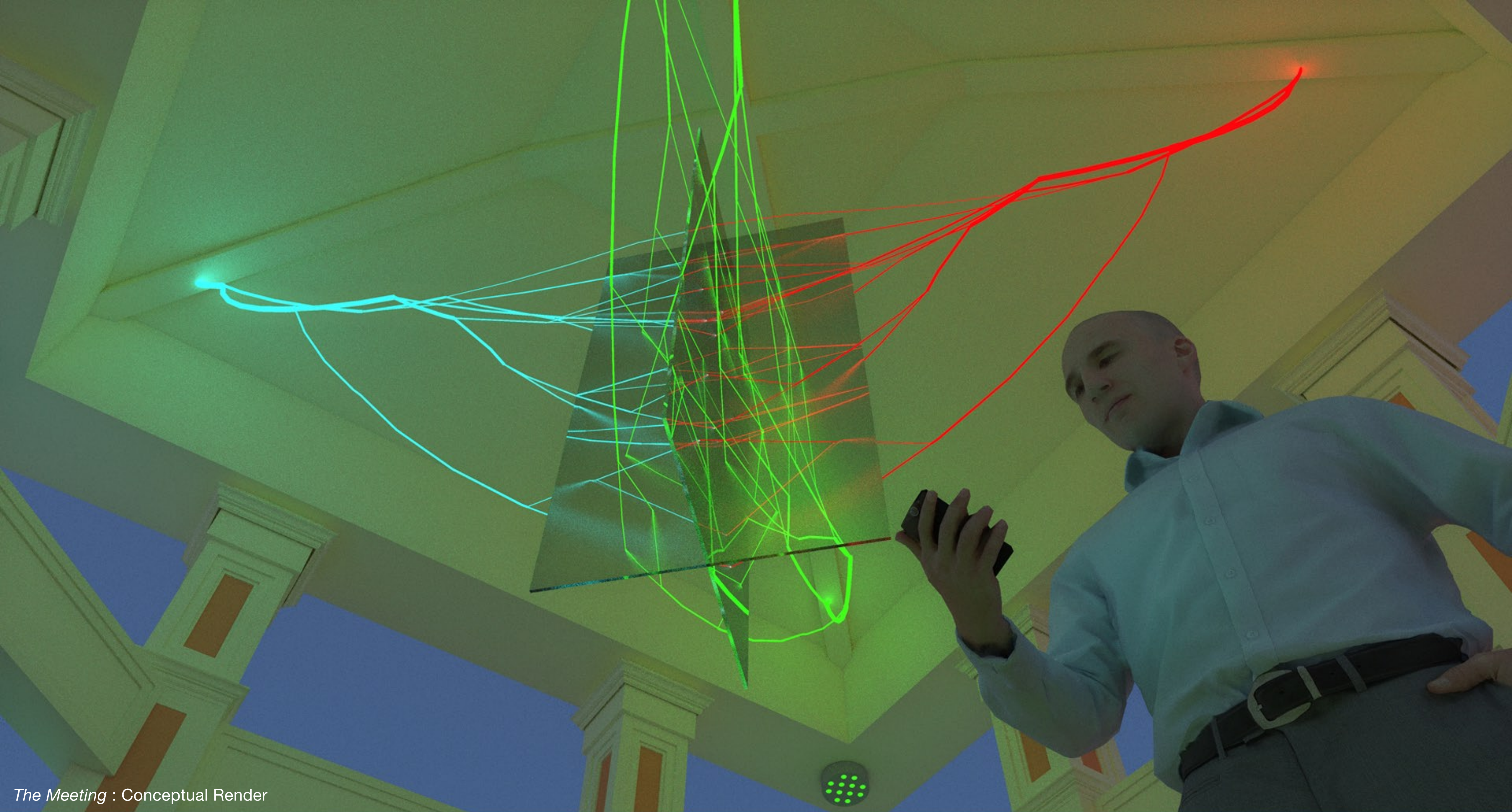

The Meeting : Conceptual Render

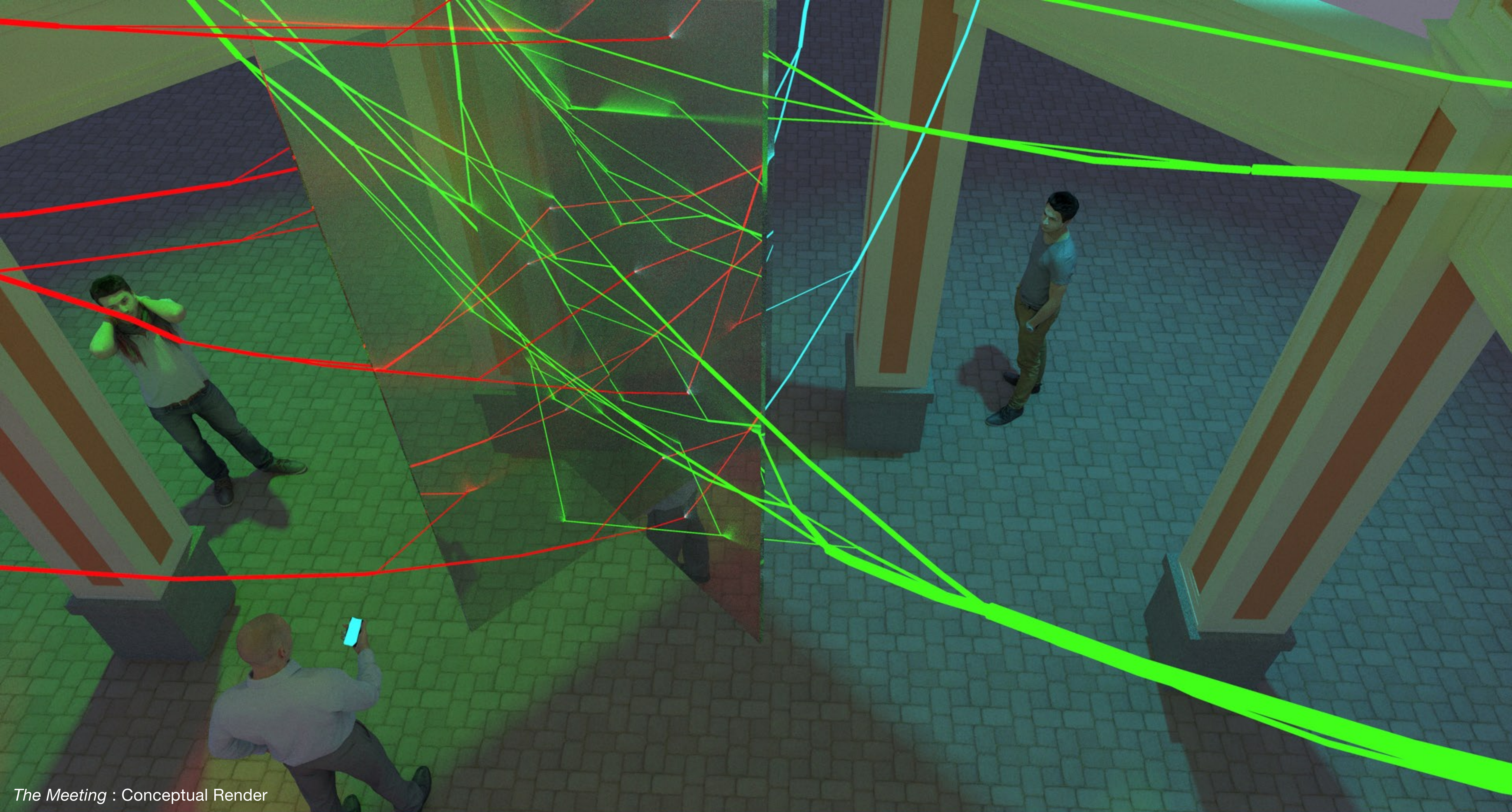

The Meeting : Conceptual Render

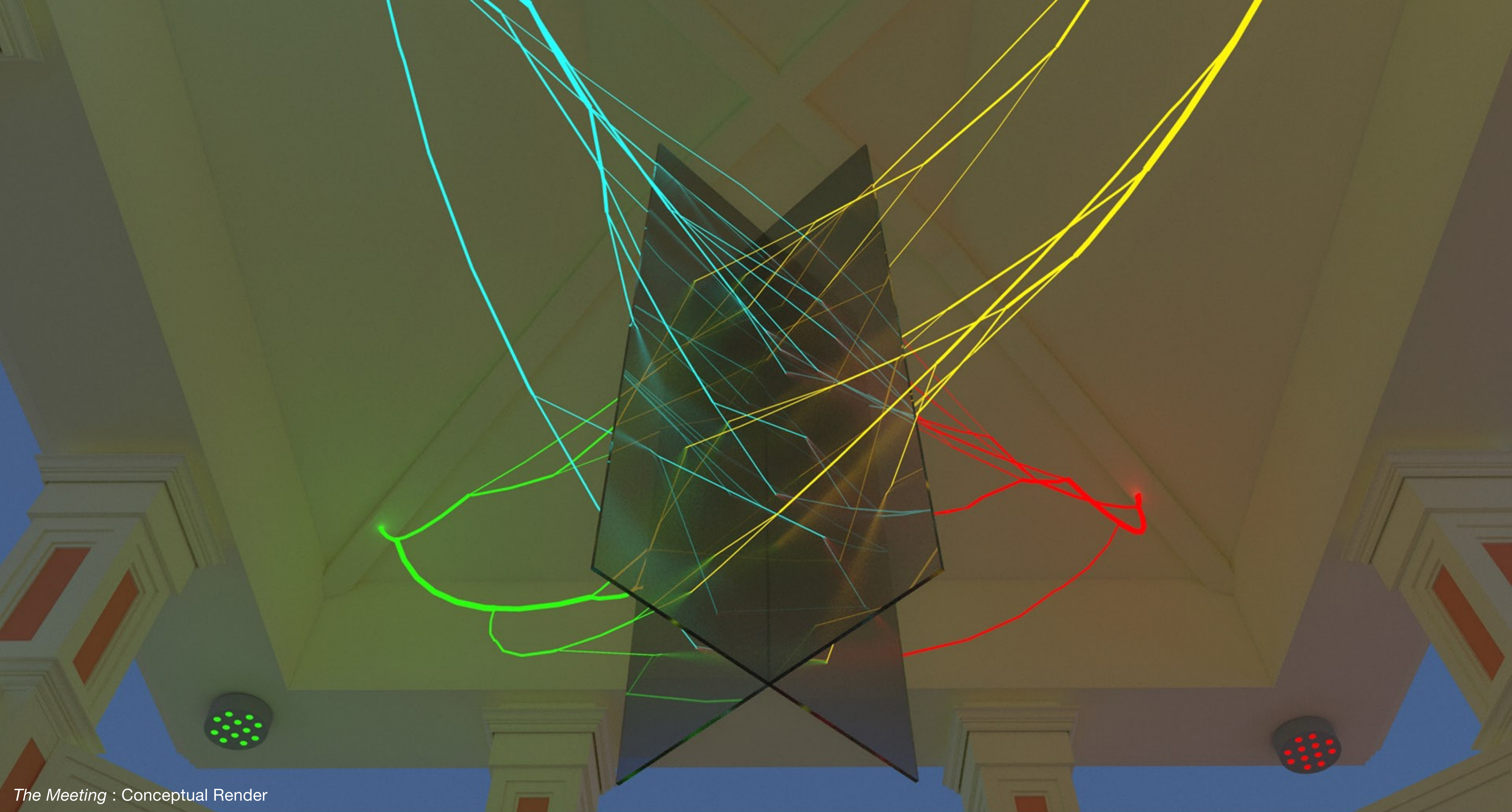

The Meeting : Conceptual Render

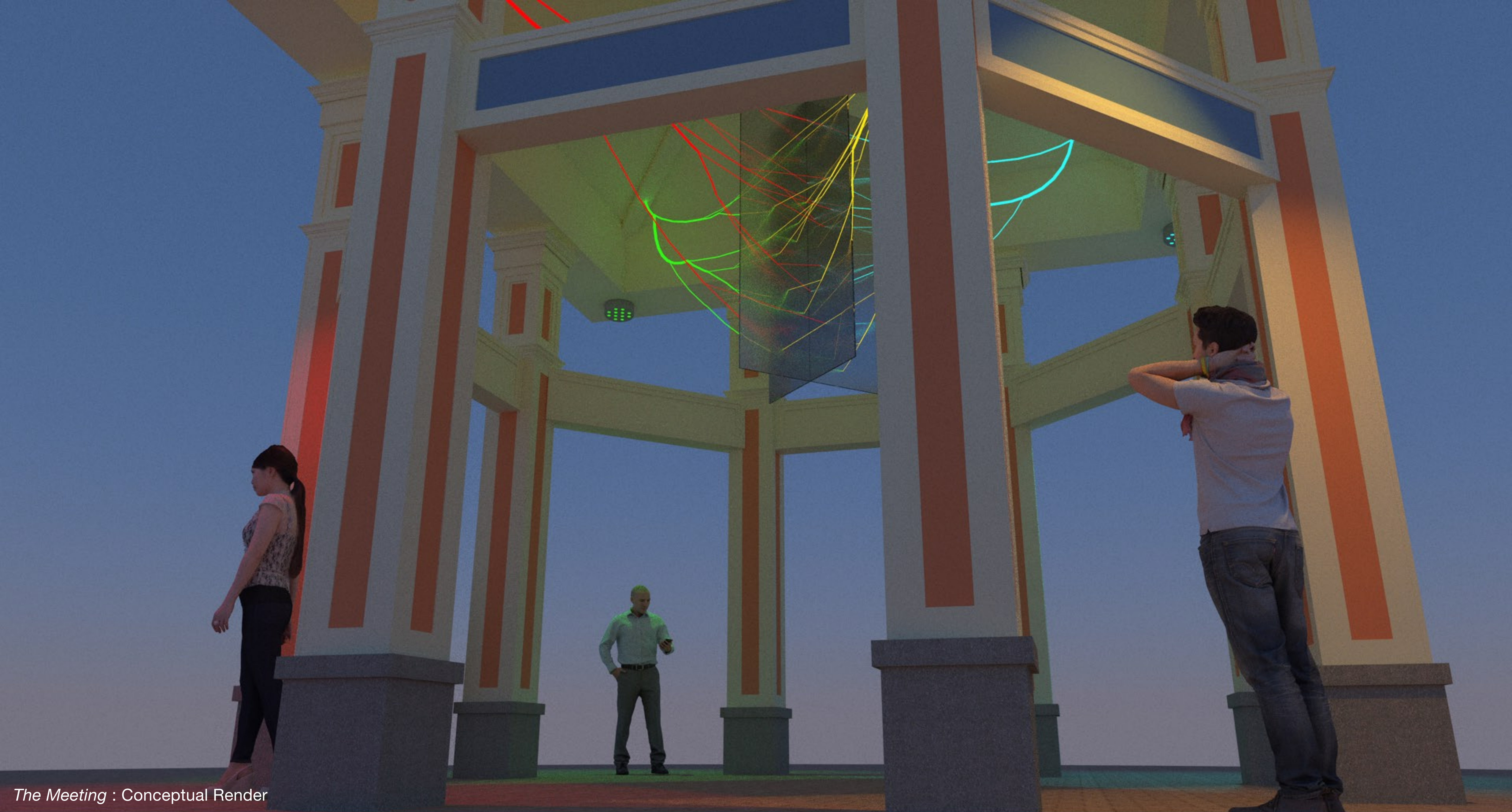

The Meeting : Conceptual Render

Features



Real-time data collection of interactions through Twilio.

- Know exactly how much the artwork is being used and by whom
- Leverage additional Twilio features to text back participants, create identity and promote local businesses



High-end lighting control

- Driven by a professional architectural lighting controller, the Pharos LPC.
- Remotely operate many different light shows for different occasions such as concerts, special events, holidays, etc.. Learn more : <https://www.pharoscontrols.com/products/controllers/lpc>



Robust materials

- All materials, electronics, light fixtures, and fiber optic cables are rated for year-round permanent outdoor use in New England weather.

