



TRAP TABLE ASSEMBLY

TOOLS REQ'D:
 -PHILLIPS HEAD SCREW DRIVER
 -3/16" ALLEN WRENCH (INCLUDED)
 -3/4" DEEP HEAD SOCKET WRENCH

ASSEMBLY TIME:
 30 MINS

DIFFICULTY LEVEL:
 YOU GOT THIS

WHAT'S IN THE BOX:

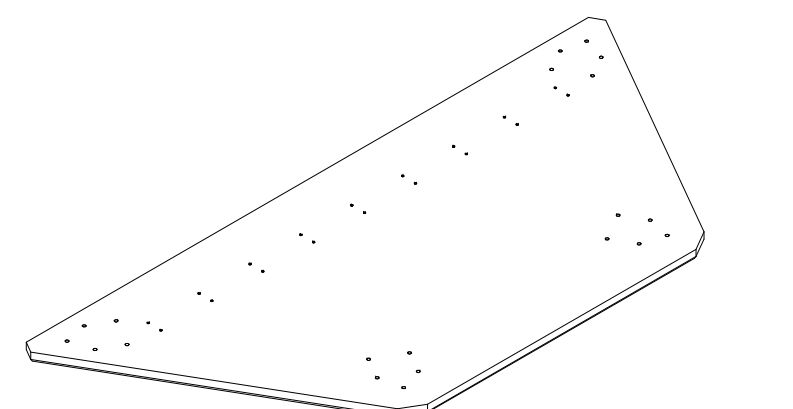

TABLETOP

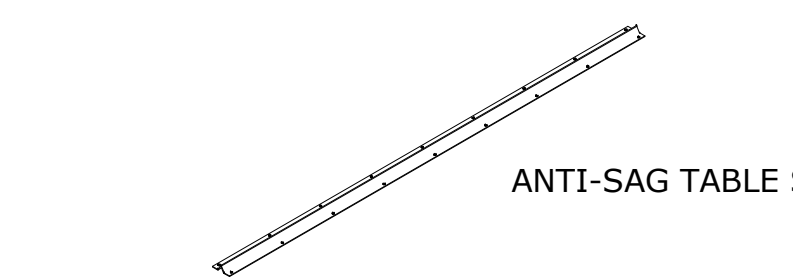

ANTI-SAG TABLE SUPPORT

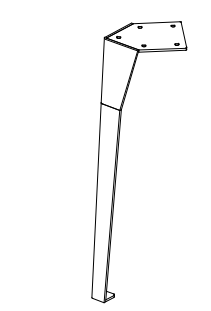

(4) TABLE LEGS



(20) 5/16"x3/4 BUTTON HEAD CAP SCREW W SPLIT WASHER



(4) M12 NYLOC NUTS

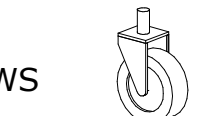

(4) LOCKING CASTERS

(18) #10x3/4 WOOD SCREWS

STEP 1 ANTI-SAG TABLE SUPPORT

-WITH TABLETOP BOTTOM-SIDE UP, ALIGN HOLES IN ANTI-SAG TABLE SUPPORT OVER PRE-DRILLED HOLES IN TABLETOP.

-ATTACH ANTI-SAG TABLE SUPPORT TO TABLETOP USING (18) #10x3/4 WOOD SCREWS. SCREWS MUST BE SECURELY TIGHTENED WITH NO GAPS BETWEEN THE TABLETOP AND TABLE SUPPORT.

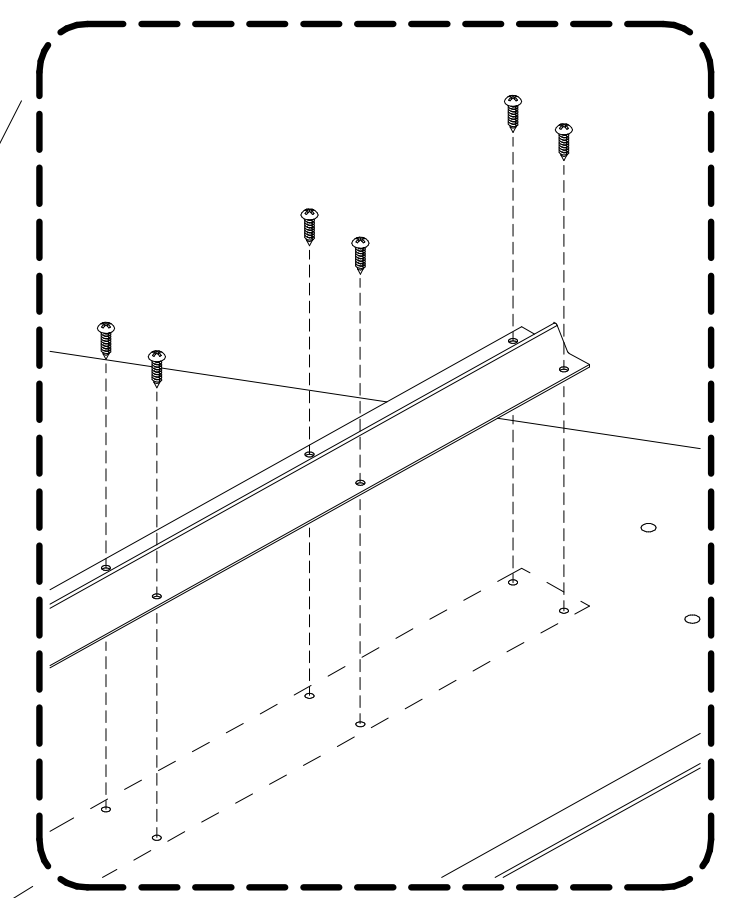
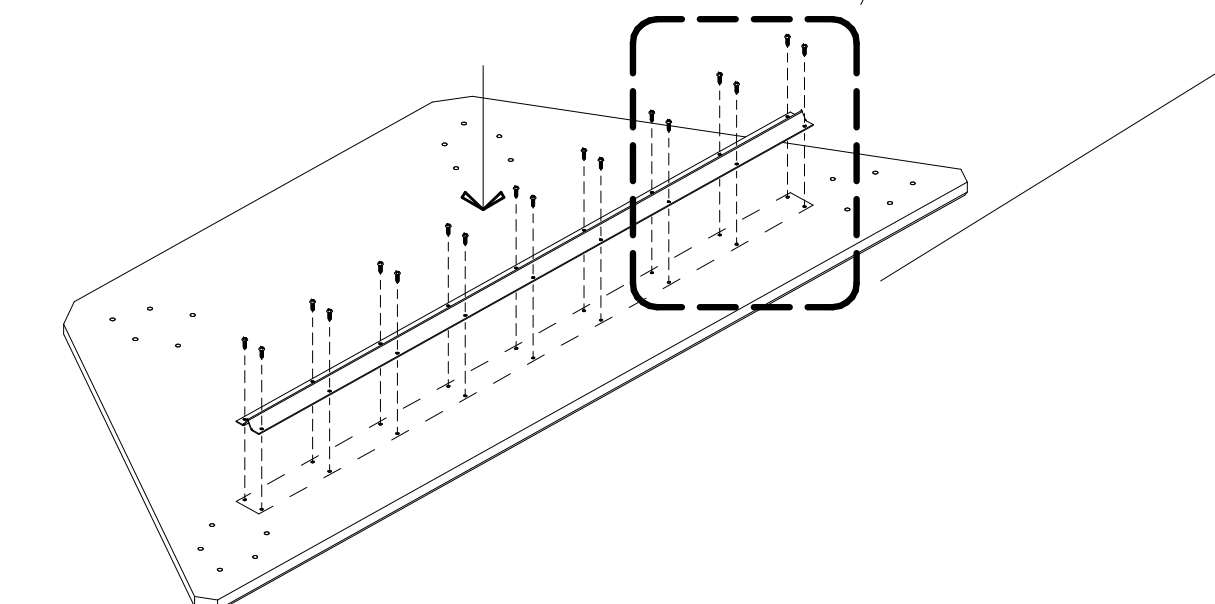

STEP 2 LEGS

-ALIGN HOLES OF TABLE LEG(S) WITH THREADED INSERTS IN TABLETOP.

-ATTACH TABLE LEG(S) TO TABLETOP USING (20) 5/16x3/4 BUTTON HEAD CAP SCREW W/ SPLIT WASHERS. SCREWS MUST BE SECURELY TIGHTENED WITH NO GAPS BETWEEN THE TABLETOP AND TABLE LEG BASE PLATE.

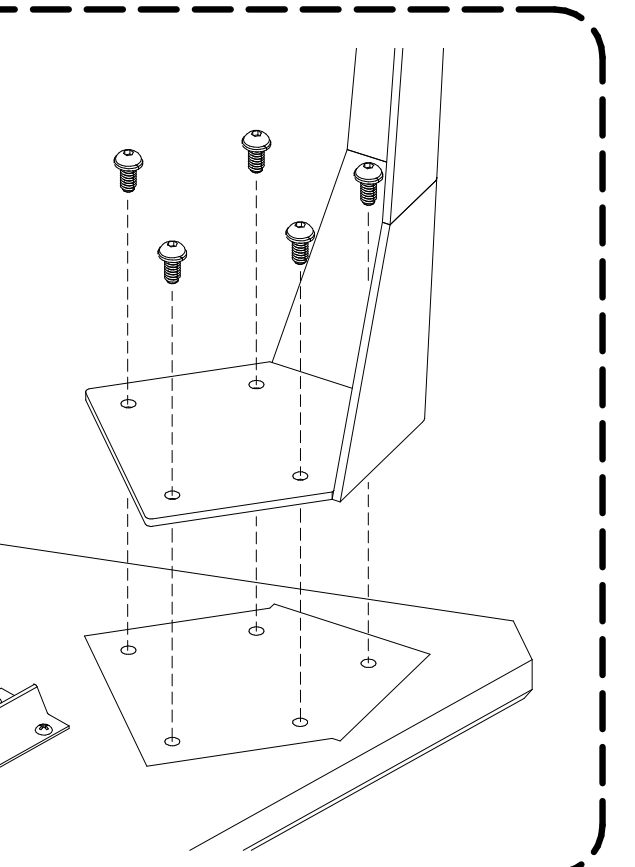
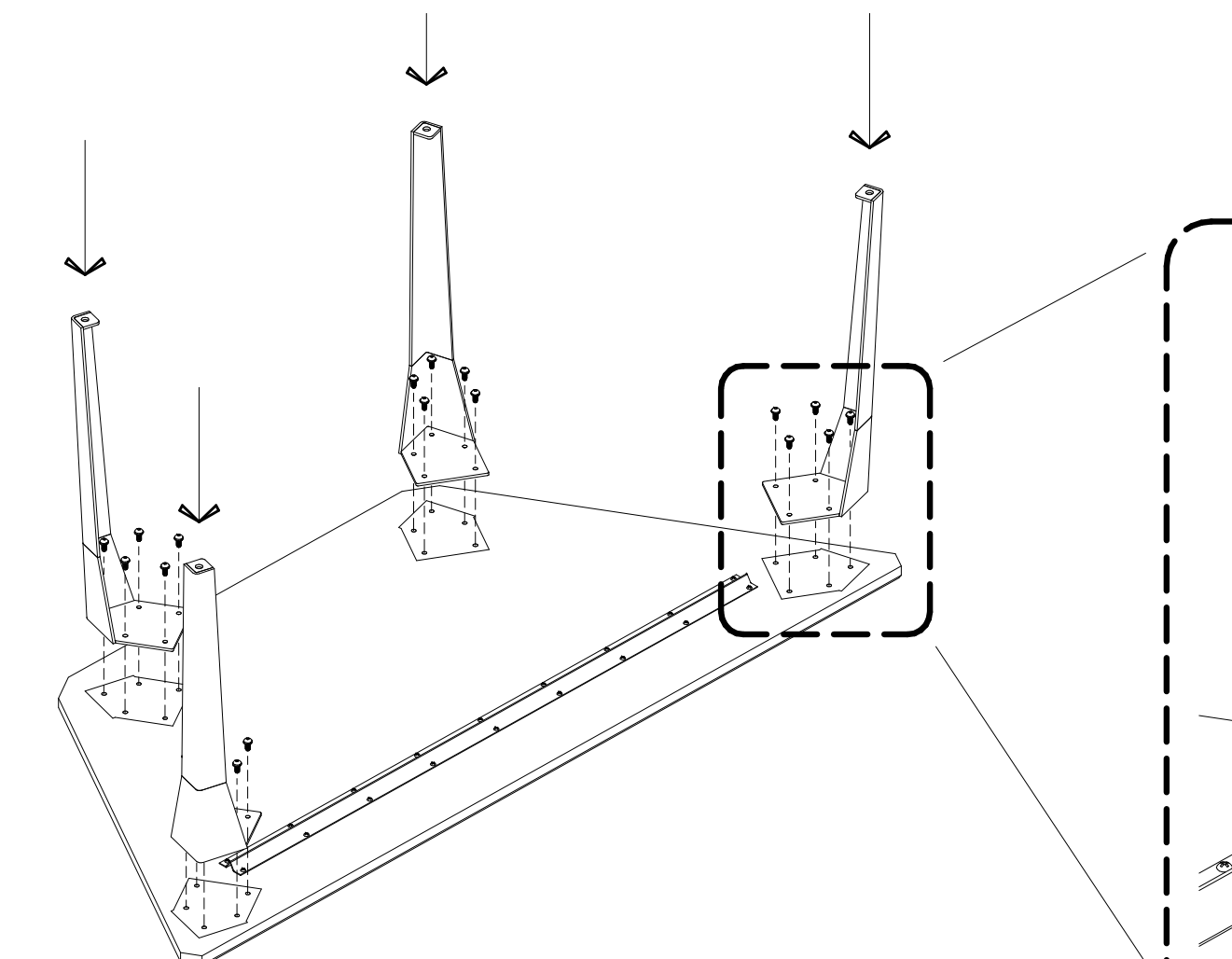

STEP 3 CASTERS

-IN THE LOCKED POSITION, INSERT THREADED STEM OF CASTER INTO THE CASTER HOLE OF TABLE LEG.

-ATTACH CASTER(S) TO TABLE LEG(S) USING (4) M12 NYLOC NUTS. CASTERS MUST BE SECURELY TIGHTENED WITH NO GAPS BETWEEN THE CASTER AND CASTER PLATE OF TABLE LEG.

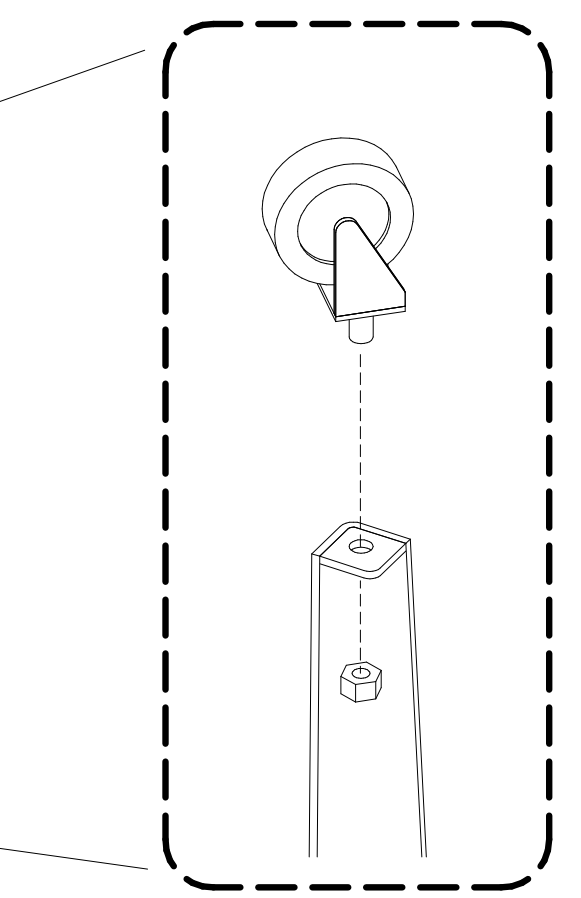
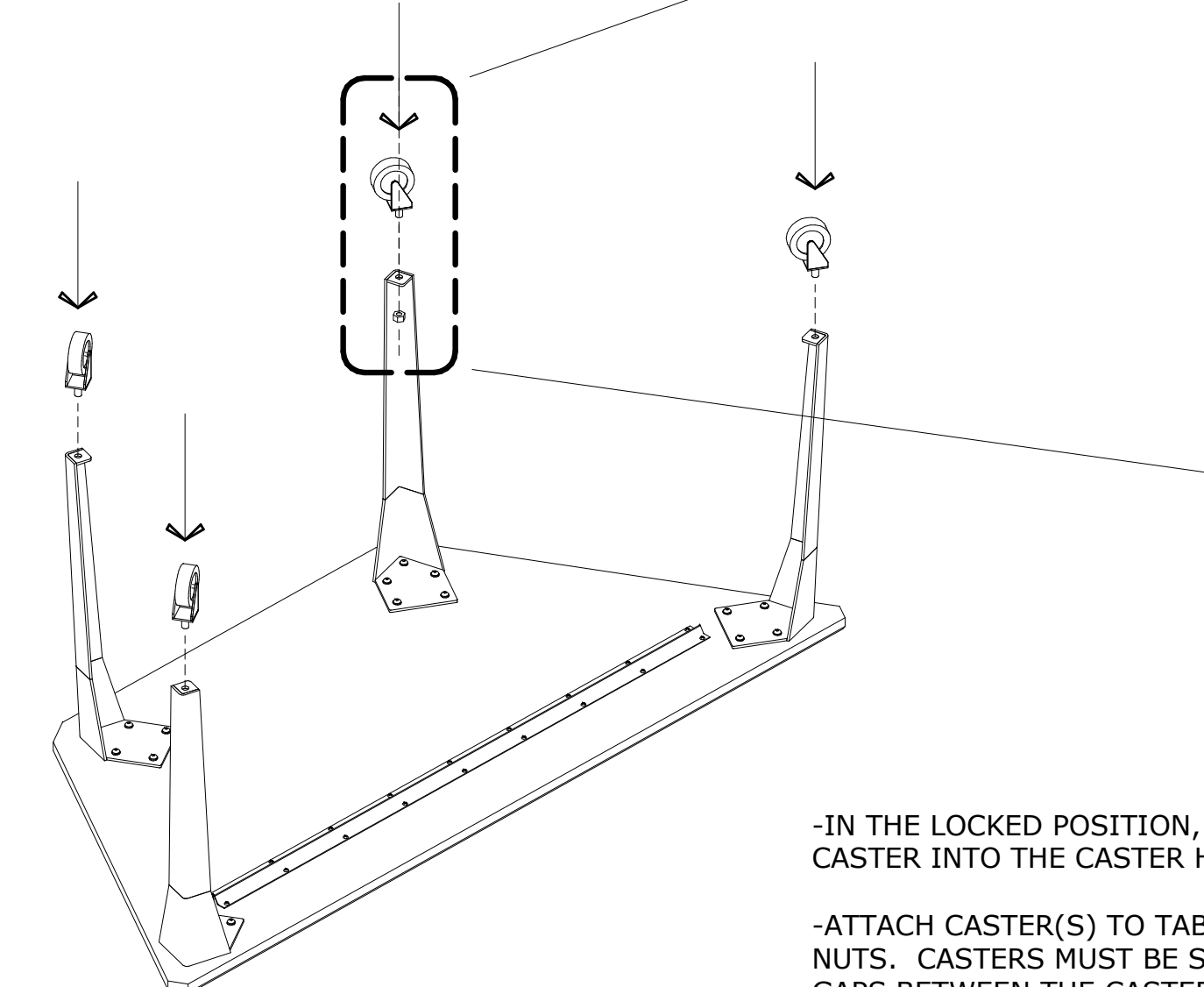

STEP 4 FLIP

-BOOM. YOU DID IT. YOU'VE ASSEMBLED YOUR TRAP TABLE.

-WITH THE HELP OF A BUDDY, FLIP TABLE OVER.

-UNLOCK CASTERS AND ARRANGE TABLE(S) IN YOUR FAVORITE CONFIGURATION. SEE <http://www.werklc.com/trap/> FOR SUGGESTED CONFIGURATIONS/LAYOUTS.

