

GRAYL®

FILTER & PURIFIER Owners Manual



A filter for all occasions.



thegrayl.com / Seattle USA

Let's get started!

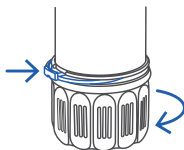

Removal.

Locate filter lock tab at bottom of inner cup. Pull out filter lock tab and twist filter clockwise.

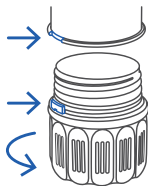

Installation.

Insert filter into inner cup/press and rotate counter-clockwise. Screw filter until filter lock tab clicks into filter lock slot. Do not over tighten.

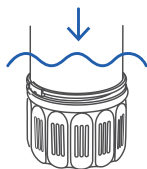

Before first use.

Before drinking, press water through the system twice. Discolored water (caused by harmless activated carbon dust) is normal during the first few cycles.

Cleaning, Maintenance, and Storage.

Your GRAYL is easy to maintain by following a few basic guidelines. Take care of your cup and it will take care of you.

- **Do not wash filter with soap or other cleaning agents.** You may rinse the filter with clean water as needed.
- Your outer cup, inner press/cup, and locking lid are top rack dishwasher safe, otherwise wash by hand with warm, soapy water.
- When storing for an extended period, separate, clean, and thoroughly dry all parts before storing.
- Do not put any components in a microwave or freezer.

Filter Lifespan

The lifespan of the filter or purifier is dependent on the quality of your water source. High levels of sediment in the water will shorten the life span of the filter. **For best results, change the filter after 300 cycles (40gal / 150L) – about three uses per day for three months.** Use beyond filter capacity diminishes filtration effectiveness and may result in drinking unsafe water. If water flow rate is noticeably slower than usual then the filter should be replaced.

Care Between Uses

Cartridges can last up to a year after opening if cared for properly between uses. Activated carbon, which removes many chemicals and heavy metals, can degrade over time. To limit the degradation of filter media, air dry completely and place in an air-tight bag.

Parts and Contact Information

For replacement parts, filters, performance ratings, frequently asked questions or to contact us, please visit, www.thegrayl.com

International Manuals

Manuales / Manuels / Manuali / Handbücher
www.thegrayl.com/manuals



TAP FILTER

FILTERS CHEMICALS & HEAVY METALS. IMPROVES TASTE & SMELL.

Suitable for safe, potable water distributed in public tap water supply networks.

Filters many chemicals (e.g. chlorine, iodine) and heavy metals (e.g. lead, arsenic) that affect health, flavor and odor.



TRAIL FILTER

FILTERS CHEMICALS, HEAVY METALS, PROTOZOA, & BACTERIA.

Suitable for most outdoor water sources and tap water.

Removes 99.99% of bacteria (e.g. *E. coli*, *Salmonella*) and 99.94% of protozoan cysts (e.g. *Giardia*, *Cryptosporidium*). Filters many chemicals (e.g. chlorine, iodine) and heavy metals (e.g. lead, arsenic) that affect health, flavor and odor.



TRAVEL PURIFIER

FILTERS CHEMICALS, METALS, BACTERIA, PROTOZOA & VIRUSES.

Suitable for the rigors of international travel and highly impacted wilderness areas.

Removes 99.999% of disease-causing bacteria (e.g. *E. coli*, *Salmonella*), protozoan cysts (e.g. *Giardia*) and viruses (e.g. *Hepatitis A*). Filters many chemicals (e.g. chlorine, iodine) and heavy metals (e.g. lead, arsenic) that affect health, flavor and odor.

FILTER MEDIA

ACTIVATED CARBON

The **TAP Filter** uses activated carbon fiber with an extremely small micro pore structure and a capacity for absorption far greater than conventional granular activated carbon.

G3+™ FILTRATION MEDIA

The **TRAIL Filter** and **TRAVEL Purifier** use a patented **G3+™ Filtration Media** – three filtration technologies in one for added protection: 1) A triple-charged mesh traps disease-causing germs while allowing water to flow quickly, 2) Activated natural carbon (made from coconut shells) attracts and traps many heavy metals, industrial chemicals, 3) An integrated anti-microbial agent suppresses the growth of mold, mildew and bacteria, keeping GRAYL fresh between uses.

SPECIFICATIONS	TAP	TRAIL	TRAVEL
Improves taste and smell	✓	✓	✓
Effective against chemicals/toxins	✓	✓	✓
Effective against bacteria	✗	99.99%	99.9999%
Effective against protozoan cysts	✗	99.94%	99.999%
Effective against viruses	✗	✗	99.9999%
Filter media	Activated Carbon	G3+™	G3+™
Anti-microbial	✓	✓	✓
Chemical free	✓	✓	✓
BPA-free	✓	✓	✓
Press time	7 seconds per 16oz (473ml)	15 seconds per 16oz (473ml)	30 seconds per 16oz (473ml)
Flow rate	4 L/minute	2 L/minute	1 L/minute
Lifespan	300 uses (40 Gal/150 L)	300 uses (40 Gal/150 L)	300 uses (40 Gal/150 L)
Tested to NSF Standards	42	42 + 53	42 + 53