

Observers: AT

Center for Snow and Avalanche Studies

Profile # 1

Time: 1040

Snowpack Profile

Date: 1/18/18

Location: SBSR

Elev. 2,200

Aspect: NE

Boot Pen: 26 cm

α : 2 °

Air T: -6 °C

Sky: B

Precip: NO

Wind: None

Prior Pit: # -; -1-1-

Total Snowpack SWE: 93 mm H₂O

HS Norm: 0.42 m

Mean ρ 221 kg/m³

Notes: Study plot

heavily wind-affected

T°	K	P	1F	4F	F	H	E	ρ	θ	DOD	Notes
270											
260											
250											
240											
230											
220											
210											
200											
190											
180											
170											
160											
150											
140											
130											
120											
110											
100											
90											
80											
70											
60											
50											
40											
30											
20											
10											
0											

-4.1
-7.3
-9.3
-7.1
-3.6
-0.6

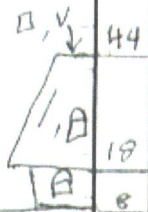

NSF + old wind-broken SH
Faceted mix of DF's, wind deposited snow
faceted wind deposit
old poly gone. DH

7
SWE

61

32

93

Notes:
