



CENTER *for* PLANNING EXCELLENCE



LOUISIANA

**SMART
GROWTH
SUMMIT**



#CPEX_LA

summit.cpex.org

EVENT FLOORPLAN

◀ LAFAYETTE STREET

CONVENTION STREET ▲

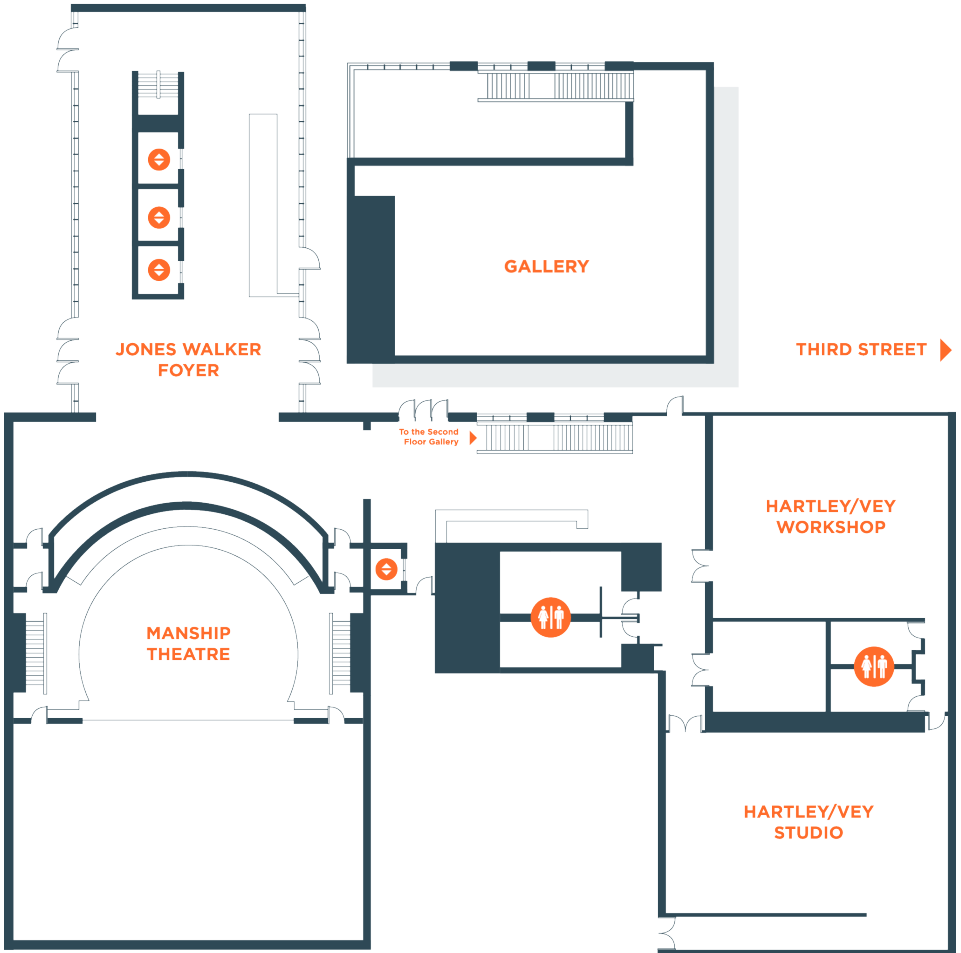

▼ NORTH BOULEVARD

SMART GROWTH PRINCIPLES

Smart Growth is meant to create and maintain attractive, convenient, safe and healthy communities. These pillars foster design that encourages choices for residents, workers, visitors, in where to live, how to get around, and how to interact with the people around them.



Create a range of housing opportunities



Create walkable neighborhoods



Encourage community and stakeholder collaboration



Foster distinctive, attractive communities with a strong sense of place



Make development decisions predictable, fair and cost effective



Mix land uses



Preserve open space, farmland, natural beauty and critical environmental areas



Provide a variety of transportation choices



Strengthen and direct development toward existing communities



Take advantage of compact building design

MONDAY | NOVEMBER 10

6:00 PM

Keynote Event

📍 **MANSHIP THEATRE**

Call to Order

Elizabeth “Boo” Thomas, FASLA President/CEO, Center for Planning Excellence

Opening remarks

U.S. Senator Mary L. Landrieu (Invited)

Welcome

John Paul Funes President/CEO, Our Lady of the Lake Foundation

Keynote Address

Mayor AC Wharton, Jr. Mayor of Memphis, Tennessee

7:00 PM

Reception *Sponsored by Our Lady of the Lake Foundation*

📍 **GALLERY AT THE MANSHIP THEATRE**

TUESDAY | NOVEMBER 11

8:00 AM

Registration / Breakfast / Networking

Sponsored by Hotel Indigo Downtown Baton Rouge

📍 **GALLERY AT THE MANSHIP THEATRE**

8:30 AM

Call to Order

📍 **MANSHIP THEATRE**

Elizabeth “Boo” Thomas, FASLA President/CEO, Center for Planning Excellence

Welcome Remarks

Cordell Haymon Chairman of the Board, Center for Planning Excellence

8:45 AM

Veteran’s Day Tribute

MG John Basilica, Jr. Vice President, Gulf Coast District Leader, HNTB Corporation

9:00 AM

**Globally Competitive, Sustainable and Resilient Communities:
What are Communities of All Sizes Doing to Win the Economy?**

Sponsored by Stone Pigman Walther Wittmann L.L.C.

Harriet Tregoning Director, Office of Economic Resilience, US Dept. of Housing and Urban Development

MODERATOR: James E.A. Slaton Member, Stone Pigman Walther Wittmann L.L.C. and
Chair of the 2014 Louisiana Smart Growth Summit Planning Committee

9:45 AM

BREAK

10:00 AM

Session 1 (CHOOSE ONE OF THE FOLLOWING SESSIONS)

📍 MANSHIP THEATRE

Tennessee DOT: Innovative Transportation Solutions and Multi-Modal Investments

Sponsored by Stantec Consulting Services

Learn about how the Tennessee Department of Transportation's innovative approaches to funding, multi-modal strategies, project delivery and community engagement have created better outcomes while saving taxpayer money at the same time.

John Schroer Commissioner, Tennessee Department of Transportation

Toks Omishakin Chief of Environment and Planning/Deputy Commissioner, Tennessee DOT

Bridget Jones, PhD Executive Director, Cumberland Region Tomorrow

MODERATOR: Rachel DiResto Executive Vice President, Center for Planning Excellence

📍 HARTLEY/VEY STUDIO

Building for Generations to Come

How do we take a pro-active approach to housing that addresses current needs, anticipates shifting markets, and helps guide development toward healthy growth and sustainable communities? Our speakers will address these issues from federal, state and local perspectives, reporting on HUD programs and priorities designed to support state and local efforts; the role of the Louisiana Housing Corporation in setting state policy and managing credits and investments to create value and maximize access to opportunity; the need for data and findings of the new Louisiana Housing Needs Assessment; and the critical role of community engagement in developing our statewide housing strategy.

Harriet Tregoning Director, Office of Economic Resilience, US Dept. of Housing and Urban Development

Frederick Tombar, III Executive Director, Louisiana Housing Corporation

Roy L. Heidelberg, PhD Assistant Professor, Public Administration Institute, LSU

MODERATOR: Andreanecia M. Morris Vice President of Homeownership and Community Development, Providence Community Housing

📍 HARTLEY/VEY WORKSHOP

Introduction to Smart Growth: Avoiding the 20 Most Common Mistakes

A great introduction for first-time attendees to the conference or those new to the practice of implementing Smart Growth solutions. The session will cover the 10 principles of Smart Growth, how to avoid dumb growth and leverage placemaking as an economic development tool.

Nathan Norris CEO, Downtown Development Authority, Lafayette

MODERATOR: Susan Kelliher SVP of Human Resources, Albemarle Foundation

11:30 AM

BREAK



TUESDAY | NOVEMBER 11

11:30 AM

Lunch Session

**YOU CAN
PURCHASE
A TICKET
FOR THIS
SESSION AT
THE FRONT
TABLE, IF
AVAILABLE.**

📍 MANSHIP THEATRE

What Makes People Love a City?

Sponsored by Blue Cross and Blue Shield of Louisiana

Attendees will hear about the importance of local businesses, what attracts entrepreneurs to cities and what they're seeking from city life.

Lunch is
provided by
Whole Foods.

Brandell Lomas Owner & Founder, The Buy Local Card

Andrea Chen Executive Director, Propeller: A Force for Social Innovation

Nicole David Corporate Relocation Manager, Louisiana Economic Development FastStart

MODERATOR: Julie Laperouse Director of Talent Development, Baton Rouge Area Chamber

12:50 PM

Session 2 (CHOOSE ONE OF THE FOLLOWING SESSIONS)

📍 MANSHIP THEATRE

From Vision to Action: Living and Prospering with Water

This session will take a look at current efforts to transform the ecologies and economies of our cities and regions through smart, integrated water management policies. Speakers will talk about what communities are doing to become more resilient at local, national, and international levels; and will reference specific resources, initiatives, coalitions and policies, including the Greater New Orleans Water Plan, HUD's Rebuild by Design, the Coalition for Coastal Resilience and Economy, and the Coalition for Sustainable Flood Insurance.

Robin Barnes Executive Vice President & COO, Greater New Orleans, Inc.

J. David Waggoner, III Principal, Waggoner & Ball Architects

MODERATOR: Jeannette Dubinin Project Manager, Center for Planning Excellence

📍 HARTLEY/VEY STUDIO

Shared Streets: Walk to Shop, Bike to Work

You have a vision and plan for Complete Streets, but how do you implement it? This session will explore the transition between vision and construction, highlighting how the vision for a Complete Street can be successfully realized while maintaining the integrity of the vision through engineering and construction. The session will include successful examples from Memphis and Chattanooga, TN; Russellville, AR; and North Central Texas, which Louisiana communities can learn from as our communities move forward towards implementation.

G. Wade Walker Complete Streets Regional Leader, Alta Planning + Design

Janet Tharp Director of Planning, Center for Planning Excellence

MODERATOR: Jennifer E. Ruley Active Transportation Engineer, Louisiana Public Health Institute

📍 HARTLEY/VEY WORKSHOP

Big Ideas, Small Tools: How Shared Goals and Calculated Risks Can Remake Your City

Attendees will hear from four groups in Lafayette collaborating to implement plans and engage the community. Speakers will also highlight the importance of accessible leadership, the ways they're leveraging funding and sharing resources, and ultimately working together along the road to implementation.

Carlee Alm-LaBar Assistant to City-Parish President, Lafayette Consolidated Government

Kate Durio Director of Marketing and Events, Lafayette Downtown Development Authority

Gretchen LaCombe Vanicor Director of Sustainability, University of Louisiana at Lafayette

Elizabeth Brooks Director of Planning and Design, Lafayette Central Park, Inc.

MODERATOR: Kevin Blanchard Chief Development Officer, Lafayette Consolidated Gov.

TUESDAY | NOVEMBER 11

2:05 PM

Session 3 (CHOOSE ONE OF THE FOLLOWING SESSIONS)

📍 MANSHIP THEATRE

Great Lakes, Great Parks, Great Places

Attendees will hear about projects including City Park in New Orleans; Shangri La Botanical Gardens and Nature Center in Orange, TX; and Buffalo Bayou in Houston. Speakers will highlight the design, what they learned along the way to implementation, their models for long-term maintenance and operations, and ways they engage the community. This will set the stage for a glimpse at the six Baton Rouge Lakes and what's coming up for the project.

Dr. Robert W. Becker Chief Executive Officer, New Orleans City Park

Jeffrey K. Carbo, FASLA Jeffrey Carbo Landscape Architects & Site Planners

Kinder Baumgardner President, SWA Group

MODERATOR: John Spain Executive Vice President, Baton Rouge Area Foundation

📍 HARTLEY/VEY STUDIO

Transit that Works: Connecting to Opportunities

PolicyLink will give an overview of what equity is, a national policy update on what's going on with equity, and what organizations are doing in our state to realize transit as an economic resource for our communities. Attendees will also hear about strategies for leveraging infrastructure and transportation investments for inclusive job creation and connecting people to employment centers.

Anita Hairston Associate Director, PolicyLink

Mark E. Kirstner Director of Planning, Piedmont Authority for Regional Transportation

MODERATOR: Ashley Shelton Louisiana Director, One Voice

📍 HARTLEY/VEY WORKSHOP

The Anatomy of a Downtown Zoning Code: Producing Vibrancy, Convenience and Charm

Learn about the latest innovations in form-based codes that are designed to maximize the inherent competitive advantages of downtowns and town centers. Special attention will be given to what you should avoid regulating as well as how to create a simpler framework for regulating the metrics that matter.

Nathan Norris CEO, Downtown Development Authority, Lafayette

Geoff Dyer Director of Design, Downtown Development Authority, Lafayette

Frank M. Duke, FAICP Planning Director, Baton Rouge City-Parish Planning Commission

MODERATOR: Davis Rhorer Executive Director, Downtown Development District

CLE

1
HOUR

3:20 PM

Session 4 (CHOOSE ONE OF THE FOLLOWING SESSIONS)

📍 MANSHIP THEATRE

CLE

1

HOUR

Who Owns What: The Legal and Economic Impacts of Annexation and Incorporation

Sponsored by Jones Walker LLP

This session will look at the legal, economic and other impacts around annexation and incorporation. Speakers will discuss policy and planning tools including legislation and state of statutes affecting communities either looking to annex additional properties, or those dealing with parts of their current Parish wanting to incorporate.

Dr. James A. Richardson Director of the Public Administration Institute, LSU

Kenneth M. Murchison Professor Emeritus, LSU Law Center

MODERATOR: Charles A. Landry Of Counsel, Jones Walker LLP

📍 HARTLEY/VEY STUDIO

CLE

1

HOUR

Knowing Your Market: Tools for Neighborhood Revitalization

Sponsored by Federal Reserve Bank of Atlanta

Attendees will hear about ways local governments and communities are using data to help them make better decisions when it comes to stabilizing and revitalizing distressed neighborhoods. Speakers will touch on the Market Value Analysis Tool used in Baltimore, Philadelphia, Detroit and now New Orleans and how it has shaped or led to neighborhood revitalization and feasible development plans. Other tools including Data Driven Detroit, Motor City Mapping, and Baltimore's Vacants to Value will also be highlighted.

Joseph Schilling Senior Fellow, Metropolitan Institute, Virginia Tech

Catherine Califano Associate Director of Policy Solutions, The Reinvestment Fund

Susannah Bing Dir. of Finance and Economic Development, EBR Redevelopment Authority

MODERATOR: David Jackson Economic Development Adviser, Federal Reserve Bank of Atlanta

📍 HARTLEY/VEY WORKSHOP

Trailblazers: Creating Networks with Nature

Trails are not just for recreation anymore. As cities are focus on giving their residents choices about how they move, trail networks are increasingly seen as critical links in the commuter mobility network. This session will focus on how urban and rural trail and greenway systems can create a seamless network that aids travel choice, while exploring the various challenges such as off-road to on-road transitions, agency coordination, and property acquisition. Attendees will hear about efforts underway in Memphis, New Orleans, and other communities and how they provide tourists and residents transportation alternatives.

G. Wade Walker Complete Streets Regional Leader, Alta Planning + Design

Sarah Olivier Program Manager, Trust for Public Land

Sophie Harris Executive Director, Friends of Lafitte Corridor

MODERATOR: Haley Blakeman Director of Implementation, Center for Planning Excellence

TUESDAY | NOVEMBER 11

4:35 PM

Session 5 (CHOOSE ONE OF THE FOLLOWING SESSIONS)

📍 MANSHIP THEATRE

The Future of Our Coastal Communities: Achieving Resiliency

Attendees will hear about local and state efforts to reduce flood risk in Louisiana. This session will highlight coastal communities resilience measures and their challenges as well as past, present, and future state-led projects to restore and protect Louisiana's coast.

Camille Manning Broome SVP of Planning + Implementation, Center for Planning Excellence

Kyle Graham Executive Director, Coastal Protection and Restoration Authority

MODERATOR: Pamela Jenkins, PhD Professor of Sociology, University of New Orleans

📍 HARTLEY/VEY STUDIO

Creating Ageless Communities

This session will take a look at trends in development, demographic changes, what people are looking for in communities, and if we're building for our past or future needs.

Kathryn Lawler Aging and Health Resources Manager, Atlanta Regional Commission

Helen Foster Principal, Foster Strategy, LLC

MODERATOR: Jessica Kemp PhD VP of Policy + Advocacy, Center for Planning Excellence

📍 HARTLEY/VEY WORKSHOP

Fighting Blight: Neighborhood Stabilization Strategies

This session will give a national overview of techniques and tools available to clean up blighted properties, how New Orleans is looked to as a model, and what is currently going on in Louisiana to address these issues, looking at code enforcement as one important tool.

Laura C. Settlemyer Assistant City Attorney, Code Enforcement & Hearings Bureau, City of New Orleans

Brenda M. Breaux Chief Operating Officer, New Orleans Redevelopment Authority

MODERATOR: Joseph Schilling Senior Fellow, Metropolitan Institute, Virginia Tech



5:45 PM

Great Places in Louisiana Awards Reception

Sponsored by AARP Louisiana

📍 GALLERY AT THE MANSHIP THEATRE

WEDNESDAY | NOVEMBER 12

8:00 AM **Registration / Breakfast / Networking**

📍 **GALLERY AT THE MANSHIP THEATRE**

Sponsored by Urban Restoration Enhancement Corporation (UREC)

8:45 AM **Call to Order**

Elizabeth “Boo” Thomas, FASLA President/CEO, Center for Planning Excellence

Welcome Remarks

Cordell Haymon Chairman of the Board, Center for Planning Excellence

9:00 AM **Plenary Session**

📍 **MANSHIP THEATRE**

Planning for a New Day

Sponsored by Coleman Partners Architects, LLC

Attendees will hear from the two new planning directors in Louisiana’s most populated and economically significant communities and how they will incorporate innovative ideas, approaches and technologies to their new leadership roles. They will also discuss trends in demand for walkable communities, development infill, and community resilience.

Harriet Tregoning Director, Office of Economic Resilience, US Dept. of Housing and Urban Development; Former Planning Director for Washington DC (Via video)

Frank M. Duke, FAICP Planning Director, Baton Rouge City-Parish Planning Commission

Robert D. Rivers Executive Director, New Orleans City Planning Commission

FACILITATOR: Elizabeth “Boo” Thomas President/CEO, Center for Planning Excellence

MODERATOR: Marvin “Buddy” Ragland, Jr. Principal, Coleman Partners Architects, LLC

WEDNESDAY | NOVEMBER 12

10:20 AM

Session 1 (CHOOSE ONE OF THE FOLLOWING SESSIONS)

📍 MANSHIP THEATRE

Rising Tides, Real Risks

Speakers will give federal and local updates on sea level rise, climate change, and how these are being incorporated into policy to impact our communities and the way we develop.

Robert R. Twilley, PhD Director of Louisiana Sea Grant College Program, LSU

Douglas Meffert, PhD VP and Executive Director of Louisiana, National Audubon Society

Andrea Cook, PhD Senior Manager, Education, Center for Sustainable Energy

MODERATOR: Camille Manning-Broome SVP of Planning + Implementation, CPEX

📍 HARTLEY/VEY STUDIO

Building Green Pays Off, But How Do You Pay for Green Buildings?

Sponsored by USGBC Louisiana

Attendees will hear about initiatives to grow sustainability natives, how occupants ultimately lead to the long-term success of smart buildings, and funds available for green building.

William B. Bradshaw, II President, Green Coast Enterprises

Z. Smith Principal, Director of Sustainability & Building Performance, ESKEW+DUMEZ+RIPPLE, APC

Robert Suggs AllianceNRG Solutions

James M. Gariepy Vice President, Energy Efficiency Services, Leidos

MODERATOR: Shannon Stage Executive Director, USGBC Louisiana

📍 HARTLEY/VEY WORKSHOP

Main Streets: Revitalizing Communities and Corridors

For many communities, change is being made from within. Attendees will hear about transformations occurring in Louisiana towns and cities, the people who are making it happen, the creative steps they're taking to do so, and the tools they're using. Projects highlighted include the ReFresh Project in New Orleans and other Louisiana Main Street programs.

Jeffery Schwartz Executive Director, Broad Community Connections

Michael C. Ince Special Projects Administrator/Main Street Manager, City of Kenner Planning Dept.

MODERATOR: James Andermann Real Estate Director, EBR Redevelopment Authority



11:45 AM

Lunch Session

**YOU CAN
PURCHASE
A TICKET
FOR THIS
SESSION AT
THE FRONT
TABLE, IF
AVAILABLE.**

Lunch is
provided by
Fresh Junkie.

📍 MANSHIP THEATRE

Planning for Boom Without Bust: Communities Embracing Economic Growth

Sponsored by CSRS, Inc.

Proactive planning strategies can make communities more resilient in minimizing, preparing for and surviving the impacts of substantial economic growth – and reducing the impacts on local economies, infrastructure, and quality of life. As case studies, we will explore how the North Dakota, Huntsville, and Lake Charles communities have planned for the impact as a result of the industrialization and population boom. We will discuss the findings of the Lake Charles regional impact study and strategies for overcoming the challenges ahead for the River Region between Baton Rouge and New Orleans amidst the substantial economic growth on the near horizon.

Michael Songy President & CEO, CSRS, Inc.

MODERATOR: Jessica Kemp, PhD Vice President of Policy + Advocacy, CPEX

WEDNESDAY | NOVEMBER 12

1:20 PM

Session 2 (CHOOSE ONE OF THE FOLLOWING SESSIONS)

📍 MANSHIP THEATRE

Boom Along the River Region: The Path Forward?

This panel will discuss the implications of the unprecedented industrial expansion combined with a surge in coastal protection and restoration activity, and specifically what this means for the River Region. How are our communities planning for the investments announced throughout the River Region, both short and long term, so that we don't find ourselves in a boom and then a bust?

James C. Setze Executive Director, Capital Region Planning Commission

Eric Kalivoda, PhD Deputy Secretary, Louisiana Department of Transportation and Development

Kristin Gisleson Palmer Chair, Louisiana Super Region Rail Authority

Tom Yura Senior Vice President and General Manager, BASF Corporation - Geismar

Donna Fraiche Member, Coalition for Coastal Resilience and Economy

Travis Woodard Project Manager for the Southwest Louisiana Regional Impact Study, CSRS, Inc.

MODERATOR: Jessica Kemp, PhD VP of Policy + Advocacy, Center for Planning Excellence

📍 HARTLEY/VEY STUDIO

Knowing Your Water Systems

Attendees will gain a better understanding of how to use science and technology to help planning and decision making for surface and groundwater. Speakers will delve into groundwater consumption and how we are managing water rights from a state perspective, rule of capture, and the relationship between runoff and recharge of the aquifer.

A. Hays Town, Jr. President, Baton Rouge Citizens to Save Our Water

Bryan Piazza Director of Freshwater and Marine Science, The Nature Conservancy's Louisiana Chapter

MODERATOR: Christopher Dalbom Program Manager, Tulane Institute on Water Resources Law and Policy

📍 HARTLEY/VEY WORKSHOP

How Healthy is Your ZIP Code? Planning for Healthy Communities

Sponsored by Blue Cross and Blue Shield of Louisiana

If we really want to affect the health of our community, whether measured in rankings or health outcomes, we have to take into account the environmental and social determinants of health. Making health a part of the conversation and consideration when we plan new neighborhoods, redevelop spaces, design public transportation, and chart the future of education will be vital to improving the overall health of our community.

Birgitta Baker, PhD Associate Professor, School of Kinesiology, LSU

Mary Ellen Brown Research Associate, Office of Social Service Research and Development, LSU

Christy O. Reeves Executive Director, Blue Cross and Blue Shield of Louisiana Foundation

Sanjay Kharod Executive Director, New Orleans Food & Farm Network

Cleve Hardman Director of Outdoor Recreation, Louisiana Office of State Parks

Juan Cruz Independent Public Health Planner, Bike Baton Rouge/Gardere Initiative

MODERATOR: Andy Allen Community Outreach Coordinator, Office of the Mayor-President; City of Baton Rouge, Parish of East Baton Rouge



2:35 PM

Session 3 (CHOOSE ONE OF THE FOLLOWING SESSIONS)

📍 MANSHIP THEATRE

From Medical Corridor to Health District: Institutions Working Together

Attendees will learn about the importance of synergies between medical institutions, hearing about the Baton Rouge Health District, efforts underway in New Orleans, and the Buffalo Niagara Medical Campus. When anchor institutions work together, they improve efficiency, coordinate investment decisions for land-use and transportation, provide a platform for community health initiatives, and combine diverse strengths. A unified health district enables local providers to leverage assets to compete with other medical centers and cities nationwide.

Matthew Enstice President /CEO, Buffalo Niagara Medical Campus, Inc. (Via video)

David Green Principal, Perkins + Will

Melissa Ehlinger Interim President & CEO, New Orleans Business Alliance

MODERATOR: John Spain Executive Director, Baton Rouge Area Foundation

📍 HARTLEY/VEY STUDIO

Case Studies: Real Estate and Financing Tools

Case studies will be presented on recent mixed-use housing projects at a variety of scales and with various uses, how they were financed, partners needed, lessons learned, challenges, and ultimately, how it was implemented.

Kathy Laborde President, Gulf Coast Housing Partnership

Samuel Sanders Executive Director, Mid City Redevelopment Alliance

Michael Airhart Executive Director, East Baton Rouge Mortgage Finance Authority (Invited)

MODERATOR: Brian Andrews Assistant Director, Real Estate Research Institute, E.J. Ourso School of Business, LSU

📍 HARTLEY/VEY WORKSHOP

Achieving a Strong Code on Any Budget

This session will present the Louisiana Land Use Toolkit, a model development code (zoning and subdivision regulations) steeped in smart growth principles. It was created so that local governments in Louisiana could download the Toolkit, tailor it to meet their local conditions, and apply the results to guide future growth in a sustainable manner. The session will also look at the implementation of the Toolkit in Vernon Parish and the University Parkway Economic Development District.

Jeannette Dubinin Project Manager, Center for Planning Excellence

Lauren Marschall Community Planner, Center for Planning Excellence

Janet Tharp Director of Planning, Center for Planning Excellence

MODERATOR: Jay Noland Attorney/Developer, Noland Developments, LLC

CLE

1.25
HOUR

CLE

1.25
HOUR

WEDNESDAY | NOVEMBER 12

4:30 PM

Urban Land Institute Walking Tour

📍 MEET IN THE JONES WALKER FOYER

Urban Land Institute (ULI) Louisiana will be leading a walking tour of downtown Baton Rouge as a wrap-up event to the 2014 Louisiana Smart Growth Summit. The tour will start at 4:30 pm from the Shaw Center for the Arts and will take a look at a number of new developments, including the Onyx Residences, 440 on Third, and the IBM building among others. The event is free for ULI members and \$10 for non-members and will culminate with networking and cocktails, generously sponsored by Iberia Bank.

Visit louisiana.uli.org/ for more information.



CONTINUING EDUCATION

At this year's Summit, we are pleased to offer continuing education credits for practitioners of various professions. Please visit the continuing education table in the lobby to sign in. If you have specific questions about the reporting requirements, please contact your professional organization. A certificate of attendance will be sent/emailed to you after the Summit.

Architects:

Self-reported

Engineers (PDH):

Self-reported

Landscape Architects:

Self-reported

LEED Professionals:

Self-reported

Planners (AICP CM):

Self-reported

Attorneys (CLE):

7.41 hours available

Must sign in at each session and return sign-in sheets to the CPEX representative in the session.

Course number: 7482141111



Envision a more livable Louisiana.

Become a member
of CPEX to help create
a better quality of life
in our state.

cpex.org/membership

Thank you to all of our generous 2014 Smart Growth Summit sponsors.

SILVER SPONSORS



BRONZE SPONSORS

Republic Finance | Whitney Bank | HNTB Corporation | Whole Foods Market
 New Orleans Redevelopment Authority | American Traffic Solutions
 Baton Rouge Metropolitan Airport | Gulf Coast Housing Partnership
 Downtown Business Association of Baton Rouge | Kimley-Horn | Forum 35

SUPPORTERS

The Water Institute of the Gulf | Dean Kenneth Schwartz, FAIA and the Tulane School of Architecture
 Citizens Bank & Trust Co. | LSU AgCenter | LUBA Workers' Comp | Donnie Jarreau Real Estate | Sierra Club
 Hannis T. Bourgeois, LLP, CPAs | Franklin Associates, LLC | WHLC Architecture | Chenevert Architects
 Bradley-Blewster & Associates | TOPCOR Companies, LLC | Terracon | American Planning Association, Louisiana Chapter

Thank you to all of our generous 2014 Smart Growth Summit sponsors.

EVENT SPONSOR



BlueCross BlueShield of Louisiana

An independent licensee of the Blue Cross
and Blue Shield Association.

PLATINUM SPONSORS



RAIN WATER
CONSULTING

GOLD SPONSORS

