

Sewcial Bee Sampler

sharon holland and
Maureen Cracknell →→→

#5 JULY FOURTH

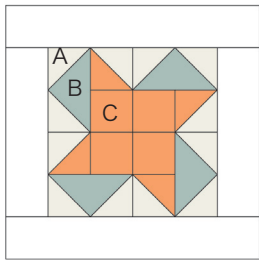

Material List

- (6) 2-7/8" squares fabric A
- (1) 5-1/4" square fabric B
- (2) 2-7/8" squares and (4) 2-1/2" squares fabric C
- (2) 2-1/2" x 12-1/2" rectangles and (2) 2-1/2" x 8-1/2" rectangles for frame

Read through all instructions before beginning. Remove selvages. Sew pieces right sides together and use a 1/4" seam throughout unless otherwise stated.

Flying Geese Units

1. Draw a diagonal line on the wrong side of (4) 2-7/8" fabric A squares.

2. Place a marked A square right sides together on the corner of the 5-1/4" fabric B square. In the same manner, place another marked A square in the opposite corner as shown.

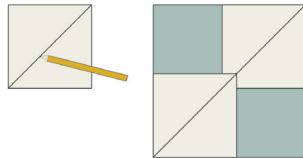

3. Sew a 1/4" seam on each side of the drawn line. Cut apart on the line. Open and press. Makes 2 Flying Geese sections.

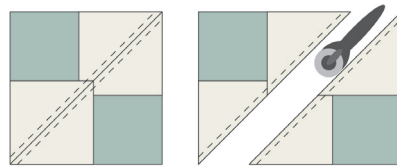

4. Noting orientation of the drawn line, place a marked A square right side together on the fabric B corner of one Flying Geese section as shown. Sew a 1/4" seam on each side of the drawn line. Cut apart on the line to make 2 Flying Geese

units. Open and press. Repeat step 4 with the remaining section for a total of 4.

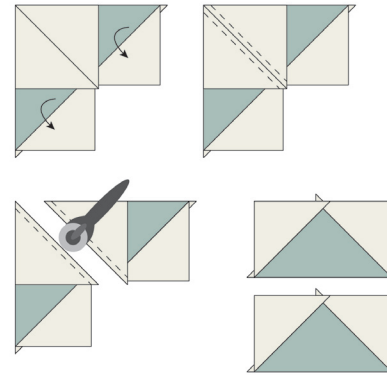

Half-Square Triangles

Draw a diagonal line on the wrong side of both 2-7/8" fabric A squares. Place a marked square right sides together with a 2-7/8" fabric C square. Sew a 1/4" seam on each side of the drawn line. Cut apart on the line. Makes 2 half-square triangle (HST) units. Make a total of 4 HST units.

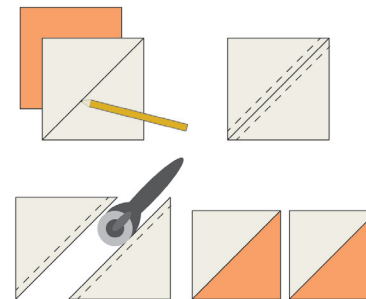

Block Assembly

1. Noting placement and orientation, sew 1 Flying Geese unit, 1 HST unit and (1) 2-1/2" fabric

C square together as shown in the Block Assembly Diagram to make 1 section. Make a total of 4 sections.

2. Noting placement and orientation, sew the sections into 2 rows of 2 sections each. Join the rows to make the block.

3. Stitch the (2) 2-1/2" x 8-1/2" framing strips to opposite sides of the block. Stitch the (2) 2-1/2" x 12-1/2" framing strips to the remaining sides of the block.

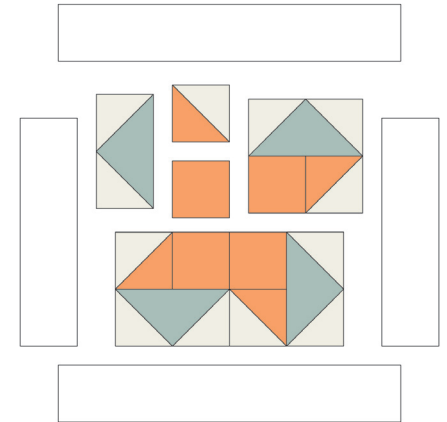

Block Assembly Diagram

Copyright

For personal use only. Reproduction of any part of this pattern in any way whatsoever without written permission is strictly prohibited. If this design is used in a quilt for display, please credit "Sharon Holland" for the design. All rights reserved. ©2017 Sharon Holland For pattern support: contact@sharonhollanddesigns.com