

# Sewcial Bee Sampler

sharon holland and  
Maureen Cracknell →→→

## #6 THE SEASONS

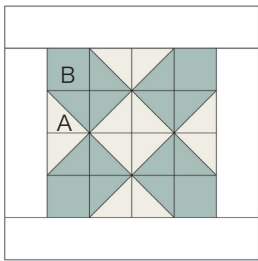

### Material List

- (6) 2-7/8" squares fabric A
- (6) 2-7/8" squares and (4) 2-1/2" squares fabric B
- (2) 2-1/2" x 12-1/2" rectangles and (2) 2-1/2" x 8-1/2" rectangles for frame

Read through all instructions before beginning. Remove selvages. Sew pieces right sides together and use a 1/4" seam throughout unless otherwise stated.

### Half-Square Triangles

1. Draw a diagonal line on the wrong side of each 2-7/8" fabric A square.

2. Place a marked 2-7/8" A square right sides together with a 2-7/8" fabric B square. Sew a 1/4" seam on each side of the drawn line. Cut apart on the line. Open and press. Makes 2 half-square triangle (HST) units. Make a total of 12 HST units.

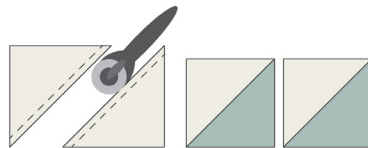
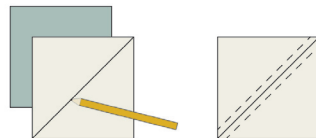

### Block Assembly

1. Noting placement and orientation, sew 3 HST units and (1) 2-1/2" fabric B square into 2 rows of 2 units/square each to make a section. Join the rows. Make a total of 4 sections.

2. Noting placement and orientation, sew the 4 sections into 2 rows of 2 sections each. Join the rows to make the block.

3. Stitch the (2) 2-1/2" x 8-1/2" framing strips to opposite sides of the block. Stitch the (2) 2-1/2" x 12-1/2" framing strips to the remaining sides of the block.

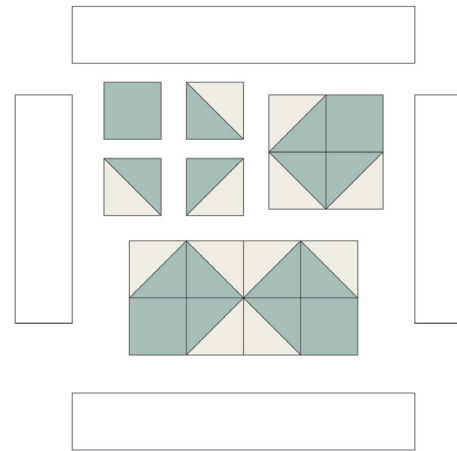

Block Assembly Diagram

Notes

### Copyright

For personal use only. Reproduction of any part of this pattern in any way whatsoever without written permission is strictly prohibited. If this design is used in a quilt for display, please credit "Sharon Holland" for the design. All rights reserved. ©2017 Sharon Holland For pattern support: contact@sharonhollanddesigns.com