

# Sewcial Bee Sampler

sharon holland and  
Maureen Cracknell →→→

## #7 DOVE IN THE WINDOW

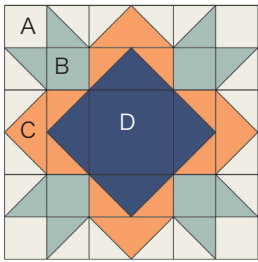

### Material List

- (1) 5-¾" square, (4) 2-⅞" squares, and (4) 2-½" squares fabric A
- (1) 5-¾" square and (4) 2-½" squares fabric B
- (1) 5-¼" square and (4) 2-⅞" squares fabric C
- (1) 5-¼" square and (1) 4-½" square fabric D

Read through all instructions before beginning. Remove selvages. Sew pieces right sides together and use a ¼" seam throughout unless otherwise stated.

### Half-Square Triangles

1. Draw a diagonal line on the wrong side of the 5-¾" light fabric A square. Draw another diagonal from the remaining corners.

2. Place the marked fabric A square right sides together with the 5-¾" fabric B square. Sew a ¼" seam on each side of the drawn line. In the same manner, stitch on each side of the remaining diagonal line.

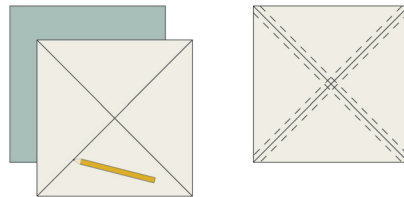

3. Align the short end of a ruler with the straight edge of the squares and the long side centered at the intersection of the diagonal lines. Cut the square in half, but leave the cut pieces in place. Without disturbing the shape of the original square, cut the square in half again in the same manner, dividing it into

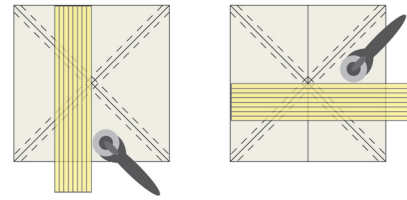

4. Cut the square quarter-sections apart on the drawn lines. Open and press. Trim dog ears. Makes 8 half-square triangle (HST) units.

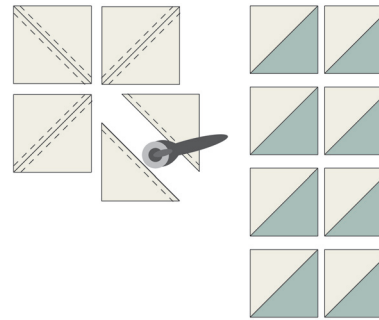

### Flying Geese Units

1. Draw a diagonal line on the wrong side of (4) 2-⅞" fabric A squares.

2. Place a marked A square right sides together on the corner of the 5-¼" fabric C square. In the same manner, place another marked A square in the opposite corner as shown.

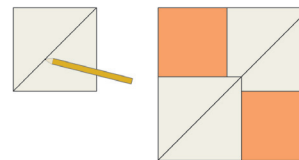

3. Sew a ¼" seam on each side of the drawn line. Cut apart on

the line. Open and press. Makes 2 Flying Geese sections.

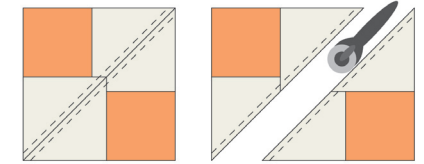

4. Noting orientation of the drawn line, place a marked A square right side together on the fabric C corner of one Flying Geese section as shown. Sew a ¼" seam on each side of the drawn line. Cut apart on the line to make 2 Flying Geese units. Open and press. Repeat step 4 with the remaining section for a total of 4 A/C combination Flying Geese units. Repeat Steps 1 through 4 to make 4 C/D combination Flying Geese units.

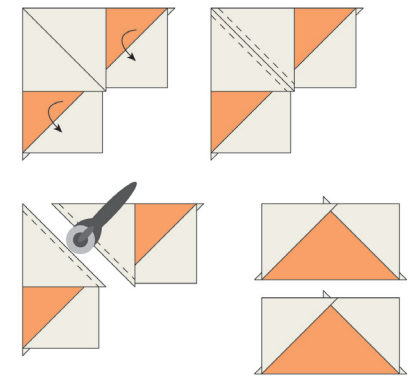

### Block Assembly

Referring to the Block Assembly Diagram on page 2, and noting placement and orientation, sew the units and pieces into 5 rows of 5 units/pieces each. Join the



Block of the Week Sew Along  
#SewcialBeeSampler

# Sewcial Bee Sampler

sharon holland and  
Maureen Cracknell >>>>

## #7 DOVE IN THE WINDOW Continued

rows to make the block. Note that this block finishes out to 12-1/2" (unfinished) square and doesn't require a frame. Suggestion: Make fabric A the same material as used for frames to unify the quilt blocks.

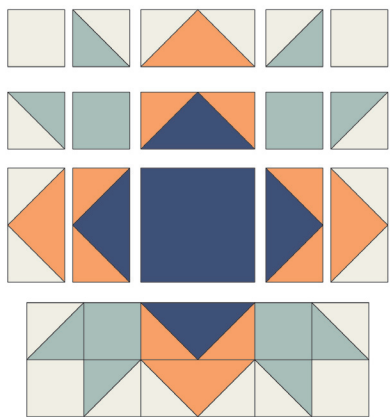

Block Assembly Diagram

Copyright  
For personal use only. Reproduction of any part of this pattern in any way whatsoever without written permission is strictly prohibited. If this design is used in a quilt for display, please credit "Sharon Holland" for the design. All rights reserved. ©2017 Sharon Holland For pattern support: [contact@sharonhollanddesigns.com](mailto:contact@sharonhollanddesigns.com)

Notes: