

Sewcial Bee Sampler

sharon holland and
Maureen Cracknell →→→

#16 KING'S CROWN

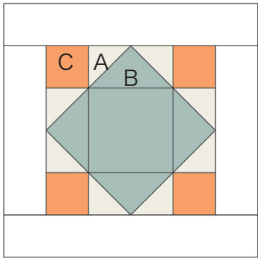

Material List

- (4) 2-7/8" squares fabric A
- (1) 5-1/4" square and (1) 4-1/2" square fabric B
- (4) 2-1/2" squares fabric C
- (2) 2-1/2" x 12-1/2" rectangles and (2) 2-1/2" x 8-1/2" rectangles for frame

Read through all instructions before beginning. Remove selvages. Sew pieces right sides together and use a 1/4" seam throughout unless otherwise stated.

Flying Geese Units

1. Draw a diagonal line on the

wrong side of the (4) 2-7/8" fabric A squares.

2. Place a marked A square right sides together on a corner of the 5-1/4" fabric B square. In the same manner, place another marked A square in the opposite corner as shown.

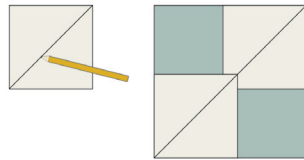

3. Sew a 1/4" seam on each side of the drawn line. Cut apart on the line. Open and press. Makes 2 Flying Geese sections.

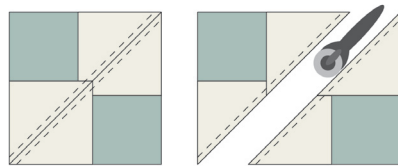

4. Noting orientation of the drawn line, place a marked A square right sides together on the fabric B corner of one Flying Geese section as shown. Sew a 1/4" seam on each

side of the drawn line. Cut apart on the line to make 2 Flying Geese units. Open and press. Repeat with the remaining section for a total of 4 Flying Geese units.

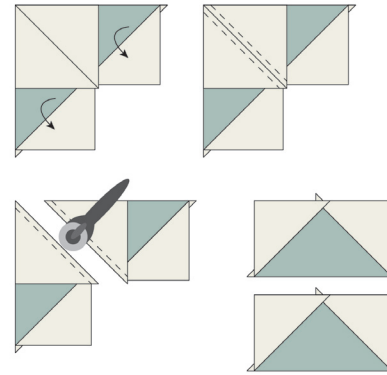

Block Assembly

1. Referring to the Block Assembly Diagram, and noting placement and orientation, sew the Flying Geese units and squares into 3 rows of 3 units/squares each as shown. Join the rows to make the block.

2. Stitch the (2) 2-1/2" x 8-1/2" framing strips to opposite sides of the block. Stitch the (2) 2-1/2" x 12-1/2" framing strips to the remaining sides of the block.

Copyright

For personal use only. Reproduction of any part of this pattern in any way whatsoever without written permission is strictly prohibited. If this design is used in a quilt for display, please credit "Sharon Holland" for the design. All rights reserved. ©2017 Sharon Holland For pattern support: contact@sharonhollanddesigns.com

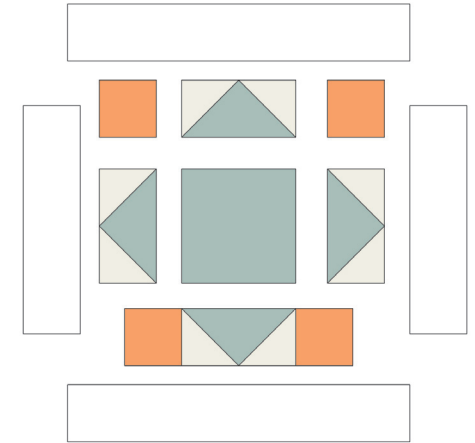

Block Assembly Diagram

Notes