

Ribbon Star

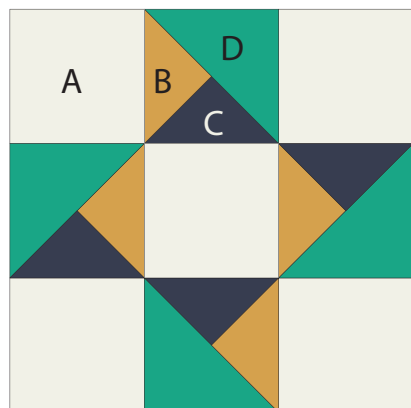

Triple-Square Triangle Units

1. Draw a diagonal line on the wrong side of a 6" fabric B square.

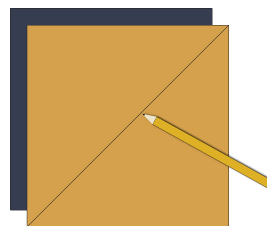

2. Place the marked square right sides together with the same-size fabric C square. Sew a 1/4" seam on each side of the drawn line. Cut apart on the line to make two Half-Square Triangle (HST) units. Trim units to 5" square. Make a total of two HST units.

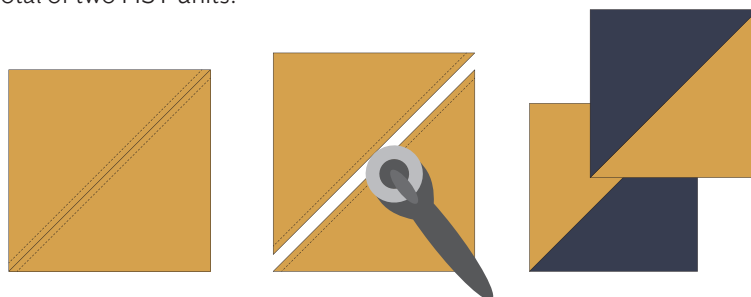

3. Draw a diagonal line on each of the 5" fabric D squares. Pair a 5" square with a HST unit right sides together and draw line perpendicular to the seam line of the HST. Sew a 1/4" seam on each side of the marked line. Cut apart on the line. Open and press. Makes two mirror image Triple-Square Triangle (TST) Units. Trim units to 4-1/2" square. Make a total of four TST units.

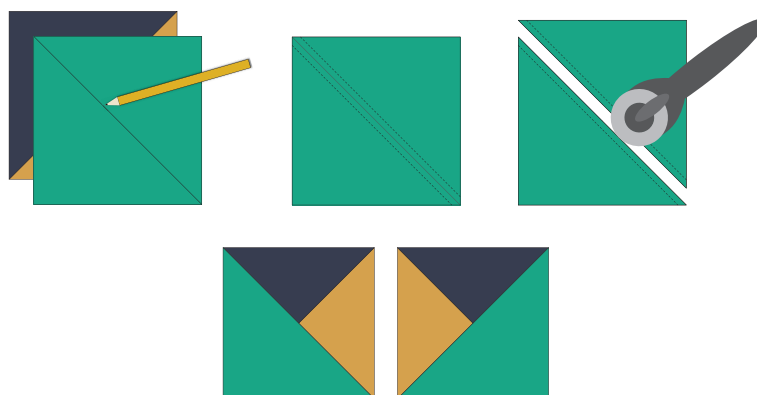

CUT

•Fabric A

» Five 4-1/2" squares

•Fabric B

» One 6" square

•Fabric C

» One 6" square

•Fabric D

» Two 5" squares

Read through all instructions before beginning. Remove selvages. Cut pieces exactly as listed in instructions. Sew pieces right sides together and use an accurate 1/4" seam allowance.



Ribbon Star Page 2



Notes

BLOCK ASSEMBLY

1. Referring to the Block Assembly Diagram and noting placement and orientation, sew one TST unit between two 4-1/2" fabric A squares to make an A row. Make a total of two A rows.

2. Sew a 4-1/2" fabric A square between two TST units to make a B row. Join the rows to make a block. Trim to 12-1/2" square.



Block Assembly Diagram

COPYRIGHT

For personal use only. Reproduction or distribution of any part of this pattern in any way whatsoever without written permission is strictly prohibited. If this design is used in a quilt for display, please credit, "Sharon Holland" for the design. All rights reserved. ©2018 Sharon Holland. For pattern support: contact@sharonhollanddesigns.com

