

Morning Star

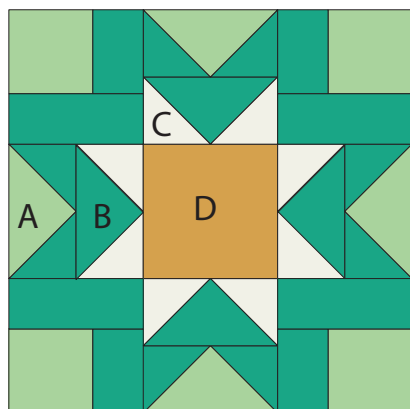

Read through all instructions before beginning. Remove selvages. Cut pieces exactly as listed in instructions. Sew pieces right sides together and use an accurate $\frac{1}{4}$ " seam allowance.

No-Waste Flying Geese Units

1. Draw a diagonal line on the wrong side of four $3\frac{1}{8}$ " fabric B squares. Place a marked square right sides together on the corner of the $5\frac{1}{2}$ " fabric A square. In the same manner, place another marked B square in the opposite corner, overlapping the squares in the center as shown.

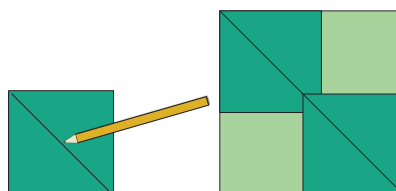

2. Sew a $\frac{1}{4}$ " seam on each side of the drawn line. Cut apart on the line. Open and press. Makes 2 Flying Geese sections.

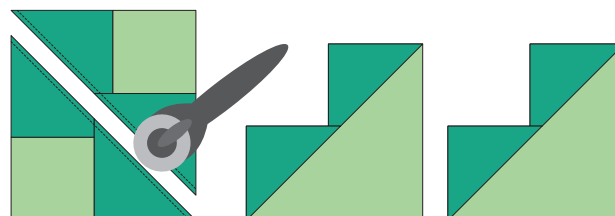

3. Noting orientation of the drawn line, place a marked B square right sides together on the fabric A corner of one Flying Geese section as shown. Sew a $\frac{1}{4}$ " seam on each side of the drawn line. Cut apart on the line to make two A/B Flying Geese units. Open and press. Trim units to measure $2\frac{1}{2}$ " x $4\frac{1}{2}$ ", leaving a $\frac{1}{4}$ " seam allowance on each side.

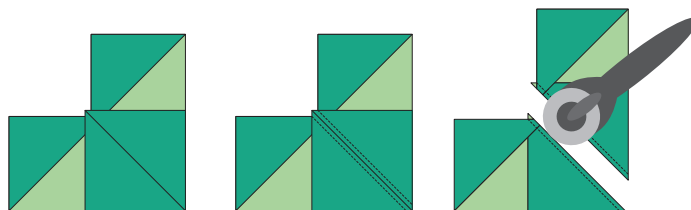

4. Repeat Step 3 with the remaining section for a total of four A/B Flying Geese units.

CUT

•Fabric A

- » One $5\frac{1}{2}$ " square
- » Four $3\frac{1}{8}$ " squares

•Fabric B

- » One $5\frac{1}{2}$ " square
- » Four $3\frac{1}{8}$ " squares
- » Four $2\frac{1}{2}$ " x $4\frac{1}{2}$ " rectangles
- » Four $2\frac{1}{2}$ " x $3\frac{1}{8}$ " rectangles

•Fabric C

- » Four $3\frac{1}{8}$ " squares

•Fabric D

- » One $4\frac{1}{2}$ " square

Morning Star Page 2



A/B

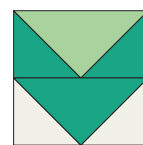

5. In the same manner as Steps 1 through 4, make a total of four B/C Flying Geese units.

B/C



Corner Units

1. Noting placement and orientation, sew one 2" x 3" fabric B rectangle to the right side of a 3" fabric A square.



2. Sew a 2" x 4-1/2" fabric B rectangle to the bottom of section as shown. Makes one Corner unit. Trim unit to 4-1/2" square. Make a total of two A Corner units.

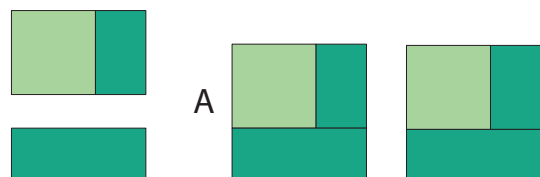

3. In the same manner as Steps 1 and 2 make a total of two mirror image B Corner units.

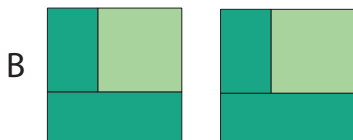

2. Referring to the Block Assembly Diagram and noting placement and orientation, sew one Flying Geese section between one each A and B Corner units to make an A row. Make a total of two A rows.

3. Sew the 4-1/2" fabric D square between two Flying Geese sections to make a B row.

4. Join the rows to make a block. Trim to 12-1/2" square.

A

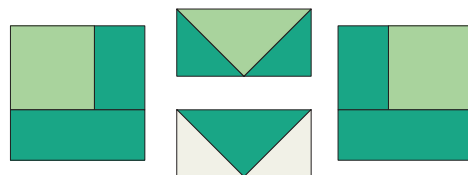

B

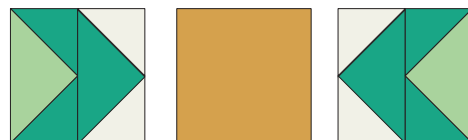

A

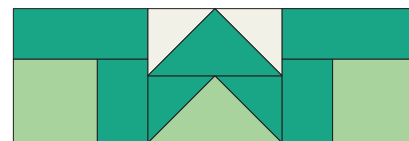

Block Assembly Diagram

BLOCK ASSEMBLY

1. Noting placement and orientation, sew an A/B Flying Geese unit to a B/C Flying Geese unit to make a Flying Geese section. Make a total of four Flying Geese sections.

COPYRIGHT

For personal use only. Reproduction or distribution of any part of this pattern in any way whatsoever without written permission is strictly prohibited. If this design is used in a quilt for display, please credit, "Sharon Holland" for the design. All rights reserved. ©2018 Sharon Holland. For pattern support: contact@sharonhollanddesigns.com