

New Four-Patch

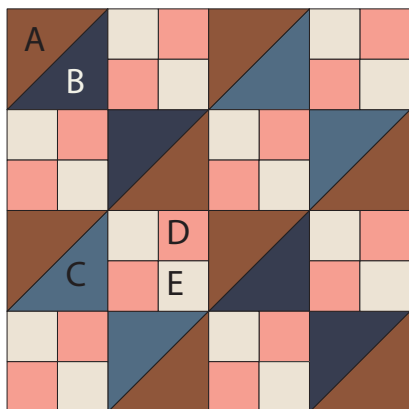

Half-Square Triangle Units

1. Draw a diagonal line on the wrong side of each 4" fabric A square. Place a marked square right sides together with a same-size fabric B square. Sew a ¼" seam on each side of the drawn line. Cut apart on the line to make two Half-Square Triangle (HST) units. Trim units to 3-½" square. Make a total of four A/B HST units.

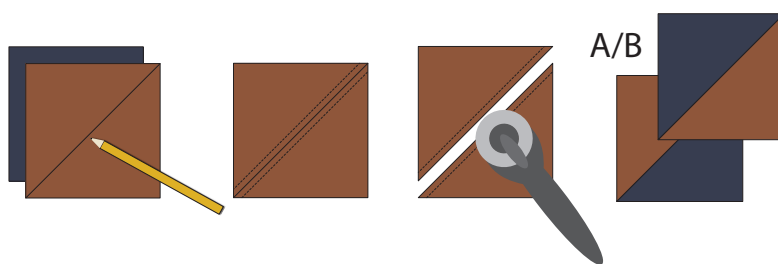

3. In the same manner as Steps 1 and 2, make a total of four A/C HST units.

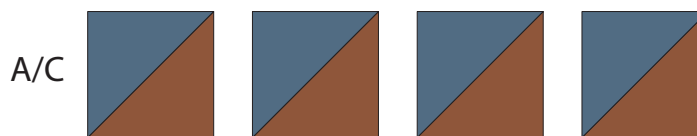

CUT

•Fabric A

» Four 4" squares

•Fabric B

» Two 4" squares

•Fabric C

» Two 4" squares

•Fabric D

» Sixteen 2" squares

•Fabric E

» Sixteen 2" squares

Four-Patch Units

1. Noting placement, sew two 2" fabric D squares and two 2" fabric E squares into two rows of two squares each. Join rows to make a Four-Patch unit that measures 3-½" square. Make a total of eight Four-Patch units.

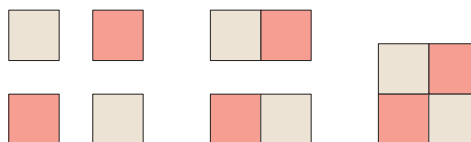

BLOCK ASSEMBLY

1. Referring to the Block Assembly Diagram on page 2 and noting placement and orientation, sew one A/B HST unit, one A/C HST unit, and two Four-Patch units to make an A row. Make two A rows. In the same manner, make two B rows.

2. Noting placement and orientation, join the row to make a block. Trim to 12-½" square.

Read through all instructions before beginning. Remove selvages. Cut pieces exactly as listed in instructions. Sew pieces right sides together and use an accurate ¼" seam allowance.



New Four-Patch

Page 2

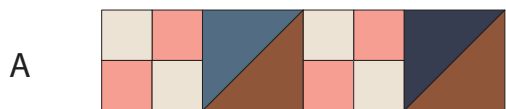
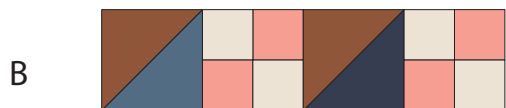
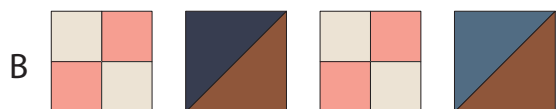
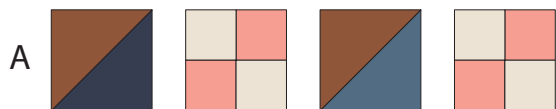

Block Assembly Diagram

Notes



COPYRIGHT

For personal use only. Reproduction or distribution of any part of this pattern in any way whatsoever without written permission is strictly prohibited. If this design is used in a quilt for display, please credit, "Sharon Holland" for the design. All rights reserved. ©2018 Sharon Holland. For pattern support: contact@sharonhollanddesigns.com