

Finishing

CUT

•Binding

- » Seven 2-¼" x 42" strips (or 294" total length) for quilt with borders (or Six 2-¼" x 42" strips (or 252" total length) for quilt without borders)

•Backing

- » 4 yards backing for quilt with borders (3-¼ yards for quilt without borders)

•Batting

- » 73" x 77-½" batting for quilt with borders (57" x 65-½" for quilt without borders)

Read through all instructions before beginning. Remove selvages. Cut pieces exactly as listed in instructions. Sew pieces right sides together and use an accurate ¼" seam allowance unless otherwise stated.

QUILT

1. Cut and piece the backing to measure 73" x 77-½" for quilt with borders or 57" x 65-½" for quilt without borders using a ½" seam allowance.

2. Press the seam(s) open to reduce bulk. Press the quilt top and backing well. On a large flat surface, layer the backing wrong side up, the batting with edges matching the backing, and the quilt top centered right side up. Baste the layers together.

3. Quilt as desired.

BIND

1. To make the double-fold binding, place (2) 2-¼" x 42" strips right sides together at right angles. Sew with a diagonal seam. Continue adding strips in the same manner to make one long binding strip. Trim seams to ¼". Press seams open.

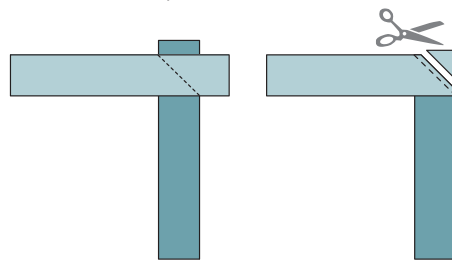

2. Fold the strip lengthwise in half with wrong sides together and press. Starting at the center of one edge of the quilt top, place the folded binding on the right side of the top with raw edges aligned.

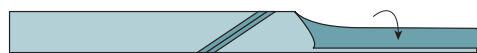

3. Leaving 12" of the binding strip free, begin stitching with a ¼" seam allowance. Sew to the corner and backstitch ¼" from the edge. Remove the quilt from the machine. Fold the strip up at a 45° angle and then back down over itself, lining up the raw edges to make a mitered corner. Resume stitching, beginning at the top edge of the new side and continuing around the quilt to the next corner. In the same manner as Step 2, sew to the corner and backstitch, remove the quilt from the machine, fold the strip, then continue around the quilt to within 12" of the starting point; backstitch. Remove the quilt from the machine. See illustrations on page 2.

4. Lay the quilt top on a flat surface. Bring the loose ends of the binding together so the binding and the quilt lie flat. Fold the binding ends back onto themselves so the folded edges touch but do not overlap; finger press to crease. Open the binding. Place the strips at right angles right sides together using the creases to align the strips as

Finishing Page 2



indicated in the diagram by white dashed lines. Pin the ends together as shown. Draw a diagonal line from the corner intersections. Sew on the line. Before trimming the seam allowance, refold the binding and check that it lies flat on the quilt top. Adjust the stitching if needed; check and trim seam allowance to $\frac{1}{4}$ " when satisfied. Pin the binding down and sew to the remaining edge of the quilt top.

5. Trim the backing and batting even with the quilt top. Turn the binding to the back of the quilt and blind stitch by hand or machine stitch to finish.

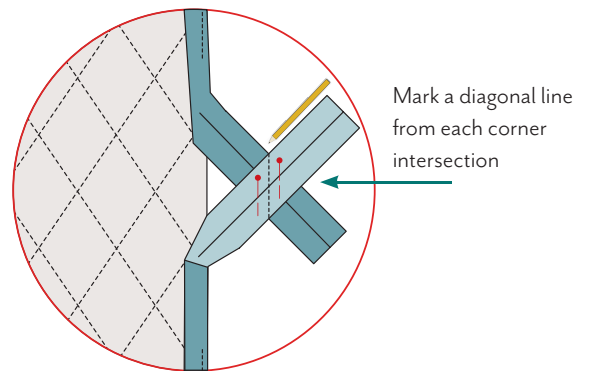
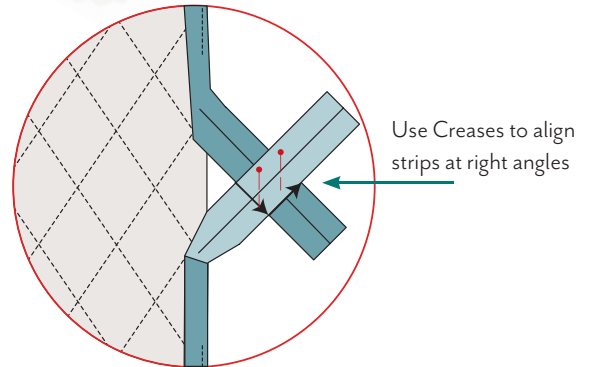
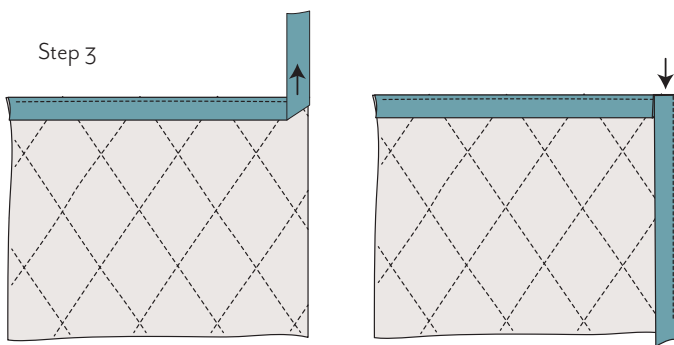

Step 4

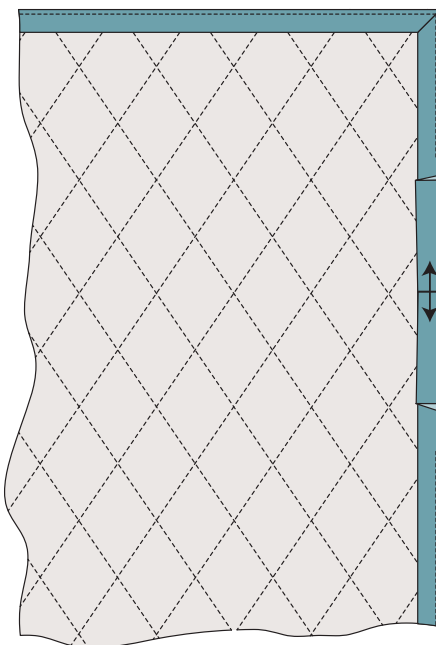

Fold binding ends back onto themselves with folded edges touching

*You did it,
congratulations!*

Be sure to share a photo of your make and use the hashtag #communitysampler

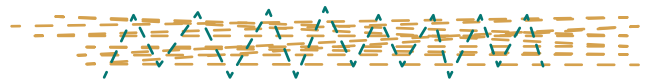

COPYRIGHT

For personal use only. Reproduction of any part of this pattern in any way whatsoever without written permission is strictly prohibited. If this design is used in a quilt for display, please credit "Sharon Holland" for the design. All rights reserved. ©2018 Sharon Holland. For pattern support: contact@sharonhollanddesigns.com