

Access Covers and Gratings

PAMREX & REXUS Manhole Covers/Bedding and Installation Instructions

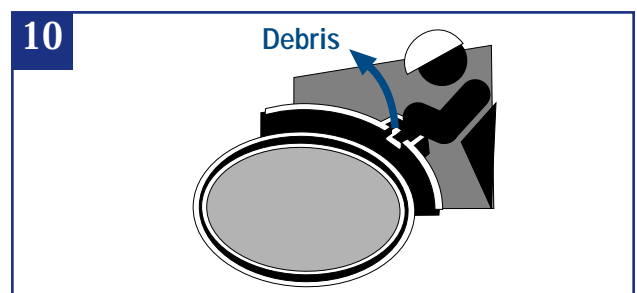
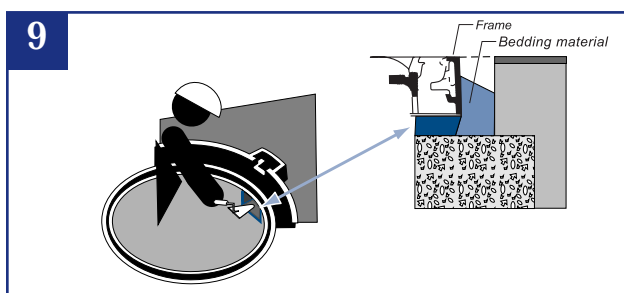
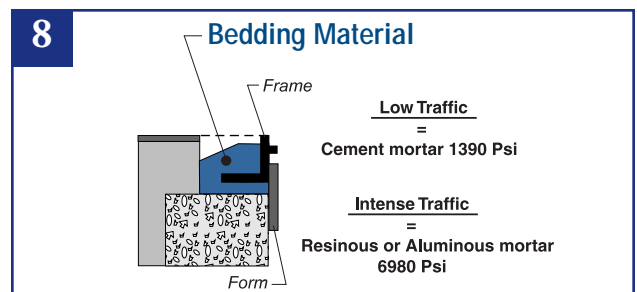
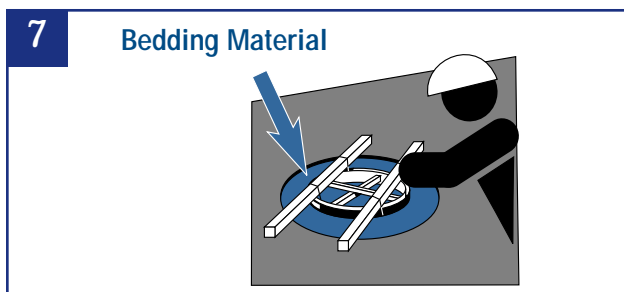
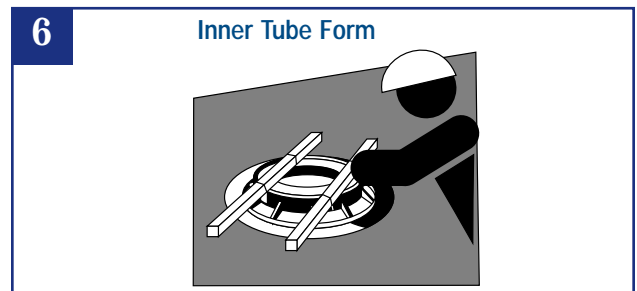
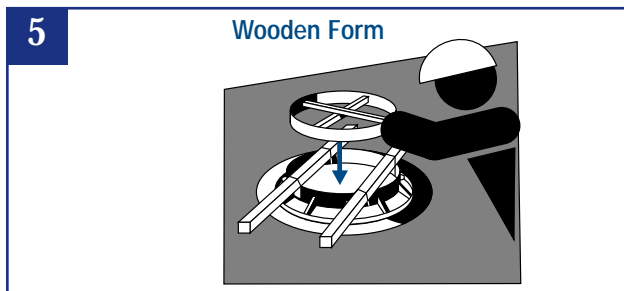
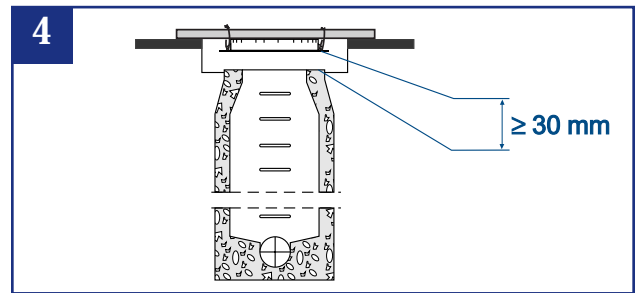
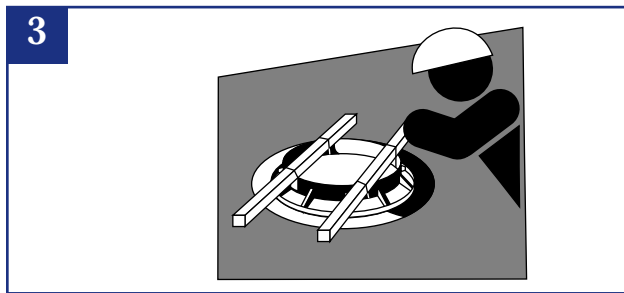
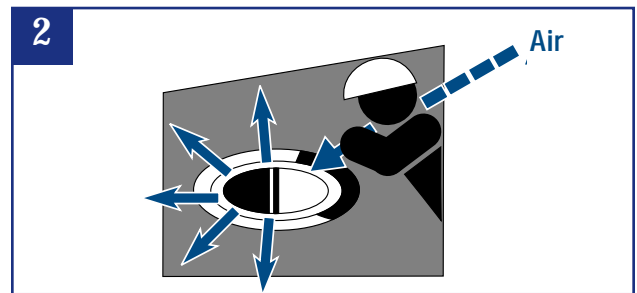
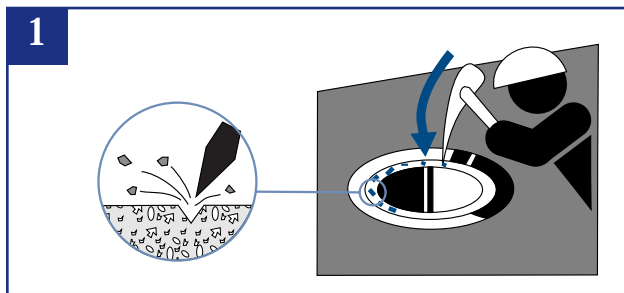

General Recommendations

The following recommendations specific to PAM products are not meant to replace local safety or installation practices. CertainTeed cannot be held responsible for any malfunctioning or failure of its products when guidelines below are not followed.

- Specify appropriate bedding mortar, depending on site conditions and allocated time for installation before resumption of traffic flow.
- Check that frame is dimensionally compatible with the concrete/masonry structure for sufficient load bearing.
- Ensure the top chamber surfaces are clean and in good repair, as good bearing surfaces are required for all municipal castings.
- Make sure that slotted frames are completely filled in with mortar for efficient interaction between iron and structure.
- Check that bedding mortar is not in contact with either hinge housing or elastomer gasket. Make sure:
 - When using resin mortar, the concrete surface is totally dry before spreading mortar.
 - Elastomer plugs installed inside PAMREX frame hinge boxes are properly placed.
 - Hinge, locking devices, gaskets and contact surfaces are cleaned before operation and resumption of traffic flow.
 - Anti-theft REXUS spline is activated and prevents cover from being removed.
 - Frame and cover are flush with road surface after installation.



For more information contact:

- Your authorized PAM Access Covers and Gratings distributor.
- U.S. headquarters: 877.351.3323; fax 877.351.3320.
- Or visit www.certainteed-pamcovers.com.

CertainTeed 

© 03/06 CertainTeed Corporation CTPAM-0029-.5M-SGCS-SO