

A VITAL LINK

EXPANDING TRANSPORTATION CAPACITY ACROSS THE HUDSON



CrossRail Studio | Final Review

PennDesign | May 6, 2015

Instructors: Dean Marilyn Taylor & Professor Robert Yaro



INTRODUCTION

Global Investments in Infrastructure

- Large-scale **\$23 billion** project
- **Increases rail capacity** by 10% in Greater London
- Brings **+1.5 million** people within a **45-minute** commute to Central London



INTRODUCTION

Made in **New York** and **New Jersey**, Inspired by **London**



FOCUS STATIONS

Why Meadowlands South & Long Island City?

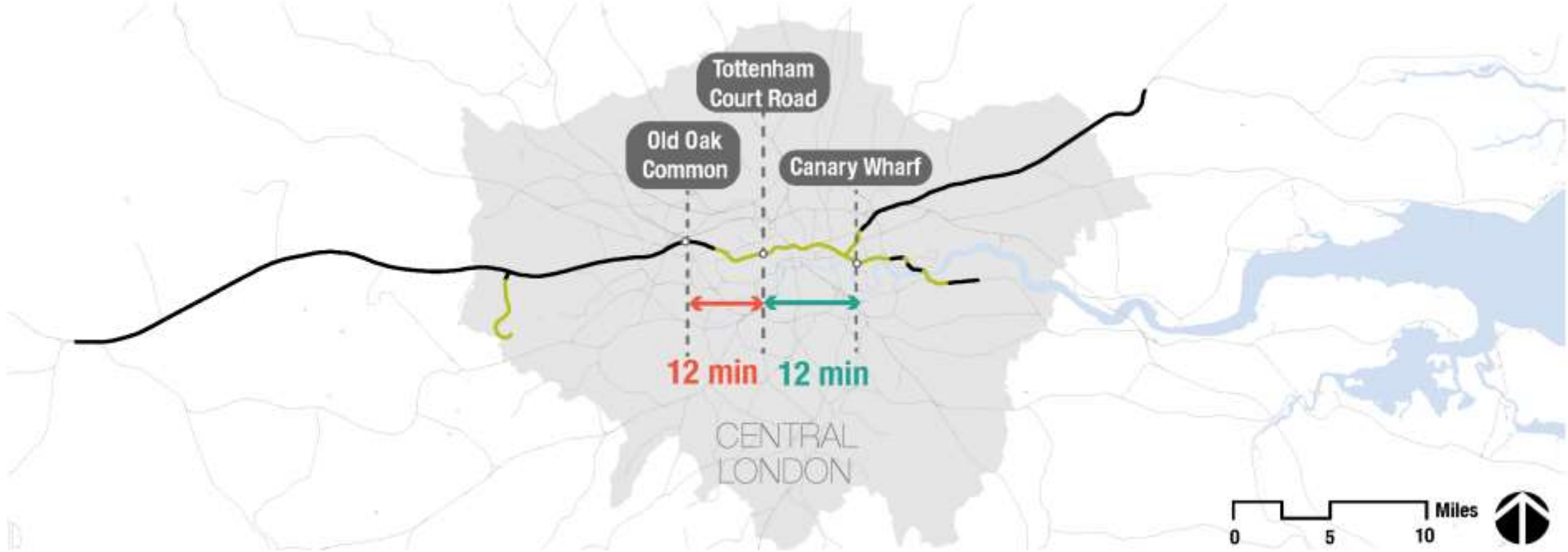

STATION DEVELOPMENT VISION

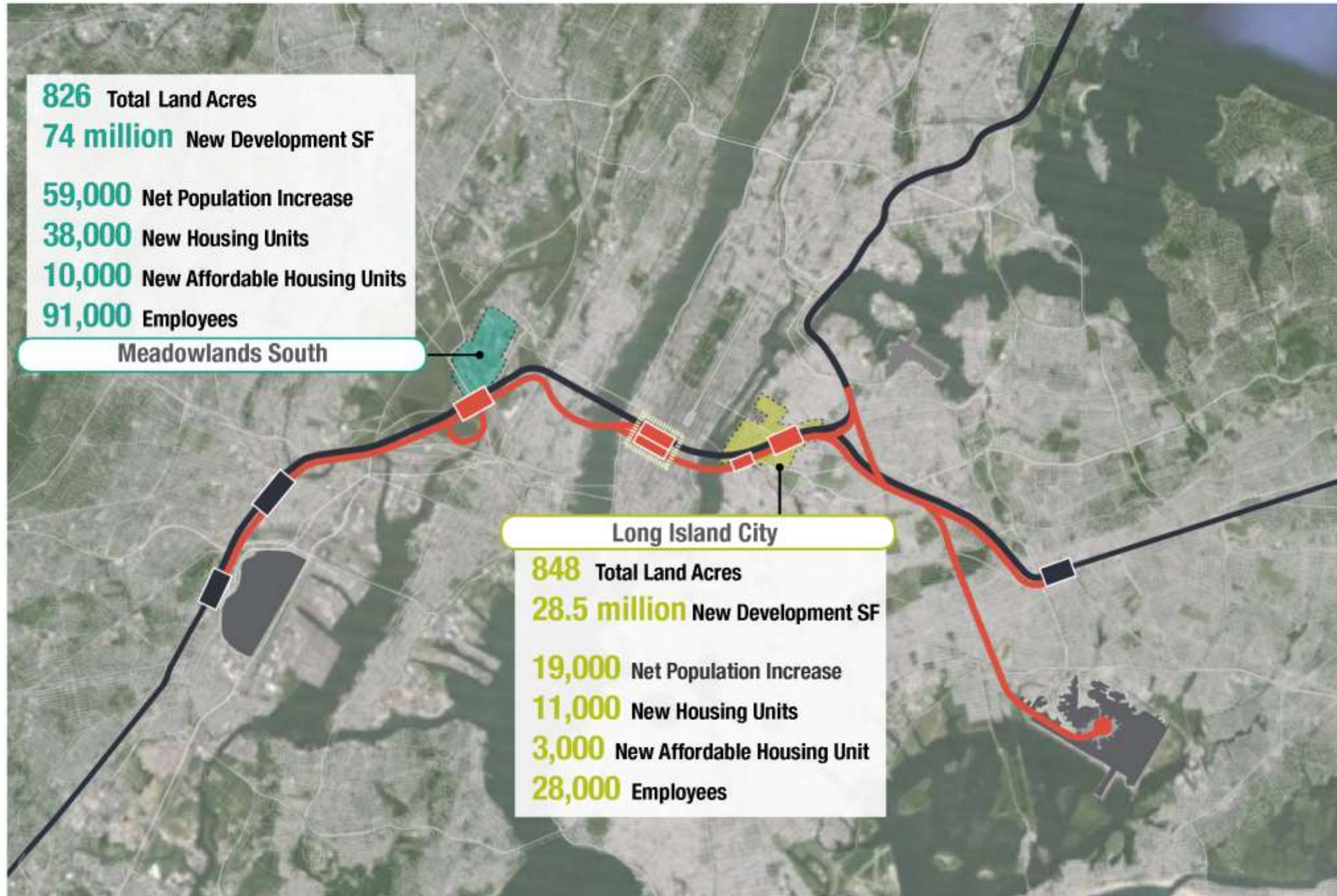

MEADOWLANDS SOUTH DEVELOPMENT
Vision of Meadowlands South Station Area

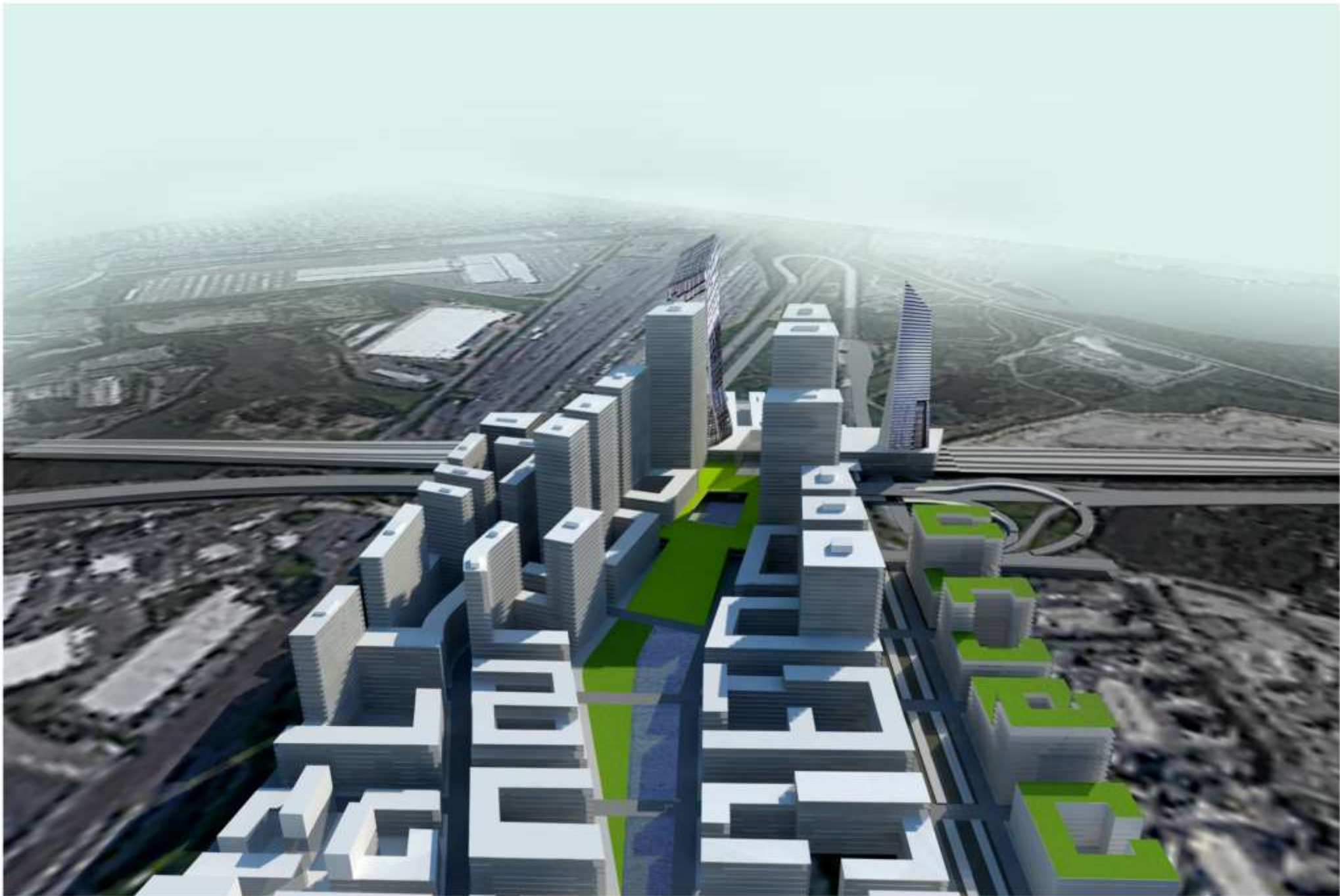

TRANSPORT FOR GROWTH

Regional rail **ridership** will exceed **1 million per day** with the NY-NJ CrossRail

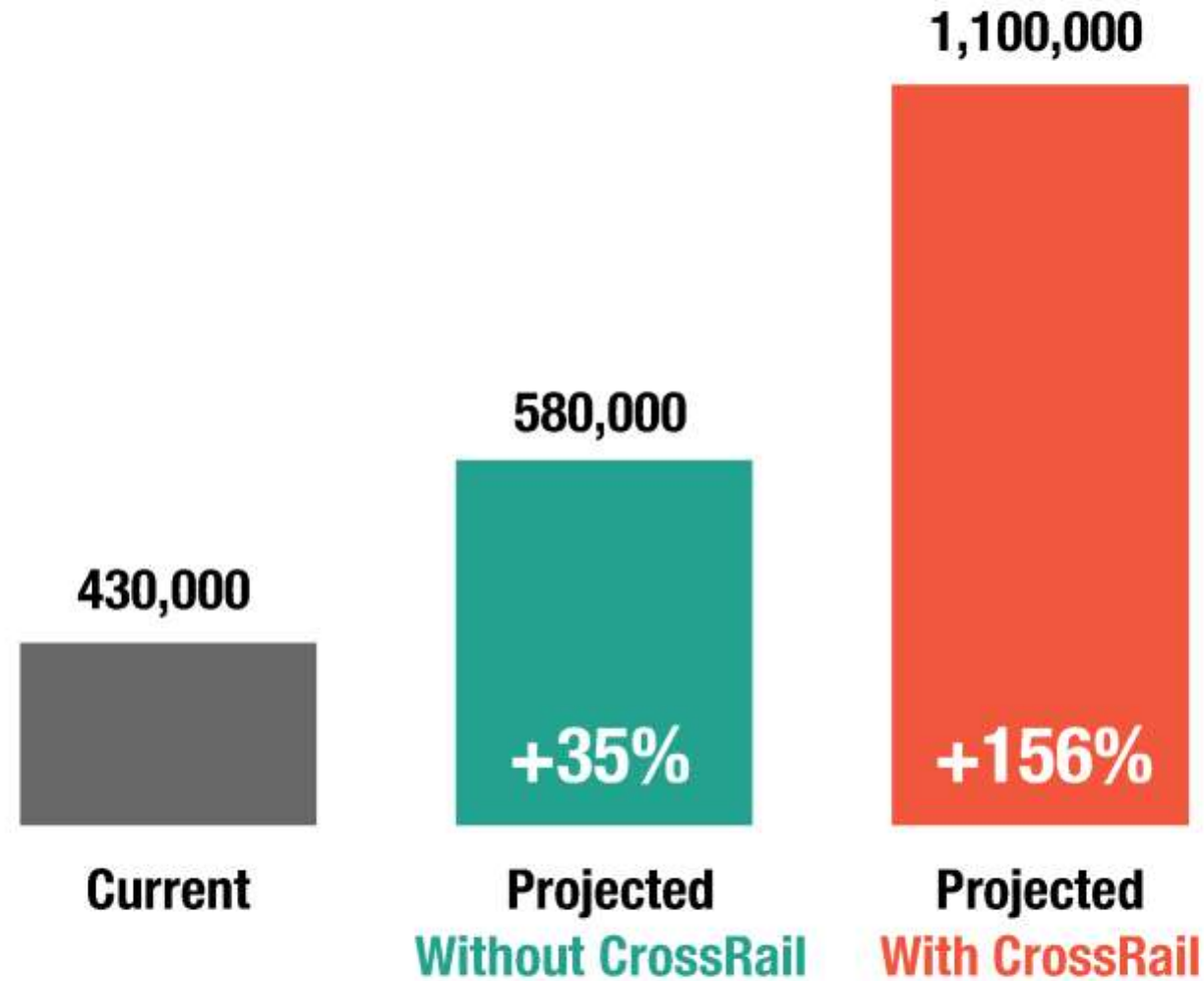

Ridership Projections on New Jersey Transit,
Long Island Railroad, and Metro North

CREATING AND CAPTURING VALUE

Long Island City

State and Local Tax Revenue Impact

\$3 billion Income Tax Gain

\$0.5 billion Sales Tax Gain

\$38 billion Property Tax Gain

\$41.5 billion Total Tax Gain

Note: NPV of Recurring Revenue over 45 years, using a 4.5% discount rate

Meadowlands South, NJ

State and Local Tax Revenue Impact

\$3 billion Income Tax Gain

\$1 billion Sales Tax Gain

\$17 billion Property Tax Gain

\$21 billion Total Tax Gain

Note: NPV of Recurring Revenue over 45 years, using a 4.5% discount rate



30%

Percentage of Tax Gain to fund NY-NJ CrossRail Project



30%

FINANCING STRATEGY
Case Study: London Crossrail - \$23 billion Project

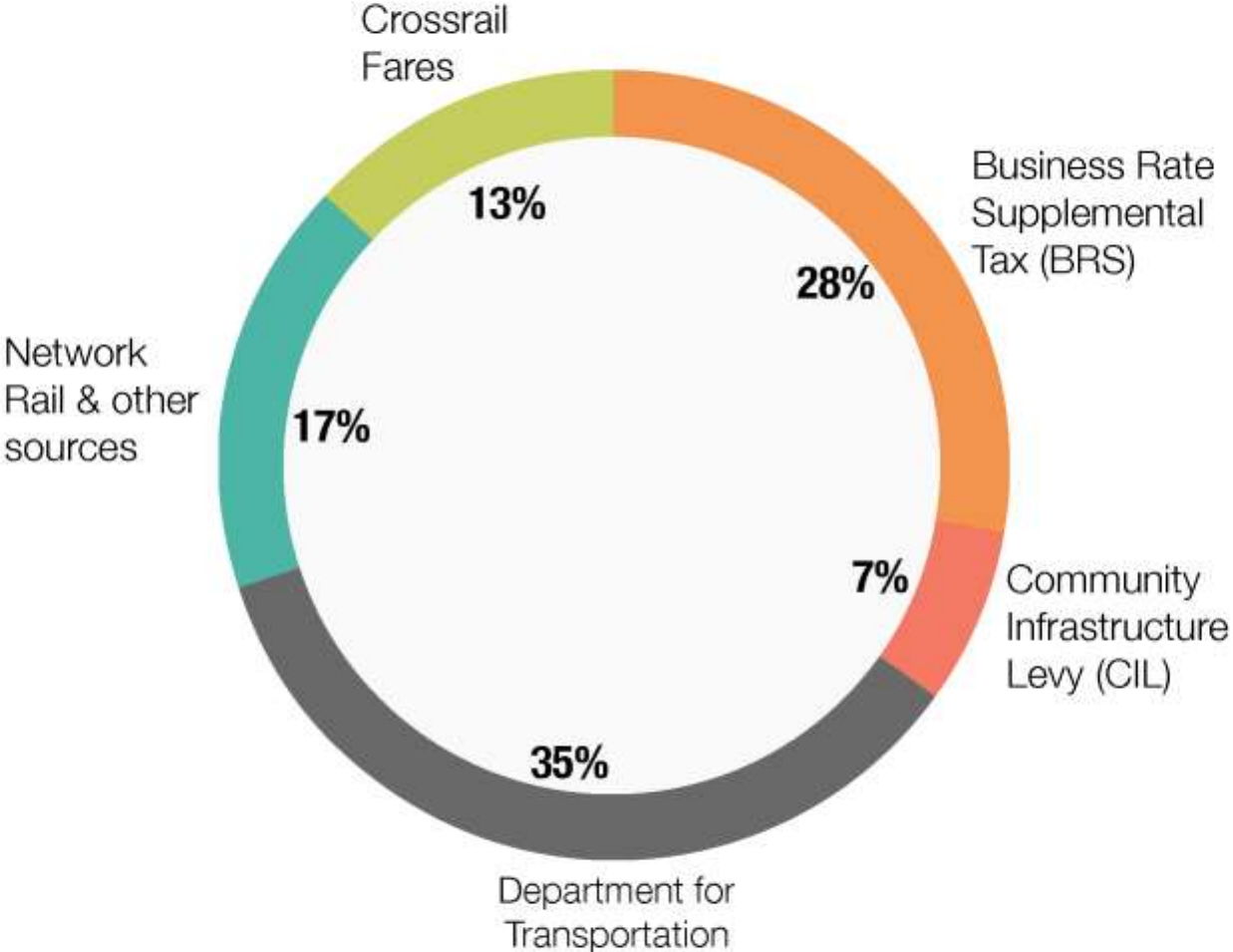

FINANCING STRATEGY
NY-NJ CrossRail - \$45 billion Project

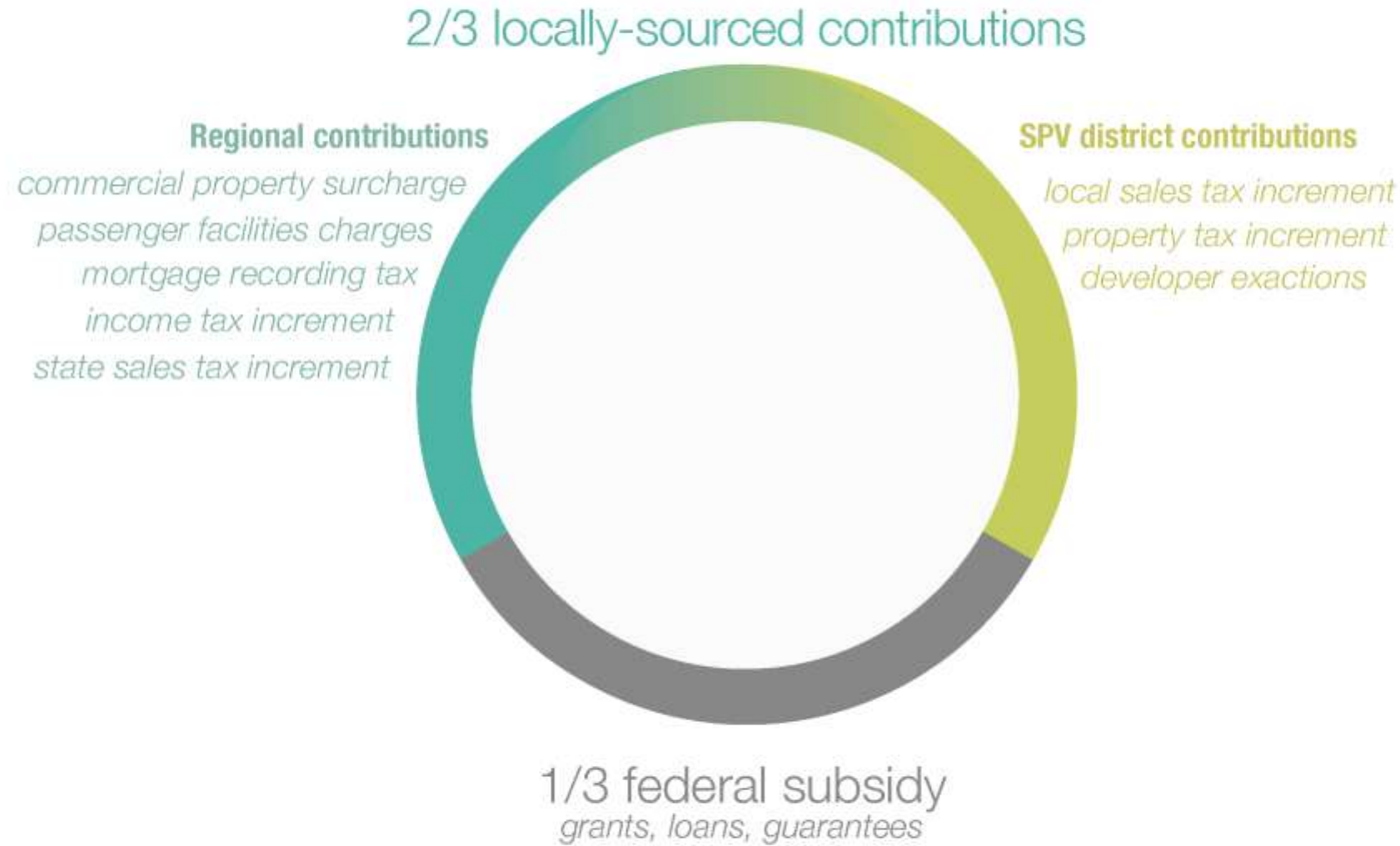

A VITAL LINK

EXPANDING TRANSPORTATION CAPACITY ACROSS THE HUDSON

