

EXTENSION 1

'NOW OUR HOME IS FILLED WITH LIGHT'

Rearranging the interior layout of Lee and Elise Spaventa's house in Hertfordshire has created the perfect family space



AFTER



↑ FLUSH FIT

Appliances were built into the wall to ensure an uncluttered look

← GOOD LINK

Two sets of doors give access to the decked area and garden beyond

→ HOME HUB

The former kitchen used to be closed off from the rest of the house and was never a social room, but this new bright and spacious zone is in constant use



STYLING TIP

The key to successful Scandi interiors is using natural, understated materials. Wood finishes throughout this room add texture and create a uniform look



BEFORE

EXTENSION DETAILS

HOMEOWNERS

Lee Spaventa, who works in finance, and his wife Elise, a full-time mum

AGES Both 39

FAMILY Daughters Rosa, 4, and Lilia, 8

LOCATION Bishop's Stortford, Hertfordshire

PROPERTY

Nineties four-bedroom detached house

COST OF NEW EXTENSION

Demolition	£12,650
Building works	£38,885
Doors & windows	£15,720
Joinery & decoration	£5,245
Kitchen	£30,800
Wood flooring	£14,560
Professional fees	£7,480
Furniture	£6,838
Lighting	£2,140

TOTAL £134,318

PROJECT BRIEF

To replace the existing cramped layout with a larger room, which would house the kitchen and dining area, and lead to the garden. The WC also needed a refit

→ VIEW THE FLOORPLAN

Removing the conservatory at the back of the house meant the property could be extended and rooms knocked together to create an open-plan space on the ground floor. One of the bedrooms above the old conservatory was also made bigger

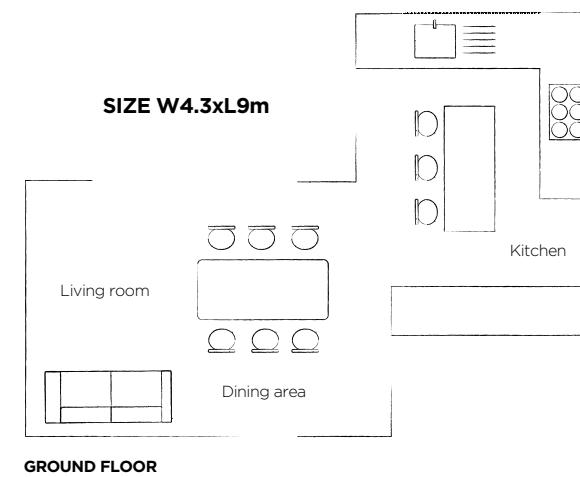

The bright, open-plan room to the rear of the Spaventa family's home is a far cry from the boxy, closed-off layout that once existed. Lee and Elise have lived in the property for a decade and decided it was time for a change two years ago. 'We'd learned a lot about the house over the years. We knew what worked and what didn't,' explains Lee. 'There was a big chunk at the back that we didn't use. We wanted to open it up and create something that led out to the garden and had lots of glazing to bring in light.'

The couple planned to come up with a design that would allow for a small extension to the first floor, too, so they could expand one of the bedrooms. Although Lee and Elise had a clear idea of what they hoped to achieve, they needed professional guidance to help them translate their dreams into a reality. 'I approached three firms to discuss the project with,' says Lee. 'They all had good ideas, but when ▶



'We love the room's stylish, cohesive finish'

← **DANISH DESIGN**

Scandi pieces include the Snowball light by Poul Henningsen and table and chairs by Hans J Wegner

↓ **FRESH LOOK**

The WC adjoining the dining area was fitted with new sanitaryware

STOCKISTS
Turn to
page 181



Ian Harvey from Harvey Norman Architects visited us I knew he was ideal for the job as his plan was spot on.'

Ian drew up an elegant layout that was influenced by Lee's love of Scandinavian design. The old conservatory was removed and the house extended out to cover its footprint. 'The goal was to maximise light and space,' says Ian. 'The interior was redesigned to create a new open-plan family living area, dining room and kitchen. We also refitted the WC and relocated the study.'

Removing the internal walls has created a smooth flow between the various zones. Bi-fold doors to the rear, in addition to a set of French doors, mean the interiors can flow seamlessly out to the patio.

The Spaventas originally struggled to find the right builder for the project, and ended up turning to Ian for advice. He recommended a firm that was happy to stick to the couple's guidelines and requirements, and was able to keep to the budget. The building work ran

smoothly and the couple were delighted with the workmanship from all the specialists they employed. 'Our engineered oak flooring, bought from and fitted by Floors of Old, is excellent,' says Lee. 'We often get comments on how perfectly it has been laid.'

Having been left uninspired by many high-street companies, Lee and Elise came across specialist firm Tomas Kitchen Living. Lee was instantly drawn to the chic, clean lines of the units, as well as the creativity and attitude of designer Tomas. 'He was fantastic and worked with our architect to ensure that we could create the space we wanted,' says Lee. 'He was really excited about the project, and was eager to produce something that suited our tastes and practical requirements.'

The mixture of a central island, plenty of storage cabinets and flush built-in appliances provide a sleek and tidy aesthetic. The cool blue shade selected for the low-level kitchen units works perfectly with the white decor and natural wood floor, and complements the Danish furniture that's used throughout the space. 'Tomas helped us to select key items for our home from Carl Hansen, so we have some really great pieces from classic Scandi designers,' says Lee. 'We love the effect this has on the room, and it means we have a stylish and cohesive finish overall.'

Now that the project is complete, Lee, Elise and their two girls adore the new space. The family can spend all their time together, whatever they're doing, thanks to the size of the room that's been created. 'I can relax with Elise or cook and we can still interact with the girls playing outside or in the living area,' says Lee. 'In fact, we have a separate living space that we just don't use as we're always in here together.'

Things we love

■ **Full-height glazing** from Klöeber was installed in the new kitchen-diner, which faces east, allowing sunlight to flood in every morning.

■ **Clean lines** - we're big fans of relaxed and unfussy design. Scandi style really suits us and the cool colours we chose throughout complement this.

■ **Access to the garden** has been improved - now that we can throw open the bi-fold doors, the house is immediately connected to the outside space. The seamless flow means we use the garden much more, which the kids adore.

PHOTOGRAPHS HARVEY NORMAN ARCHITECTS FEATURE ANNA-MARIE DESOUZA

SHOPPING LIST

DOORS Three-panel bi-fold doors in anthracite grey, £5,000, Klöeber **KITCHEN** Natural Sheer cabinetry in Waterwheel light blue, quartz worksurfaces and integrated Siemens appliances, £30,800, all Tomas Kitchen Living **FLOORING** Engineered oak flooring, £14,560, Floors of Old **FURNITURE** CH006 dining table in oak with an oil finish, £2,940; CH33 dining chairs in oak with leather seats, £512 each, all Carl Hansen. Strum tables, £950 for a set of three; Erik Buch bar stools, £450 each, all Tomas Kitchen Living **LIGHTING** Poul Henningsen Snowball light, £1,510; Toldbod pendant lights, £210 each, all Carl Hansen