

TALENT WATCH

A brief to revamp two rooms developed into a complete makeover when the owners of this Melbourne home hired a multiskilled interior designer.

STORY JUDY OSTERGAARD | STYLING JO McCOMISKEY
PHOTOGRAPHY DEREK SWALWELL



New cabinetry and cornices in the informal living area helped smarten up this 1940s home. Sofas from Jardan. Coffee table from Cavendish Furniture. Ottomans from Lounge Designer Furniture. Tray and jug from Maple Homewares. Artwork by Kim Kennedy (left) and Herman Pekel. **OPPOSITE** Floor-to-ceiling windows in the living space provide a gorgeous view to the pergola. Dining setting from Jati Furniture. Lanterns from Monte Bello Emporium. **For Where to Buy, see page 236.**



‘Contemporary colours help to create a sense of flow from the informal living and kitchen spaces to the outside.’ HOMEOWNER

Architect Peter Barton added the full-length windows to the informal living space to visually merge it with the outdoors. Table and chairs from Gaudion Furniture. Vase from Maple Homewares. **OPPOSITE** Designed by Atticus & Milo, the capacious cabinetry was made by Cook & Nation. For Where to Buy, see page 236.



When the owners of this inner-Melbourne home approached interior designer Caecilia Potter of Atticus & Milo, it was with the intention of simply updating soft furnishings in the formal rooms. As it became apparent that a far bigger job was required, Caecilia rose to the task. Her eye for proportion and balance, knowledge of architecture and construction, as well as project-management skills meant the owners could remain relaxed as the project grew in scope.

“We bought the house about 10 years ago and it’s been great for our family as our kids grew from their early teenage years to young adulthood here,” says the owner. “It was built in the post-Depression era of the early 1940s and was good and solid, though plain, with none of the flourishes and elegance that most of the other houses in the neighbourhood have.”

Caecilia’s first assessment of the four-bedroom, two-storey house was that although it had lovely large rooms and good light, the architectural detailing was rather stingy. As for the decor, the owners told her they were keen to hold on to their antiques but willing to jettison other pieces that didn’t suit the house.

“I was originally called in to update the decor in the front living and dining rooms,” says Caecilia. “The owner wanted these rooms to have lots of her >



GROL

FIRST FLOOR

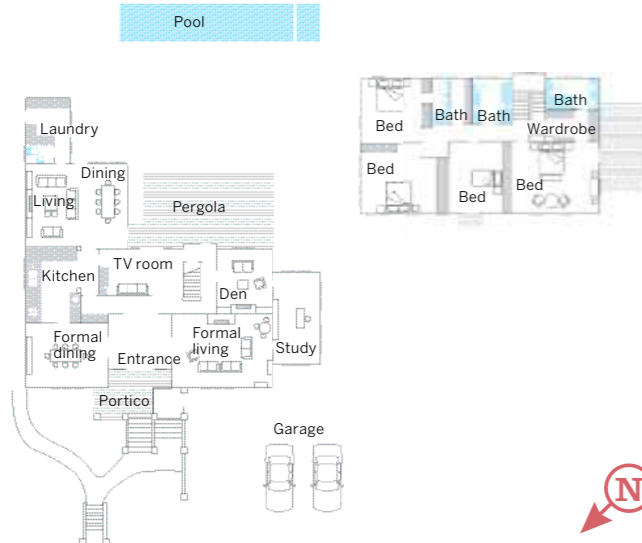

ABOVE Sandberg Carl Gustaf striped wallpaper enhances the proportions of the formal living room. Sofas and ottoman from Colby Furniture. Colourburst carpet in 47 Steel from Feltex Carpets. Artwork by Maxwell Wilks. **OPPOSITE** For the main bedroom, Atticus & Milo designed gorgeous cushions in Romo fabrics with Nina Campbell trims. **For Where to Buy, see page 236.**

< favourite colour, which is cerulean blue, and a hint of English style, without being overly formal.”

To make these facing rooms and the entrance hall between them seem more welcoming and open, Caecilia suggested replacing the doorways with handmade sets of timber double doors. An archway in the hall was raised, making the space look grander and more generous. New timber flooring was laid on the ground floor and elegant cornices, skirtings and architraves have been added throughout.

As one thing led to another, the firm ended up working on the interiors of the entire house. This included the selection of finishes and fittings for spaces that had recently been renovated by architect Peter Barton. Still on the to-do list was a kitchen redesign, which Atticus & Milo also took on.

“We retained the columns leading into the kitchen as they were structural and would have been very expensive to remove,” says Caecilia. “A key improvement was to insert a long, sliding glass window as the main splashback, creating an open, airy feel.”

The finished interiors are a handsome blend of form and function. Beyond the front rooms, a study, den, TV room, kitchen and casual living/dining space wrap around an outdoor terrace. Upstairs are four bedrooms, two with ensuites, and a chic family bathroom. >

Love your home

Stripes, in differing widths, are a masterstroke in this home. The walls of the formal living and dining rooms and the main bedroom upstairs were finished with Swedish wallpapers in blue and cream stripes. In the downstairs rooms the stripes are subtly wider, to correct the proportions of these large, wide spaces and make the ceiling appear higher. “The paper was also a clever way to hide walls that were uneven and rough,” the owner says.



H&G houses

Colour palette



Heritage Paints Kirklands
(bathroom)

Add a dash of...



Dulux Noblesse



Wattyl Moraine Lake



Wattyl Fifi

Accents of soft blue,
blush and chocolate add
a subtle feminine touch.



< An earthy, neutral scheme was chosen for the kitchen, family room and meals area, while the formal rooms and main bedroom wear classic striped wallpapers. The floorboards are warm, weathered tallowwood, recycled from Melbourne's Mount Waverley football stadium. In the kitchen, a honed Calacatta marble benchtop introduces its own pattern and texture, and will develop a striking patina over time.

The final stage was a complete makeover of the facade and gardens. New terraces and a portico were created for the steep front garden, as well as a rendered masonry fence that acts as a retaining wall and transforms the front elevation. Landscaping firm The Garden Company devised a richly layered planting scheme, including a gorgeous heritage rose, 'Pierre de Ronsard', that climbs over the portico and softens the facade.

Caecilia's influence is strongly felt outside, too, especially in the wrought-iron pergola she designed for the terrace. Hung with lanterns and covered in wisteria, it has become a prime spot for summer meals and one of many design highlights for the owner. "Every change we made has been rewarding," she says. "The house has a serene feeling that starts at the front gate and extends to the back fence." **H&G Atticus & Milo, Hawthorn, Victoria; (03) 9882 0088 or www.atticusmilo.com.au.**



Paint colours are reproduced as accurately as printing processes will allow.

This is the life

The romantic wrought-iron pergola over the rear terrace, adjacent to the casual family living area, really comes into its own during the warmer months, according to the owner. "We spend as much time as possible under its canopy," she says. "By day it provides plenty of welcome shade and at night it becomes an outdoor dining room with great atmosphere when softly lit by garden lights."



Wisteria winds around the pretty ironwork pergola, crafted by Alpha Wrought Iron. Vase and green bowls from Town & Country Gardens. **OPPOSITE TOP** Shutters give extra privacy in the family bathroom. Tiles from Alan Patrick. **OPPOSITE BOTTOM** The walk-in wardrobe offers an elegant place in which to ponder dressing decisions. Atticus & Milo had the owner's slipper chair reupholstered in a Voghi cotton-linen weave. Carpet from SuperTuft. Smock from Mienne. For Where to Buy, see page 236.