

Best Perf

MODEL

P-22

Perforated doors offer maximum protection while still maintaining visibility. The perforated design allows for a fully enclosed opening that is ideal for street facing store fronts with valuable products.

LISTINGS

Meets and exceeds visibility code requirements.

SPECIFICATIONS

CURTAIN

- A. Perforation available in Square or Round pattern design.
- B. Pattern is available in Regular or Micro-Perforations.

SLATS

- A. Manufactured from 2.5" wide metal slats roll formed to interlace together to create a continuous steel curtain.
- B. Also available in 1.5" wide for counter shutter applications or to meet astringently small headroom requirements.

OPERATION

- Motor, Chain, Hand-Crank or Push-Up operation available based on size, weight or frequency of operation.
- Battery backup available to ensure operation in the event of power failure or blackout.

MATERIALS & FINISHES

- Exterior skin is available in 24, 22, 20, 18 and 16 gauge. Gauge is typically determined by door size, consult factory.
- Typical finish is Galvanized Steel. Curtains common exterior finishes for steel slats include White, Black and Bronze. Aluminum slats common finishes includes Mill and Clear Anodized.
- Additional options include: Copper, Stainless Steel, Galvalume, Prime Painted Galvanized & Powder Coated.

GUIDE & TRACK CONFIGURATIONS

- Guides and tracks can be combined in a series of ways to accommodate side-rooms requirements. F-guide, Z-guide, E-guide, Pack-out can be provided either welded or bolted.
- For interior applications behind wall, typical 3 in. x 3 in. steel tubes are used for mounting supports.



BOTTOM BAR

- Bottom Bar options include: Single Angle, Double Angle, Tubular (extruded alum.) or "T" Aluminum bottom bar.
- Bottom Bars have typical Mill Finish. Additional options: Clear Anodized, Brass, Copper, Galvanized, Stainless Steel, Hot Rolled Steel, Powder Coated, Paint.

LOCKING

- A. Chain Operation: Wall mounted chain keeper or zinc plated steel slide bolt with padlock provisions.
- B. Push-Up or Hand-Crank Operation: Slidelocks, Round Locks or Cylinder Locks for locking at bottom bar (bottom bar design effects locking option available).
- C. Motor Operator: No additional locking required as motor has automatic feature to prevent door from being lifted. Additional locking mechanisms include Slidelocks, Round Locks or Cylinder Locks for locking at bottom bar (bottom bar design effects locking option available).

HOODS & COVERS

- Hoods are typically furnished if the coil is exposed. If provided, hoods are typical Steel Galvanized Finish. Additional Finish Options: Brass, Copper, Stainless Steel, Galvalume, Prime Painted, and Powder Coated
- Standard shape is round cover. Options for square or hexagonal hood upon request.
- Additional covers can be provided for all exposed mechanical parts (motors, chain mechanism, etc.) to accommodate for weather intrusion, security protection and aesthetics.

CONTACT US

Best Rolling Manufacturer, Inc. P: 305-698-3550
9780 NW 79 Avenue F: 305-698-3552
Hialeah Gardens, FL 33016 www.bestdoor.us

Best Perf

Details - Components Breakdown Model - Coiling Security Doors

PARTS & ACCESSORIES

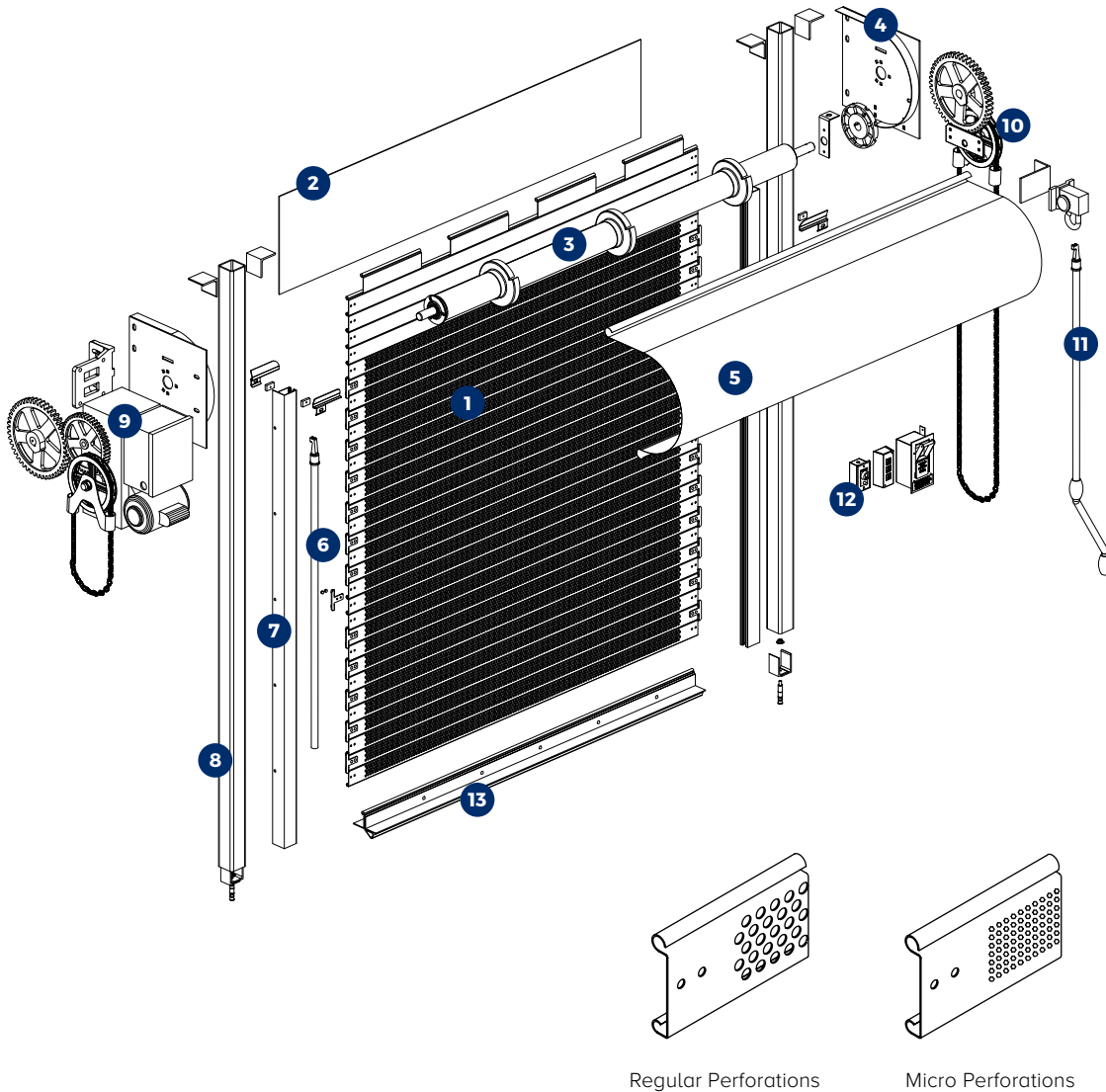

COMPONENTS

1. **CURTAIN** Available in regular or micro perforations Both options in accordance with NYC visibility code requirements.
2. **FASCIA** Optional for installations with no header to cover exposed coil.
3. **TORSION-SPRING PIPE ASSEMBLY**
4. **HEADPLATE** Size varies based on door dimensions.
5. **COVER** Standard round shape, Supplied when coil is exposed.
6. **PUSHUP OPERATION** Pull hook provided.
7. **GUIDES** Additional types and configurations available based on job type.
8. **STEEL TUBE SUPPORTS** Provided for installation when there is no jamb.
9. **MOTOR OPERATION** Additional types and configurations available based on job type.
10. **CHAIN OPERATION** Allow for minimum 5.0" sideroom clearance.
11. **CRANK OPERATION** Allow for minimum 2.0" sideroom clearance.
12. **OPERATION ACCESSORIES** Additional accessories and finishes available.
13. **BOTTOM BAR** Additional types, finishes and locking options available.

COMMON FINISHES

Steel Slats:



Galvanized



White



Black



Bronze

Aluminum Slats:



Mill



Clear Anodized

Consult for availability. Painted and Powder Coated colors available upon request.