

Best Perf

MODEL

Side Folding Gates

Security While Maintaining an Open Appearance

Retractable Protection and Visible Appeal - This attractive, perforated model combines the transparency of glass with the strength of aluminum for good-looking protection. It can be used in many settings including schools, food fairs, stadiums, restaurants, hospitals, warehouses, etc.

SPECIFICATIONS

CURTAIN

The top and bottom of each section is fitted with an aluminum panel 4" high (102mm). This panel consists of an aluminum extrusion 1/16" (1,6mm) thick and composed of modules with a 15° angle between them to facilitate the operation of the closure. The curtain is constructed of 6" (152mm) wide modules linked together by a continuous aluminum hinge. These hinges hold steel perforated panels with 3/16" (5mm) diameter holes providing a 51% visibility and ventilation through the panels.

LOCKING

- A. Lead post shall be equipped with a 7-pin Master-Keyable cylinder lock.
- B. Lead post shall engage a full height wall jamb.
- C. Trailing post shall be self-locking at the top and bottom inside the storage pocket.
- D. Free floating intermediate posts shall be located at all curves and at recommended intervals of 10 feet (3m) or 5 feet (1,5m) for counter top units. Intermediate posts shall be equipped with self-adjusting spring loaded drop bolts activated from the inside only. Drop bolts shall engage dustproof stainless steel receptacles.

TRACK

- A. Curtain shall be hung from an overhead track 1-5/16" (33mm) wide by 1-9/16" (40mm) high. Track shall be tempered aluminum alloy 6351-T6.
- B. Curves where required shall be 14" (356mm) radius standard.

STACKING

Stacking shall not exceed a depth of 1.15" per foot of closure width plus 3" for each post (lead, end or intermediate). (95mm/lin. m + 76mm per post). Full egress doors add 7" (178mm).

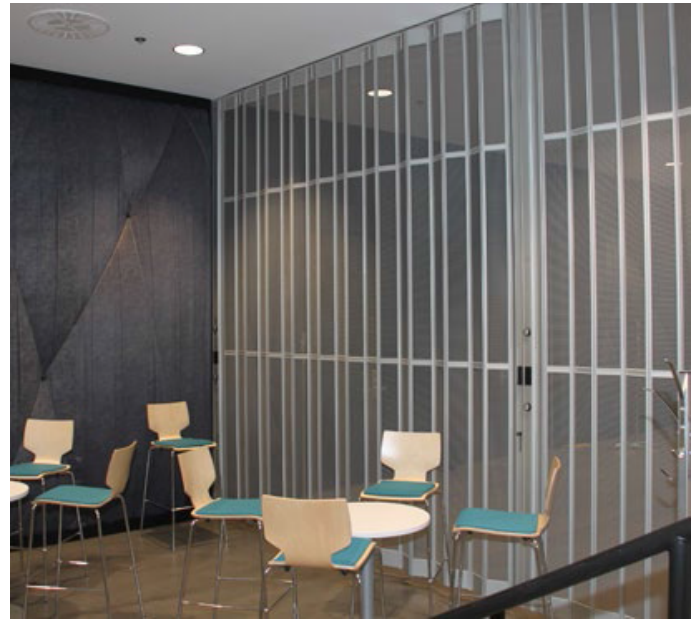

FINISH

Finish shall be standard clear anodized or paint in white, black or bronze.

Following options are available if modifications or improvements are required:

LOCKING OPTIONS

- Top and bottom locking posts with key cylinders one or both sides are available for either end of the curtain.
- Large sections may be divided by incorporating bi-part units as intermediate posts.
- Second hook bolts on lead, end or bi-parts (Recommended for closures over 12' (3,7m) high or for more security).
- Solid aluminum block covering cylinder lock for additional protection (Specify guard cylinder protection).
- Architect to decide side of lock cylinders.
- Additional intermediate post with shoot bolt to floor or counter.

TRACK CURVES

- 10" (254mm) radius curves (Indicate location on plans).
- Special radius curves (Indicate location and radius on plans).

EGRESS COMPLIANCE

- Full egress door 36" x 80" (914mm x 2032mm) where required by local building code.

CONTACT US

Best Rolling Manufacturer, Inc. P: 305-698-3550
9780 NW 79 Avenue F: 305-698-3552
Hialeah Gardens, FL 33016 www.bestdoor.us

Best Perf

Details - Typical Scenario Model - Side Folding Gates

ELEVATION

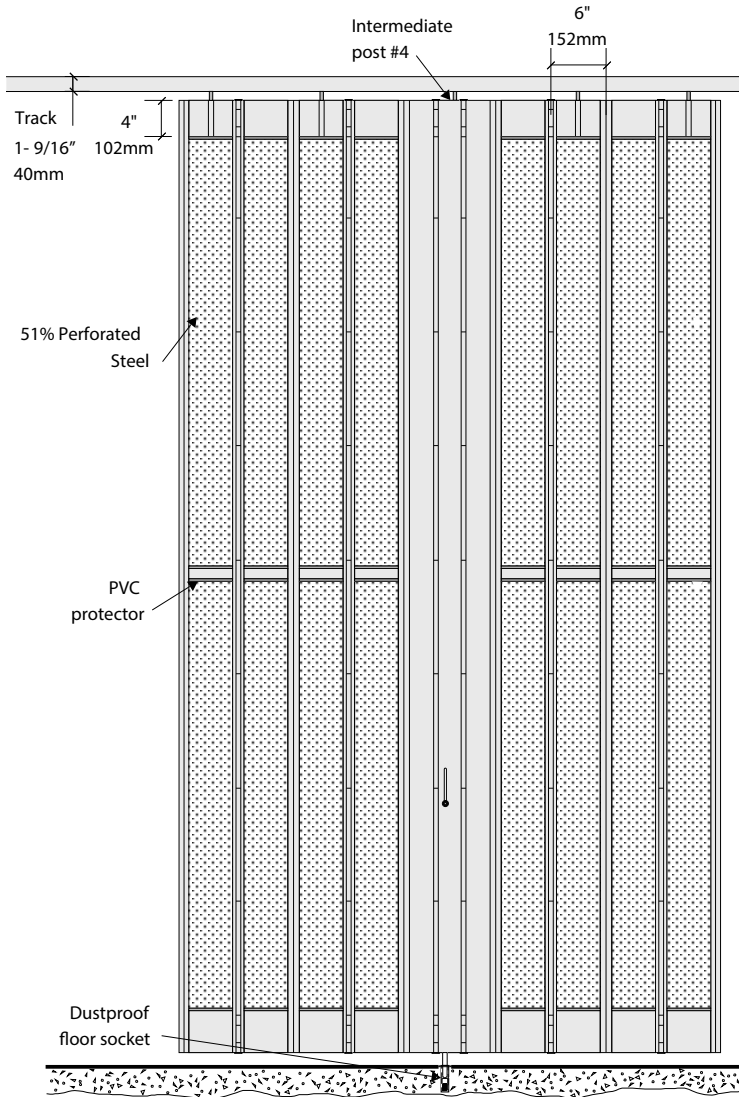

COMMON FINISHES

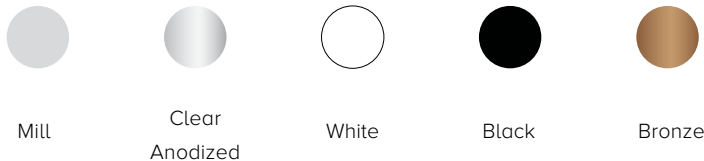

TYPICAL LAYOUT

For further options, consult factory.

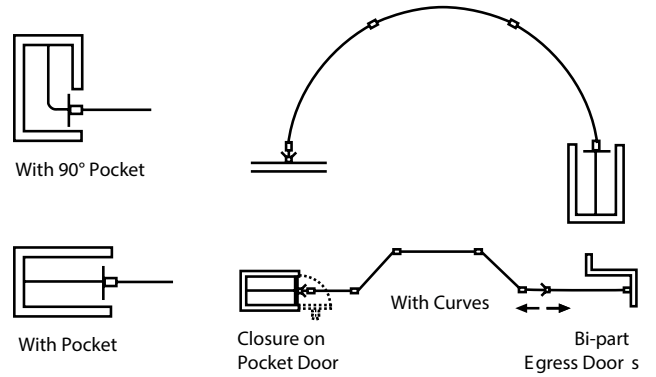

VERTICAL SECTION

