



**Professional
TrailBuilders**
ASSOCIATION



Grand Junction, CO // March 17 - 23, 2019

SUSTAINABLE TRAILS CONFERENCE





Welcome to Grand Junction!

We hope that you meet your trail goals with the conference content, the indoor expo and outdoor demo, the networking opportunities, and that you take some time to enjoy the amazing trails of Grand Junction.

Two Rivers Convention Center

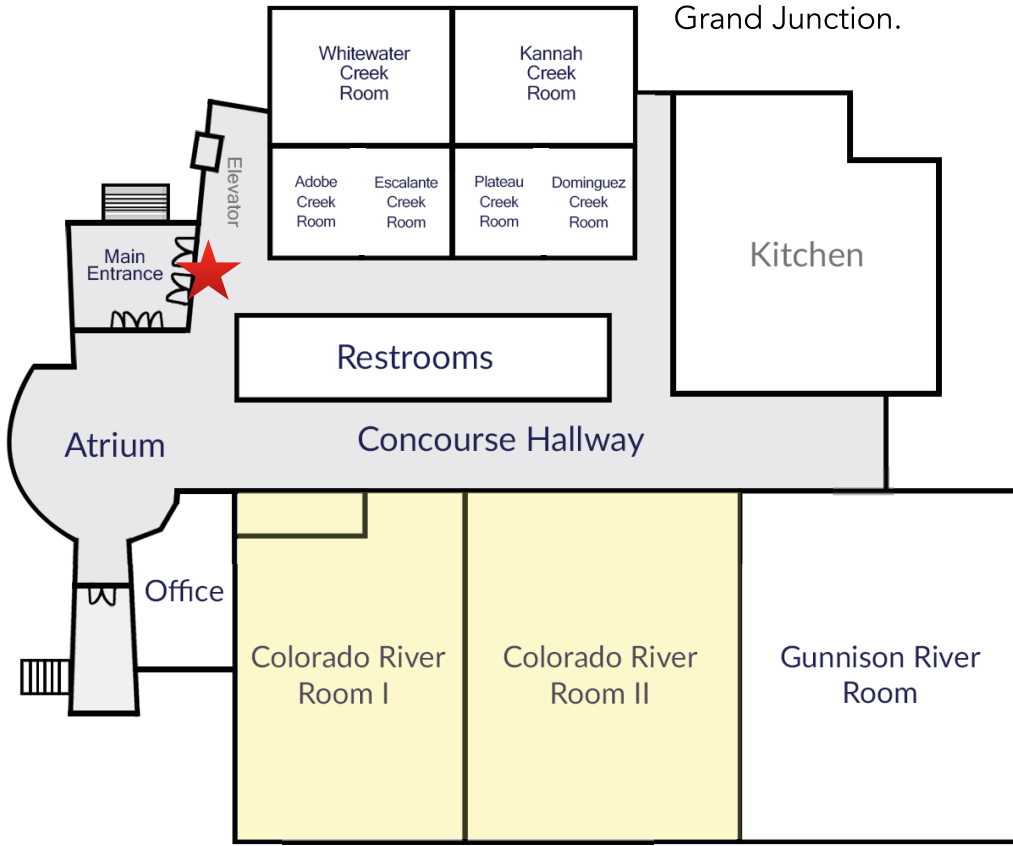

Registration

Indoor Expo

Thanks to our Conference Partners and Supporters!



U.S. Department of Transportation

Federal Highway Administration



Tri-State Company, Incorporated Huntington, WV



TUESDAY, MARCH 19

7:30 am - 9:00 am	Registration	
7:30 am - 9:00 am	Coffee in the Indoor Expo	Colorado Room
8:15 am - 8:45 am	State of the Trailbuilding Industry <i>Jon Underwood, PTBA Board President</i>	Gunnison Room
9:00 am - 10:15 am	Concurrent Session A	
10:15 am - 10:45 am	Enjoy Coffee and snacks in the Indoor Expo	Colorado Room
10:45 am - 12:00 pm	Concurrent Session B	
12:00 pm - 1:15 pm	Lunch & Plenary Session The Future of Trailbuilding: A Global Perspective Sponsored by Tony Boone Trails & Timberline Landscaping	Gunnison Room
1:30 pm - 2:45 pm	Concurrent Session C	
2:45 pm - 3:15 pm	Enjoy Coffee, sodas, and snacks in the Indoor Expo	Colorado Room
3:15 pm - 4:30 pm	Concurrent Session D	
4:30 pm - 6:00 pm	Dinner on your own	
6:00 pm - 9:00 pm	Kick-off Networking Party @ Baron's in Downtown GJ <i>539 Colorado Ave, Grand Junction, CO 81501</i>	

All concurrent sessions are labeled with the following *Track* icons:

 Trail Design & Assessment

 Technical Trailbuilding

 Mountain Bike Trails

 Trail Communities

 Science & Policy

 Partnerships & Case Studies

 Youth Corps

 Professional Skill Building -
Beyond Trails

TUESDAY, MARCH 19

CONCURRENT SESSION A: 9:00 - 10:15 am

Planning and Development of Sustainable Urban Bike Parks

Tim Babcock, Bike Park Development Manager, Progressive Bike Ramps, PTBA Member

The "INs and OUT's" of Urban Bike Park Development. This interactive Q& A session will engage some of the world's best bike park developers. Topics will include: What is an Urban Bike Park, the planning process, structuring bids and RFP's to ensure qualified responses, sustainable design/build methods, Urban Bike Park maintenance, overcoming common objections to Urban Bike Parks through education, the return on investment (ROI) and the broad range of users in Urban Bike Parks, and making Urban Bike Parks a staple in our communities.



Whitewater
Creek

The Nature of Trail Aesthetics

Troy Scott Parker, Natureshape LLC, PTBA Member

Four concepts generate all trail aesthetics for better or worse. Learn how to use them to shape any type of trail for the better. Troy Scott Parker is the author of *Natural Surface Trails by Design: Physical and Human Design Essentials of Sustainable, Enjoyable Trails*.



Kannah
Creek

Lesson Learned from Designing and Constructing the High Rockies Trail

Matt Hadley, McElhanney Consulting Services Ltd.

We will present a case study of constructing High Rockies Trail, an 80Km shared use trail. The session will highlight the design process and learnings from all stages. Points of discussion will be how to maximize layout efficiency using apps and LiDAR along with ground truthing. The tendering package and process to ensure a quality trail builder is hired and ways to reduce construction management time.



Dominiguez/
Plateau
Creek

Top 10 Trail Fails: Common Pitfalls and How to Avoid Them

Scott Gordon, ContourLogic, PTBA Member

What are the common trail planning and management mistakes we see happen frequently. Learn how to spot these common pitfalls ... and more importantly how to avoid them.



Escalante/
Adobe
Creek



PTBA Brings Great Trails to Life!

By the Numbers:

- 95 PTBA Members Nationwide
- Founded in 1976
- 50% of this Conference's sessions and workshops are led by PTBA members

Find a member near you: trailbuilders.org

TUESDAY, MARCH 19

CONCURRENT SESSION B: 10:45 am -12:00 pm

GIS for trails

Emilie Young Vigneault, Analyst, Sentiers Boréals, PTBA Member

GIS is a great underused tool in trail building. It can be used as a layout tool for future development projects or as a mapping tool for user and risk management teams. Participants will learn the strength and limitations of various GIS software and its uses for trails building, planning and management.



Escalante/
Adobe
Creek

Sustainable Trails 101

Jon Underwood, Happy Trails, Inc. PTBA Member

What is a sustainable trail? What are the physical attributes that make a trail sustainable or non-sustainable? What do these things look like on the ground? This class takes you through the basics of sustainable trail design and construction.



Kannah
Creek

Connecting Communities: Integrating Transportation & Recreation Networks

Cindra Thompson, Federal Highway Administration (FHWA)

FHWA's transportation programs can help create safe, accessible, attractive, and environmentally sensitive communities where people want to live, work, and recreate. FHWA funds benefit recreation including hiking, bicycling, in-line skating, equestrian use, cross-country skiing, snowmobiling, off-road motorcycling, all-terrain vehicle riding, four-wheel driving, or using other off-road motorized vehicles. Join this session to learn about current FHWA tools and resources!



Dominiguez/
Plateau
Creek

Partners in Trails: Grand Valley

Scott Winans - COPMOBA, President; John Howe - COPMOBA, Grand Junction Chapter Chair; Chris Pipkin - BLM, Grand Junction Field Office; Mike Bennett - City Manager, Fruita

The working relationships created within the Grand Valley power a singletrack trail movement that serves our local residents, cares for and utilizes our public lands resources, and provides a powerful and growing economic engine in our communities. Trails are the medium for this movement. Representatives from our trails non-profit COPMOBA, Bureau of Land Management, and the City of Fruita will share aspects of the growth, work, partnership, impacts, and results of these partnerships in a panel discussion format, with substantial time allocated for Q&A.



Whitewater
Creek

FUTURE OF TRAILBUILDING

Tuesday, 12:00 - 1:15 pm, Gunnison Room

Panelists will share innovative projects around the world followed by a discussion what these global trends in trailbuilding mean for the future of the trailbuilding industry.

Tony Boone, Tony Boone Trails, Facilitator
Scott Linnenburger, Kay-Linn Enterprises, North America
Jerome Pelland, Sentiers Boréals, Quebec, Canada
Gabe Travis, Interior Trails, AK firm, South America
Tomáš Kvasnička, Singltrek, s.r.o. Czech Republic

A GLOBAL PERSPECTIVE



Sponsored by:



TUESDAY, MARCH 19

CONCURRENT SESSION C: 1:30 - 2:45 pm

Recreation Ecology: Investigating Trail Degradation on the Appalachian Trail

Fletcher Meadema, Graduate Student, Virginia Tech

This session presents findings from National Park Service funded research on the Appalachian Trail. We will explore the influence of trail layout on three forms of trail degradation: soil loss, widening, and muddiness. Our analysis confirms the benefits of core sustainable trail design principles, specifically low trail grades and rolling side-hill alignments, across a large and ecologically diverse data set.



Kannah
Creek

Mechanized Trail Equipment, what's new (what's in your Inventory?)

Merdith C. Lockwood, Trails Unlimited LLC

Trails Unlimited LLC has been helping agencies and manufactures develop new mechanized trail equipment for the past 40+ years. Come and see what is the latest and discuss the pro-con's of each.



Whitewater
Creek

Why Partner with Volunteer Stewardship Organizations and How to Do It

Anna Zawisza, Director of Community Relations & Strategic Partnerships;

Dan Williams, Associate Director of Statewide Stewardship, Volunteers for Outdoor Colorado (VOC)

Including volunteers as part of a well-planned and managed recreational trail project is increasingly viewed as providing numerous significant benefits. These include: insuring long-term maintenance needs are met, increasing stakeholder engagement and community buy-in, local economic development, high priority for public land managers, and greater interest from trail funders. Volunteers for Outdoor Colorado (VOC) will talk about the myriad reasons to undertaking construction, maintenance and other trail work with trained volunteers and volunteer organizations. VOC will also share resources and tools available through VOC and other organizations to build develop your volunteer stewardship capacity.



Dominiguez/
Plateau
Creek

SEMINAR SESSION: 1:30 - 4:30 pm

Trail Contracting Preparation

Mike Shields, Michael D. Shields Consulting, PTBA Member

What makes a good versus flawed contract and what are the effects on both client and contractor. An overview with particular emphasis on preparing functional as well as legal Specifications, General Provisions, and Bid Schedules. We will discuss specific scenarios as part of the exercise and to spur the discussion. Bring your own successes and/or failures to share.



Escalante/
Adobe
Creek

TUESDAY, MARCH 19

CONCURRENT SESSION D: 3:15 - 4:30 pm

Creating Success for the 80%:

Techniques in trail design, construction, risk management and signage

Steven Ovitt, Wilderness Property Management Inc. / WPM Trails, PTBA Member

Techniques in trail design, construction, risk management and signage that create successful mtn. biking, hiking and backcountry & XC skiing experiences.

1. Understanding the recreational users who are the target for a specific trail.
2. Sustainable trail building techniques that create success, skill development and fun.
3. Utilizing a complexity analysis approach to risk management and recreational user success.
4. Signage that makes the 80% comfortable and successful.



Kannah Creek

Recreation Infrastructure for Climbing Areas

Julia Geisler & Lindsay Anderson, Salt Lake Climbers Alliance

The Salt Lake Climbers Alliance is the local rock climbing advocacy 501c3 non-profit that exists to be the voice for climbers in the Wasatch through stewardship, advocacy, community and education. We have led two successful climbing infrastructure projects and would like to share them as models for other areas. We will discuss two successful climbing infrastructure projects: 1) one the largest climbing access trail network on Forest Service property in the nation - in Little Cottonwood Canyon, Salt Lake City, Utah called the Alpenbock Loop Trail systems and 2) one at LDS Church owned property known as the Gate Buttress. This talk would be an in depth look at what climbing infrastructure means from transportation, toilets, climbing trail systems and specific rock masonry skills, as well as vertical route (trail) maintenance.



Dominiguez/
Plateau
Creek

Basic Soil Mechanics for Trail Builders

Alex Man, Scatliff+Miller+Murray

Soil types vary widely all over the world - and even on a single trail! Understanding the physical characteristics of soil and having the ability to categorize soil is VERY important to successful trailbuilding. This session will provide trailbuilders with applicable knowledge of soil including soil description, grain size distribution and its measurement, clay plasticity, and compaction curves and the importance of water.



Whitewater
Creek

TRAIL LOVE PARTY

**Celebrate Trails at
Baron's Grill!**

Tuesday, 3/19 // 6:00 - 9:00 pm
539 Colorado Ave

Eat dinner on your own and
everyone pays their own way.

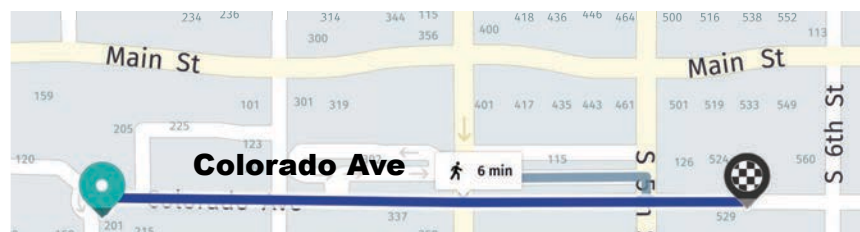

Two Rivers
Convention
Center

Baron's Grill

WEDNESDAY, MARCH 20

7:30 am - 8:30 am	Coffee in the Indoor Expo	Colorado Room
8:30 am - 9:45 am	Concurrent Session E	
9:45 am - 10:15 am	Enjoy coffee and snacks in the Indoor Expo Sponsored by Trail Arts	Colorado Room
10:15 am - 11:30 am	Concurrent Session F	
11:45 am - 1:00 pm	Lunch & Plenary Session Grand Junction: Outdoor Recreation, Community, Economy Sponsored by Tools for Trails	Gunnison Room
1:15 pm - 2:30 pm	Concurrent Session G	
2:30 pm - 3:30 pm	Enjoy coffee, drinks, and snacks in the Indoor Expo	Colorado Room
3:00 pm - 6:00 pm	Dirt Demo - Off-Site @ the Lunch Loop Trailhead Check out trail building machine demos, enjoy food truck fare and the local trails!	
6:00 pm - 9:00 pm	Party at the Handlebar Tap House 417 Monument Rd. #1	

GRAND JUNCTION

Plenary Session

Wednesday, 11:45 am - 1:00 pm, Gunnison Room

OUTDOOR
RECREATION

TRAILS

COMMUNITY

ECONOMY



Jen Taylor, Outdoorist and OREC advocate, leading and building brands in the Outdoor and Cycling industries for 25 years



Tim Casey, PhD, Professor of Political Science at Colorado Mesa University.

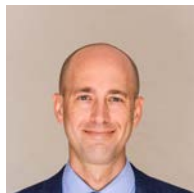

Nathan Perry, Ph.D., Associate Professor of Economics

Sponsored by:



WEDNESDAY, MARCH 20

DIRT DEMO - Lunch Loop Trailhead
Monument Rd // 3:00 - 6:00 pm

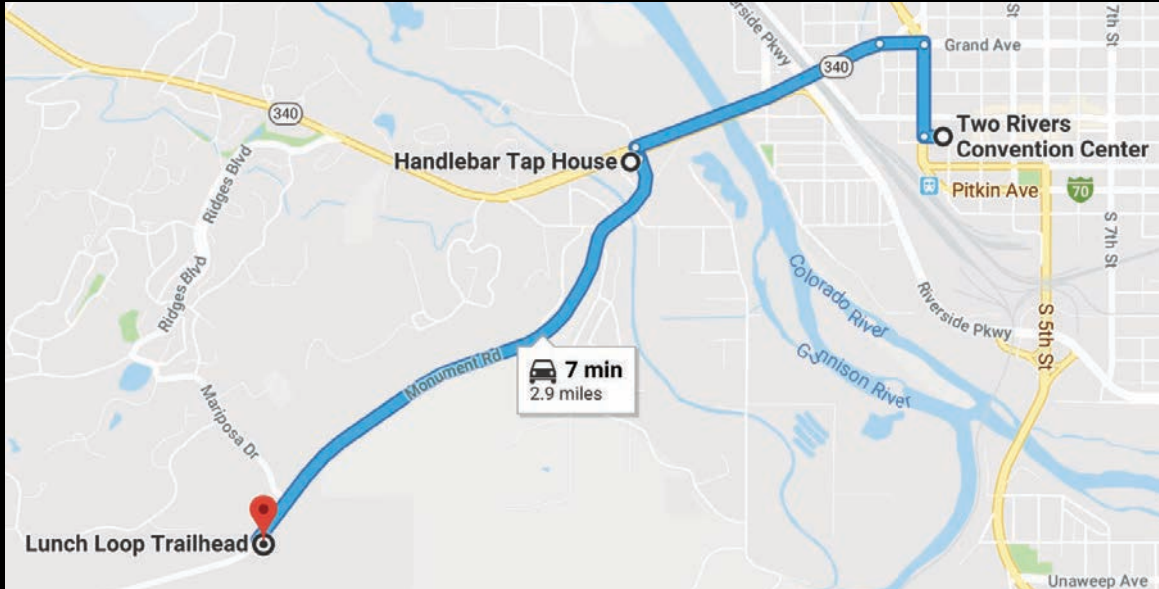

- Getting there -

Carpool with other attendees!

Ride your bike!

Van Shuttles running between Two Rivers, the Handlebar & The Trailhead

ENJOY
Food Trucks Fare from:

Big Mike's Pork N Wings

Gumbo Lov

Time to explore the Lunch Loop trails on foot or bike!

Mechanized Equipment Demo

SUTTER EQUIPMENT CO.
THE ULTIMATE TRAIL MACHINE

WU 3
WERK-BRAU

CANYCOM



WEDNESDAY, MARCH 20

CONCURRENT SESSION E: 8:30 - 9:45 am

Art of Conscious Communications

Dr. Audrey Nelson, Nelson Communications

There is a direct correlation between how you communicate and your overall success both at work and home! You cannot not communicate; everything you say or do sends a message. Today's technology such as email, Twitter, and the Internet has made communication faster and more accessible. Telecommunication is a misnomer; we've lost the human moment. Additionally most of us operate on automatic in The first five seconds: There is no dress rehearsal for a first impression! Additionally, our everyday face-to-face communication. This highly interactive program brings communication into consciousness and supplies tools to help you send the message you want. Audrey Nelson, PhD., is an international trainer, key-note speaker; author and consultant who helps organizations increase their productivity and profitability through winning communication strategies. Bolster your communication skills – with clients, partners, volunteers – with this session!



Gunnison Room

Pumptrack 2.0 - Asphalt and Concrete Pumptracks

Jerome Pelland, Sentiers Boreals, PTBA Member

With the greater interest in asphalt and concrete pumptrack, this session present the basics of what makes a great pumptrack comes to life, then continue with case-study of asphalt pumptrack around the world. The presentation conclude with specific details to keep in mind when planning a pumptrack project.



Kannah Creek

Trails and the new CCC: Corps, Community, Collaboration

Cliff Kipp, Montana Conservation Corps, Northern Rockies; Jeff Roberts, Western Colorado Conservation Corps; Kevin Heiner, Southwest Conservation Corps

Conservation Corps are partnering with communities, land trusts, public agencies, nonprofits, and professional trail builders to create trails that connect communities, and connect youth to their communities. Come learn from three corps about innovative and cost-efficient partnerships that are pumping energy and funding into local trails projects - and in the process creating jobs and a next generation of trail stewards. Federal policies are incentivizing partnerships with conservation corps for trail development. Raise money, stretch it farther, and have more fun doing it with a new generation of trail builders.



Whitewater Creek

SEMINAR SESSION: 8:30 - 11:30 am

Field Contract Administration

Mike Shields, Michael D. Shields Consulting, PTBA Member

What causes contract performance to be a smooth versus nightmare experience for either the client, the contractor, or both. An overview with particular emphasis on contract lines of authority, Pre-Bid actions, the Inspection process and problems, and Contract Closure. Will include scenarios to spur the discussion, but bring your own successes and/or failures to share.



Escalante/ Adobe Creek

WEDNESDAY, MARCH 20

SESSION F: 10:15 - 11:30 am

Dealing with Difficult People

Dr. Audrey Nelson, Nelson Communications

You may call them "inhuman resources." They are difficult people. Dealing with them is a challenge and often leads to feelings of hopelessness and frustration. This presentation will identify tactics for disarming games and contentious tactics including manipulation, blame, sabotage and bullying will be emphasized. Audrey Nelson, PhD., is an international trainer, key-note speaker; author and consultant who helps organizations increase their productivity and profitability through winning communication strategies. Bolster your communication skills – with clients, partners, volunteers – with this session!



Gunnison
Room

What mountain bikers want to ride: current social science research in mountain biker motivations, preferences, and identity.

Samuel Dobrozi, Master's Student, Clemson University

Mountain bikers want more trails to ride. What should be planned and built? Cross-country trails? Downhill runs? Dirt jumps? What's an "all-mountain trail" and how do I build it? What do those words mean, and how do mountain bikers actually experience them or decide where to ride? This ongoing research by Clemson master's student Samuel Dobrozi gains insight into these questions through an exploratory mixed methods study, using in-depth interviews and survey research with mountain bikers around the country.



Kannah
Creek

Managing Successful Hybrid Projects

Ryan Spates, S & S Trails and Scott Gordon, ContourLogic, PTBA Members

Combining the efforts of volunteers, youth corps and/or agency crews with the expertise and "heavy lift" ability of contractors is commonly know as "Hybrid Contracting." This session will examine the technical side of creating teaming agreements/contractual arrangements, as well as case studies with successful outcomes and lessons learned from less successful projects.



Whitewater
Creek

FEATURED SPEAKER: AUDREY NELSON

As part of PTBA's focus on professional development within the trails industry, we are excited to bring Audrey Nelson, PhD. to our conference. She is an international trainer, key-note speaker; author and consultant who helps organizations increase their productivity and profitability through winning communication strategies.



Effective communication is KEY to every trailbuilding project - from builders, to clients, to stakeholders, to volunteers. Build your skills with her communication sessions on Wednesday!

Art of Conscious Communications, 8:30 - 9:45 am

Dealing with Difficult People, 10:15 - 11:30 am

Women in Trailbuilding Forum, 1:15 - 2:30 pm

WEDNESDAY, MARCH 20

SESSION G: 1:15 - 2:30 pm

Women in Trailbuilding Forum

Moderated by Dr. Audrey Nelson, Nelson Communications

Panelists: Dawn Packard, Blue Sky Trails LLC, North Dakota; Christine Byl, Interior Trails, Alaska; Meara McQuain, Headwaters Trails Alliance, Colorado; Emilie Young-Vigneault, Sentiers Boréals, Quebec

Join our expert moderator and panelists in this lively discussion on the "unique" challenges women confront in the world of Trailbuilding.



Kannah
Creek

Community Trails Accomplished Through Collaborative Partnership

Clifford Kipp, MT Conservation Corps; Greg Gunderson; President, Forestoration. Pete Costain; President, Terraflow Trail Systems; Heidi Van Everen, Whitefish Legacy Partners

The Flathead Valley of NW Montana is rapidly establishing itself as a haven for outdoor recreation. The burgeoning trail systems that entice visitors, and keep locals happy/healthy, exist thanks to ongoing dynamic public/private/non-profit collaborations. A non-profit trail organization, a trail designer, a trail builder and a conservation corps invite you to join us as we explore the effectiveness of collaboration, resourcefulness, and how a rising tide lifts all boats.



Whitewater
Room

Recreation and Conservation: A shared vision and responsibility

Kacie Miller, Planning Manager, Colorado Parks and Wildlife & Brian Magee, SW Region Land Use Coordinator, Colorado Parks and Wildlife

The Statewide Comprehensive Outdoor Recreation Plan (SCORP 2019) reflects the shared vision and commitment of outdoor partners to advance recreation enjoyment and conservation of Colorado's outdoor resources. We will discuss the planning process, results of an economic analysis of outdoor recreation, the 5-year priorities, Colorado's/SHIFT Outdoor Principles, and ways to avoid, minimize, and mitigate impacts from trail development on wildlife resources.



Dominiguez/
Plateau
Creek

Safe and Effective Use of Preserved Wood in Trail Building

Butch Bernhardt, Sr. Program Manager, Western Wood Preservers Institute

Preservative-treated wood can ensure the durability of outdoor structures, including decks, gazebos, trail railings, fences and wood pedestrian bridges. In this presentation, participants will learn about the manufacturing process for pressure-treated wood, the preservatives used today, the available products and their differences, and how preserved wood is used in trail and outdoor projects. Topics include an overview of preservative treatments, desired service life and exposure conditions, AWWPA Use Category standards, Best Management Practices for use in aquatic and sensitive areas and current issues concerning the safe use of preserved wood. Participants will also receive instructions for free downloading of the Treated Lumber Guide smartphone/tablet app.



Escalante/
Adobe
Creek

THURSDAY, MARCH 21

7:30 - 8:30 am Coffee in the Indoor Expo Colorado Room

8:30 - 9:45 am **Concurrent Session H**

9:45 - 10:15 am Enjoy coffee and snacks in the Indoor Expo Colorado Room

10:15 - 11:30 am **Concurrent Session I**

SESSION H: 8:30 - 9:45 am

Bridges 101

Charlie Dundas, Tri-State Company, PTBA Member

Introduction to the basic types of trail and pedestrian bridges by Tri-State Company, Inc. Includes discussion of the basic considerations of bridge design. Discussion of site selection, the "physics of bridge functioning", dead load, live load, and moment of load. The presentation includes photos, drawings, and animations.



Colorado Room

Clino Over Ego: Ten Observations On Creating Trails & Trail Destinations

Tony Boone, Tony Boone Trails, Inc., PTBA Member

60-75 minute session recently presented at T.H.E Trail Summit in Fruita, CO (Oct. 2018) on the hazards and pitfalls of creating trails with ego instead of sound, sustainable Best Management Principles. I will share some of the most important lessons/observations I've learned over the past three decades working with multi-national trail crews and unique trail destinations around the world.



Whitewater Room

Building Coalitions Through Consensus: Mediation and Interest-Based Negotiation Skills for Community Trail Planning

Evan Pilling, Sonoran Desert Mountain Bicyclists

Effective trail planning involves including community stakeholders in the entire planning process. Often stakeholder concerns are not sufficiently understood or addressed, and relatively minor issues snowball and become major problems down the road. Inclusion of all trail user groups, community members, environmental advocates, and government officials promotes long-term sustainability of trail projects and yields trails that benefit the entire community. Join this skills-based presentation that outlines the principles and practices of mediation and interest-based negotiation and how they can be applied to work with stakeholders, address concerns and disagreements, and develop long-term consensus. Evan Pilling is a trained mediator and holds a Master's Degree in Counseling Psychology.



Dominiguez/
Plateau
Creek

Technology and Trails - Using Drones for Trail Planning in the North Fruita Desert (18 Road)

Jon Altschuld, Chinook Landscape Architecture, LLC

Chinook Landscape Architecture and Tony Boone Trails are currently developing the 18 Road Master Plan north of Fruita. The Master Plan is creating the long-term vision for the area, including a maintenance/sustainability plan, trail re-routes, new trails, seasonal closure recommendations, trail design prescriptions, and an events area for NICA, amateur and professional events. Our Team is using emerging and evolving technologies such as drones, photogrammetry, RTK GPS, and 3D GIS mapping to inventory and analyze the existing conditions, as well as to communicate design ideas and potential trail alignments. Come learn from Chinook's Jon Altschuld is a leading expert in emerging technologies on the use of visualization and drone technologies in design, planning, and construction industries.



Kannah
Creek

THURSDAY, MARCH 21

SESSION I: 10:15 - 11:30 am

Bridges 103

Charlie Dundas, Tri-State Company, PTBA Member

Case studies of the construction of four differing trail bridge designs, detailing the the thought behind the selection of the type of bridge, the process, material, and critical path of construction. Also included are display of the elements of construction control used by Tri-State Company, Inc. [Nikon Total Station EDM, Trimble Recon Construction Computer, and Nikon Auto level as well as older style of transit levels and measuring tools]. This presentation will focus on the following types of bridges: Cable suspension, glu-lam beam, prefabricated steel, and curvilinear screw-lam bridges.



Colorado Room

High Community Impact Trail Systems: Successful And Innovative Approaches To Rapidly Creating A Trail-Rich Community

Scott Linnenburger, Kay-Linn Enterprises, PTBA Member

Most of our common examples for healthy, happy, trail-focused communities developed organically over fifteen to twenty years and depend on access to hundreds of thousands of acres of public land- conditions that simply aren't viable for many communities. Many communities across the country have made up for lost time or lack of abundant land in innovative ways- from creating unwitting or unusual community influencers, to tapping into alternative funding sources and even private investment. By not following the rules of the past, these communities are proving that "going big" by being strategic is their charted course for a successful trails future. Scott Linnenburger, Principal of Kay-Linn Enterprises (PTBA Member Company), has been involved with many of these projects over the last 15 years, learning to recognize and facilitate the key elements of successful, rapidly developed trails communities. He will present numerous examples and engage the group in an active discussion around these high-impact trail developments.



Whitewater Room

Tools for Trails

Jerome Pelland, Sentiers Boréals, PTBA Member

A review of various tools and products available to optimize trail planning, construction and maintenance. Pros and cons of various products will be presented by a leading contractor and invited professionals.



Kannah Creek



2020 SUSTAINABLE TRAILS CONFERENCE

BENTONVILLE, AR
March 17 - 19, 2020



Don't miss our amazing vendors!

CANYCOM

WB
WERK-BRAU

SUTTER EQUIPMENT CO.
THE ULTIMATE TRAIL MACHINE



CHANCE®

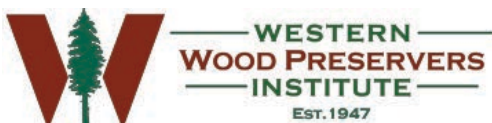

Schedule At Glance



Date	Time Slot	Description
Tuesday, March 19	7:30 am -9:00 am	Registration & Morning coffee in Indoor Expo, Gunnison Room
	7:30 am - 4:30 pm	Indoor Expo Open
	8:15 am - 8:45 am	General Session - Welcome & State of the Trailbuiding Industry
	9:00 am - 10:15 am	Concurrent Session A
	10:15 am - 10:45 am	Indoor Expo Break - Snacks and Coffee
	10:45 am - 12:00 pm	Concurrent Session B
	12:00 pm - 1:15 pm	Banquet Lunch & Plenary Session The Future of Trailbuilding, A Global Perspective
	1:30 pm - 2:45 pm	Concurrent Session C
	2:45 pm - 3:15 pm	Indoor Expo Break - Treats, Drinks, and Coffee
	3:15 pm - 4:30 pm	Concurrent Session D
	4:30 pm - 6:00 pm	Dinner (on your own)
	6:00 pm - 9:00 pm	Party at Baron's Grill in Downtown GJ, 539 Colorado Ave
Wednesday, March 20	7:30 am - 8:30 am	Morning coffee in Indoor Expo
	7:30 am - 3:30 pm	Indoor Expo Open
	8:30 am - 9:45 am	Concurrent Session E
	9:45 am - 10:15 am	Indoor Expo Break - Snacks and Coffee
	10:15 am - 11:30 am	Concurrent Session F
	11:45 am - 1:00 pm	Banquet Lunch & Plenary Session Grand Junction, Outdoor Recreation, Trails, Community & Economy
	1:15 pm - 2:30 pm	Concurrent Session G
	2:30 pm- 3:30 pm	Indoor Expo Break - Treats, Drinks, and Coffee
	3:00 pm - 6:00 pm	Dirt Demo - Off-Site @ the Lunch Loop Trailhead
	6:00 pm - 9:00 pm	Party at the Handlebar Tap House - 417 Monument Rd. #1
Thursday, March 21	8:00 am - 8:30 am	Morning coffee in the Gunnison Room
	8:30 am - 9:45 am	Concurrent Session H
	9:45 am - 10:15 am	Morning Break - Snacks and Coffee in the Gunnison Room
	10:15 am - 11: 30 am	Concurrent Session I
	11:30 am	Conference Ends