

MAPS



KENDAL[®] on Hudson
Together, transforming the experience of aging.®

1010 Kendal Way Sleepy Hollow, NY 10591 1-866-KENDALNY or 914-922-1000

MARY POWELL BUILDING

MAIN LEVEL
Adirondack
Public Space

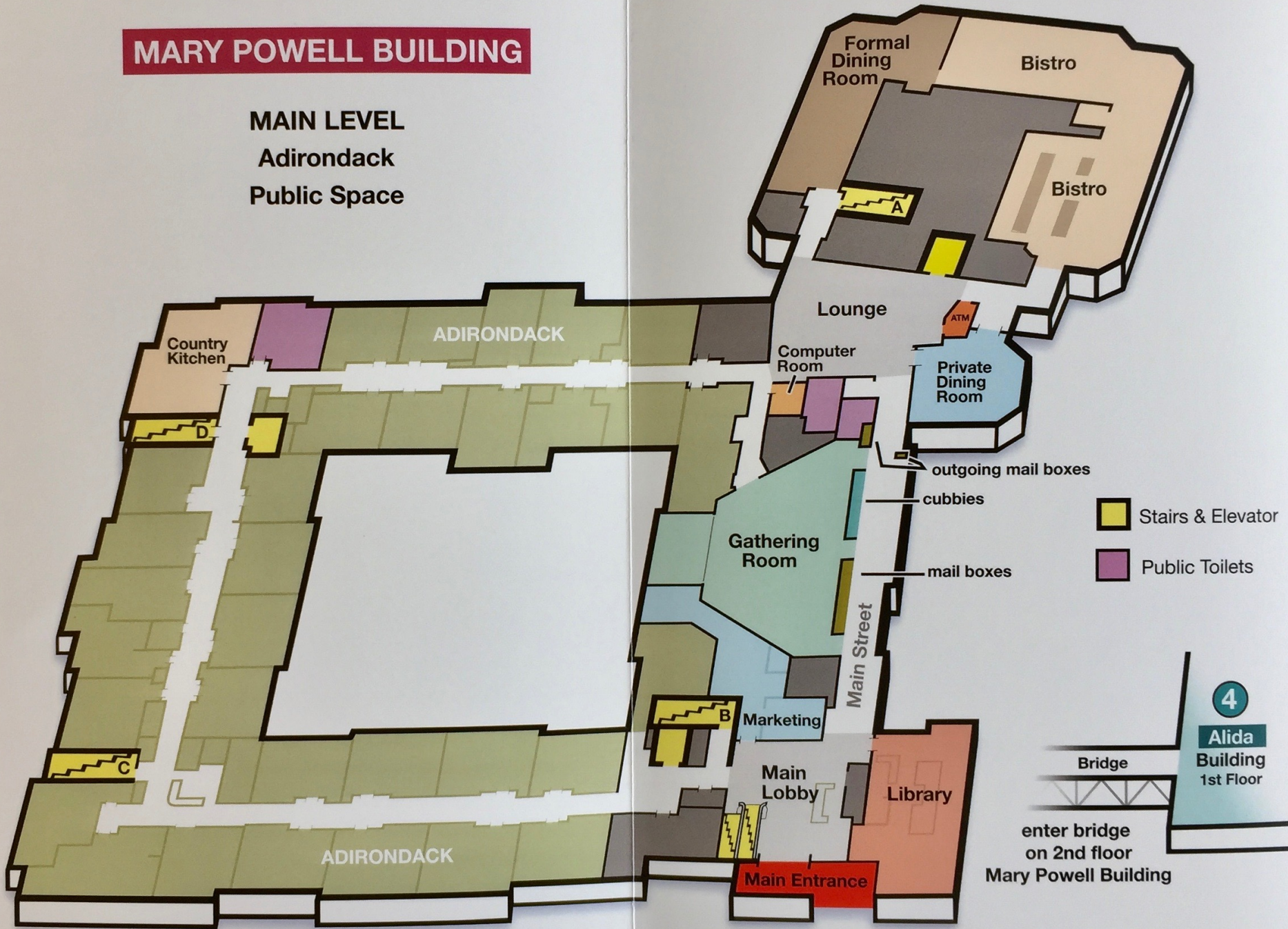

1 MARY POWELL BUILDING

COMMUNITY LEVEL (C Level)
 Sunnyside
 Clearwater
 Administrative Offices

2
 Clermont
 Building
 2nd Floor

3
 Robert Fulton
 Building
 1st Floor

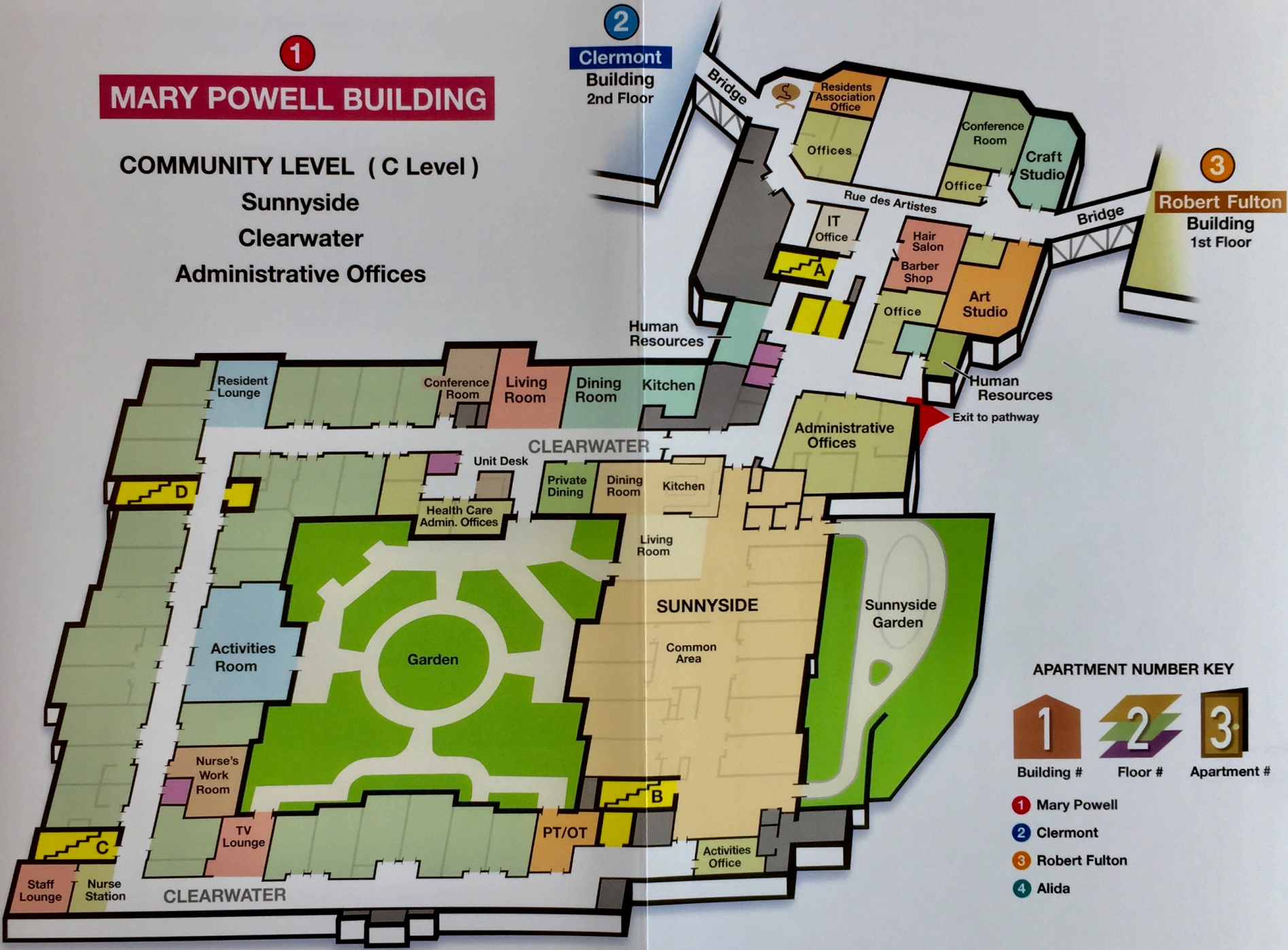

APARTMENT NUMBER KEY

		
Building #	Floor #	Apartment #

- 1 Mary Powell
- 2 Clermont
- 3 Robert Fulton
- 4 Alida

MARY POWELL BUILDING

TERRACE LEVEL

Pool

Fitness Center

Resident Care Center

Outpatient Rehab

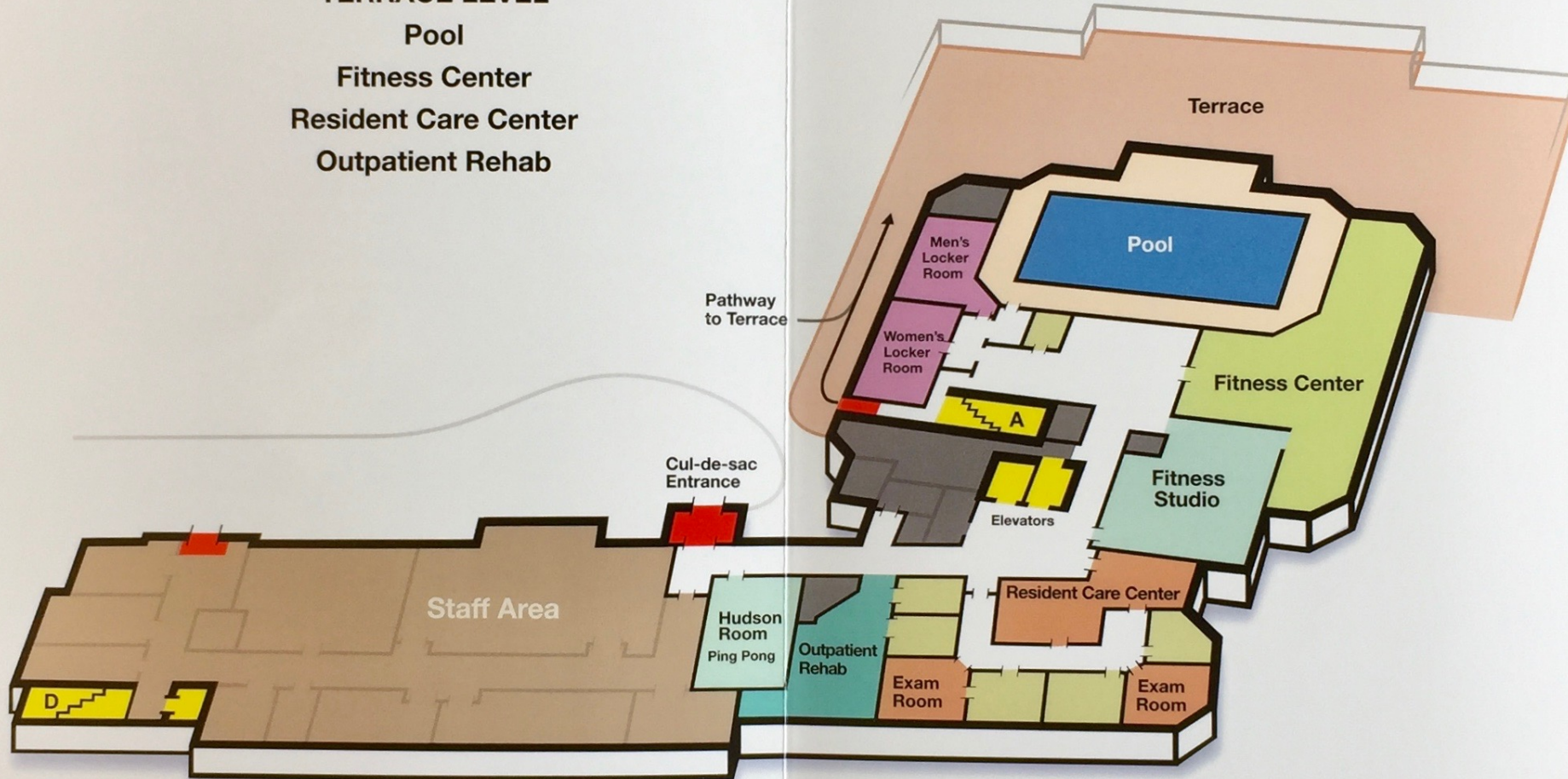

Stairs & Elevator

Public Toilets

