

# DIGITAL EAR THERMOMETER

## INSTRUCTION MANUAL

Please read carefully before using

KI-8192

### DEVICE DESCRIPTION AND INTENDED USE

The thermometer is an electronic device intended to measure the body (human) temperature. It is designed to absorb the infrared from human body to detect your temperature. It can be used with adult or pediatric patients and it can be used in household.

### HOW TO USE

#### Measurement Consideration

##### CAUTION

1. Make sure the measuring site is dry, clean prior to measurement taking.
2. Clean the probe before and after each measurement to prevent cross-contamination, see Cleaning & Disinfection.
3. After cleaning and disinfection the probe, please wait for at least 2 minutes to do a measurement.

1. Straighten the ear canal.  
For Children under 12 months: Make the ear canal straight by gently pulling the ear backward.  
For Children over 12 months and Adults: Make the ear canal straight by gently pulling the ear backward and upward.
2. Place the probe inside the ear canal.
3. Press and release power button to do a measurement.

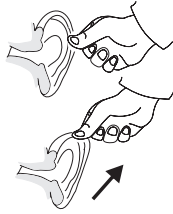

#### Doing a Measurement

1. Press and release the power button to turn on the device; it will auto self-diagnosis.
2. After completing self-diagnosis, the device will be ready for measurement.
3. Press and release the power button then read the temperature.
4. The backlight will light up in accordance with the temperature, shown as below table.

Temperature (°F)	Backlight
T ≤ 98.9	Green Backlight
99 ≤ T ≤ 99.4	Yellow Backlight
99.5 ≤ T	Red Backlight



#### Read-back last memory by NFC

Install OUCare APP from Google play or App Store successfully. OUCare not only collect temperatures but also can do graph for checking temperature's trend easily.



**For Android mobile device:** When the device is off, put mobile device above the thermometer, the last temperature will be read-back and show on mobile device.

**For iPhone7 or above:** The iOS should be 11.0 or above. When the device is off, press the **MFC** icon of APP then close to the thermometer, the last temperature will be read-back and show on mobile device. Right side is a figure of NFC area of iPhone7.



### CONTRAINDICATIONS

The thermometer is contraindicated:

1. Place the probe in scarred tissue or tissue compromised by any disorders of measuring site.
2. Patients in trauma or treat with certain drug therapies of measuring site.

### SETTING

#### Setting °C or °F Scale

1. Turn on the device by pressing and release the button.
2. Press and hold the button within first 2 seconds until °C or °F change, release the button as soon as change occurs.
3. Press and hold the button again for 2 seconds to switch back and forth from °C or °F.



### MEMORY FUNCTIONS

#### Recall Memory

1. When the unit is off, press and hold the power button around 3 seconds until the last memory shows.
2. You may continue to press and release the power button to recall up to 9 previous records.
3. Discontinue pressing the power button to stop recalling memories.
4. The memory will flash for times then the device is ready to do a new measurement.



#### Delete All Memory

When the device is in memory mode, press and hold the power button to delete all memories, then the device will be off automatically.

#### Otherwise,

1. To stop deleting memories, do not press the power button when you see "dEL".
2. Then the device will return to memory mode after 2 seconds then it is ready for measurement.



### DEVICE OVERVIEW & DISPLAY OVERVIEW

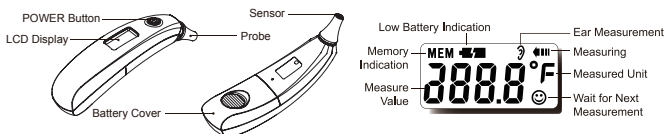

### QUICK START

1. Install batteries into the device. Make sure the polarity (+ and -) of the battery matches as shown in the battery compartment.
2. Press and release the power button, you will hear a short beep. The device will be ready for measuring when two short beeps are heard.
3. Place the probe on the measuring site.
4. Press the power button then read the temperature on the display.



### PRODUCT SPECIFICATION

Measuring Site	Ear canal
Measuring time	3 second
Display Temperature Range	90°F ~ 110°F (32.2°C~43.3°C)
Accuracy	96.8°F~102.2°F (36°C~39°C):±0.4°F (0.2°C) <96.8°F (36°C) : 0.5°F(0.3°C) >102.2°F (39°C) : 0.5°F(0.3°C)
Resolution	0.1°F
Memory sets	9 sets
Operation Environment	60.8°F~104.0°F(16°C~40°C), R.H. of 15~95% non-condensing
Storage Environment	-4°F~120°F(-20°C~50°C), R.H. of 15~95% non-condensing
Power Source	AAA battery x 2pcs
Battery Life	More than 1000 measurements
Auto Shut Off	After 60 seconds of inactivity
Dimension	140.6mm x 34.1mm x 42.5mm +/- 2%
Weight	Approx. 60g includes batteries +/- 5%
Warranty	1 year
Certification	ISO 13485, ASTM E1965-98

### EXPLANATION OF SYMBOLS

	Power Button
	Power Off
	Measuring
	Measuring site is ear canal
	Memory Indication.

	Device can do next measurement when it shows.
	Low battery indicator
	Delete memory
	Operating instructions.
	Warning and Caution
	YYMM : Lot Number composed by year(YY) and month(MM) of manufacture.

### TROUBLESHOOTING

	The reading is higher than measuring range, please redo a measurement.
	The reading is lower than measuring range, please redo a measurement.
	Out of operating condition.
	Device self-diagnostic error, please contact the distributor.

### BATTERY INSTALLMENT

#### WARNING

Use only same type of alkaline batteries to avoid incompatibility. Memory may be erased after replacing a new battery.

1. Replace with 2 new AAA batteries simultaneously when the low battery indication appears.
2. Remove batteries if the device is not likely to be used for a long period of time.
3. Do not dispose the batteries in a fire, the batteries will explode.

#### Replace Battery

1. Remove the battery cover to insert batteries.
2. Confirm the polarity (+ and -) of batteries are correct as indicated inside the compartment and insert batteries accordingly.
3. Replace the battery cover.

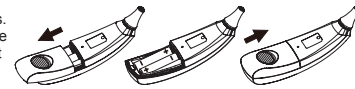

### CLEANING & DISINFECTION

1. To clean and disinfect the device, use a cotton swab or pad moistened with 70% alcohol to wipe the Sensor and Probe.
2. Use a cloth dampened with water or neutral detergent to clean and dry the device.
3. Do not use thinner, benzene, and other harsh cleaners for cleaning the device.
4. Do not immerse the unit in water or liquid of any kind. **The unit is not water proof.**

#### Do not submerge or expose the device to water.

Do not use corrosive detergent to clean the device. Clean and disinfect the thermometer before and after use.

#### Cleaning process:

1. Pre-cleaning with cold water wash several times.
2. Clean the probe with a solution of 5-10% mild detergent about 10-15 seconds.
3. Continuously clean with cold water to avoid any chemical residues remaining on the device.
4. Rinse the device with drinking water or distilled water to ensure the removal of all remnants of the cleaning agent.
5. If necessary, repeat step 2 through step 4 in order to make sure the device is clean.
6. A final wipe down by a clean wipe is necessary to avoid of water stains.

#### Disinfection process:

1. To disinfect the device when completed the cleaning process.
2. Wipe the probe with a cloth dipped in a disinfectant solution such as 70-75% isopropyl (rubbing) alcohol solution: contact time ≥10 minutes for disinfection.
3. The disinfectant free rinse without residues.

#### Drying process:

1. After cleaning and disinfection process above.  
Put the device to air-dry in the room temperature 68-86°F, exposure time around 30-60 minutes.

### CARE AND STORAGE

1. Do not drop or crush the device. It is not shock proof.
2. Do not dismantle or modify the device other than changing the batteries.
3. Do not store the device in an extreme environment with direct sunlight, high/low temperatures or in a location with high humidity or severe dust.

Please contact your local agents or distributors if the device does not function properly as specified under **Product Specification**.

### SAFETY INSTRUCTIONS

#### WARNING:

1. Read the entire instruction manual before trying to operate the device.
2. The device is delivered non-sterile; please clean the device before measuring.
3. Stop using the device if malfunctions appear or if it operates abnormally.
4. Children should not use the device without the supervision of an adult. Keep out of reach of unsupervised children.
5. Do not use the device when flammable materials are around.
6. Do not place the device on scarred tissue, open wounds or abrasions.
7. If the device has been kept or stored in extreme temperatures, wait at least one hour for the device to return to room temperature before measuring.
8. Do not touch the probe, unless the device is taking a measurement.
9. The device is not water resistance, please keep dry.
10. Do not drop the thermometer or expose it to heavy shock.
11. Do not bite or swallow the probe and the battery cover.
12. Do not let thermometer come into contact with any thinner or chemical solvents.
13. Components may be harmful if swallowed. Contact a physician immediately should this occur.
14. Do not use it if the display malfunctions or it operates irregularly.
15. Do not put this unit in dishwasher.
16. Performance of the thermometer may be degraded if: Operated or stored outside stated temperature and humidity ranges or if the patient's temperature is below the ambient (room) temperature.
17. Only use the thermometer indoors and do not use it near mobile phones or microwave ovens. In the case of the thermometer whose maximum power exceeds 2W, the minimum distance from thermometer should be 3.3 meters (11 feet).
18. The reading is for reference, if you feel sick or uncomfortable, please contact the physician.

#### CAUTIONS:

1. Do not scrape or scratch the probe as it will hamper the effectiveness of the device.
2. Do not dismantle the device except when replacing the battery.
3. Wait at least thirty minutes after exercising, bathing or eating before taking a measurement.
4. If the subject's body temperature is lower than the room temperature, a false reading may occur.
5. To ensure the best performance of the device, please follow the Product Specification "Storage condition" regarding temperature and humidity ranges for storing the device.
6. Dispose of the device and battery according to your local regulatory or environmental protection agency.
7. The device is not intended for use in the emergency medical services environment.

For maximum performance of the device, we recommend a device calibration every two years.

### ABOUT BODY TEMPERATURE

A person's normal body temperature can range from 95.9°F to 100.0°F throughout the day. We recommend taking your temperature at different times during the day when you are NOT sick. This will give you a preliminary reference to know what your normal temperature is and how it fluctuates during a normal day. Then, when you feel sick or uncomfortable, knowing this information will provide an index for a reliable diagnosis of a fever.

### WARRANTY INFORMATION

#### Warranty:

The device itself (battery excluded) comes with one year warranty from purchase date if it is operated under normal circumstances without evidence of tampering. See exclusions below.

#### Warranty exclusions:

1. If user does not properly operate the device according to the instructions as described in this manual.
2. If the device shows signs of tampering or attempted modification.
3. Improper handling, such as dropping, liquid or cleaner damage.
4. Natural disasters (such as fire, flood, earthquake, lightning strike).
5. If you do not have a receipt or proof of purchase showing date of purchase.

### LOT NUMBER INFORMATION

LOT NO.(YYMM) on the device label means the year and month of manufacturing. For example, "1904" means the device was manufactured in April, 2019.

Thank you for purchasing a 180 Innovations product.  
Distributed by 180 Innovations, Lakewood, CO 80215  
Made in China  
www.180innovations.com  
Toll free 877-299-6700

REV.20190808 PN.82819200XX