

Saluzi





'My horse Saluzi could fly like a sparrow and possessed a unique
physical strength and charismatic character on the battlefield'

Emperor Taizong

599 - 649





The former cruise ship built by Austal, is the product of remarkable engineering and vision, designed to offer a truly unique floating vacation home for exploring Asian and Mediterranean waters.

ABOUT

Saluzi is a voluminous yacht of great proportions, at 70 meters in length with a wide 13.8 metre beam. 1,650 square metres of guest space is spread across five decks comprising spa, hair salon, gym, karaoke bar and an open air cinema. 32 guests can lodge in cabins that are divided into two masters, seven VIPs and seven deluxe.

It is a summer class yacht with a shallow beam that, despite her size, can access to exploration areas, coral reefs and shores. With an aluminium hull and superstructure, Saluzi features an ultra-modern stabilisation system to reduce roll motion effect and ensure ultimate comfort throughout one's charter vacation. With a cruising speed of 12 knots, a maximum speed of 16 knots and a range of 1,500 miles, she is the perfect combination of performance and comfort.

INSPIRATION

She is named after the mystical warhorse of Tang Dynasty Emperor Taizong that, according to legend, despite being wounded in battle brought the Emperor back to safety. The artwork of the horse on the exterior of the yacht has been created by artist Li Jiwei as a modern interpretation of the ancient tale. Today, Saluzi, the yacht, represents the strength of an era and a symbol of modern spirit: ‘Saluzi symbolises a dialogue amongst civilisations. By integrating an ancient Chinese royal horse with a modern yacht, Saluzi is an expression of both East and West. It is a blending of spirituality and materiality, a representation of multidimensional thinking.’ says Li Jiwei.

DESIGN

Inspired by the notion of an ultra-chic floating beach house, Saluzi is a truly modern sanctuary for family and friends that combines both the space and privacy essential for creating a relaxed atmosphere in which to recharge and reclaim time.

The yacht was designed by Miami based designer Luiz de Baso and his team, the results of their work is stunning. “The briefing for the Saluzi interior team was, from day one, to think different, to be original. Although we did not know where this would lead, the owners knew exactly what they did not want. They did not want to play it safe, they were not afraid to take risks. It was a good time for us to be creative, to get inspired”, says de Basto.

SERVICE

With a crew of 35, Saluzi is as you wish it to be. Whether you prefer a more formal setting or a relaxed style of living, everything is arranged to suit. From breakfast to the varied dining experiences available on-board, the pleasures of great food, excellent wines and convivial company is an integral part of the Saluzi experience.

The adventures at sea can range from just lounging in one of the two jacuzzi pools on the sun deck or diving in some of the world's prime spots and more. The water toys offer exhilaration and Saluzi's beach barbeques are simply legendary.

Both a salon and a wet spa are available for relaxing after a session in the on-board gym. As night falls, the dining room can be changed to a karaoke lounge or you can move up to the sundeck for a movie under the stars.

We have created Saluzi so that there is something for everyone and we have done everything we can to make sure the happy memories you take home last until we see you again!



SUN DECK



295 sqm total area
Outdoor Cinema
2 Jacuzzis















BRIDGE DECK



310 sqm total area

2 Master Suites

Private Salon











Bridge Deck Salon



Master Suites



UPPER DECK

561 sqm total area

6 VIP Suites

Gym

Spa

Hair Salon

99 sqm Main Salon







Upper Deck Salon



VIP Cabins



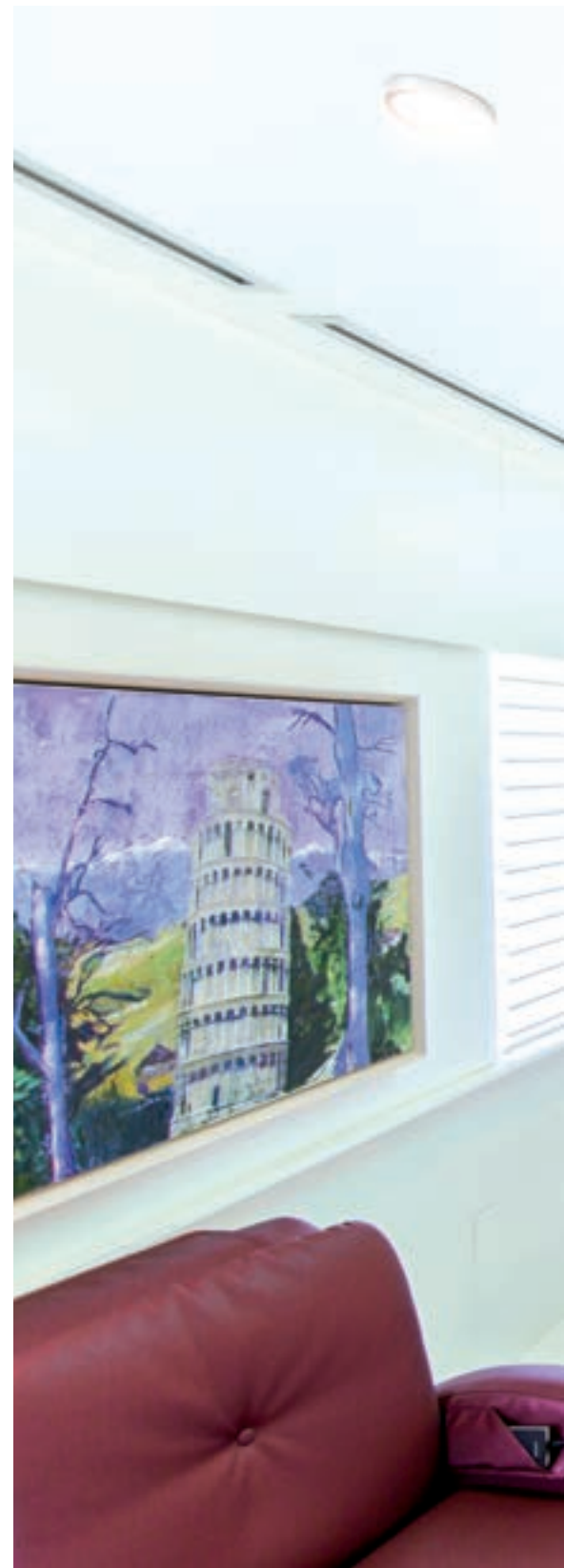









Above : Gym
Right : Spa



MAIN DECK



459 sqm total area

1 Vip Suite

7 Deluxe Cabins

Dining Room

Karaoke Lounge

Office







Main Deck Salon









Above : Foyer
Left : Deluxe Cabin





LOCATIONS

Indian Ocean
South-East Asia
Andaman Islands
Burma
China
Hong Kong
Indonesia
Japan
Korea
Malaysia
Maldives
Palau
Philippines
Singapore
Thailand
Vietnam
Mediterranean
Croatia
France
Greece
Italy
Montenegro
Spain

Charters in other locations can be arranged on request

TENDERS & WATER TOYS

Castoldi Jet Tender
Avon Penta Tender
Yamaha FX cruiser
Yamaha FX
Seabob – Cayago F7 & F5
Hobie Cat sailboat
Glass bottom kayak
Jet board – white adventure
Wake boards
Stand up paddle boards
Skurfboard
Kneeboard
Water skis
Inflatable toys
Floating mat
Dive rig & bcd incl. compressor
Snorkelling equipment
Fishing equipment
Swimming pool



DECK ARRANGEMENT

1. Sun Deck 295 sqm

2. Upper Deck 561 sqm

3. Bridge Deck 310 sqm

4. Main Deck 459 sqm

5. Lower Deck

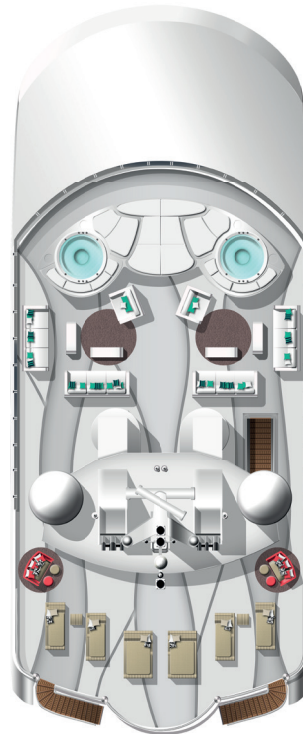

1.

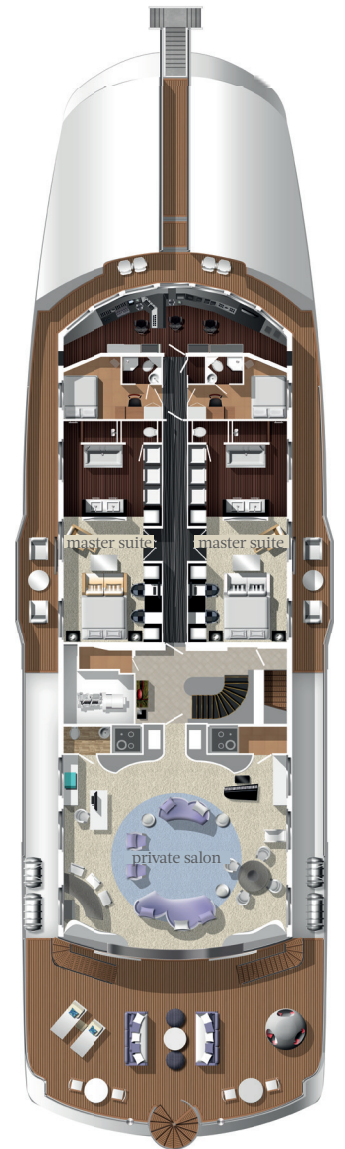

2.

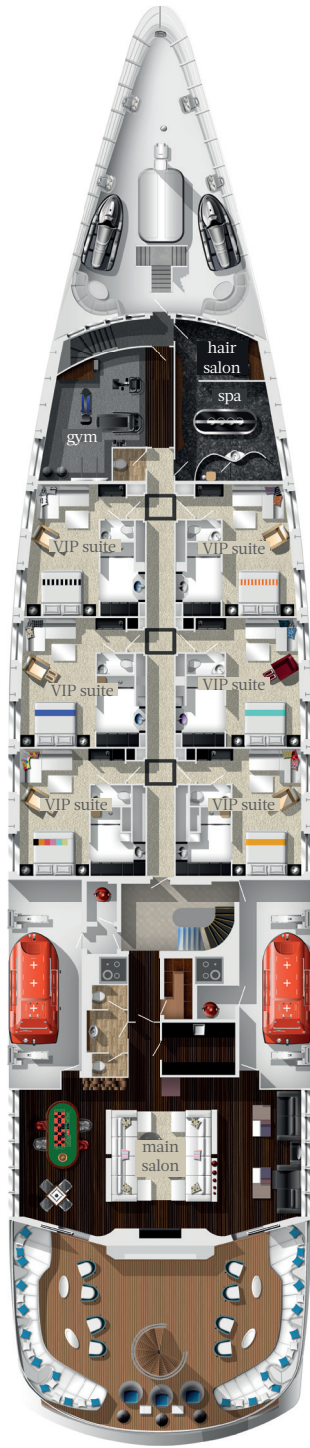

3.



4.

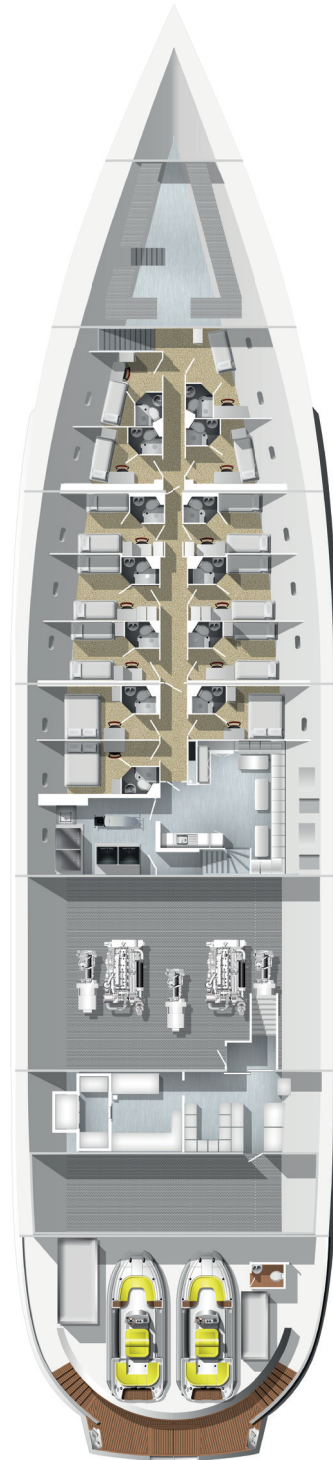

5.

SPECIFICATIONS

Vessel type: Aluminium Alloy Mono hull cruise yacht of round bilge design

DIMENSIONS

Length overall: 70 m / 226.71 ft

Length waterline: 59,40 m

Beam (moulded): 13,80 m

Hull depth (moulded): 4,80 m

Maximum draft: 2,40 m

Air draft: 19,30 m

IDENTIFICATION

Shipyard: Austal

Build: 2003

Refit: 2014

Flag: Maltese

Guests sleeping: 32

Guests cruising: 32

Number of Cabins: 32 Guests in 16 cabins

Crew: 35

TONNAGE

Gross tonnage: 1739

Net tonnage: 548

Keel Laid May: 2003

CLASSIFICATION: BUREAU VERITAS

Hull: Class 1 passenger ship summer zone

Machinery: AUT-UMS

Cruising speed: 12.00 kt



