

Z Below

Technical Specifications & Inventory

470 Florida Street, San Francisco, CA, 94110

CONTACT

Director of Production: Drew Yerys
dyerys@zspace.org

Theater Manager: Wolfgang Wachalovsky
wolfgangw@zspace.org

CAPACITY

Z Below has a total capacity of **90 people** *Including* staff and performers
Permanent seats: 73
Folding Seats: 12 (can only be added to front floor row)

RESTRICTIONS

ACCESS TO THE THEATRE IS NEVER ALLOWED BEFORE 9am OR AFTER 11:59pm

NOT PRESENT IN Z BELOW: Freight Elevator, Loading Dock, Wireless Microphones

PARKING

During weekday business hours parking in the neighborhood can be difficult to find.

STAGE

The stage is composed of Masonite over plywood. The walls surrounding the stage are sheet rock. A structural **(non-removable)** column 2' in diameter divides the stage on the downstage left edge.

PLEASE NOTE: DRILLING/SCREWING into deck or walls is NOT ALLOWED.

DIMENSIONS

Stage Opening:	20'8	from SR Corner to SL edge of column
Ceiling Height:	13'2	
Grid Height:	11'6	
Stage Depth:	24'1.5"	at Center
Moat (Floor row):	4' with row / 5'8.75"	without row
Stage Floor:	5.75"	high

DRESSING ROOMS

The dressing room can hold up to 10 people and is located upstage left. It is equipped with make-up lights, a sink, a refrigerator and a restroom. Also available for use: ironing board, iron, steamer.

PLEASE NOTE: THERE ARE NO LAUNDRY FACILITIES ON SITE.

ALSO NOTE: There is NO EXIT from the dressing room EXCEPT to upstage left. **(No lobby access)**

LOADING

ALL LOAD-IN AND OUT MUST HAPPEN THROUGH THE FRONT DOOR OF THE THEATRE.

There are stairs leading down to the theatre from the front door. Stair dimensions are as follows.

Doorway: 6' 11" high, 5' 10" wide. Stairs are 3'8" wide between the handrails, which are 3' 8" tall.

The minimum floor to ceiling clearance on the stairs is 7'1".

ALL SETS & MATERIALS MUST BE LOADED OUT - NO ONSITE DUMPSTERS

Z Below is appropriate for final assemblage of sets - NOT for general set construction. USE OF SAWS IS NOT PERMITTED ON THE STAGE. USE OF SPRAY PAINT IS NOT ALLOWED IN THE THEATRE OR ON THE SIDEWALK.

STAGE LAYOUT

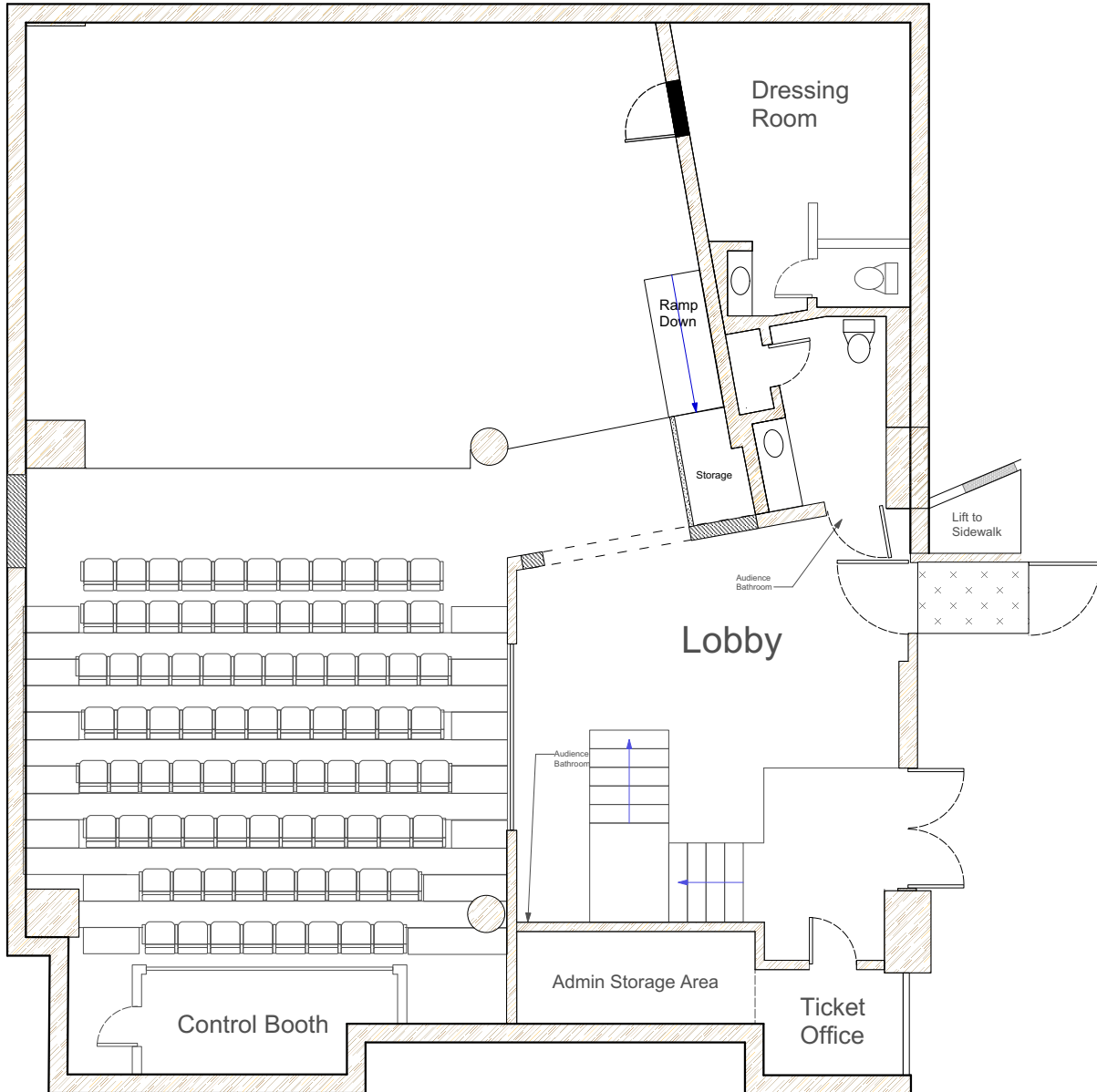

LIGHTING***** 48 DIMMERS TOTAL *******CONTROL**

ETC Express 24/48 Console

DIMMING

1	Strand CD-80 pack	24 Channels @ 1.2Kw
1	ETC Sensor Rack	24 Channels @ 1.2Kw

CIRCUITING

Five 8 Channel multis at fixed points in grid.

All multis have fan-outs of various lengths

All multis are run to the dimmers in loft

COLOR

A limited amount of color and gobos are in stock.

INSTRUMENTATION

15	Altman 6" Fresnels
10	Altman Par 56
4	Altman Par 64
3	ETC Source-4 Pars
4	ETC Source-4 Jr. 36°
13	ETC Source-4 Jr. 50°
3	ETC Source-4 50°
3	L&E Mini-Strips

CABLE

10	5' & Under
8	10'
6	15'
3	20'-25'
1	50'
24	Two-fers

MISC

10	Feds
3	Meds
2	6" Top Hats
2	Source-4 Top Hats
8	Floor Mounts
2	Side Arms

SOUND

PLEASE NOTE: Z Below is a very acoustic space. Sound levels shall **NOT exceed 95db**s during rehearsals OR performance. No amplified sound after 11:30pm and before 12noon on Saturday & Sunday

FOH MIXING CONSOLE

Mackie 1402 VLZ

FOH MAIN PA

2 Meyer UPL2

ADDITIONAL SPEAKERS

1 Mackie SRM 450
2 Mackie SRM 350
2 JBL Control 1
1 Peavey Solo Amp

PLAYBACK

1 iMac Running Qlab V3 Pro Bundle
1 Focusrite Sapphire Pro14 Audio Interface

MICROPHONES

2 Shure BG 4.0 Condenser
1 Shure SM58 Dynamic

CABLING

1 100' Audio snake run from booth to stage (DSR) 12x4
Limited XLR 5'-25'

PLAYBACK

1 iMac Running Qlab V2
1 Focusrite Sapphire Pro14 Audio Interface

MIC STANDS

3 Boom Stands
1 Straight Stand
1 Table stand

SOUND

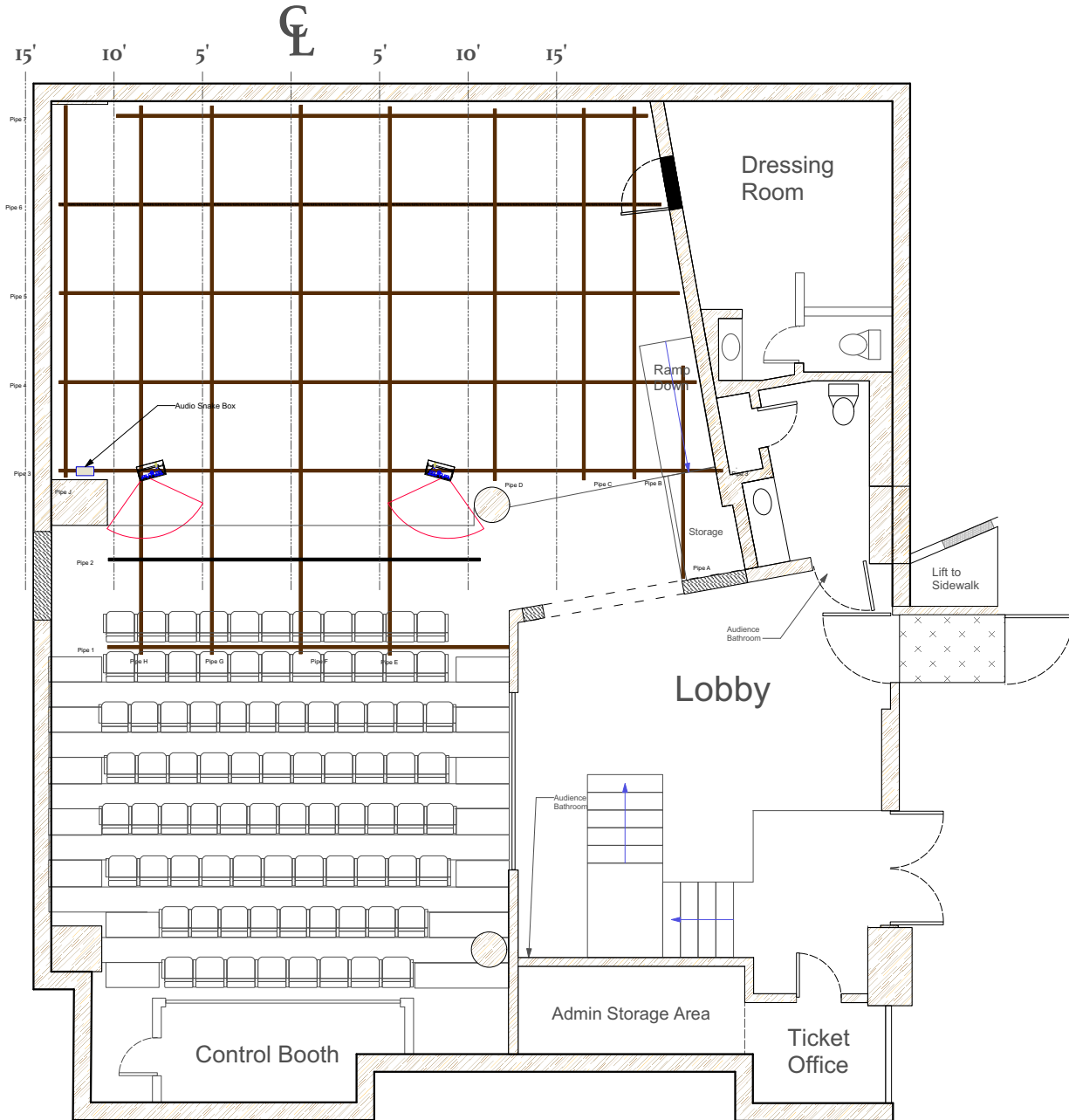

VIDEO

A **Panasonic PT-VX510 projector** is available to rent for an additional **\$250/wk.**

A limited amount of VGA & HDMI cables are available for use.

ADDITIONAL INVENTORY

SOFT GOODS

4	Legs	4'w X 11'5"h	Black
2	Legs	12'w X 11'5"h	Black
2	Panels	23'w X 11'5h	Shimmer Blue

COM SYSTEM

Clear-Com wired headsets, single working channel. One fixed position in booth, one in dressing room

ACCESS EQUIPMENT

1	6' Ladder
1	8' Ladder
1	10' Ladder

EXPENDIBLES

Z Below does NOT supply production expendables (gaff tape, tie line, gel, batteries, etc).

JCX Expendables is within walking distance and can be reached at 415.824.4110.

RENTAL REFERENCES

Audio - BBI Engineering: 415-695-9555

JK Sound: 415-826-6864

Delicate Productions: 415.484.1174

Lighting - DTC: 510.595.3456

Holzmueller: 415.826-8383

Video & Staging - Oaktown Productions: 510.385.5662

McCune: 650.873.1111

Island Creative: 415.834.0641