

Mi Sueño *My dream.*



Luxury, Style and Comfort

Mi Sueño's décor is a *tour de force* for the acclaimed designer, Patrick Knowles, who describes his vision for the yacht's ambiance as urban contemporary. Entering from the main aft deck, wine aficionados will be delighted with the floor-to-ceiling stainless steel and glass wine refrigerators lining either side of the "wine cellar". Housed below are custom wormwood cigar humidors. The tumbled marble mosaic floor, curved leather benches and end tables in petrified wood complete this unique area which is ideal for an impromptu wine tasting.



Main Salon 927 Sq. Ft.

Four different species of wood warm the salon and adjacent dining room - Honduran mahogany, European maple burl, Australian lacewood, and wenge from Africa. The woods are unstained and simply treated for a light sheen allowing their intrinsic beauty to take center stage.

Relaxed contemporary style



The visually striking cosmos granite floor of the main deck foyer echoes the repeating circle motif leading to the central stairway, wheelchair accessible elevator and powder room.





The split-level master suite offers a private oasis. The bedroom is located on the top level with the king-sized bed facing a surround of windows. A private lounge is located on the lower level. Abundant cabinets and walk-in closet space provide generous storage. The suite is entered via a private study with desk and sofa leading to the hallway with his and hers bathrooms.



Split-Level Master Suite 1,052 Sq. Ft.

FULL BEAM MASTER SUITE



Guest Accommodation Deck

1,594 Sq. Ft.

Located on the lower deck off the wide hallway are five spacious *en suite* guest staterooms decorated with understated elegance including the VIP king aft, 2 kings amidships, 1 queen (handicap accessible) forward on the port side and 1 twin (with Pullman bed) forward on the starboard side.



FULL BEAM VIP SUITE 415 Sq. Ft.



For added flexibility, and with select luxury charter in mind, a seventh *en suite* stateroom is located on the bridge deck. Equipped with four Pullman beds, this stateroom converts to a massage/exercise room complete with a steam shower.



VIP BATH



Skylounge



The skylounge continues the theme of a relaxed, contemporary style. The room's focal point is the bar topped with Tiger's Eye, a South African semi-precious stone. The stone's rich yellow and brown stripe pattern complements the fabrics of the plush furniture. Additional skylounge features include a 60" flat screen TV with true surround sound and a game table for six players. Panoramic oversized windows and glass doors to the aft deck add the finishing touch to this popular gathering place.



Outdoor Living

3,750 Sq. Ft.

The raised section of the main deck aft effectively creates a veranda. The trend-setting Sutherland furnishings can be re-arranged as desired.

Indulge in *alfresco* dining for up to 12 on the skylounge deck aft in air-conditioned comfort.



MAIN DECK



SUNDECK



SKYLOUNGE DECK



Free of toys and tenders, the massive sundeck is all play but with a practical side too; the aft area is certified as a touch-and-go helipad. Loose teak deck chairs and loungers invite *ad hoc* groupings for private conversation. The entertainment area forward includes a casual dining/game table, wet bar and the Jacuzzi plus plunge pool with elevated sun pads on either side. An observation settee with table overlooks the bow as the voyage progresses.



SUNDECK

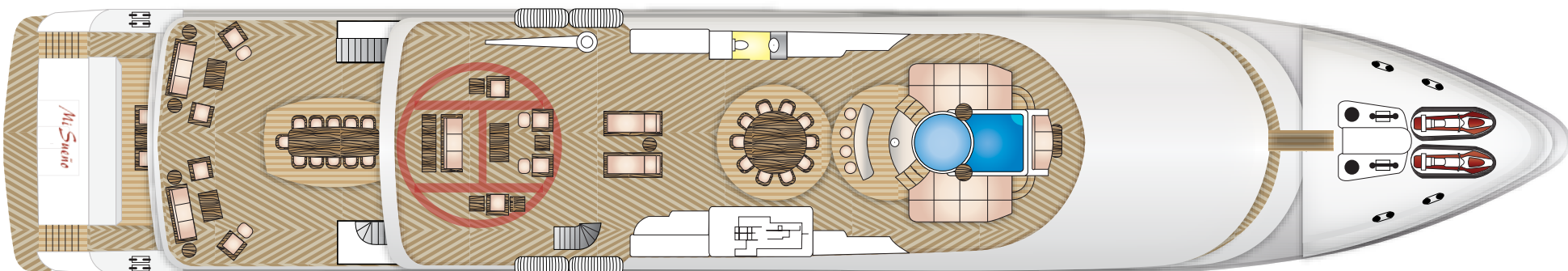

SKYLounge DECK

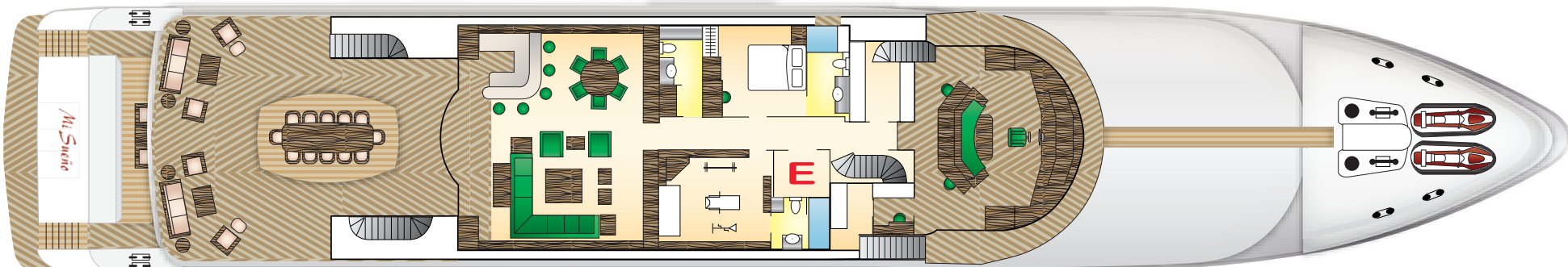

MAIN DECK

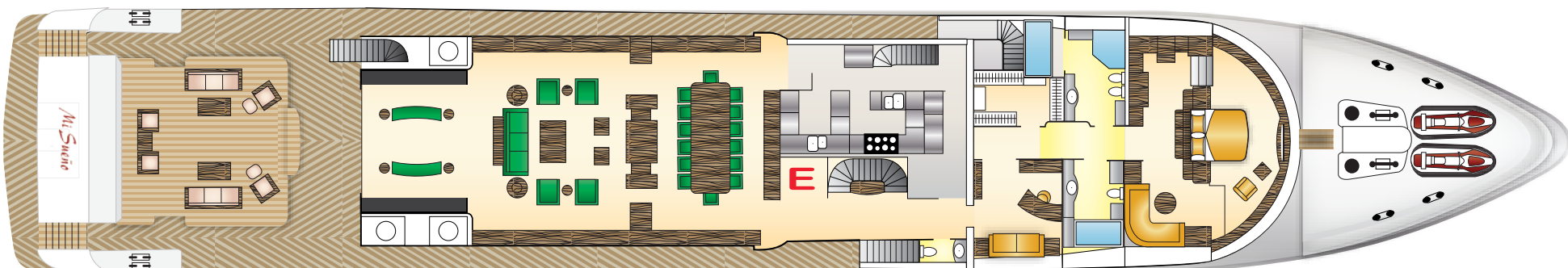

LOWER DECK

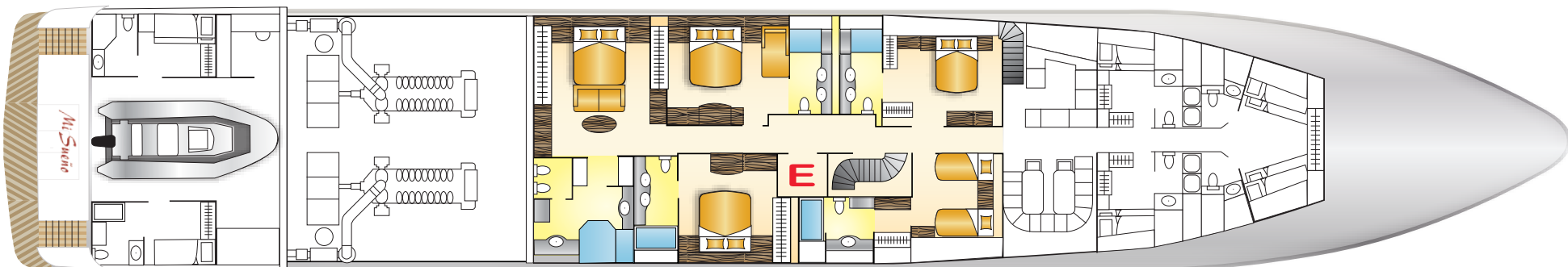

Cruising in Comfort

The state-of-the-art pilothouse falls right into step with Mi Sueño's urban feel. The large leather settee welcomes guests to observe the complex instrumentation of the captain's command station in action.

CAPTAIN/CREW QUARTERS 1,213 Sq. Ft.



PILOTHOUSE 378 Sq. Ft.



Specifications

LENGTH: 190' (57.9 m)
 BEAM: 33'5" (10.2 m)
 DRAFT: 8'6" (2.6 m)
 YEAR COMPLETED: 2010
 BUILDER: Trinity Yachts
 EXTERIOR DESIGNER: Trinity Yachts
 INTERIOR DESIGNER: Patrick Knowles
 HULL CONFIGURATION: Semi-Displacement
 HULL CONSTRUCTION: Aluminum
 FLAG: Cayman Islands
 CLASSIFICATION: ABS
 MCA COMPLIANT: Yes / Commercial Registration
 MAIN ENGINES: 2 x Cat 3516-CHD 3,384 hp
 STABILIZERS: At Anchor (zero speed)

FUEL: 22,000 g (83,270 l)
 WATER: 3,500 g (13,248 l)
 WATERMAKERS: 2,500 gpd (9,463 lpd)
 SPEED: Cruise 17 kts / Max 21 kts
 STATEROOMS: 7
 GUEST SLEEPS: 15
 CREW CABINS: 7
 CREW SLEEPS: 14

Custom audio-visual system with Kaleidescape central movie/music server, Crestron remote control, WiFi and satellite TV throughout (surround sound in the skylounge, main salon, and master suite).
 Exercise equipment: Treadmill, Elliptical Trainer

Photos: Jim Raycroft _ Design and Production: IYC. Fort Lauderdale, FL 1010

The garage stores a 23' Novurania tender and the 5,500-pound davit along with 4 SeaDoo waverunners, a wide array of watersport equipment and beach gear.

"Beautiful Dreamer, out on the sea..."
Stephen Foster

