



# Rise & shine

A stylish Leicht kitchen stands strong within this huge, open-plan space thanks to a striking melange of contrasting tones and textures

Report: Felicity Borthwick Photography: Sharin Johal





**W**hen the village of Hanwell first formed back in medieval times, a natural spring provided the social centre for the community. Today there are many popular modern-day watering holes for residents of the area – the Kings Arms and Fox Inn to name a few – but for Kieran and Elaine Redmond they need look no further than their own beautiful new kitchen, which sits within a vast open-plan room overlooking the garden and provides a wonderful space for entertaining.

“We have a four-year-old son, Eoghan, and both come from big families so we wanted to create a large area we can enjoy with our loved ones,” explains Elaine. Thus, they decided to extend out the back and side, as well as convert a loft – a mammoth task for anyone but one made slightly less daunting by the fact that Kieran runs his own building company and could build and project-manage everything himself.

With the extension well underway, the couple then approached Joe and Sharan Johal of Vogue Kitchens about creating a kitchen for the new space. “We’d seen the company’s work in KBB, which really appealed to us, so went down to the showroom armed with some clippings of designs we like,” recalls Elaine.

“We already knew that we wanted a grey kitchen with an island in a different colour and when we arrived at the showroom there was this Leicht model on display, which we fell in love with straight away,” she continues. “We talked through all our requirements with them then and there – Kieran spoke to Joe about our measurements, while I discussed appliances and cabinetry with Sharan. The next time we saw them they had plans drawn up that were pretty much perfect. So that was it, just two visits, and amazingly we had our kitchen picked,” Elaine marvels. “We spent more time choosing the tiles and wallpaper!”

Nestled into the front right-hand corner of the room, the kitchen comprises textured wood-grain lacquered doors in Basalt Grey, which wrap around two adjacent walls, and high-gloss acrylic doors in Frosty White on the island. “The Redmonds wanted

the kitchen to be quite predominant in the space rather than just blending in, which was achieved by using this dark finish on all the wall units,” explains Sharan. “However, then we used white on the island to break it up and establish contrast.”

The vivid aubergine splashback also gives the kitchen presence and creates a visual tie with the living area where a sumptuous purple rug and cushions provide colour and softness. “I love purple and we have a lot of it in other rooms so it seemed like a perfect choice,” says Elaine. “It also works really well with the grey floor tiles and cabinetry.”

Worktops are also in grey or white to coordinate with the kitchen. Diresco stone quartz in Beach Medium Grey flows over the base units, seamlessly incorporating an induction hob into its surface. Meanwhile, white Silestone wraps around the island, as does a slab of Zirconium Silestone to form the breakfast bar. “The island design was very much governed by space restrictions as the Redmonds wanted to incorporate a seating area but without encroaching into the living area,” explains Sharan. “Moreover, by raising the bar up 100mm it conceals cooking clutter from guests in the dining or living zones.”

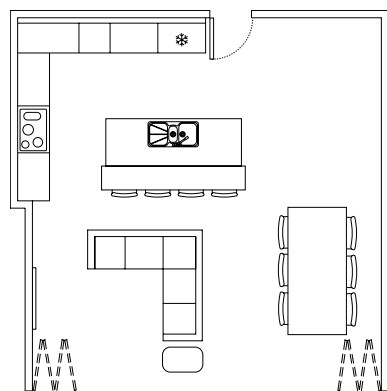

Previous page (p127): The wrap-around breakfast bar was on display in Vogue’s showroom and when we saw it we just had to have it,” smiles Elaine. “The grey works so well with the white too.” Reduced-depth cupboards have been built along the back of the island for additional storage.

Opposite page: The Redmonds had a huge rectangular skylight incorporated into the ceiling of the rear extension. Combined with full-height glazing along the back wall, this bathes the room in natural light all day long for a bright, airy feel.







Opposite page: A pitched skylight enhances the sense of volume in the living area and channels light down into the room at various angles. The higher ceiling also adds to the sense of drama and grandeur in here.

Right: Tucked within a wallpapered alcove, this sophisticated drinks cabinet from Hülsta complements the kitchen beautifully with its combination of gloss white and glass doors and luxurious wood framing.

Below: Leicht cabinetry in a luxurious Basalt Grey finish defines the kitchen space to give it presence within the vast open-plan room. The Redmonds love to entertain so a breakfast bar and wine storage unit were essential features.



Despite occupying just a corner of the room, the kitchen boasts copious amounts of storage thanks to clever planning that utilises every bit of available space. Floor-to-ceiling housing conceals a huge 900mm pantry and also accommodates a sizeable side-by-side fridge-freezer and two ovens, while wall and base units extend along the adjacent wall. Storage is also offered on both sides of the island. "Elaine wanted us to take the wall units right to the ceiling to get some additional shelving in and we have also incorporated a carousel unit in the corner, with four shelves that come all the way out so you don't waste any space, not even at the very back," explains Sharan.

Another feature that the Redmonds value highly within their kitchen is its ease of maintenance. Elaine stipulated that she wanted something easy to clean - "I'm a bit obsessed with cleaning, that's why I chose an induction hob" - and fortunately this is an area where Sharan excels. "I always like to make kitchens as low maintenance as possible as I do a lot of cooking myself," she explains. "The textured lacquer doors are much easier to keep clean than gloss, and white worktops show up a lot less than black. What's more, one of the ovens is pyrolytic and even the telescopic extractor requires minimal work - you just take the filters out and place them in the dishwasher," she adds.

Without doubt, this is a truly fabulous space for entertaining; the interior is bright and airy, there's plenty of comfortable seating - both at the bar and table - and it's easy to maintain. What's more, the stylish furnishings and connection with the garden make it a beautiful room to just relax and spend time in. KBB







## SourceBook

### DESIGN

Building Delmond Construction (020 8326 5686)  
Kitchen Sharan and Joe Johal of Vogue Kitchens  
(020 8997 5400 or [www.voguekitchens.co.uk](http://www.voguekitchens.co.uk))

### KITCHEN

Cabinetry Avance range in Basalt Grey (on wall) and high-gloss acrylic in Frosty White (on island), both by Leicht ([www.leicht.de](http://www.leicht.de)) from Vogue Kitchens, as before

Worktops Engineered stone kitchen worktop in Beach Medium Grey by Diresco ([www.diresco.be](http://www.diresco.be)) and island worktop in Blanco Zeus, Silestone ([www.silestone.co.uk](http://www.silestone.co.uk)), both sourced by Vogue Kitchens, as before  
Breakfast bar Zirconium from the Platinum range, Silestone, as before  
Appliances Single oven, microwave, induction hob, extractor and wine storage unit, all Siemens (0844 892 9044 or [www.siemens-home.co.uk](http://www.siemens-home.co.uk))

Taps Mythos, Franke (0161 436 6280 or [www.franke.com](http://www.franke.com)) and Pro 3 'Design' boiling-water tap, Quooker (02079233355 or [www.quooker.co.uk](http://www.quooker.co.uk))

Sink Kubus, Franke, as before  
Splashback Glass in Aubergine, Deco Glaze (020 8569 8585 or [www.decoglaze.co.uk](http://www.decoglaze.co.uk))

Wallpaper and lights (above island) Fishpools (01992 636465 or [www.fishpools.co.uk](http://www.fishpools.co.uk))

Sofa Harveys (0844 847 2626 or [www.harveysfurniture.co.uk](http://www.harveysfurniture.co.uk))

Coffee table Calligaris from Mac and Mac Interiors (01252 717771 or [www.macandmacinteriors.com](http://www.macandmacinteriors.com))

Rug Carpets 4 Less (01767 600013 or [www.carpets4less.com](http://www.carpets4less.com))

TV unit, dining table and chairs Hülsta (020 7318 8000 or [www.huelsta.co.uk](http://www.huelsta.co.uk)) from BeadleCrome (0118 324 0327 or [www.beadleandcrome.co.uk](http://www.beadleandcrome.co.uk))

Drinks cabinet (against wallpaper) Hülsta from BeadleChrome, as before

### COST

A similar kitchen from Vogue Kitchens would cost from around £25,000

Above: Glossy materials such as porcelain floor tiles, a Silestone worktop and glass splashback bounce around light that pours through. Three elegant pendants, meanwhile, have been suspended above the island to anchor the unit within the huge, open area and provide some task lighting.

Below: The juxtaposition of smooth colourful glass with dark, textured cabinetry adds impact and depth to the kitchen design. A series of small lights sit flush with the underside of the wall unit to throw light down onto the work area.

