

MAP REFERENCE

TOPOGRAPHIC SURVEY MAP OF LANDS AT 87-93 NORTH CHESTNUT STREET, NEW PLAZA, N° 12961" dated November 20, 2015 by Santo Associates, P.C., Clifton Park, N.Y.
 FIRM FLOOD INSURANCE RATE MAP, ULSTER COUNTY, NEW YORK Map Number 3611100815E, Effective date September 25, 2009.

S.B.L.# 86,026-1-10,12
 #12 Mulberry Street
 Lands n/f of
 Spencer
 L.1760 p.212

S.B.L.# 86,026-1-10,2
 #130 Huguenot Street
 Lands n/f of
 McLaughlin
 L.5828 p.126

S.B.L.# 86,026-1-10,112
 #134 Huguenot Street
 Lands n/f of
 SCOTT
 L.1429 p.149

S.B.L.# 86,026-1-10,111
 #140 Huguenot Street
 Now or formerly
 Nyquist
 L.2974 p.27

S.B.L.# 86,026-3-7
 Now or formerly
 BURGE
 L.2177 p.184

Lands of
 The Village of New Paltz
 L.2063 p.261
 ("Walkkill Valley Rail Trail")

S.B.L.# 086,026-1-15
 #113 North Chestnut Street
 Lands n/f of
 Stoute & Annastas
 L.4007 p.268

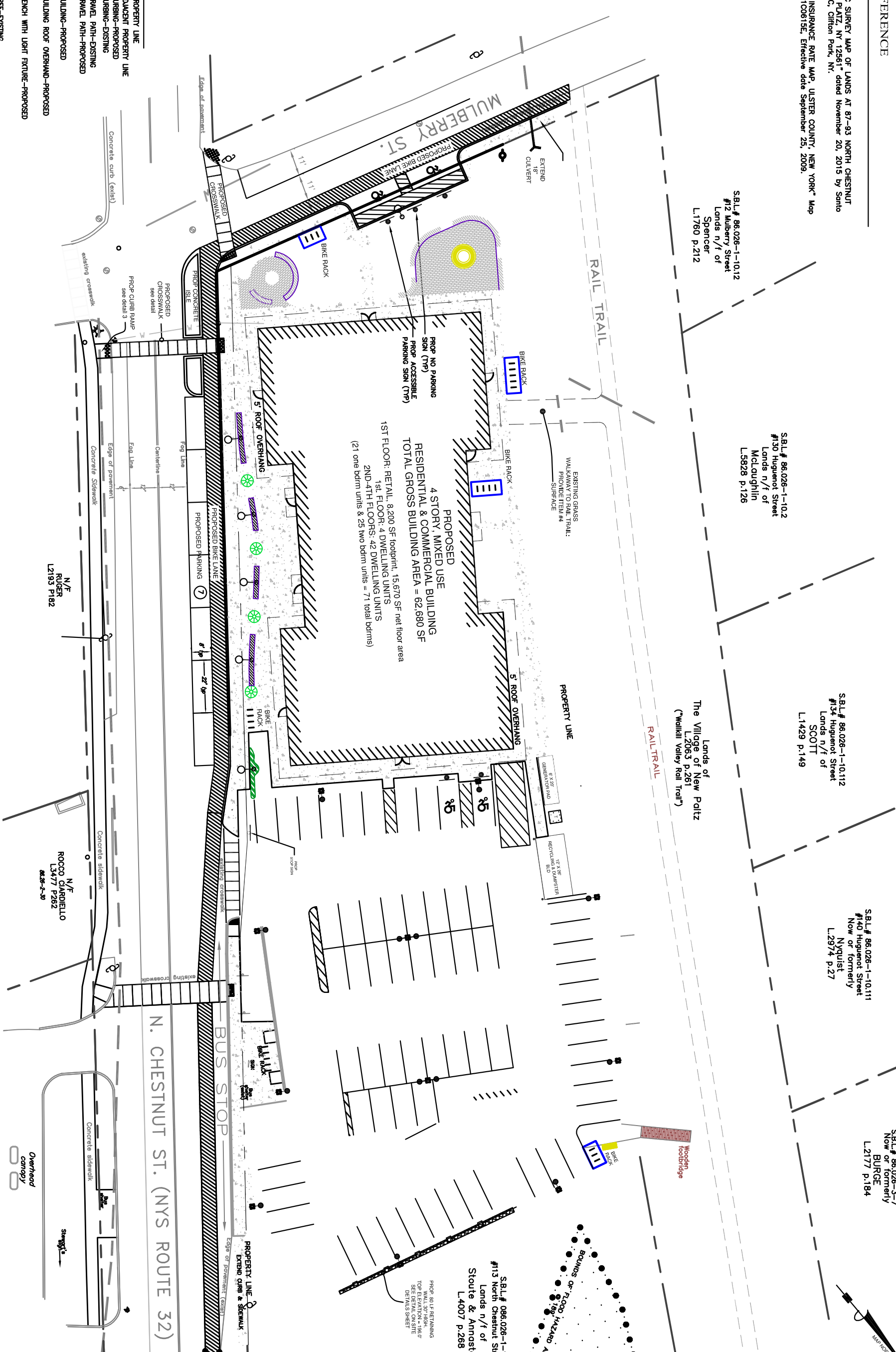

LEGEND

- PROPERTY LINE
- ADJACENT PROPERTY LINE
- CURBING-PROPOSED
- CURBING-EXISTING
- GRAVEL PATH-EXISTING
- GRAVEL PATH-PROPOSED
- BUILDING-PROPOSED
- BUILDING ROOF OVERHANG-PROPOSED
- BENCH WITH LIGHT FIXTURE-PROPOSED
- TREE-EXISTING

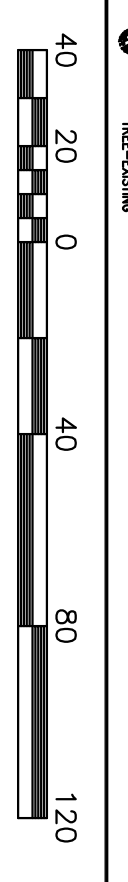

MEDENBACH & EGGERS
 CIVIL ENGINEERING & LAND SURVEYING, P.C.
 STONE RIDGE, NEW YORK (845) 687-0047
 www.mecels.com

ZERO PLACE
 SITE PLAN - ALTERNATE BIKE LANE ON RT 32
 3/24/2017

Sheet 1 of 1