

Data Sheet



Helping Engineer the Technology of Power

ICE Components, Inc.

Tel 678-560-9172 Fax 678-560-9304

cust.serv@icecomp.com

www.icecomponents.com

1165 Allgood Rd., Ste. #20, Marietta, GA 30062

Mechanical Drawing

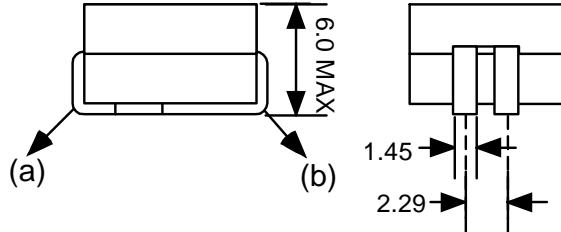
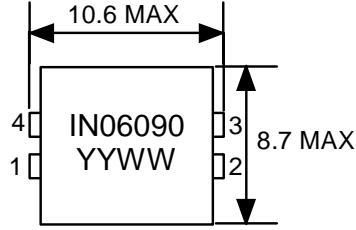

unit:mm

General Information

Customer	
Part Number	IN06090
Revision	0
Description	Inductor
Date	AUG-07-2009
Reference	--
Doc Control #	--
Issue(For ICE use only)	--

Specification

Sample Test Data

Item	Pins	Spec	Test Condition	Sample Test Data
Inductance @0Adc	1 - 3	600 nH +/- 15%	1 MHz, 0.1Vrms, series	
Inductance @Isat at 25degC	1 - 3	430 nH min	1 MHz, 0.1Vrms, series (26Adc)	
	1 - 3	320 nH min	1 MHz, 0.1Vrms, series (32Adc)	
DCR	1 - 2	0.63 mOhm +/- 10%	+25 deg C	
	4 - 3	0.63 mOhm +/- 10%		

Schematic

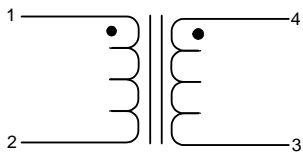

Footprint

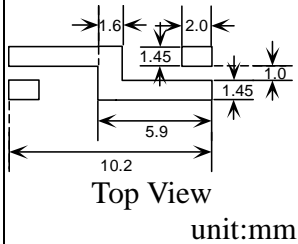

Recommended PCB Layout

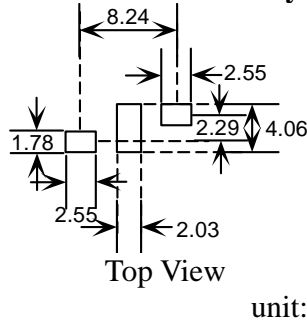

Remark

1. Isat is the current at which the inductance drops by 20%.
2. Inductance vs. Current Curve as attached.
3. This is RoHS compliant product.
4. The nominal DCR is measured from point (a) to point (b), as shown on the mechanical drawing.

Sample approval is required before release to production. Sample specifications take precedence over customer specifications.

Rev.	Description	PRD	CHK	APP	Date	NTFY
0	Initial release	Emily	Gary	L. L. Chou	2009/8/7	2009/8/7

Customer Signature

Inductance VS Current

