

An aerial photograph of a river system. A large, dark green reservoir is the central focus, with a river winding through it and extending downwards. The surrounding landscape is a mix of light brown and tan, suggesting a dry or semi-arid environment. The sky is filled with soft, white clouds.

# UNITING LEADERS CONFERENCE 2017

GROWING LEADERS TO GROW THE CHURCH

Tuesday - Thursday, 22 - 24 August

[unitingleaders.com.au](http://unitingleaders.com.au)

Behold, I am doing a new thing;  
now it springs forth, do you not perceive it?

*I WILL MAKE*  
*a way*  
*IN THE WILDERNESS AND*  
*rivers*  
*IN THE DESERT.*

ISAIAH  
43:19

Welcome to **Uniting Leaders 17**

We are delighted that you have taken time out of your ministry schedule to gather as leaders in the Uniting Church over these few days. This is the second gathering of Uniting Leaders since it was launched in 2016 at Newlife Uniting Church on the Gold Coast.

At the heart of the Uniting Leaders conference is the call to evangelism, mission and church growth, and our mantra has been to grow leaders who grow the church. We pray that you will be refreshed, equipped and have the opportunity to network and pray with others as we seek God together.

**Kynan Brookes**

Lead Pastor  
*Hope Valley Uniting Church*

**Rev Nigel Rogers**

CEO/General Secretary  
*Uniting Church in South Australia*

*On behalf of the Uniting Leaders Conference Committee and the President of Uniting Church in Australia, Stuart McMillan.*

**Contents**

**02**.....Venue Map

**03 - 05**.....Program

**06 - 07**.....Welcome

**08 - 19**.....Keynote  
Session Notes

**20 - 26**.....Elective Notes

**27 - 28**.....Survey

**29**..... Speaker Resources



# VENUE MAP

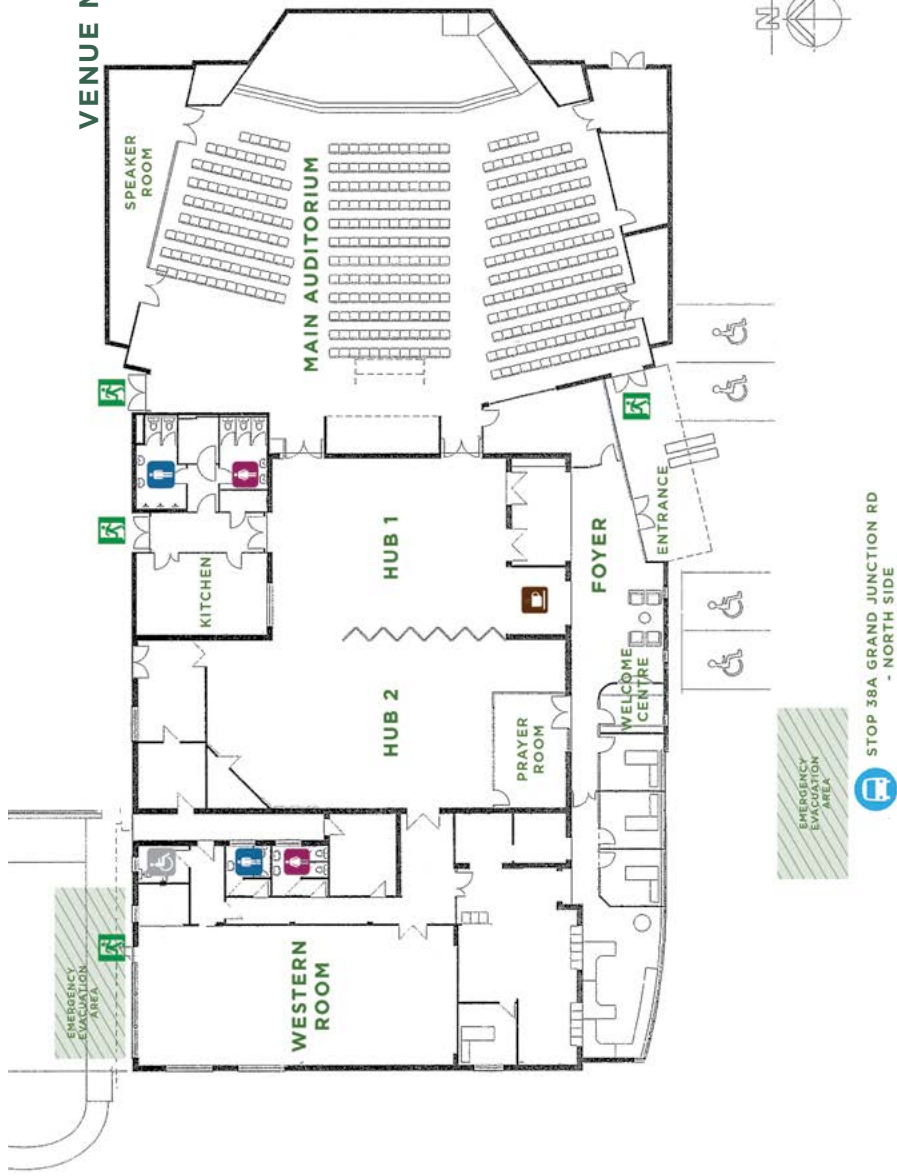

ADELAIDE CBD



STOP 38A GRAND JUNCTION RD  
- SOUTH SIDE

STOP 38A GRAND JUNCTION RD  
- NORTH SIDE

12.00PM - 01.00PM

**Welcome lunch**

*Hub 1 & Hub 2*

04.30PM - 05.30PM

**Worship & ministry**

*Auditorium*

01.00PM - 01.30PM

**Opening worship**

*Auditorium*

05.30PM

**End of day**

01.30PM - 02.15PM

**Welcome to UL17**

Kynan Brookes and Stuart McMillan

*Auditorium*

02.15PM - 03.00PM

**Introduction session**

Getting to know Mark Conner

*Auditorium*

03.00PM - 03.30PM

**Afternoon tea**

*Hub 1*

03.30PM - 04.30PM

**Keynote session**

Mark Conner - Re-imagining the Church

*Auditorium*

09.45AM - 10.15AM

**Worship**Auditorium

10.15AM - 10.45AM

**Introduction session**

Getting to know Nancy Beach

Auditorium

10.45AM - 11.15AM

**Morning tea**Hub 1

11.15AM - 12.20PM

**Keynote session**Nancy Beach - Signs of  
a healthy cultureAuditorium

12.20PM - 01.20PM

**Lunch**Hub 1

01.20PM - 02.30PM

**Keynote session**Mark Conner -  
Successful Christian ministryAuditorium

02.30PM - 03.30PM

**Elective 1**Mark Conner -  
The strategic leader\*Hub 2Nancy Beach - Men and  
women in ministryAuditorium

03.30PM - 04.00PM

**Afternoon tea**Hub 1

04.00PM - 05.00PM

**Elective 2**Mark Conner - Preaching to  
change lives\*Hub 2Nancy Beach - Church for  
the unchurchedAuditorium

05.00PM

**End of day**\* Elective will include times of Q&A  
around two key topics,  
'Leadership' and 'Communication'.

09.00AM - 09.30AM

**Worship**Auditorium

09.30AM - 10.30AM

**Keynote session**

Nancy Beach - Seasons of the soul

Auditorium

10.30AM - 11.00AM

**Morning tea**Hub 1

11.00AM - 12.00PM

**Elective 3**

Nancy Beach - Navigating transition

AuditoriumAndy Hogarth - Ministering in  
the power of GodHub 2

12.00PM - 01.00PM

**Lunch**Hub 1

01.00PM - 02.00PM

**Keynote session**Mark Conner - Habits of  
healthy leadersAuditorium

02.00PM - 03.00PM

**Closing worship**

Including communion

Auditorium

03.00PM

**End of day**

06.00PM - 07.00PM

**Optional \$10 dinner**Hub 1

07.00PM - 08.30PM

**Evening Session with worship**

Nancy Beach - God's YES to you

Auditorium



WELCOME

## REGISTRATION

---

This booklet is received along with a welcome bag and name tag after registration. For more information about registration please visit the Welcome Centre (see map on page 2).

## STALLS

---

A MediaCom bookshop and Uniting College stall will be situated in the main hub for people looking to further their Christian leadership studies or for reading material during or after the conference. MediaCom catalogues are also included in the welcome bags.

## SPONSORS

---

We are grateful to the conference sponsors: UC Invest who are sponsoring the welcome lunch, and Jordan Gauci (House Shirts) who has supplied UL17 T-shirts for this event.

## SHUTTLE BUS & PARKING

---

Free parking and four disabled car parks are available in the Hope Valley Uniting Church car park at the front and rear of the church. A shuttle bus is available from Pilgrim Uniting Church at 12 Flinders Street in the CBD. It will deliver people to and from the conference each day. Below are the scheduled shuttle bus times:

- 22 August - Departs at 10.30am - returns at 5pm
- 23 August - Departs at 7am & 9am - returns at 5pm
- 24 August - Departs at 8am & 5.45pm\* - returns at 3.15pm\* & 8.30pm.

*\*these shuttle bus times will only operate only if there are adequate numbers.*

## MEALS & COFFEE

---

Lunch, morning and afternoon teas will be offered each day of the conference, except Thursday afternoon. Water, tea and coffee will also be available at meal breaks. Barista coffee will be available for \$3.50. A coffee card can be purchased, which entitles the purchaser to five coffees for \$15.

Hope Valley Uniting Church are offering a \$10 meal to be served at 6pm on Thursday night. If you wish to purchase this meal, please do so when you register or ask any of the volunteers during the conference.



## BATHROOM FACILITIES

The main bathroom facilities are located to the left of the main auditorium. There are more toilets located at the rear of the building. The bathroom locations are indicated on the map in the program. Wheelchair access is available through the first door of the male bathroom.

## INTERNET

There is no Wi-Fi available in the conference venue.

## CHAPLAINS

There are four Chaplains available throughout the conference should you need them. Steph Tai 0417 861 065, Tony Eldridge 0418 481 955, Scott Button 0479 101 975 and Linda Driver 0458 500 655.

## FIRST AID

A First Aid officer will be on duty at all times during the conference. Please seek out a volunteer or head to the Welcome Centre if you require First Aid assistance. In the event of an emergency, please dial 000.

## EMERGENCY PROCEDURES

In the event of an emergency please follow the directions of the wardens to evacuate the building. The main assembly point is near the bus stop on Grand Junction Road in front of the church. There is a second assembly point near the playground at the rear of the building.

## GENERAL INFORMATION & ASSISTANCE

If you have a query, look out for the volunteers wearing black T-shirts and orange name tags. These volunteers will ensure your well-being and happiness for the duration of the conference - **ask them anything!**



Hi!

WELCOME













































Please assist the Uniting Leaders Planning Committee to make improvements for UL18 in order to serve you and your ministry more effectively. This survey is also available online: [unitingleaders.com.au/survey](http://unitingleaders.com.au/survey)

***Thank you for your time...***

How would you rate the event overall?

1 Poor	2	3	4	5 Average	6	7	8	9	10 Excellent

**1. How likely are you to recommend Uniting Leaders to other leaders?**

- Extremely likely
- Very likely
- Somewhat likely
- Not so likely
- Not at all likely

Comments: \_\_\_\_\_  
 \_\_\_\_\_  
 \_\_\_\_\_

**3. How convenient or inconvenient is the date, time and location of UL17 for you?**

- Very convenient
- Convenient
- Neither
- Inconvenient
- Very inconvenient

Comments: \_\_\_\_\_  
 \_\_\_\_\_  
 \_\_\_\_\_

**2. How easy was the registration process?**

- Extremely easy
- Very easy
- Somewhat easy
- Not so easy
- Very difficult

Comments: \_\_\_\_\_  
 \_\_\_\_\_  
 \_\_\_\_\_

**4. How helpful was the content presented at UL17?**

- Extremely helpful
- Very helpful
- Somewhat helpful
- Not so helpful
- Not at all helpful

Comments: \_\_\_\_\_  
 \_\_\_\_\_  
 \_\_\_\_\_





**SURVEY**

# UNITING LEADERS 2017

## 5. How engaging were the speakers?

- Extremely engaging
- Very engaging
- Somewhat engaging
- Not at all engaging

Comments: \_\_\_\_\_

\_\_\_\_\_  
\_\_\_\_\_

## 6. How organised was UL17?

- Extremely organised
- Very organised
- Somewhat organised
- Not so organised
- Not at all organised

Comments: \_\_\_\_\_

\_\_\_\_\_  
\_\_\_\_\_

## 7. How friendly & helpful were the staff & volunteers?

- Extremely friendly & helpful
- Very friendly & helpful
- Somewhat friendly & helpful
- Not so friendly & helpful
- Not at all friendly & helpful

Comments: \_\_\_\_\_

\_\_\_\_\_  
\_\_\_\_\_

## 8. Prior to the event, how much of the information that you needed did you get?

- All of the information
- Most of the information
- Some of the information
- A little of the information
- None of the information

Comments: \_\_\_\_\_

\_\_\_\_\_  
\_\_\_\_\_

## 9. What did you like or dislike about UL17?

\_\_\_\_\_  
\_\_\_\_\_  
\_\_\_\_\_  
\_\_\_\_\_  
\_\_\_\_\_

## 10. Is there anything else you'd like to share about UL17?

\_\_\_\_\_  
\_\_\_\_\_  
\_\_\_\_\_  
\_\_\_\_\_  
\_\_\_\_\_

***Thank you for completing this survey.***

Please give your completed form to the UL17 volunteers or send to Uniting Leaders, GPO BOX 2145, Adelaide SA 5001





BLOG: [nancybeach.com/blog](http://nancybeach.com/blog)

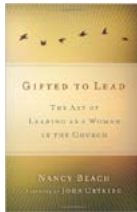

**GIFTED TO LEAD**

The Art of Leading as a Woman  
in the Church

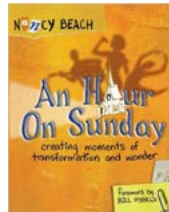

**AN HOUR ON SUNDAY**

Creating Moments of  
Transformation and Wonder

BLOG: [blog.markconner.com.au](http://blog.markconner.com.au)



**SUCCESSFUL CHRISTIAN  
MINISTRY**

Empowering Principles for Every Believer

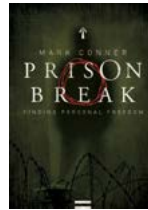

**PRISON BREAK**

Finding Personal Freedom



**TRANSFORMING YOUR CHURCH**

Seven Strategic Shifts



**PASS THE BATON**

Successful Leadership Transition



hopevalley  
uniting church



Uniting Church. **Uniting People.**