

QUICK COUPLERS

Ball Type NPT Female

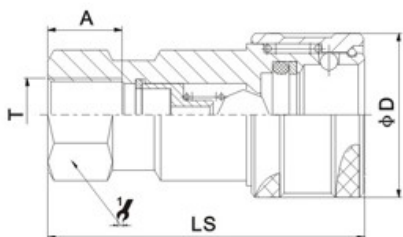

Part No	Size	Price
4050-02	1/4"	
4050-03	3/8"	
4050-04	1/2"	
4050-05	3/4"	
4050-06	1"	

Ball Type NPT Male

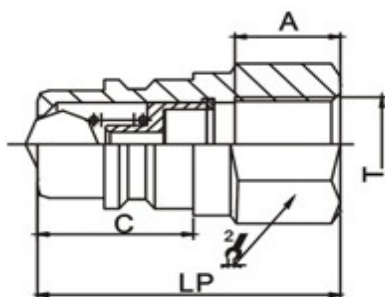

Part No	Size	Price
4010-02	1/4"	
4010-03	3/8"	
4010-04	1/2"	
4010-05	3/4"	
4010-06	1"	

Ball Type BSP Female

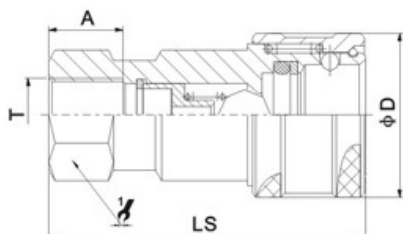

Part No	Size	Price
4050-02/B	1/4"	
4050-03/B	3/8"	
4050-04/B	1/2"	
4050-05/B	3/4"	
4050-06/B	1"	

Ball Type BSP Male

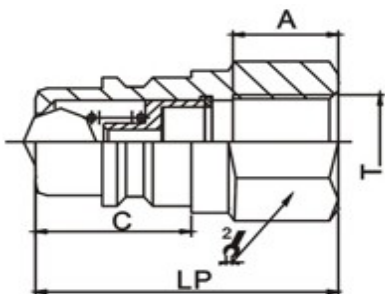

Part No	Size	Price
4010-02/B	1/4"	
4010-03/B	3/8"	
4010-04/B	1/2"	
4010-05/B	3/4"	
4010-06/B	1"	

QUICK COUPLERS

Pin Type NPT Female

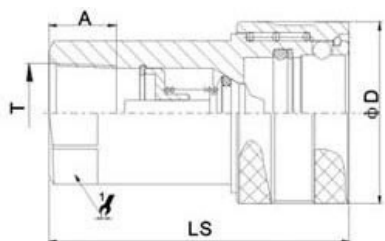

Part No	Size	Price
4050-2P	1/4"	
4050-3P	3/8"	
4050-4P	1/2"	
4050-6P	1"	
4050-7P	1 1/4"	
4050-8P	1 1/2"	

Pin Type NPT Male

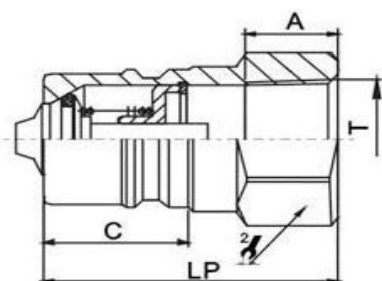

Part No	Size	Price
4010-2P	1/4"	
4010-3P	3/8"	
4010-4P	1/2"	
4010-6P	1"	
4010-7P	1 1/4"	
4010-8P	1 1/2"	

Pin Type BSP Female

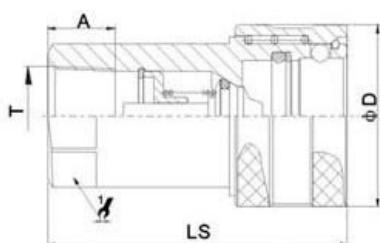

Part No	Size	Price
4050-2P/B	1/4"	
4050-3P/B	3/8"	
4050-4P/B	1/2"	
4050-6P/B	1"	
4050-7P/B	1 1/4"	
4050-8P/B	1 1/2"	

Pin Type BSP Male

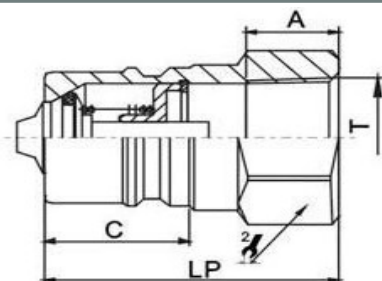

Part No	Size	Price
4010-2P/B	1/4"	
4010-3P/B	3/8"	
4010-4P/B	1/2"	
4010-6P/B	1"	
4010-7P/B	1 1/4"	
4010-8P/B	1 1/2"	

QUICK COUPLERS

Flat Faced Female

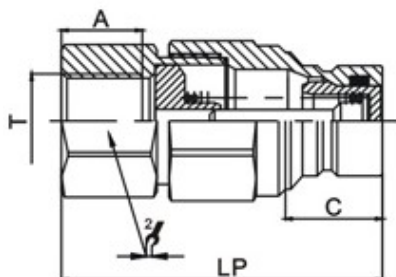

Part No	Size	Price
4050-02F	1/4"	
4050-03F	3/8"	
4050-04F	1/2"	
4050-05F	3/4"	
4050-06F	1"	

Flat Faced Male

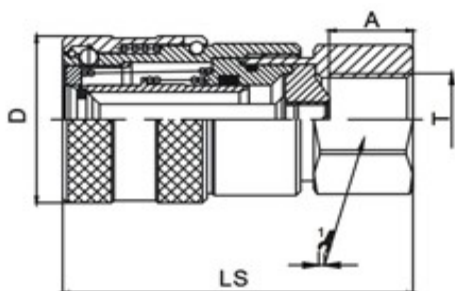

Part No	Size	Price
4010-02F	1/4"	
4010-03F	3/8"	
4010-04F	1/2"	
4010-05F	3/4"	
4010-06F	1"	

Enerpac Screw In Males

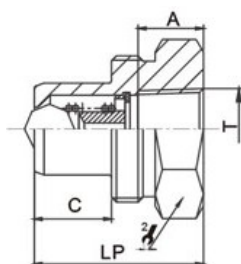

Part No	Size	Price
3010-02	1/4"	
3010-03	3/8"	
3010-02P	1/4"	
3010-03P	3/8"	

Enerpac Screw In Females

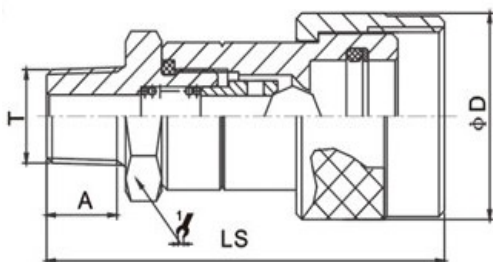

Part No	Size	Price
3050-02	1/4"	
3050-03	3/8"	
3050-02P	1/4"	
3050-03P	3/8"	