

**Register Search Statement - Volume 10547 Folio 160**

Copyright State of Victoria. This publication is copyright. No part may be reproduced by any process except in accordance with the provisions of the Copyright Act 1968 (Cth) and for the purposes of Section 32 of the Sale of Land Act 1962 (Vic) or pursuant to a written agreement. The information is only valid at the time and in the form obtained from the LANDATA REGD TM System. The State of Victoria accepts no responsibility for any subsequent release, publication or reproduction of the information.

REGISTER SEARCH STATEMENT (Title Search) Transfer of Land Act 1958

VOLUME 10547 FOLIO 160

Security no : 124065546082M  
Produced 18/04/2017 03:41 pm

LAND DESCRIPTION

Crown Allotment 3 Section 10 Parish of Connewarren.  
PARENT TITLE Volume 08623 Folio 759  
Created by instrument X007785E 29/08/2000

REGISTERED PROPRIETOR

Estate Fee Simple  
Sole Proprietor  
TRUSTPOWER AUSTRALIA HOLDINGS PTY LTD of LEVEL 23 525 COLLINS STREET  
MELBOURNE VIC 3000  
AM964744U 25/07/2016

ENCUMBRANCES, CAVEATS AND NOTICES

For details of any other encumbrances see the plan or imaged folio set out under DIAGRAM LOCATION below.

DIAGRAM LOCATION

SEE TP018285T FOR FURTHER DETAILS AND BOUNDARIES

ACTIVITY IN THE LAST 125 DAYS

NIL

-----END OF REGISTER SEARCH STATEMENT-----

Additional information: (not part of the Register Search Statement)

Street Address: CONNEWARREN LANE MORTLAKE VIC 3272

DOCUMENT END

**Delivered from the Landata ® System by SAI Global Property Division Pty Ltd  
Delivered at 18/04/2017, for Order Number 43529531. Your reference: MA.**

<b>TITLE PLAN</b>		<b>EDITION 1</b>	<b>TP18285T</b>
-------------------	--	------------------	-----------------

<b>Location of Land</b>	<b>Notations</b>
Parish: Connewarren Township: Section: 10 Crown Allotment: 3 Crown Portion:  LTO Base Record: DCMB Last Plan Reference: Title References: Vol 8623 Fol 759 Depth Limitation: nil	

Easement Information					THIS PLAN HAS BEEN PREPARED FOR LAND REGISTRY, LAND VICTORIA FOR TITLE DIAGRAM PURPOSES  Checked by <i>PM</i> .....  Date 4 / 10 / 2000 Assistant Registrar of Titles
Easement Reference	Purpose / Authority	Width (Metres)	Origin	Land benefited / In favour of	
E-1	TRANSMISSION OF ELECTRICITY	SEE PLAN	C/E K428912	S.E.C.V.	

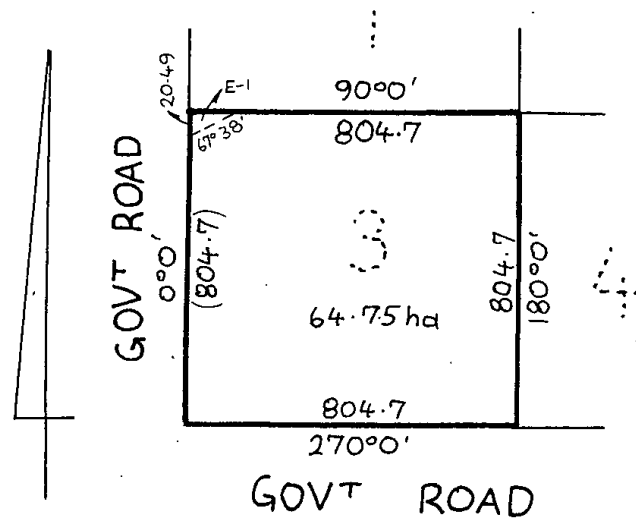

<b>LENGTHS ARE IN METRES</b>	<b>SCALE</b>	<b>SHEET SIZE</b> A3	<b>FILE NO: X007785E</b>
LAND VICTORIA 283 Queen Street Melbourne	Drawn By: Randall McDonald	<b>DEALING CODE:</b>	Sheet 1 of 1