



Flushing Meadows Corona Park Fountain of the Fairs

Located between Grand Central Parkway, the Long Island and Van Wyck Expressway, in the Borough of Queens

April 2017

Parks

GOALS

- Repurpose Existing 1964 World's Fair Fountains
- Provide Interactive Water Play
- Provide Multi-Purpose Spaces for Passive Occupation

COMMUNITY OUTREACH:

- Visioning Sessions: 4/30/2015 & 5/3/2015
- Pop-up Events: 6/28/2015 & 7/22/15
- Scope Meeting: 8/10/16
- Community Meeting: 12/13/2016
- Top Ideas:
 - World's Fair History
 - Water Play
 - Performance Space

TOTAL BUDGET: \$5 Million available FY 2018
Mayoral

PROJECT SIZE: 12 acres

Fountain of the Fairs- Site Analysis

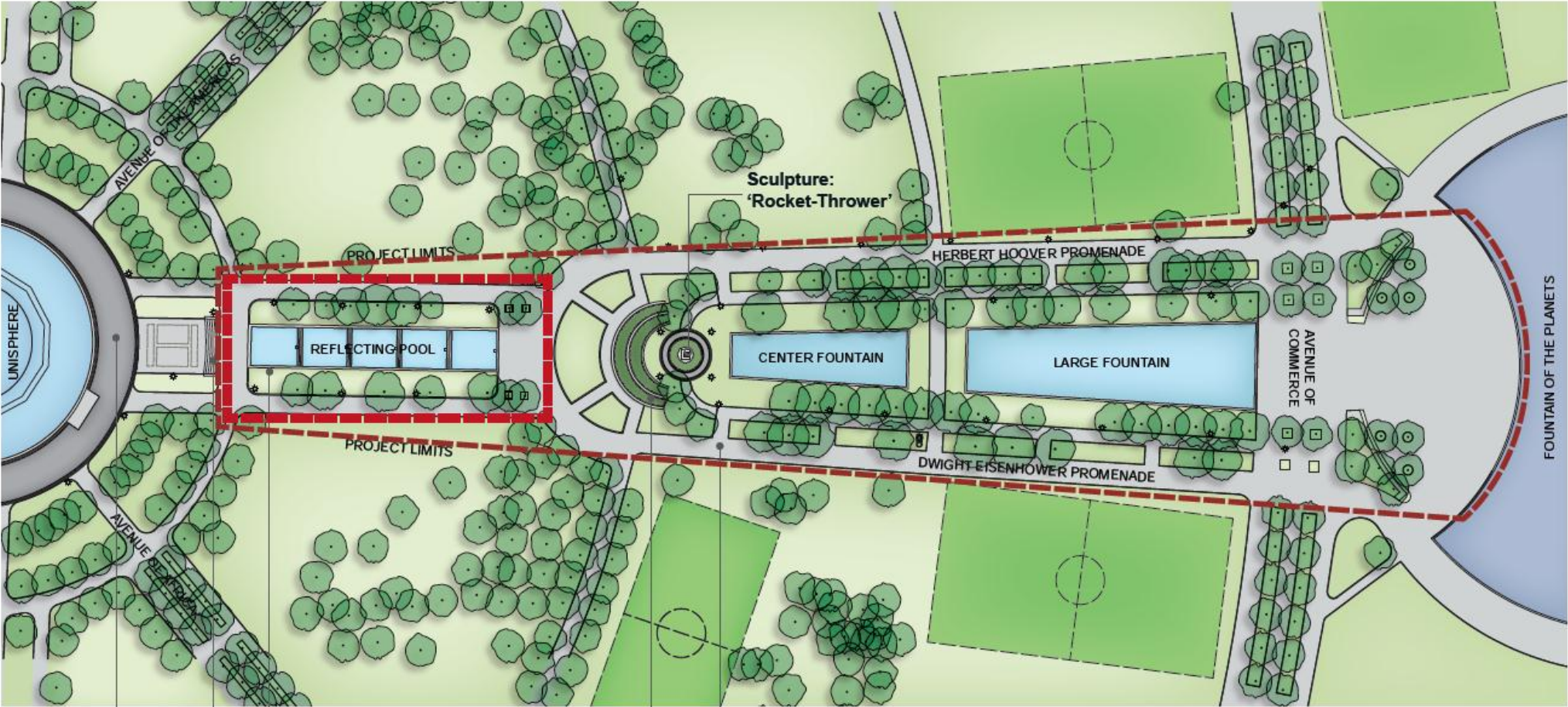

LEGEND

- Master Plan Project Area
- Project Area - Current Phase
- Lawn
- Water Body (Flushing River)
- Fountains (Painted Basins)
- Asphalt Pavement
- Hexagonal Asphalt Pavers
- Sports Field (Artificial Turf)
- Existing Tree
- Existing Light Post

Granite Coping (Typ.)

Granite Stairs

Hexagonal Asphalt Pavers With Red Asphalt Brick Paver Edging

Asphalt Pavement

Steps

Fountain of the Fairs- Site Photos



1 Use of Unisphere Fountain as a 'Spray Park'



2 View South Up the Reflecting Pool Towards the Unisphere



Key

NTS

N

Fountain of the Fairs- Site Photos



3 The Center Fountain Facing South



4 Looking North towards Fountain of the Planets - The Trees Provide Adequate Shade

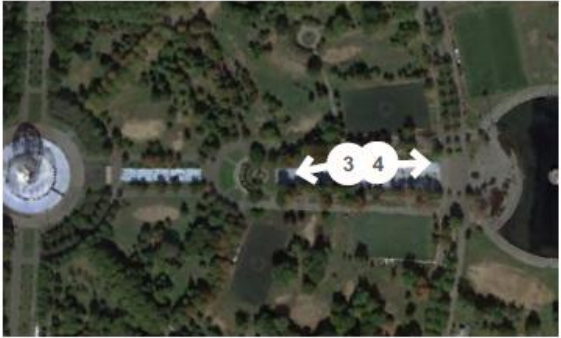

Key

NTS N

Fountain of the Fairs- Site Analysis

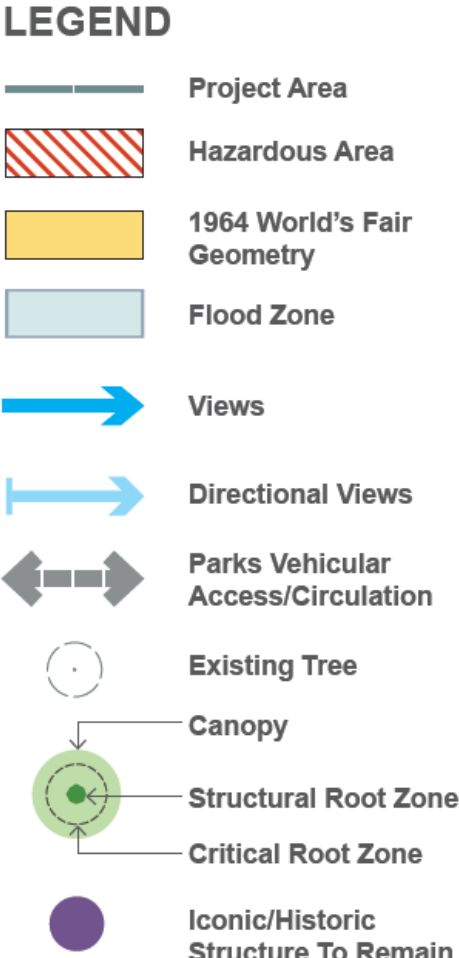
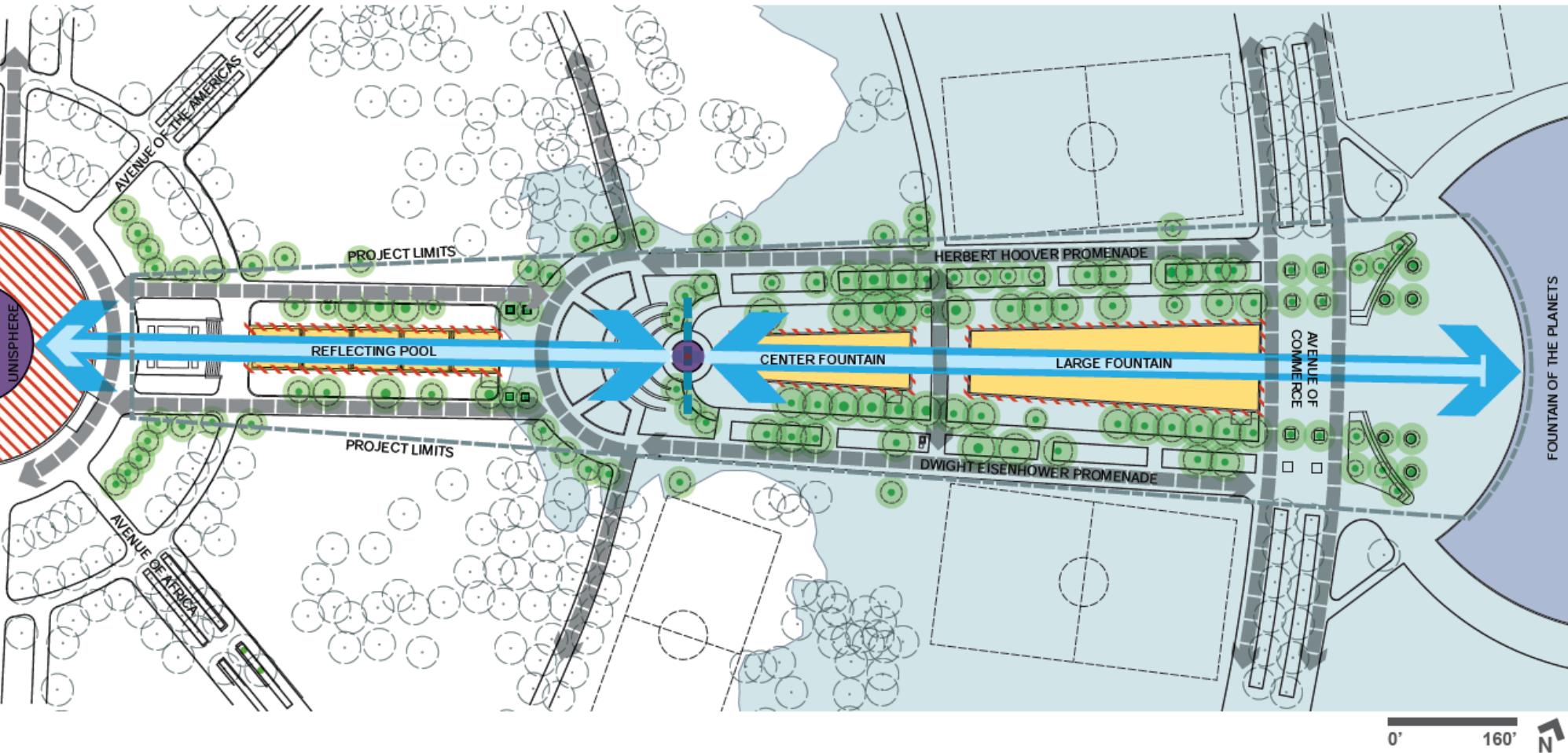

Fountain of the Fairs- Bubble Diagram

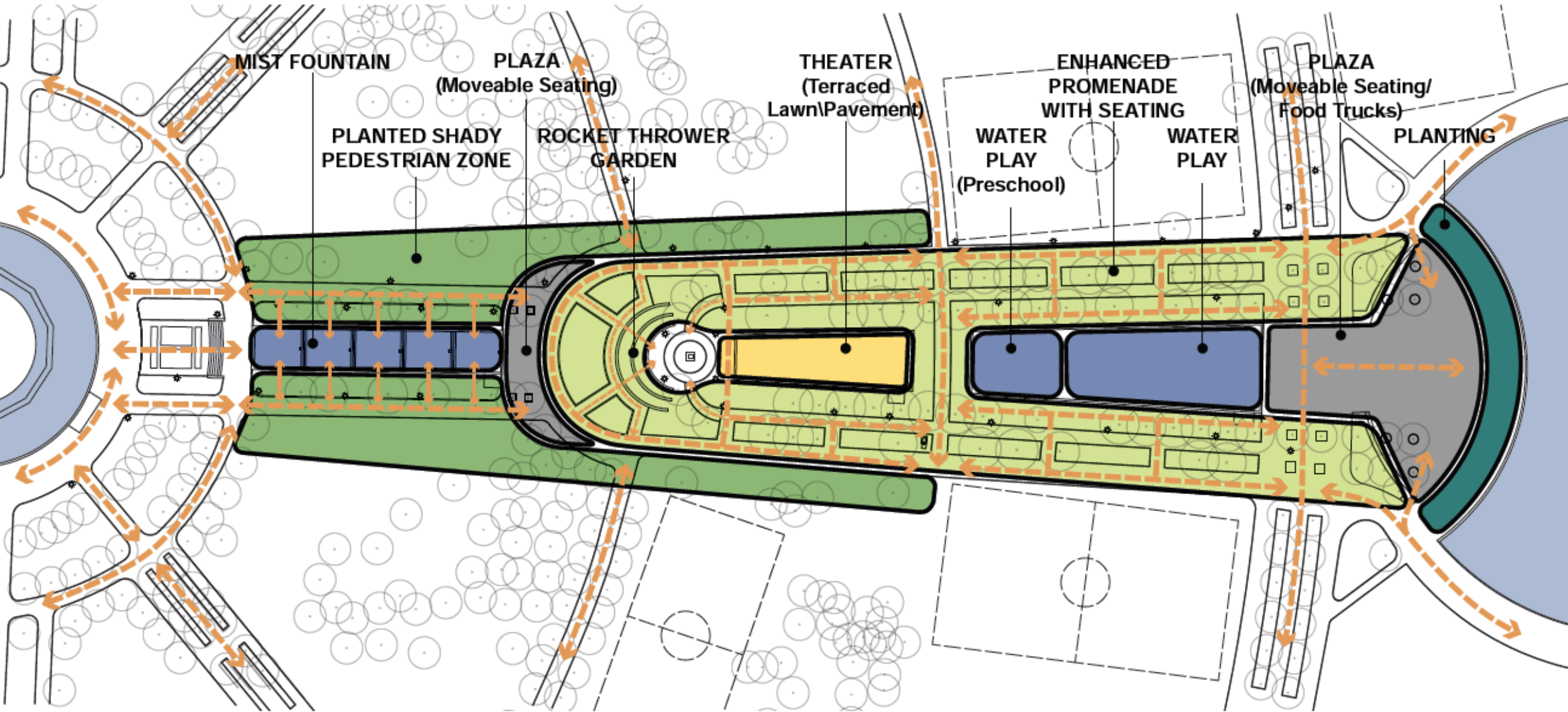

Hybrid Scheme

Fountain of the Fairs- Schematic Master Plan

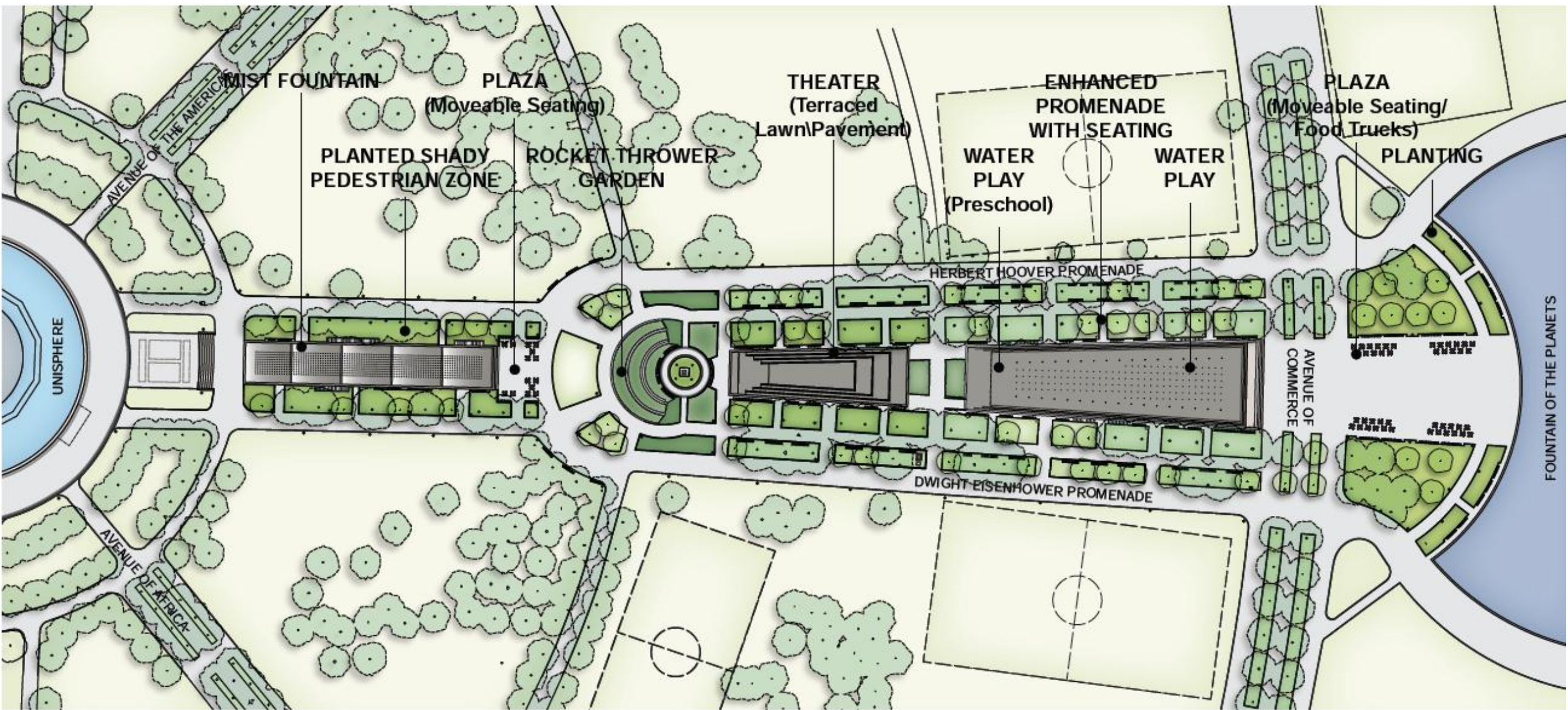

Schematic Master Plan for Fountain of the Fairs and Reflecting Pool. Current Capital Project, Phase I, is to create a mist fountain in the Reflecting Pool, which is adjacent to the Unisphere.

Fountain of the Fairs- Schematic Plan- Phase I Fog Fountain

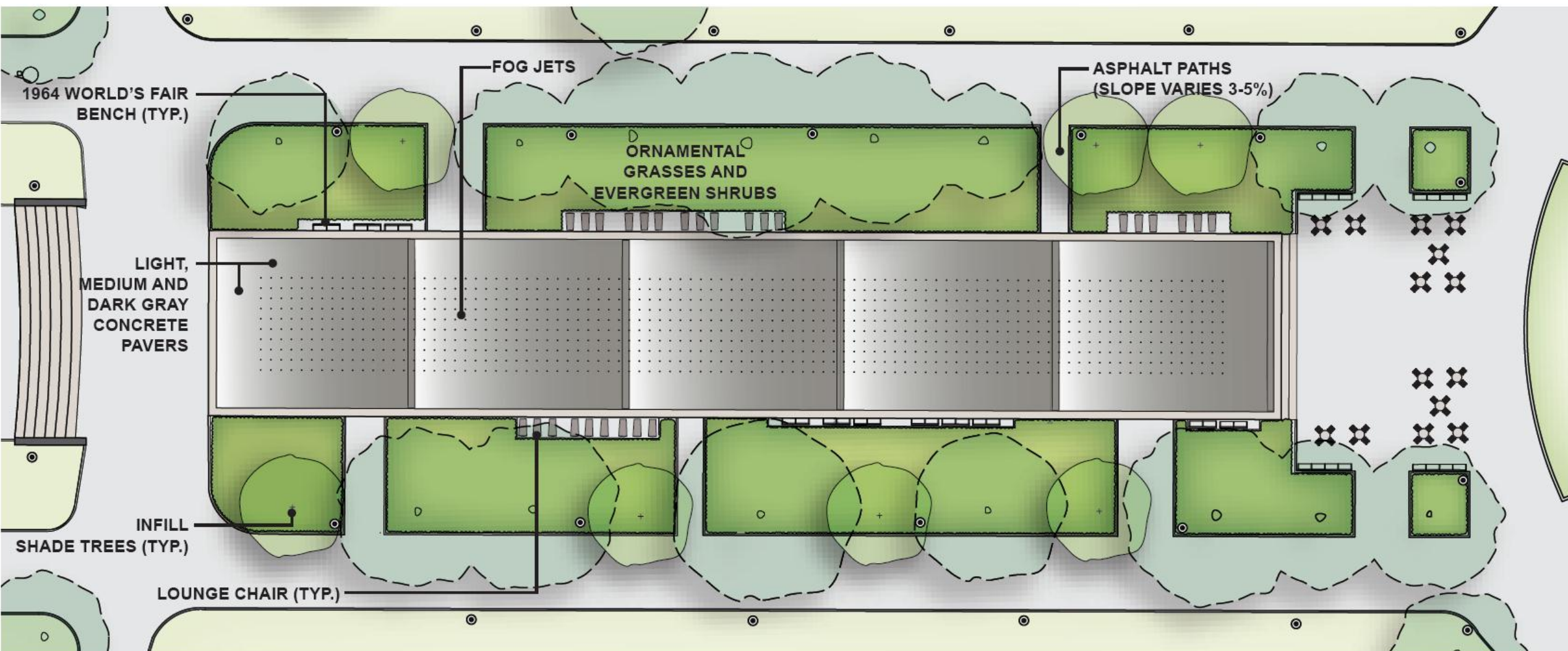

Schematic Plan for the current Capital Project, Phase I: the construction of a mist fountain and seating area in the Reflecting Pool.

Fountain of the Fairs- Fog Fountain Example



Fountain of the Fairs- Schematic Plan- Art Deco Theme



Art Deco Theme

The community was very clear that they wanted the proposed design for the Fountains of the Fairs to reflect the history of the site. As the existing coping of the fountain will be retained from the 1964 World's Fair, it seemed appropriate to also reflect the 1939 World's Fair in the pavement of the Mist Fountain. The inspirations for the proposed paving design came from art deco patterns that were in New York City at around the same time.

While the pavement of the Mist Fountain was designed to reflect the 1939 World's Fair, the design team was also cognizant of the fact that the elevation of all of the planes to one level would wind up eliminating the weirs, and therefore erasing a significant element of the fountain's structure from the 1964 World's Fair. The paving pattern developed for the basin was also designed to reference and mark the weirs that were part of the original design of the Reflecting Pool.

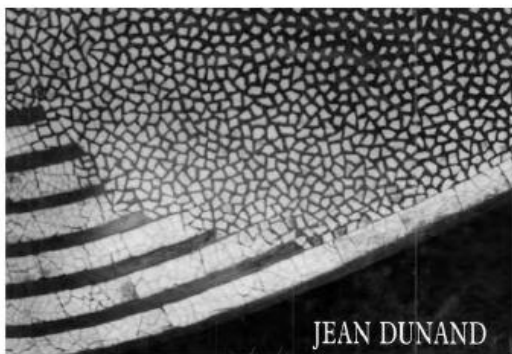

JEAN DUNAND

Jean Dunand (1877-1942)

Jean Dunand, a Swiss artist of French origin, was a master of Japanese style lacquer, and displayed his works at the 1939 World's Fair. His technique, which utilized egg shells to create geometric patterns under the lacquer, was reminiscent of tiered water falling, or of a starry night - two central themes of the 1964 World's Fair. This pattern was the inspiration for the central field of the Mist Fountain.



New York City Architecture

The architecture of New York City from around the era of the 1939 world's fair informed the design of the border around the edges of the Mist Garden. The Chrysler Building, Rockefeller Center and the Western Union Building provided inspiration for the triangular, geometric edges of the Mist Garden.



Fountain of the Fairs- Schematic Plan- Fog Fountain

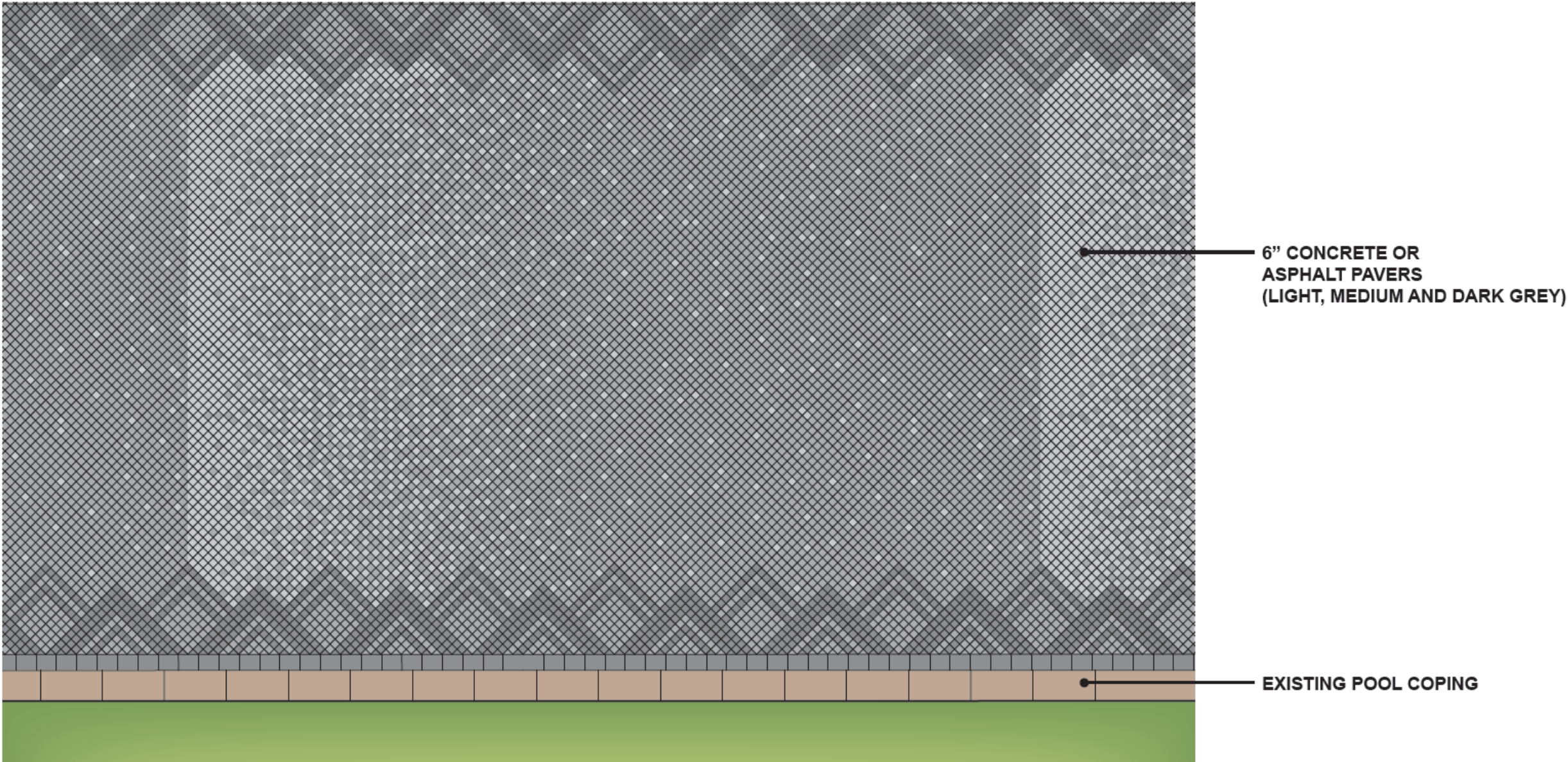

Schematic Plan - Fountain of the Fairs Paving Pattern

Fountain of the Fairs- Schematic Section- Fog Fountain

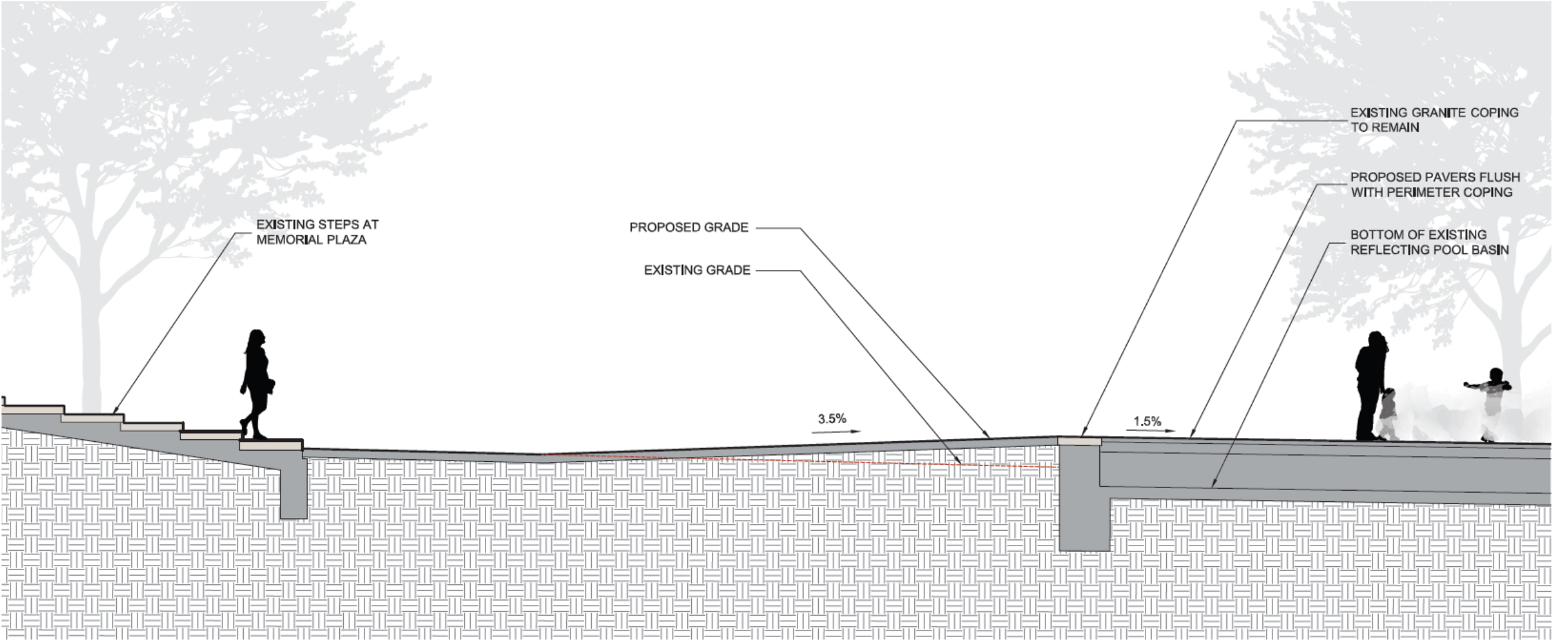

Longitudinal Section at West End of Fog/Mist Fountain

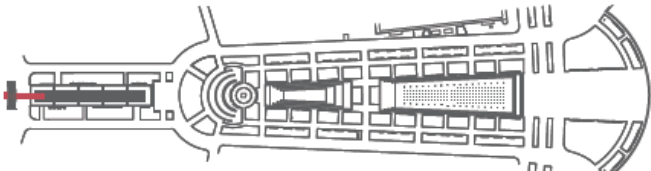

Fountain of the Fairs- Schematic Section- Fog Fountain

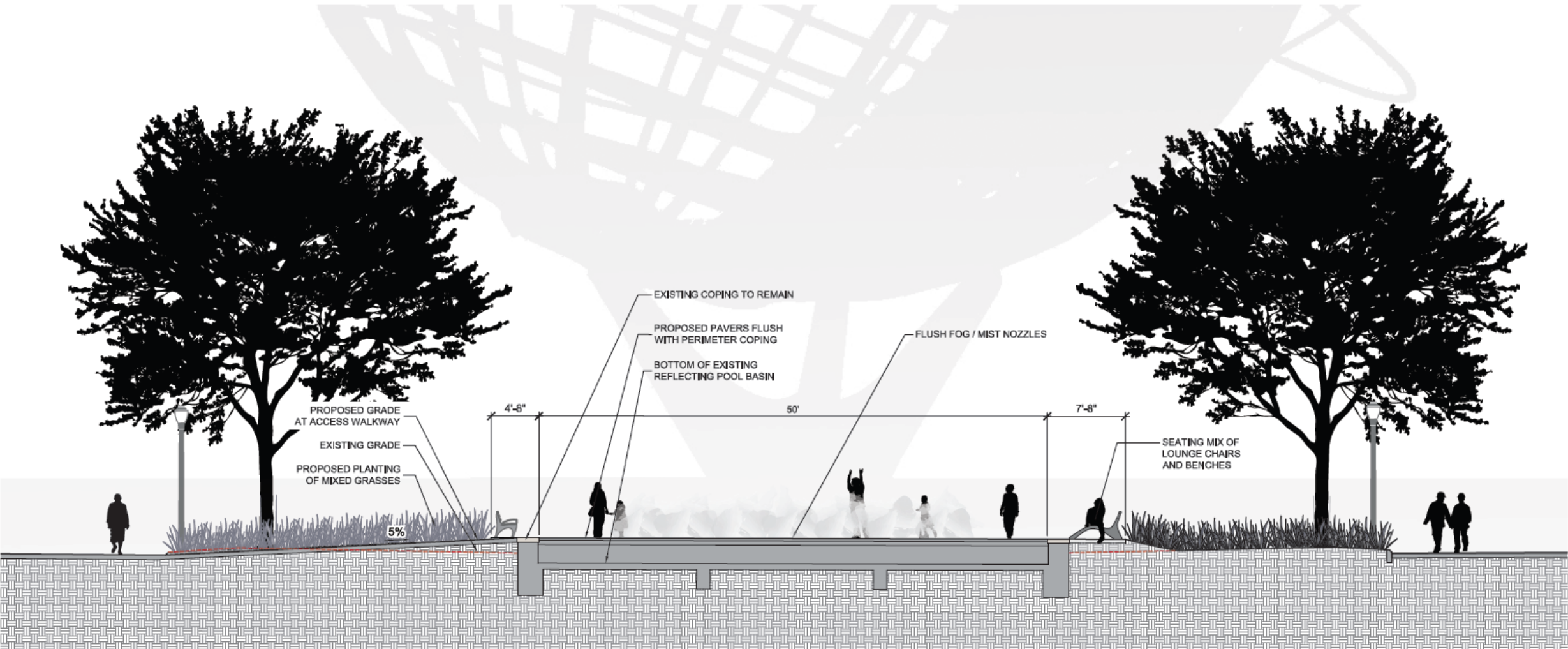

Cross-Section Through Fog Fountain

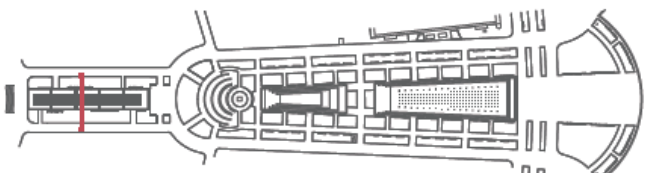

Fountain of the Fairs- Schematic Plan- Paving



Asphalt Pavement (at paths)

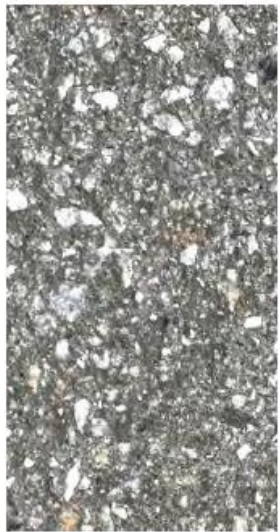
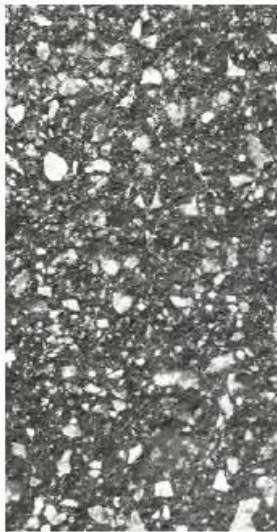

Concrete Block Pavers (at basin surfaces) - Charcoal, Limestone Gray and Natural



C14 - French Gray Tinted Concrete (at bench pads)