



The Reconstruction of the Observation Towers at the New York State Pavilion

Located In Flushing Meadows Corona Park between Grand Central Parkway, the Long Island and Van Wyck Expressway, in the Borough of Queens

April 2017

Parks

PROJECT GOALS

Observation Towers

- Reconstruct stairs for safe route from ground to top of Tower 3
- Replace deteriorated suspension cables at all platform levels
- Repair deteriorated concrete
- Restore Plaza level floor finish
- Restore stair security lighting
- Restore portions of the architectural lighting design
- Restore, clean and protect the basement
- Restore Plaza level and basement drainage
- Replace electrical infrastructure in basement

Tent of Tomorrow

- Restore portions of the architectural lighting design
- Develop superstructure movement monitoring plan

New York State Pavilion – Site Location

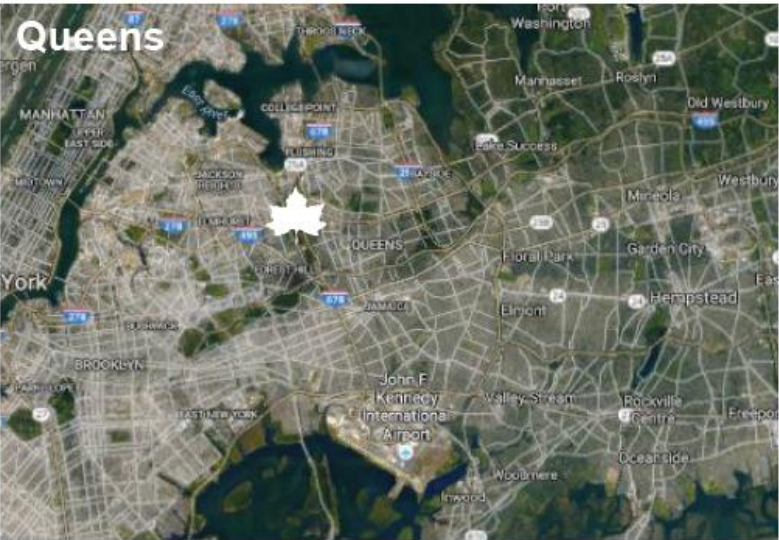

City 2 MI



Neighborhood 2000'



Site 200'

New York State Pavilion Observation Towers- Existing Conditions

OBSERVATION TOWERS



1. Observation Towers North Elevation



2. Observation Towers South Elevation

New York State Pavilion Observation Towers- Cleaning/Paint Scope

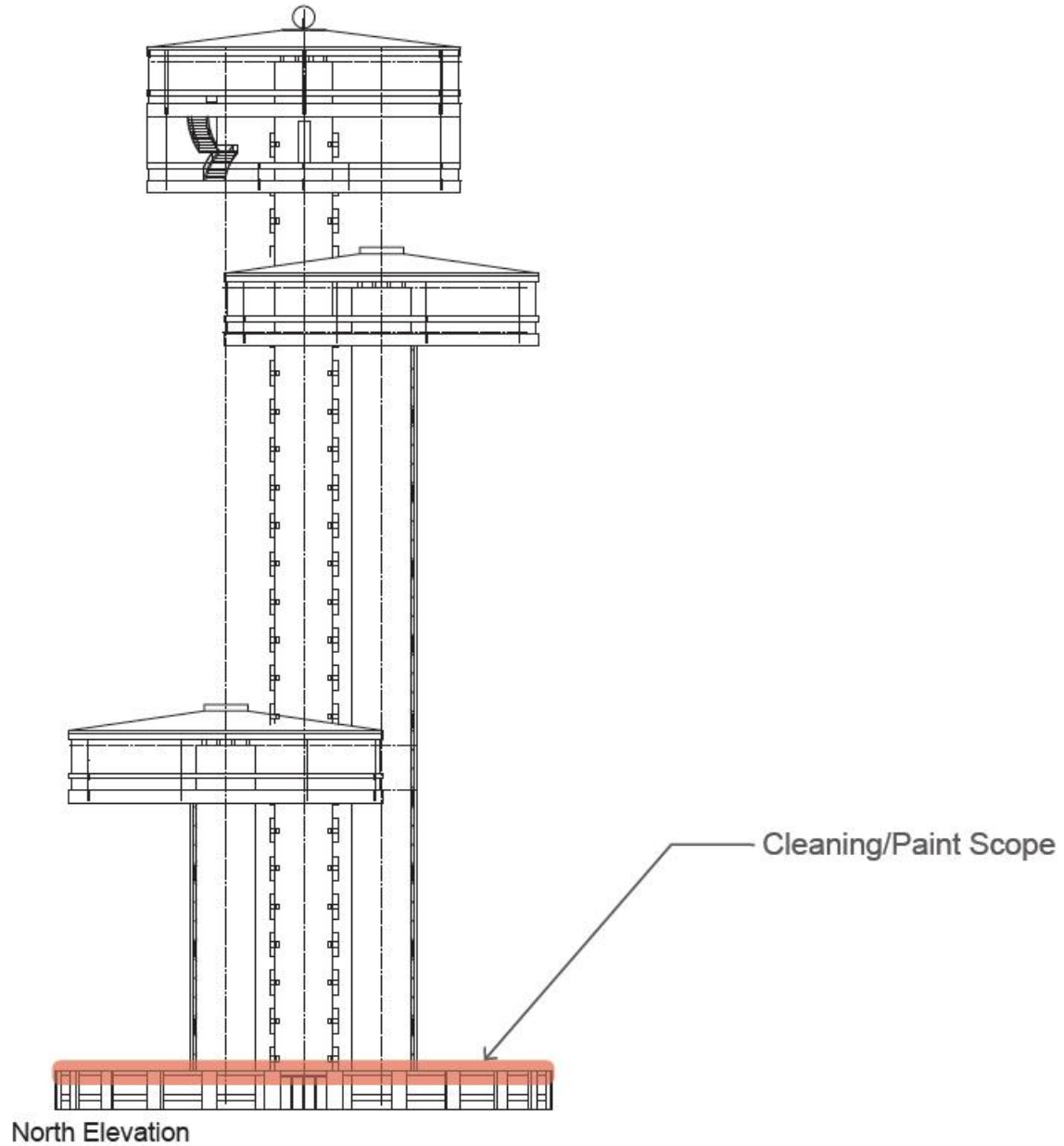

Benjamin Moore 2019-40 American Cheese



New York State Pavilion Observation Towers- Cable Replacement

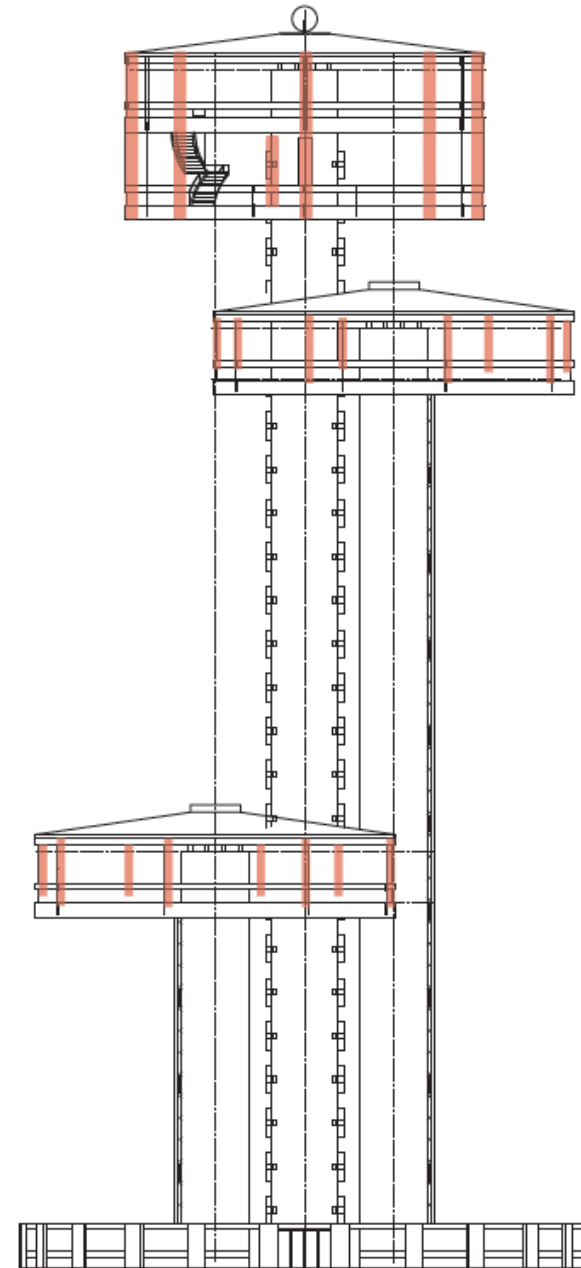

North Elevation

New York State Pavilion Observation Towers- Concrete Repair

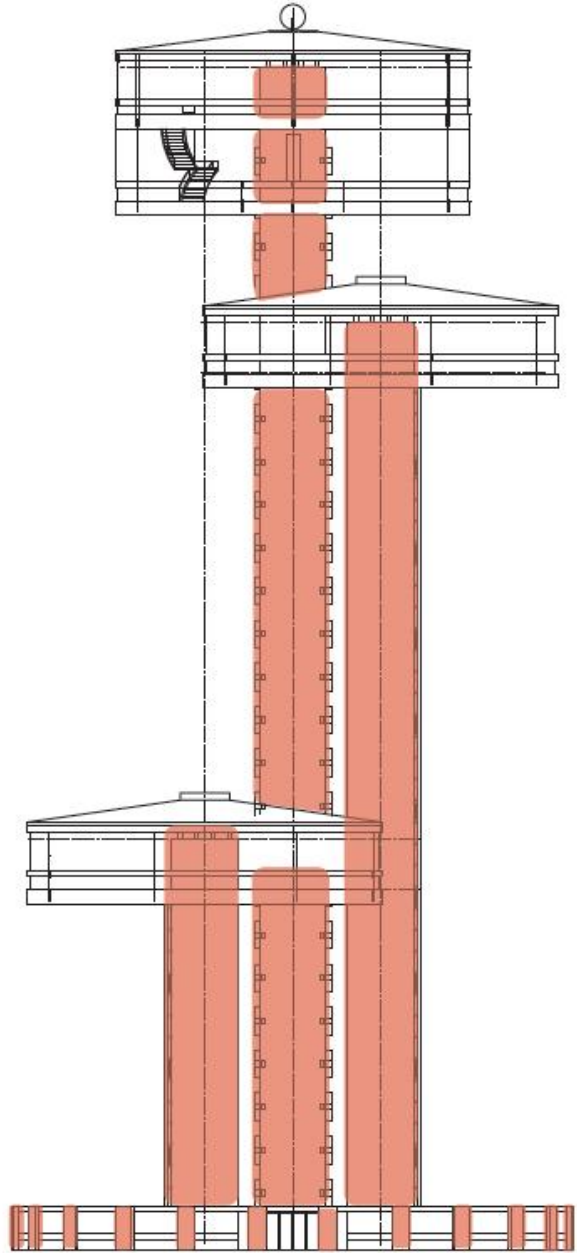

North Elevation

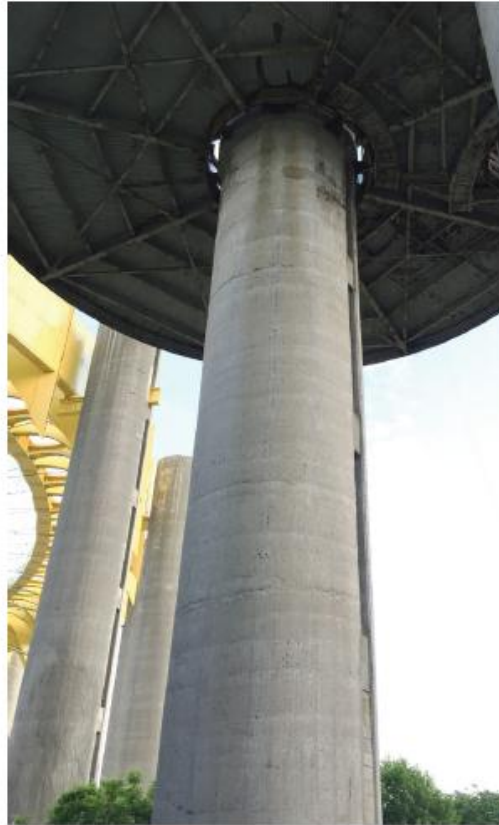

Concrete repair at discrete areas of deterioration to match texture and color of existing concrete

New York State Pavilion Observation Towers- Stair Replacement In-Kind



Internal stair at Tower 3 above Tower 2

Internal stair at Tower 2 above Tower 1

Internal stair at Tower 1

North Elevation



GENERAL NOTES

1. ALL HISTORIC COATINGS ARE TO BE MAINTAINED FOR REUSE UNLESS NOTED OTHERWISE.
2. ALL NEW COMPONENTS TO MATCH ORIGINAL IN MATERIAL, SIZE, PROFILES, COORDS AND FEATURES. UNLESS OTHERWISE INDICATED.
3. DIMENSIONS, UNLESS ELUCIDATIONS SHALL BE COORDINATED WITH FIELD VERIFIED MEASUREMENTS.
4. ALSO ALTERED: PROVIDE POWDER COAT FINISH ON ALL STEEL BRACE COMPONENTS PRIOR TO ASSEMBLY IN USE OF PRIMING AND FINISHING. POWDER COAT FINISH TO MATCH COLOR AND BURNISH OF HISTORIC PAINT COLOR.

15.47

[illegible]

OBSERVATION TOWERS



Historic photo showing Plaza Level

New York State Pavilion Observation Towers- Floor Finishes

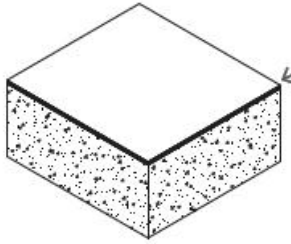

Original Intervention: "Terrazzo Styled" linoleum

Pros:

- Original detailing
- Low cost

Cons:

- 5-year lifespan
- Weak edge conditions
- Installation is only as good as the adhesive



Historic concrete linoleum coating

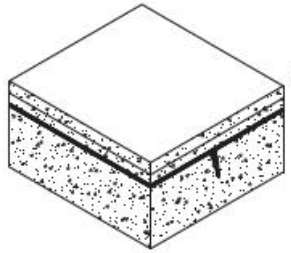

New Intervention: Methacrylate Coating

Pros:

- No elevation changes
- 15- to 20-year lifespan
- Fully reversible

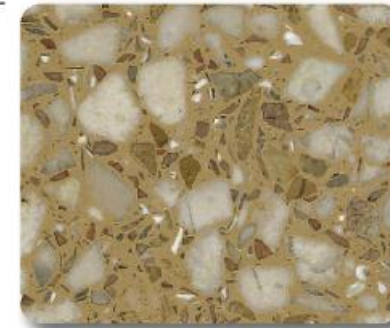

Key Coatings KRS-122

New York State Pavilion Observation Towers- Historic Tower Lighting



H-8: Overall view from the Greece Pavilion looking east, 1964



H-9: Detail view from the Brass Rail looking southeast, 1964



H-11: Detail view from the Court of Nations looking south, 1963



H-12: Tower No. 2 Detail, 1964

Historic Image Reference Plan

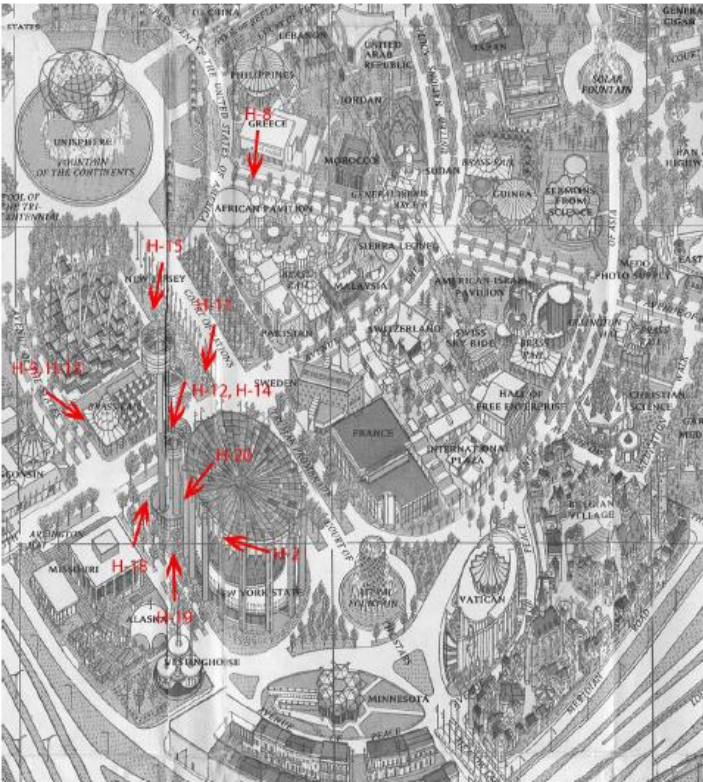

H-10: Detail view from the Westinghouse Pavilion looking northwest, 1965



H-13: Detail view from the Brass Rail looking southeast, 1964



H-14: Tower No. 2 and 3 detail, 1965

New York State Pavilion Observation Towers- Historic Tower Lighting



H-15: Detail, Observation decks, 1965



H-18: Detail view from Missouri Pavilion looking northwest, 1965



H-19: Detail view looking west, 1965

Historic Image Reference Plan

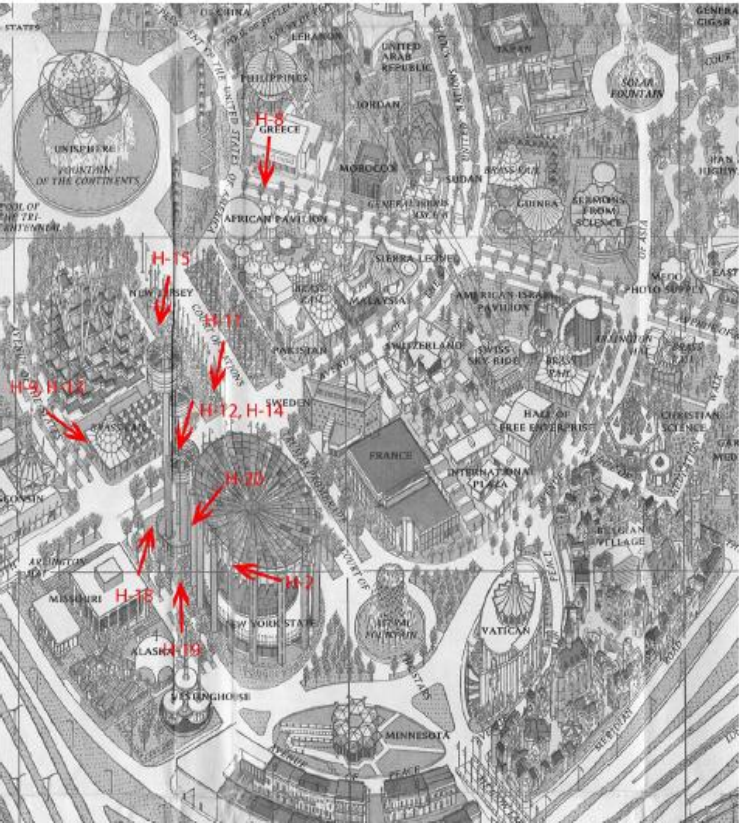

H-16: Detail, Observation deck, 1964



H-17: Detail, Observation deck, 1964



H-20: Detail view from NYS Pavilion looking south, 1964

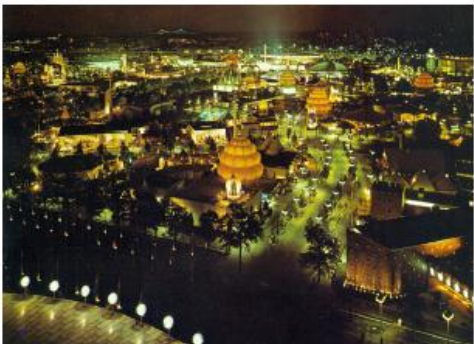

H-21: Detail view from the NYS Pavilion looking northeast, 1964

[illegible]

New York State Pavilion Observation Towers- Lighting Mockup

OBSERVATION TOWERS



New York State Pavilion Tent of Tomorrow- Lighting Mockup

TENT OF TOMORROW COLUMNS



New York State Pavilion – Architectural Lighting Rendering

OBSERVATION TOWERS AND TENT OF TOMORROW



New York State Pavilion – Architectural Lighting Rendering

**OBSERVATION
TOWERS AND
TENT OF
TOMORROW**

