

# Multi-Max® FA-3: Insulation for Above the Deck

## Single Ply Applications

**Fully-Adhered Single Ply** - Specify and install Multi-Max® FA-3 under fully-adhered single ply membranes (EPDM, PVC, TPO, etc.). Refer to the *Rmax Polyiso Roof Insulation Fastening Guide* for appropriate fastening density when using FM listed mechanical screw and plate fasteners for the attachment of Multi-Max® FA-3 to steel or wood decks. Where appropriate and suitable, Multi-Max® FA-3 may be adhered to properly prepared concrete roof deck surfaces in solid flood coats of hot bitumens. Follow the membrane manufacturer's recommended instructions for the type of adhesive, the application rate and proper application method for adhering the membrane to Rmax's Multi-Max® FA-3. Rmax recommends the use of a suitable cover board in fully-adhered single ply membrane systems.

**Mechanically Attached Single Ply** - Specify and install Multi-Max® FA-3 for use under all types of mechanically attached single ply membrane systems. Attach the product to the roof deck with a minimum of four (4) FM approved mechanical fasteners per four foot by eight foot (4' x 8') sheet of insulation. NOTE: Additional fasteners in the insulation may be required by the membrane supplier. Apply the mechanically attached membrane according to membrane supplier's specifications.

**Loose Laid Ballasted Single Ply** - Specify and install Multi-Max® FA-3 when installing a loose laid ballasted single ply system. Multi-Max® FA-3 is laid into position on the roof deck without fastening or otherwise securing the insulation. The membrane and ballast are then installed according to the membrane supplier's specifications. Ballast, placed at the specified rate, restrains the entire roof system. Please note that although fasteners are not required, fasteners may be necessary to hold the insulation system in place to stabilize insulation panels for the installation of the membrane and ballasting.

Refer to Multi-Max® FA-3 data sheet for additional application/installation, compliances, thermal and physical properties, limitations and warnings.

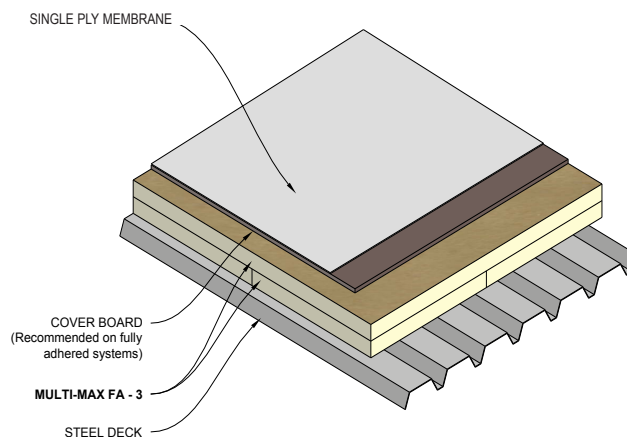

**Notes:**

1. Vapor retarders should be applied as required and recommended by the NRCA.

*Warranty: See Rmax "Sales Policy" and applicable warranties for terms and conditions. Rmax does not assume any responsibility or liability for the performance of any products other than those manufactured by Rmax. **NOTE: All Rmax products must be tarped, placed on skids and kept dry before and throughout construction. Requests for Certification Letters and/or special warranty considerations must be submitted to Rmax Sales prior to delivery of the products.***

2017-11