

# Nailable Base-3: Insulation for Above the Deck

## Concrete, Slate, Clay Roofing Tiles / Shakes / Metal Panel / Asphalt Shingles (Limited) Applications

Specify and install Nailable Base-3 over a structural roof deck. Refer to cover manufacturer for specific approvals and slope requirements. Follow recommendations of the cover supplier for application of underlayment felts and other details as required, as well as, information regarding warranty and application methods. Some shingle manufacturers do not allow their products to be installed over non-vented insulated decks.

**Refer to Nailable Base-3 data sheet for additional application/installation, compliances, thermal and physical properties, limitations and warnings.**

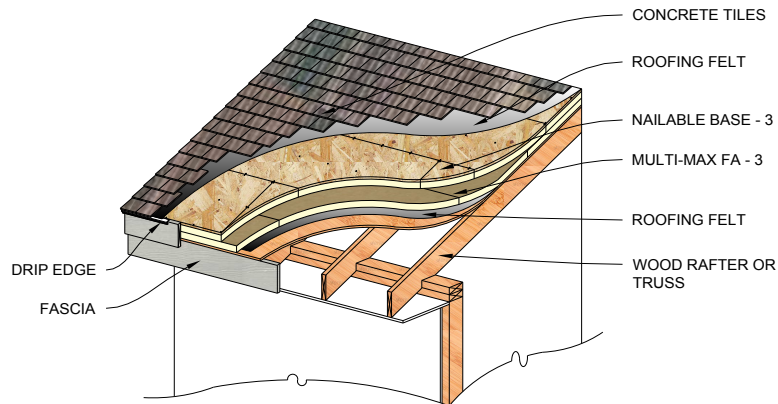

**Notes:**

1. The default thickness of the nailing surface may not be sufficient for the installation of the roof cover. Consult cover manufacturer for requirements.
2. Vapor retarders should be applied as required and recommended by the NRCA.

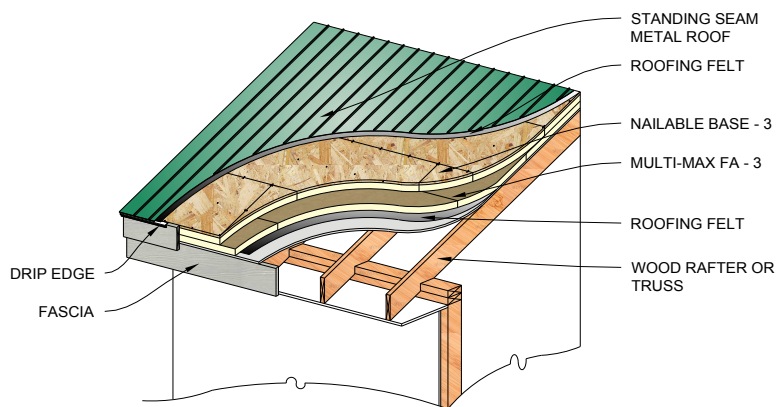

**Notes:**

1. The default thickness of the nailing surface may not be sufficient for the installation of the roof cover. Consult cover manufacturer for requirements.
2. Vapor retarders should be applied as required and recommended by the NRCA.

*Warranty: See Rmax "Sales Policy" and applicable warranties for terms and conditions. Rmax does not assume any responsibility or liability for the performance of any products other than those manufactured by Rmax. **NOTE: All Rmax products must be tarped, placed on skids and kept dry before and throughout construction. Requests for Certification Letters and/or special warranty considerations must be submitted to Rmax Sales prior to delivery of the products.***