

bobopro

WALL MOUNT INSTALLATION

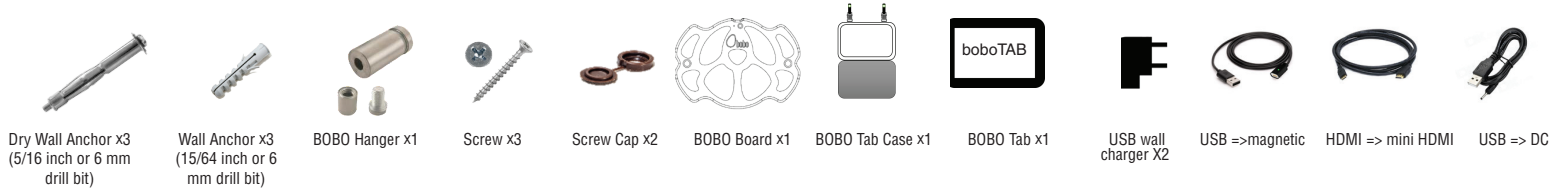

1 MARK YOUR HANGING POINTS

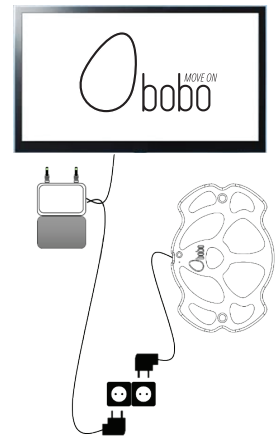
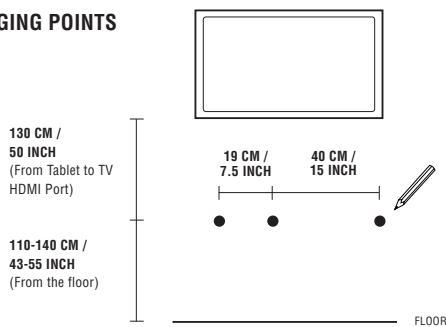

4 USE A SCREW DRIVER TO DRIVE THE SCREWS INTO THE ANCHORS. AFTER THE SCREWS ARE SECURED, MANUALLY CLOSE THE SCREW CAP COVER

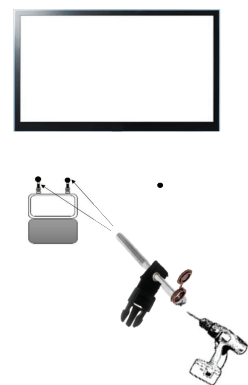

2 DRILL THE MARKED HOLES USE DRILL BIT 15/64 INCH OR 6 MM

TAP THE ANCHORS

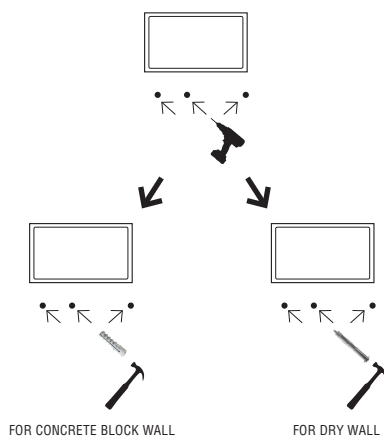

5 BOBO HANGER

- MANUALLY OPEN THE BOBO HANGER SCREW.
- FOR DRY WALL ANCHOR – DRIVE OUT THE SCREW FROM THE ANCHOR AND THREAD IT THROUGH THE HANGER BASE.
- FOR CONCRETE WALL ANCHOR - THREAD THE HANGER BASE THROUGH THE REGULAR SCREW
- DRIVE THE SCREW THROUGH THE BOBO HANGER TO THE WALL.
- MANUALLY CONNECT THE HEAD TO THE HANGER.

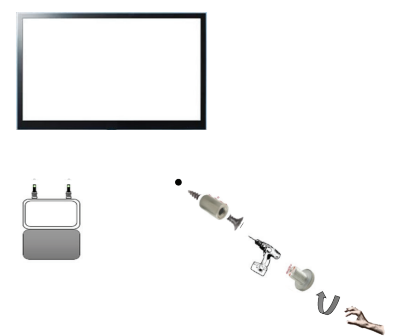

3 STRING THE SCREW THROUGH THE SCREW CAP RING AND THEN THROUGH THE CASE CLIP WHOLE

FOR CONCRETE BLOCK WALL



FOR DRY WALL



6 CONNECT CABLES

