

STONECREEK STAGE 3C

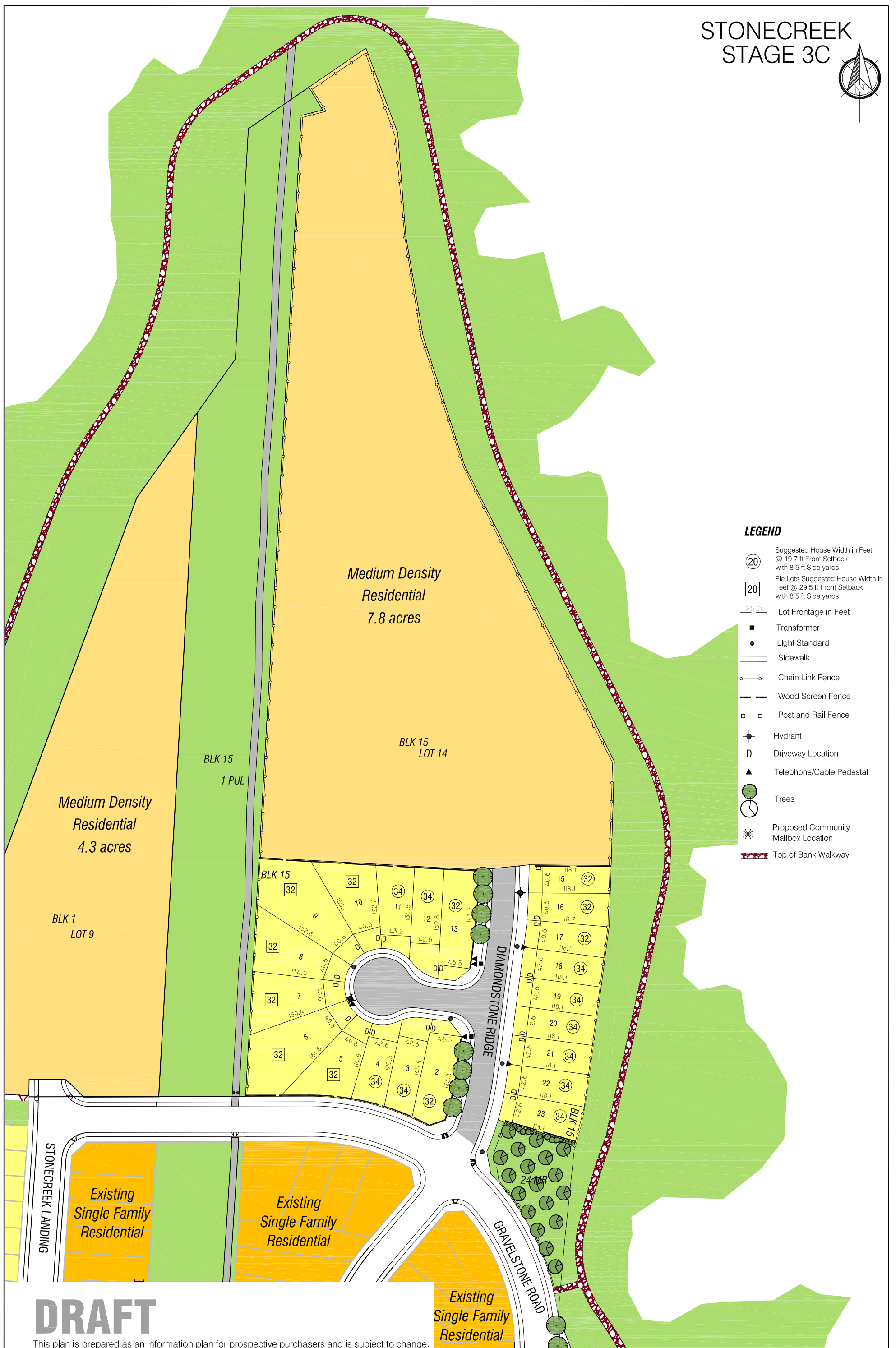

LEGEND

- 20 Suggested House Width in Feet @ 19.7 ft Front Setback with 8.5 ft Side yards
- 20 Pie Lots Suggested House Width in Feet @ 29.5 ft Front Setback with 8.5 ft Side yards
- 25.0 Lot Frontage in Feet
- Transformer
- Light Standard
- Sidewalk
- Chain Link Fence
- Wood Screen Fence
- Post and Rail Fence
- ◆ Hydrant
- D Driveway Location
- ▲ Telephone/Cable Pedestal
- Trees
- ⊙ Proposed Community Mailbox Location
- Top of Bank Walkway

DRAFT

This plan is prepared as an information plan for prospective purchasers and is subject to change. Lot dimensions are in feet and rounded, and should be verified with a registered plan. House pockets are based on front setback of 6m (19.7 ft), for R1 bylaw except for Pie Lot house pockets based on 9m (29.5 ft) setback. Corner lots in this subdivision calculated with 4.4m (14.4 ft) total side yard. Location of street furniture and landscaping approximate and should be verified on site.