

Land Lease / Build to Suit

0.75 Acres Along Main Traffic Corridor; Minutes From Harrisburg



About the Land

- ◆ Located along Market Street in Lemoyne, PA; 5 minute drive to Harrisburg
- ◆ Zoned Retail/Commercial
- ◆ Approximate lot size 147' x 228'
- ◆ Located between the West Shore Plaza and West Shore Farmer's Market
- ◆ Morning traffic side of Market Street, offering easy-in and easy-out access for drivers heading to Harrisburg

About Smith Land & Improvement Corporation

- ◆ Third generation real estate development firm
- ◆ Portfolio includes nearly 50 properties; 80% of which are in Central Pennsylvania
- ◆ We offer the personal touch of managing our own properties in-house

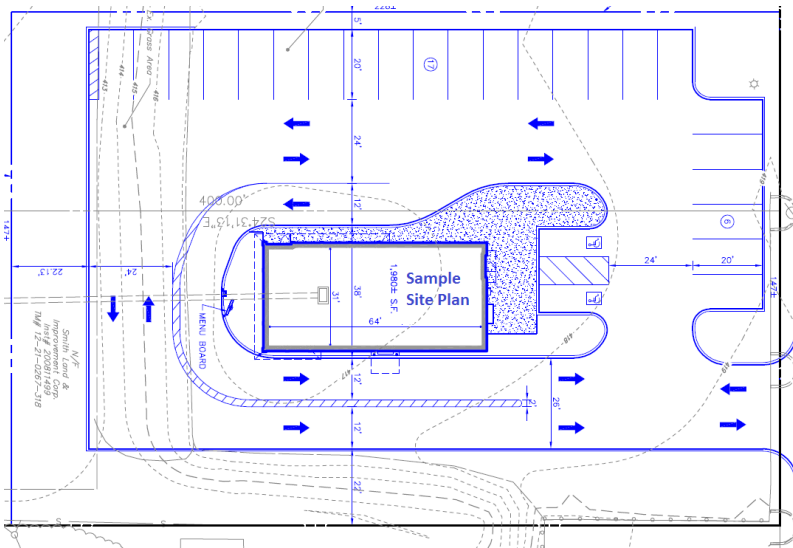

SMITH LAND
& IMPROVEMENT CORPORATION

Contact Rick Jordan III
717-731-0246 rjordan3@lbsmith.org
smithlandusa.com