

RARE LAND  
PARCEL  
FOR SALE

# LAND DEVELOPMENT SITE OR BUILD TO SUIT

20322 52ND AVENUE WEST :: LYNNWOOD, WASHINGTON



## FEATURES

- ±1.76 total acres
- Owner will build-to-suit For Sale or Lease
- Previously permitted for a 13,200 SF, two-story office flex building
- Existing improvements include:
  - Completed parking lot
  - Storm lines, biofiltration system and storm drain detention pond complete
  - All utilities are to the site
  - Site has been pre-loaded
  - SEPA items are complete and approved by the City of Lynnwood
- Business technical park (BTP) zoning - City of Lynnwood
- Excellent street signage and visibility to 52nd Avenue W/Cedar Valley Road
- Close proximity to retail amenities including newly renovated Alderwood Mall
- Quiet suburban setting bordering Scriber Creek and Interurban Trail
- Convenient access to freeway and regional Park & Ride
- Ideal for medical, dental, flex, educational or general office users
- PRICE: \$995,000



FOR MORE  
INFORMATION  
PLEASE  
CONTACT

**Ric Brandt**  
425.462.6901  
ric.brandt@cbre.com

**John Bauer**  
425.462.6906  
john.bauer@cbre.com

**Scott Barber**  
425.462.6934  
scott.barber@cbre.com

**CBRE**  
CB RICHARD ELLIS

RARE LAND  
PARCEL  
FOR SALE

# LAND DEVELOPMENT SITE OR BUILD TO SUIT

20322 52ND AVENUE WEST :: LYNNWOOD, WASHINGTON



SITEPLAN  
1.76 ACRES

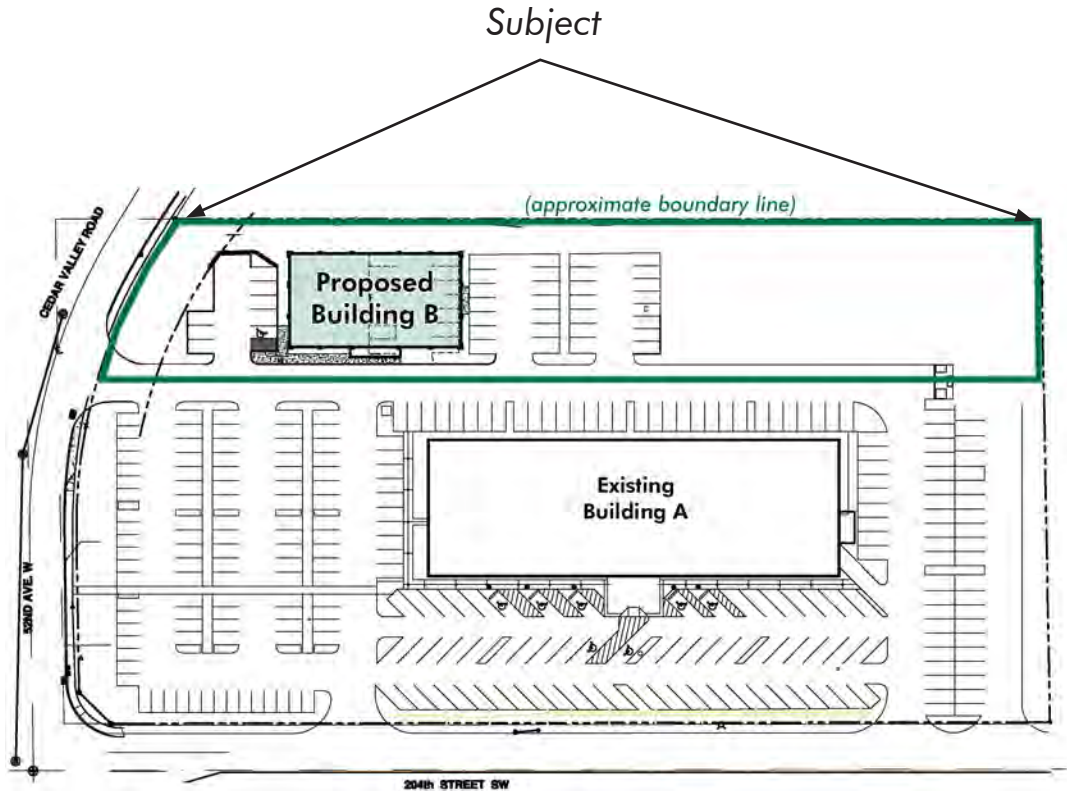

Parcel Map



FOR MORE  
INFORMATION  
PLEASE  
CONTACT

**Ric Brandt**  
425.462.6901  
ric.brandt@cbre.com

**John Bauer**  
425.462.6906  
john.bauer@cbre.com

**Scott Barber**  
425.462.6934  
scott.barber@cbre.com



CB Richard Ellis | 10885 NE 4th Street | Suite 500 | Bellevue, WA 98004 | T 425.455.8500 | F 425.462.6966

© 2011 CB Richard Ellis, Inc. This information has been obtained from sources believed reliable. We have not verified it and make no guarantee, warranty or representation about it. Any projections, opinions, assumptions or estimates used are for example only and do not represent the current or future performance of the property. You and your advisors should conduct a careful, independent investigation of the property to determine to your satisfaction the suitability of the property for your needs. CBRE, CB RICHARD ELLIS and the CBRE CB RICHARD ELLIS logo are service marks of CB Richard Ellis, Inc. and/or its affiliated or related companies in the United States and other countries. All other marks displayed on this document are the property of their respective owners. TL 2-9-11