

Eno Preserve

14 acres

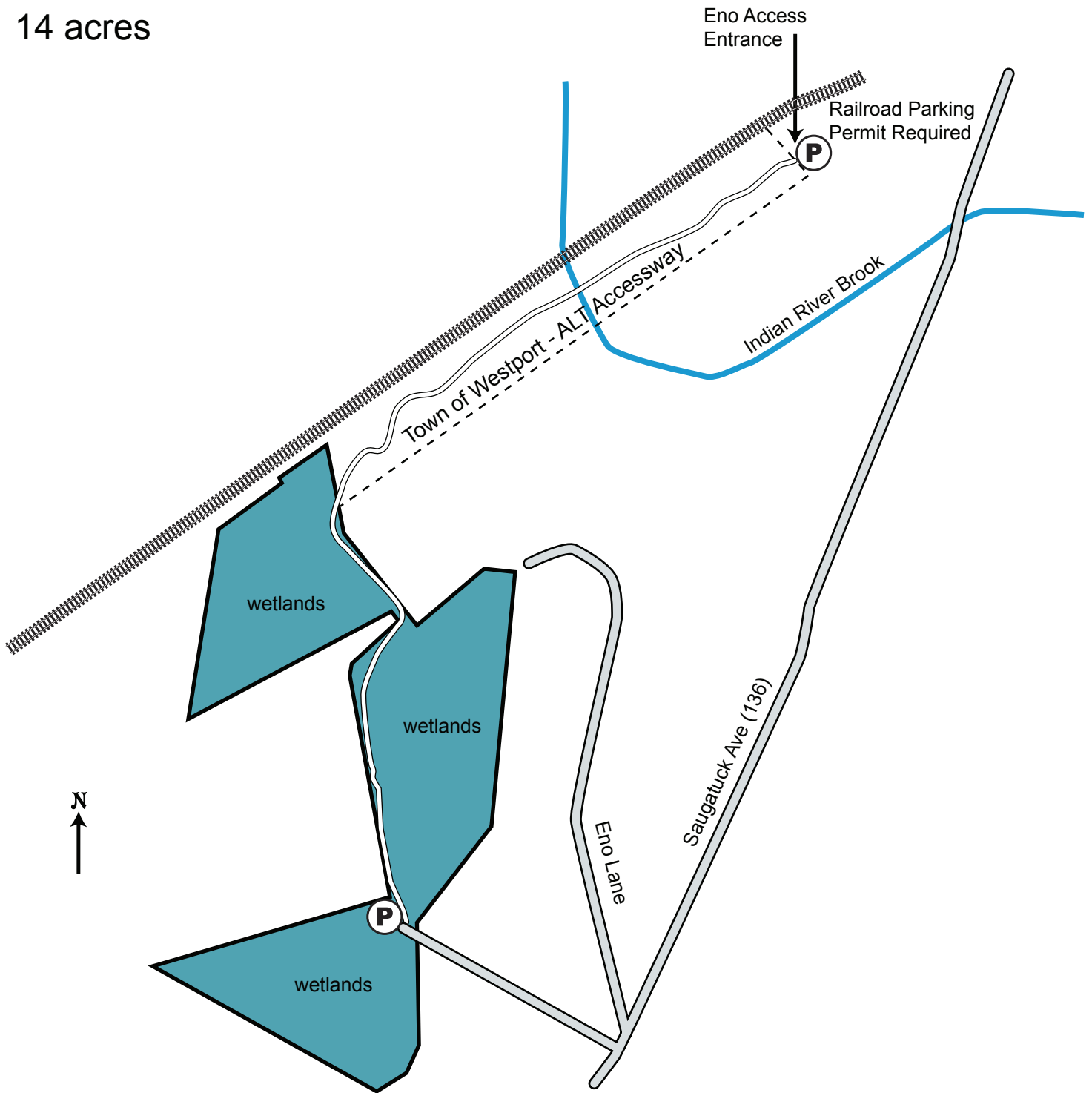

◇ White Trail

Ⓟ Access to the preserve is from the Westport railroad parking lot which requires a parking permit during weekdays (no permit required on weekends!), or from a private lane between #278 & #282 Saugatuck Ave. Parking on private road is at the end of the drive and the preserve trail begins at end of the asphalt.



www.aspetucklandtrust.org