



MN4K300WP
MINOLTA 4K UHD DIGITAL LENS



MN4K300WP User Manual

1. About Your Camcorder

About this Manual

Congratulations on purchasing the Minolta MN4K300WP Waterproof Camcorder! The contents of this manual are subject to change without notice. Note that the example screens and product illustrations shown in this User's Guide may differ somewhat from the screens and configuration of the actual camcorder.

Copyright

This manual contains proprietary information protected by copyright. All rights are reserved. No part of this manual may be reproduced by any mechanical, electronic or other means, in any form, without prior written permission of Elite Brands Inc. © 2023.

FEDERAL COMMUNICATIONS COMMISSION INTERFERENCE STATEMENT

This equipment has been tested and found to comply with the limits for a Class B digital device, pursuant to Part 15 of the FCC Rules. These limits are designed to provide reasonable protection against harmful interference in a residential installation. This equipment generates, uses and can radiate radio frequency energy and, if not installed and used in accordance with the instructions, may cause harmful interference to radio communications. However, there is no guarantee that interference will not occur in a particular installation. If this equipment does cause harmful interference to radio or television reception, which can be determined by turning the equipment off and on, the user is encouraged to try to correct the interference by one or more of the following measures:

- Reorient or relocate the receiving antenna.
- Increase the separation between the equipment and receiver.
- Connect the equipment into an outlet on a circuit different from that to which the receiver is connected.
- Consult the dealer or an experienced radio/TV technician for help.

CAUTION:

Any changes or modifications not expressly approved by the party responsible for compliance could void the user's authority to operate the equipment.

This device complies with Part 15 of the FCC Rules. Operation is subject to the following two conditions:

- (1) This device may not cause harmful interference and
- (2) This device must accept any interference received, including interference that may cause undesired operation.

RF Exposure Warning

This equipment complies with FCC RF radiation exposure limits set forth for an uncontrolled environment. This equipment must be installed and operated in accordance with provided instructions and must not be co-located or operating in conjunction with any other antenna or transmitter. End-users and installers must

1. About Your Camcorder

be provided with antenna installation instructions and transmitter operating conditions for satisfying RF exposure compliance.

FCC: SAR standard Value: 1.6 W/Kg, Maximal Measure: 0.4 W/kg

CE Mark Warning

This is a Class B product, in a domestic environment, this product may cause radio interference, in which case the user may be required to take adequate measures.

Safety and Handling Precautions

Camcorder Information

- Do not disassemble or attempt to service the camcorder yourself.
- Do not expose the camcorder to moisture, or extreme temperatures.
- Allow the camcorder to warm up when moving from cold to warm temperatures.
- Do not touch and put pressure on the camcorder lens.
- Do not expose the lens to direct sunlight for extended periods.
- Do not use abrasive chemicals, cleaning solvents or strong detergents to clean the product. Wipe the product with a slightly damp soft cloth.
- Do not use the flash or LED Light near a person's eyes to prevent possible eye injury.
- To prevent you from falling over or resulting in traffic accident, please do not use the camcorder while you are walking, driving or riding a vehicle.
- Please handle the camcorder strap with care, and never place the strap around the neck of an infant or child. Wrapping the strap around a neck may cause suffocation.
- Do not subject the LCD screen to impact.
- To prevent the risk of fire or electric shock, do not expose this appliance to rain or moisture.

Battery Information

- Turn off the camcorder before installing or removing the battery.
- Use only the provided batteries or type of battery and charger that came with your camcorder. Using other types of battery or charger may damage the device and invalidate the warranty.
- Inserting the battery upside down can cause damage to the product and possibly cause an explosion.
- When the camcorder is used for an extended period of time, it is normal for the camcorder body to feel warm.
- Download all pictures and remove the battery from the camcorder if you are going to store the camcorder for a long period of time.
- The type of battery and the battery power level may cause the lens to be stuck up. Ensure you use the correct battery type and use a fully charged battery.
- Risk of explosion if battery is replaced by an incorrect type. Dispose of used

1. About Your Camcorder

batteries according to the instructions.

- Please keep the batteries out of the reach of children to prevent from swallowing batteries, which might cause poisoning.
- Once the battery's color changes or its shape is twisted, please stop using it.

USB adapter Information

- Do not expose the adapter to high temperatures or moisture places. Otherwise, it may cause fire or electric shock.
- Do not attempt to repair, disassemble, change or transform the adapter.
- Avoid sudden changes in temperature, which may cause condensation on the adapter's internal surfaces. Please do not use it immediately in this situation.
- Do not touch the plug with wet hands. Otherwise, it may cause electric shock.
- Do not use the travel voltage converter or AC/DC power inverter. Otherwise, it may cause damage, overheating, malfunction or fire to the camcorder.

Waterproof and Dustproof Information

- The waterproof and dustproof performance described do not guarantee that the camcorder will remain completely waterproof or free from damage and trouble under all conditions.
- Do not subject the camcorder to excessive shock, Vibration or pressure by dropping it, hitting it or placing a heavy object on it. Failure to observe this precaution could deform the camcorder, cause water to seep inside, or damage the airtight seals, resulting in camcorder malfunction.
- The battery door must be closed securely and the lock engaged in order for the camcorder to be waterproof. Failure to do this can allow water to enter the camcorder and damage it.

The camcorder can shoot images underwater at a depth of 3m (10ft) for up to 60 minutes.

- Do not drop the camcorder, strike it against a hard object such as a rock, or throw it against a water surface.
- Do not subject the camcorder to shock when using it underwater.
- Do not expose to depths greater than 3m (10ft) underwater.
- Do not continuously use the camcorder underwater for 60 minutes or more.
- Do not insert a wet memory card or battery in the camcorder.
- Do not open the battery cover when the camcorder or your hands are wet. Doing so may cause water to seep inside the camcorder or result in camcorder malfunction.
- Do not open the battery cover underwater.
- If moisture such as water droplets adheres to the outside of the camcorder or inside of the battery cover, immediately wipe it off with a soft dry cloth.

1. About Your Camcorder

- If a foreign substance adheres to the outside of the camcorder or inside of the battery cover, immediately remove it with a soft cloth.
- Do not leave the camcorder in cold conditions or hot conditions of 40°C (104°F) or more for a long period of time.
- When using the camcorder underwater, make sure the water temperature is from 0°C-40°C (32°F to 104°F).
- Do not use the camcorder in hot springs.

Before Using the Camcorder Underwater

Check the items below before using the camcorder underwater.

- Make sure that there are no foreign substances inside the battery cover.
- Make sure that the waterproof packing of the battery cover is not cracked or deformed.
- Make sure that the battery door is firmly closed and the battery cover security lock is in the LOCK position.
- Failure to follow these steps can result in damage to the camcorder.

Notes about Opening and Closing the Battery Door

- Make sure the camcorder and your hands are not wet.
- Make sure that there are no debris inside the battery-chamber or memory card slot.
- Make sure that the battery cover is firmly closed and the security lock is in the lock position.

To Unlock the Battery Door

Unlock the battery door by sliding the battery door notch away from the opening.

Use a fingernail or other pointy object when sliding the latch to get a better grip.

UNLOCK & OPEN BATTERY DOOR

- ① Slide the door lock latch downward to the **UNLOCK** position and hold.
- ② While holding the door lock latch downward, push the cover to the right.
- ③ The battery door is now unlocked. You can lift the cover open.

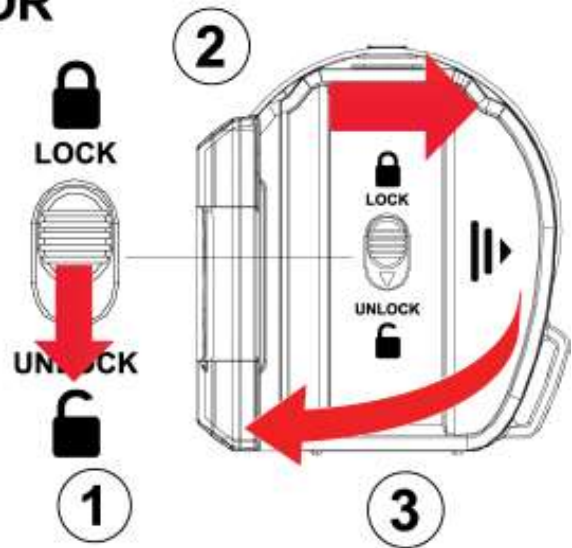

To Lock the Battery Door

CLOSE & LOCK BATTERY DOOR

- ① Flip the battery door down flat to close.
- ② Press the battery door down firmly and slide the door to the left until it clicks and locks into place. The door is fully locked into place once the latch clicks into the **LOCK** position.

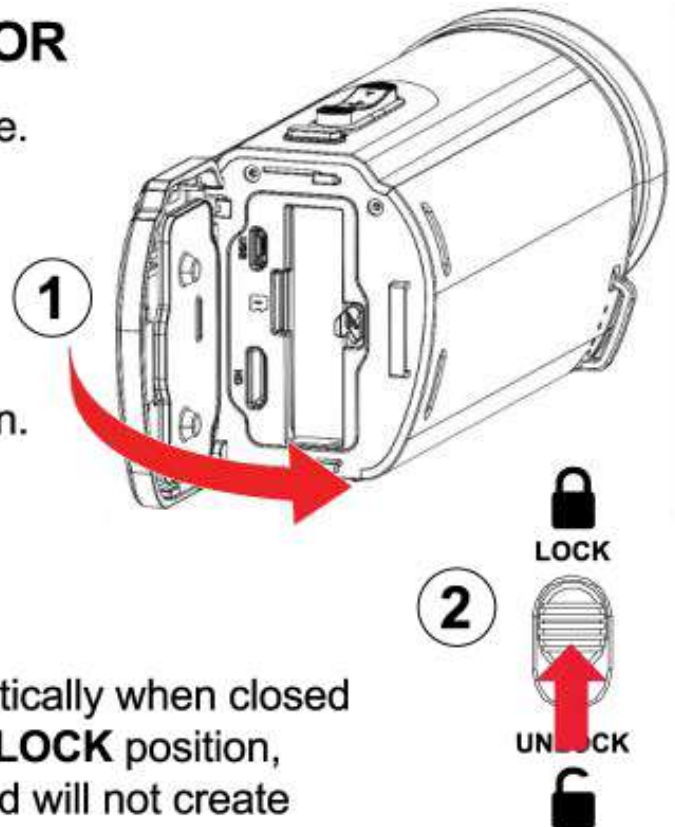

NOTE: The door locks into place automatically when closed properly. If the locking latch is not in the **LOCK** position, the battery door is not closed properly and will not create a waterproof seal.

Precautions When Cleaning

1. About Your Camcorder

- Do not puncture the microphone or speaker openings with a sharp implement.
- If the inside of the camcorder is damaged, the waterproof performance will deteriorate.
- Do not use soap, natural detergents, or chemicals such as benzene for cleaning.

Do Not Apply Strong Impact to the Camcorder

The product may malfunction if subjected to strong shock or vibration. In addition, do not touch or apply force to the lens.

Avoid Sudden Changes in Temperature

Sudden changes in temperature, such as when entering or leaving a heated building on a cold day, can cause condensation to form inside the device. To prevent condensation, place the device in a carrying case or a plastic bag before exposing it to sudden changes in temperature.

Keep Away from Strong Magnetic Fields

Do not use or store this device in the vicinity of equipment that generates strong electromagnetic radiation or magnetic fields. Doing so could result in loss of data or camcorder malfunction.

Do Not Point the Lens at Strong Light Sources for Extended Periods

Avoid pointing the lens at the sun or other strong light source light sources for extended periods when using or storing the camcorder. Intense light may cause the image sensor to deteriorate or produce a white blur effect in photographs.

Turn the Product Off before Removing or Disconnecting the Power Source or Memory Card

Do not remove the battery while the product is on, or while images are being saved or deleted. Forcibly cutting power in these circumstances could result in loss of data or cause damage to the memory card or internal circuitry.

Notes about the LCD Screen

- The LCD Screens are constructed with extremely high precision; At least 99.99% of pixels are effective, with no more than 0.01% being missing or defective. Hence, while these displays may contain pixels that are always lit (white, red, blue or green) or always off (black), this is not a malfunction and has no effect on images recorded with the device.
- Images viewed on the LCD screen may be difficult to see under certain lighting.
- Do not apply pressure to the LCD screen, as this could cause damage or malfunction.

1. About Your Camcorder

The Battery

Precautions for Use

- Note that the battery may become hot after use.
- Do not use the battery at ambient temperatures below 0°C (32°F) or above 40°C (104°F) as this could cause damage or malfunction.
- If you notice any abnormalities such as excessive heat, smoke, or an unusual smell coming from the battery, immediately discontinue use and consult your retailer.
- After removing the battery from the camcorder or optional battery charger, put the battery in a plastic bag, etc. in order to insulate it.

Charging the Battery

Check the battery level before using the camcorder and replace or charge the battery if necessary.

- Charge the battery indoors with an ambient temperature of 5°C (41°F) to 35°C (95°F) before use.
- A high battery temperature may prevent the battery from charging properly or completely, and may reduce battery performance. Note that the battery may become hot after use; wait for the battery to cool before charging. When charging the battery inserted into this camcorder using the Charging AC Adapter or a computer, the battery is not charged at battery temperature below 5°C (41°F) or above 55°C (131°F).
- When the battery is between 45°C (113°F) - 55°C (131°F), the chargeable capacity may decrease.
- Do not continue charging once the battery is fully charged as this will result in reduce battery performance.
- The battery temperature may increase during charging. However, this is not a malfunction.

Using the Battery When Cold

On cold days, the capacity of batteries tends to decrease. If an exhausted battery is used at a low temperature, the camcorder may not turn on. Keep spare batteries in a warm place and exchange as necessary. Once warmed, a cold battery may recover some of its charge.

Recycling Used Batteries

Replace the battery when it no longer holds a charge. Used batteries are a valuable resource. Please recycle used batteries in accordance with local regulations.

1. About Your Camcorder

Cleaning After Using the Camcorder Underwater

Follow the procedure below to rinse the camcorder with fresh water within 30 minutes after using it under saltwater or at the beach.

1. Keep the battery cover closed and wash off the camcorder with fresh water. Immerse the camcorder in a shallow basin filled with fresh water for 10 minutes.
2. Immerse the camcorder in fresh water and shake it sufficiently in the water to remove any foreign substances from the camcorder.
3. When the camcorder is immersed in the water, a few air bubbles may come out from the water drain holes of the camcorder such as openings in the microphone or speakers. This is not a malfunction.
4. Wipe off water droplets with soft cloth and dry the camcorder in a well-ventilated and shady place.
5. Place the camcorder on a dry cloth to dry it.
6. Do not dry the camcorder with hot air from a hair dryer or clothes dryer.
7. After making sure that there are no water droplets on the camcorder, open the battery cover and use a soft dry cloth to gently wipe off any water or sand remaining on the waterproof packing or inside the camcorder.

**If the cover is closed when the inside is wet,
this could cause condensation or a malfunction.**

Cleaning After Using the Camcorder in Conditions Other than Underwater

Use a blower to remove any dust or lint that adheres to the lens, monitor or camcorder body. To remove fingerprints or other stains that cannot be removed with a blower, gently wipe the parts with a soft dry cloth. If you wipe with too much pressure or with a rough cloth, it may damage the camcorder or cause a malfunction.

Storage

If you do not intend to use the camcorder for an extended period, remove the battery and avoid storing the camcorder in any of the following types of locations:

- Places that are poorly ventilated or subject to humidity of over 60%
- Place exposed to temperatures above 50°C (122°F) or below -10°C (14°F).
- Place next to equipment that produces strong electromagnetic field, such as television or radios.

To prevent mold or mildew, take the camcorder out of storage at least once a month, and turn it on and release the shutter a few times before putting it away again.

1. About Your Camcorder

1.1 Camcorder Interface

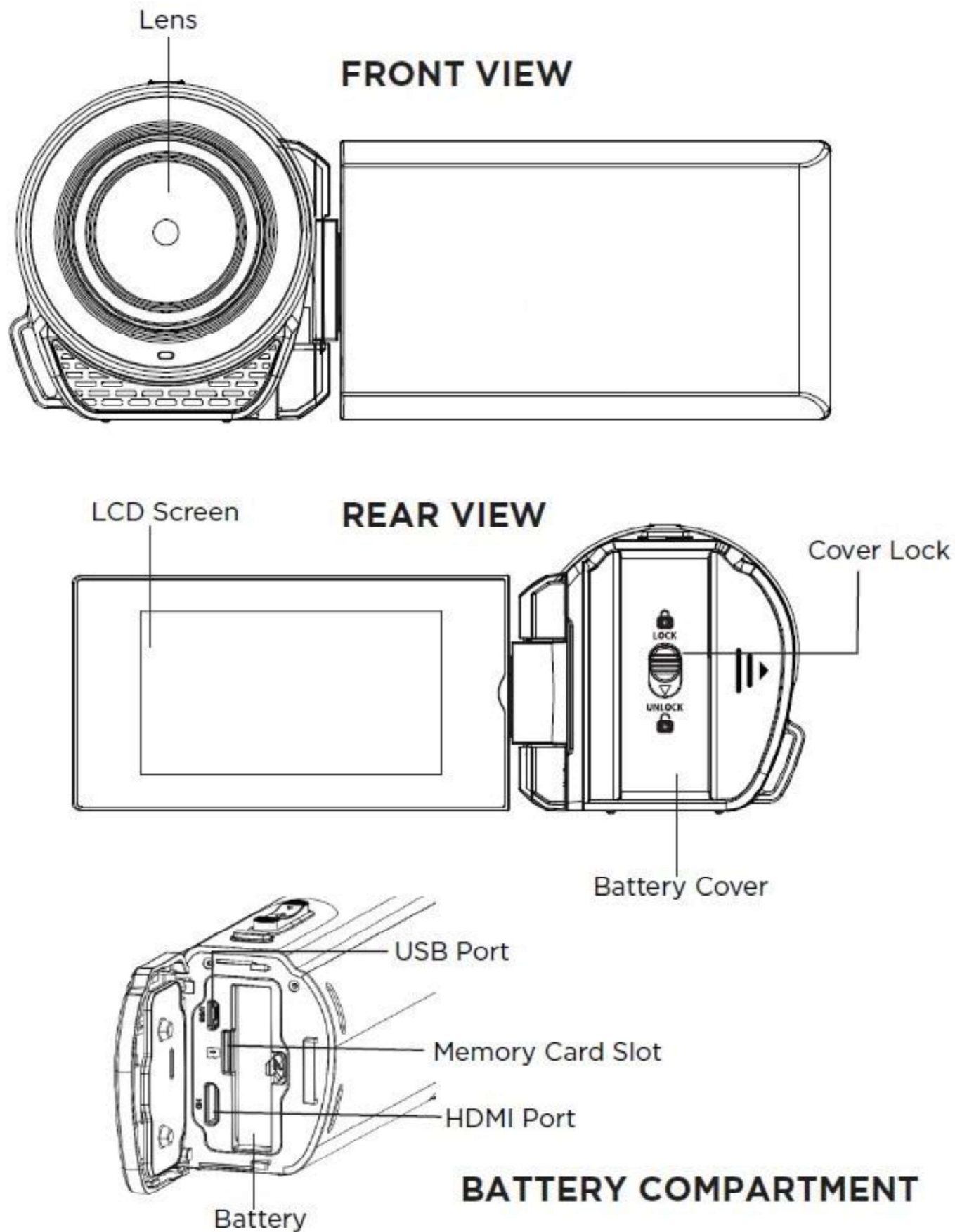

1. About Your Camcorder

BOTTOM VIEW

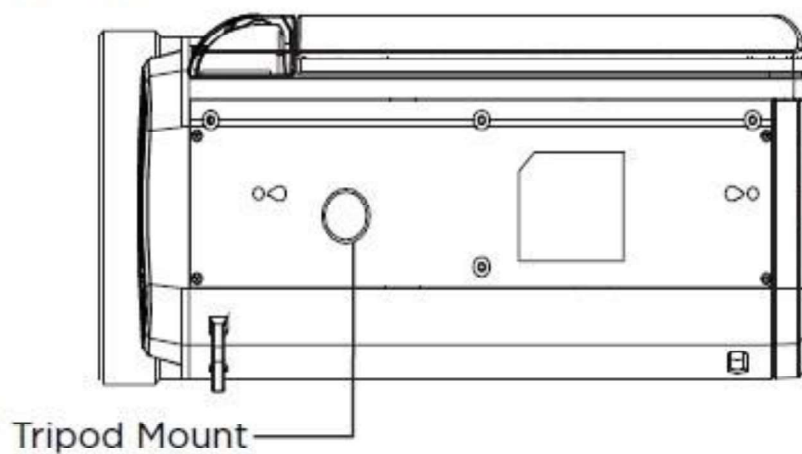

SIDE VIEW

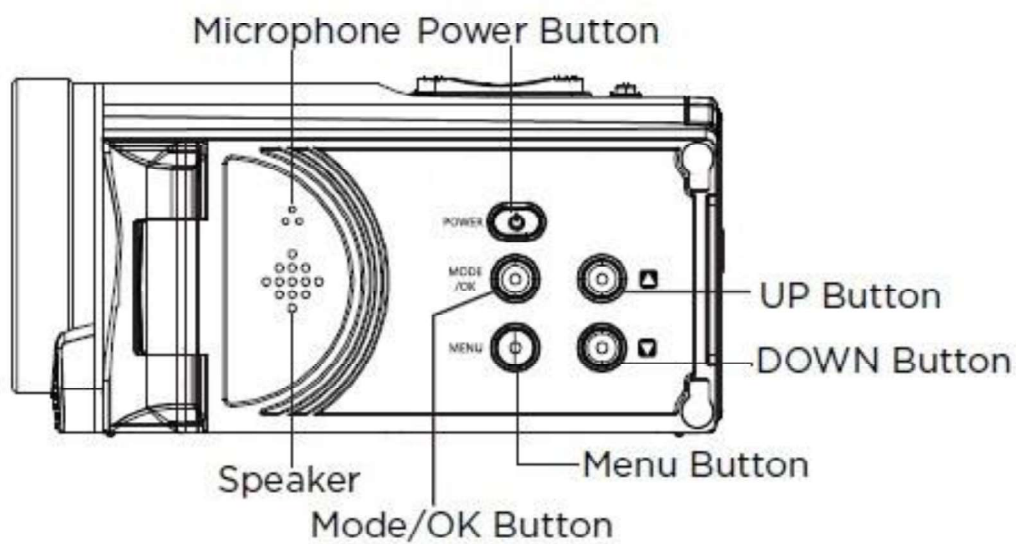

TOP VIEW

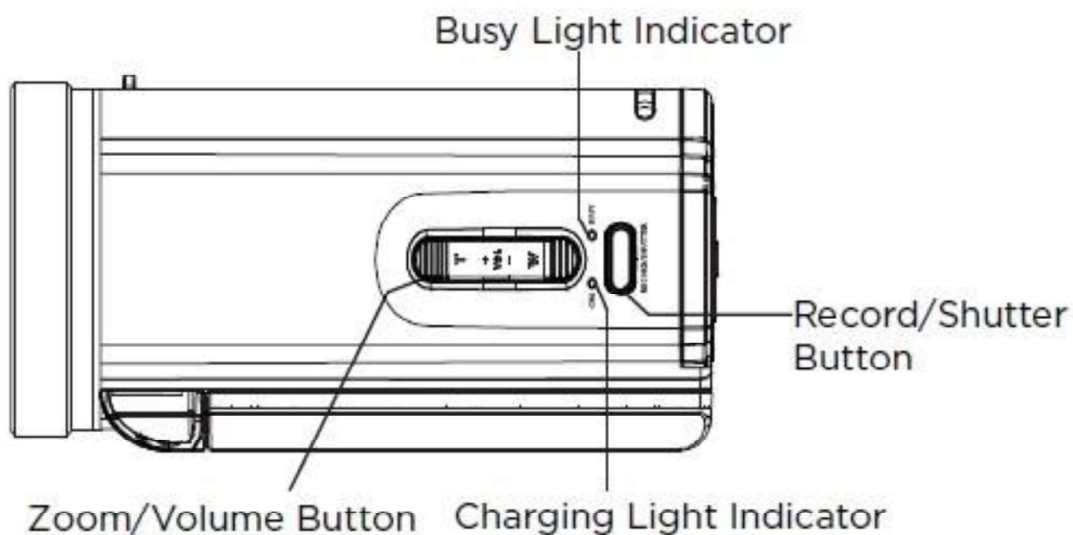

1. About Your Camcorder

1.2 Button Function Description

Function	Description
Power	Press once to power on and press and hold for 5 seconds to power off.
Mode OK	Press to change modes. OK button in menus. Tap to confirm a setting. In Video: Tap to pause a recording, tap again to resume recording. In Playback: While playing a recorded video, tap to pause and tap again to resume.
Menu	Tap to access and exit all menus and submenus.
Zoom Volume	In Video and Photo: Press and hold the front of the button to zoom-in. Press and hold the bottom of the button to zoom-out. In Playback: While playing a video, press to increase and decrease the volume.
Up	In Playback: Press to go to the previous file. In Settings: Press to select desired setting.
Down	In Playback: Press to go to the next file. In Settings: Press to select desired setting.
Shutter	In Video: Tap to start/stop recording video. In Photo: Tap to capture an image. In Playback: Tap to stop a playing video.
Photo OK	In Photo: Press hard to capture a photo. In Video: Tap to pause a recording, tap again to resume recording. In Playback: While playing a recorded video, tap to pause and tap again to resume. OK button in menus. Tap to confirm a setting.
Battery Door Release	Slide to the right to open the battery door.
Battery Door	Door to cover storage slot for inserting the battery, the memory card slot, the USB-C port and HDMI port
Tripod Mount	Mount port for attaching to a tripod nut.
Speaker	Built-in speaker output for playback of video files when audio recording is enabled.
Lens	Front capture device for all video and photo.

2. First Use

2. First Use

2.1 Opening and Closing the Battery Door

Follow the steps below to open and close the battery door:

UNLOCK & OPEN BATTERY DOOR

- ① Slide the door lock latch downward to the **UNLOCK** position and hold.
- ② While holding the door lock latch downward, push the cover to the right.
- ③ The battery door is now unlocked. You can lift the cover open.

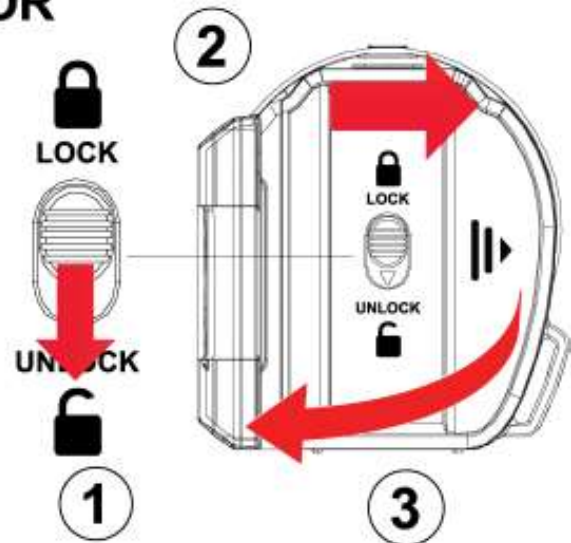

CLOSE & LOCK BATTERY DOOR

- ① Flip the battery door down flat to close.
- ② Press the battery door down firmly and slide the door to the left until it clicks and locks into place. The door is fully locked into place once the latch clicks into the **LOCK** position.



NOTE: The door locks into place automatically when closed properly. If the locking latch is not in the **LOCK** position, the battery door is not closed properly and will not create a waterproof seal.

2. First Use

2.2 Inserting the Memory Card

Insert the included MicroSD memory card to record and store your videos and photos. When the battery is low, media stored on the memory card will not be erased. Please insert the MicroSD memory card by following the steps below:

1. Open the battery door to access the memory card slot.
2. Insert the memory card. Ensure that the metal contacts are inserted first. Push the memory card down until you hear an audible click.

The memory card can only be inserted in one way. Do not force the card in if it will not go in smoothly.

3. Close and lock the battery door.
4. To remove the memory card, simply push in and the card will eject out.

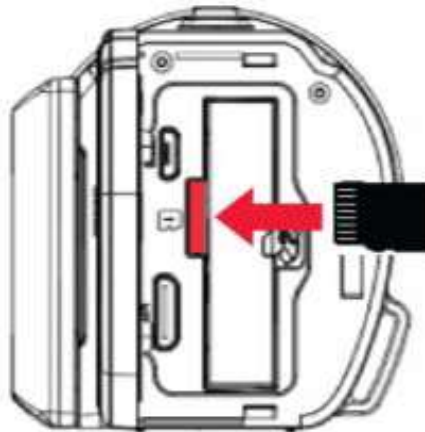

NOTE:

- Please format the memory card before using the camcorder (Caution, this will erase all data on the card).
- Do not remove or insert the memory card when recording. It may damage the card or cause data loss.
- Memory card rating must be Class 10 or above.

2.3 Installing the Battery

Insert the lithium-ion battery into the battery compartment with the metal contacts facing the inside of the camcorder. Push the battery in until it locks into place. The battery can only be inserted one way, if it does not lock into place then the battery has been inserted in the wrong orientation.

2. First Use

1. Open the battery door to access the battery compartment.
2. Insert the battery. Ensure that the metal contacts are inserted first. Push the down until you hear an audible click.
3. Close the battery door, you will hear an audible click when the battery door is locked.
4. To remove the battery, slide the battery lock away from the battery and the battery will eject.

2.4 Charging the Battery

Connect your camcorder to the included AC adaptor with the USB cable provided for charging. Open the battery door on the rear of the camcorder to access the charging port. Insert the small end of the USB plug into the camcorder's port, and the larger end into the included AC adaptor. The LED indicator light will light up red while charging and will light up green when charging is complete.

2.5 Powering the Camcorder On/Off

Press the **POWER** button to power the camcorder on. To power the camcorder off, press and hold the **POWER** button for 5 seconds. The camcorder will automatically power on and off when the screen is opened or closed. If the camcorder's battery is low, a "Low Power" message will display on the screen and it will automatically shut down within a few seconds to prevent memory corruption or loss.

2.6 Switching Modes

Press the **MODE/OK** button to switch between Video, Photo and Playback modes.

2.7 Connecting to a Computer

Your camcorder can connect to a computer to transfer photo and video files for viewing and editing, or use the camcorder as a web cam. To connect the camcorder to your computer, open the battery door on the rear of the camcorder to access the USB port. Insert the small end of the USB plug into the camcorder's port, and the larger end into the USB port on your computer. Once connected and powered on, the camcorder's screen will show "Mass Storage" and "PC Camera". Use the **UP** or **DOWN** buttons to select your

2. First Use

desired mode and press the **MODE/OK** button to enter into that mode. If a selection isn't made, the camcorder will automatically enter mass storage mode after 5 seconds.

2.8 Connecting to a TV

The camcorder can also be connected to a TV. When connected, the camcorder screen will turn off and the camcorder will function normally. Use the TV as the camcorder monitor. To connect the camcorder to your TV, open the rubber jack door on the rear of the camcorder to access the HDMI port. Insert the small end of the HDMI plug into the camcorder's port, and the larger end into the HDMI port on your TV. Then turn on the camcorder and it will be ready for use.

2.9 Using the Zoom Function

This camcorder has a digital zoom function. To operate the zoom function, slide the **UP** or **DOWN** button to the right to zoom in closer to the subject, and to the left to zoom away from the subject.

2.10 Attaching External Accessories

The camcorder lens has a 37mm diameter threading for compatible filters and attachments.

PLEASE NOTE: Only the camcorder itself is waterproof, any added external accessories should NOT be used in wet environments or underwater. Using external accessories in wet environments or underwater may cause them to become damaged or to malfunction.

3. Using the Camcorder

3.1 Video Recording

You may rotate the mode dial to switch to another mode. A camcorder icon will appear in the top left corner of the screen when you are in Video mode.

1. Line up your shot by looking at the LCD screen to see what is in view.
2. Hold the camcorder steady and press the **SHUTTER** button to begin recording.
3. When recording begins, a rolling timer will display in red in the top right corner of the screen. This indicates the recorded video time elapsed.
4. Press the **MODE/OK** button to pause and resume recording. Press the **SHUTTER** button to stop recording.
5. The recorded video files will automatically save onto the inserted memory card.

3.1.1 Movie Size (Resolution)

Your camcorder has a number of preset resolutions.

1. In Video Mode press the **MENU** button.
2. Select '*Movie Size*' using the **UP** or **DOWN** buttons and press the **MODE/OK** button to enter the '*Movie Size*' submenu.
3. Press the **UP** or **DOWN** buttons to navigate the menu and press the **MODE/OK** button to confirm your selected setting (*4K(30fps)*, *2.7K(30fps)*, *1080P(60fps)*, *1080P(30fps)*, *720P(60fps)*, *720P(30fps)*). A higher resolution and faster frames per second rate will produce a higher quality and larger video file.
4. You can also press the **MENU** button to exit the submenu without making a selection.

3.1.2 Loop Recording

This setting allows you to set a maximum duration for each video clip recorded. Once you select an option, your camcorder will record video clips in this time interval only. Once your selected duration recording time is reached, the camcorder will end the recording and begin recording a new video file seamlessly.

1. In Video Mode press the **MENU** button.
2. Select '*Loop Recording*' using the **UP** or **DOWN** buttons and press the **MODE/OK** button to enter the '*Loop Recording*' submenu.
3. Press the **UP** or **DOWN** buttons to navigate the menu and press the

3. Using the Camcorder

MODE/OK button to confirm your selected setting (*Off, 1 Minute, 3 Minutes, 5 Minutes, 10 Minutes*).

4. You can also press the **MENU** button to exit the submenu without making a selection.

3.1.3 Color Filter

This function sets the color filter effect of a video.

1. In Video Mode press the **MENU** button.
2. Select '*Color Filter*' using the **UP** or **DOWN** buttons and press the **MODE/OK** button to enter the '*Color Filter*' submenu.
3. Press the **UP** or **DOWN** buttons to navigate the menu and press the **MODE/OK** button to confirm your selected filter (*Normal, Black & White, Sepia*).
4. You can also press the **MENU** button to exit the submenu without making a selection.

3.1.4 White Balance

White Balance changes the color of light in your pictures, making it seem warmer or cooler depending on how the light you're shooting in affects the frame.

1. In Video Mode press the **MENU** button.
2. Select '*White Balance*' using the **UP** or **DOWN** buttons and press the **MODE/OK** button to enter the '*White Balance*' submenu.
3. Press the **UP** or **DOWN** buttons to navigate the menu and press the **MODE/OK** button to confirm your selected setting (*Auto, Daylight, Cloudy, Tungsten, Fluorescent*).
4. You can also press the **MENU** button to exit the submenu without making a selection.

3.1.5 Exposure

This function adjusts the frame brightness in your video.

1. In Video Mode press the **MENU** button.
2. Select '*Exposure*' using the **UP** or **DOWN** buttons and press the **MODE/OK** button to enter the '*Exposure*' submenu.
3. Press the **UP** or **DOWN** buttons to navigate the menu and press the **MODE/OK** button to confirm your selected exposure mode (*+3, +2, +1, 0*,

3. Using the Camcorder

-1, -2, -3).

4. You can also press the **MENU** button to exit the submenu without making a selection.

3.1.6 Motion Detection

This setting allows the camcorder to automatically begin recording if movement is detected in front of the camcorder lens. Once recording, the camcorder will stop recording if not further movement is detected within a 10-second period of the last movement registered. You may also manually stop recording anytime by pressing the **SHUTTER** button during a recording.

1. In Video Mode press the **MENU** button.
2. Select '*Motion Detection*' using the **UP** or **DOWN** buttons and press the **MODE/OK** button to enter the '*Motion Detection*' submenu.
3. Press the **UP** or **DOWN** buttons to navigate the menu and press the **MODE/OK** button to confirm your selected setting (*Off, On*).
4. You can also press the **MENU** button to exit the submenu without making a selection.

3.1.7 Record Audio

This setting allows you to set the built-in microphone ON or OFF during a video recording. Once you select an option, your camcorder will either record audio within the video file, or record a video file without audio captured.

1. In Video Mode press the **MENU** button.
2. Select '*Record Audio*' using the **UP** or **DOWN** buttons and press the **MODE/OK** button to enter the '*Record Audio*' submenu.
3. Press the **UP** or **DOWN** buttons to navigate the menu and press the **MODE/OK** button to confirm your selected setting (*Off, On*).
4. You can also press the **MENU** button to exit the submenu without making a selection.

3.1.8 Time-Lapse Interval

This feature allows you to capture long sequences of events in a much shorter time period.

1. In Video Mode press the **MENU** button.
2. Select '*Time-Lapse Interval*' using the **UP** or **DOWN** buttons and press the **MODE/OK** button to enter the '*Time-Lapse Interval*' submenu.

3. Using the Camcorder

3. Press the **UP** or **DOWN** buttons to navigate the menu and press the **MODE/OK** button to confirm your selected setting (*Off, 0.1 Seconds, 0.2 Seconds, 0.5 Seconds, 1 Second, 5 Seconds, 10 Seconds, 30 Seconds, 1 Minute, 5 Minutes*).
4. You can also press the **MENU** button to exit the submenu without making a selection.

NOTE: By selecting '*5 Seconds*' the camcorder will capture a photo every 5 seconds and create a time-lapse video. To disable Time-Lapse recording, select '*Off*' in this submenu.

3. Using the Camcorder

3.2 Photo Shooting

Power the camcorder on and press the **MODE/OK** button or press the icon in the top left corner of the touch screen to switch to Photo mode.

1. Line up your shot by looking at the LCD screen to see what is in the shot.
2. Hold the camcorder steady, soft press the **MODE/OK** button to focus on the scene and hard press the **MODE/OK** button to capture a photo.
3. The number of photos that can be captured at a particular resolution will be displayed in the top right corner of the screen.
4. The number of remaining photos is determined by the selected photo resolution. The higher the photo resolution, the lower the number of photos you are able to be save to the memory card. Before capturing any photos, you can select a preferred photo resolution.

3.2.1 Photo Size (Resolution)

Your camcorder has a number of preset resolutions.

1. In Photo Mode press the **MENU** button.
2. Select '*Photo Size*' using the **UP** or **DOWN** buttons and press the **MODE/OK** button to enter the '*Photo Size*' submenu.
3. Press the **UP** or **DOWN** buttons to navigate the menu and press the **MODE/OK** button to confirm your selected setting (*56MP, 48MP, 30MP, 24MP, 20MP, 16MP, 12MP, 8MP, 5MP*). A higher resolution will produce a higher quality and larger image file.
4. You can also press the **MENU** button to exit the submenu without making a selection.

3.2.2 Interval Photo

In Interval photo mode, the camcorder will take a single photo every second until stopped. This function allows you to turn Interval Photo on or off. When Interval Photo is turned on, press the **SHUTTER** button for the camcorder to start capturing images press the **SHUTTER** button again to stop capturing images. Each image will be saved as individual files.

1. In Photo Mode press the **MENU** button.
2. Select '*Interval Photo*' using the **UP** or **DOWN** buttons and press the **MODE/OK** button to enter the '*Interval Photo*' submenu.
3. Press the **UP** or **DOWN** buttons to navigate the menu and press the **MODE/OK** button to confirm your selected setting (*Off, On*).

3. Using the Camcorder

4. You can also press the **MENU** button to exit the submenu without making a selection.

3.2.3 Self-Timer

This function determines the time delay before a photograph is captured. This setting can be used by photographers to take photographs of themselves.

1. In Photo Mode press the **MENU** button.
2. Select '*Self-Timer*' using the **UP** or **DOWN** buttons and press the **MODE/OK** button to enter the '*Self-Timer*' submenu.
3. Press the **UP** or **DOWN** buttons to navigate the menu and press the **MODE/OK** button to confirm your selected setting (*Off, 2 Seconds, 5 Seconds, 10 Seconds*).
4. You can also press the **MENU** button to exit the submenu without making a selection.

3.2.4 Color Filter

This function sets the color filter effect of a video.

1. In Photo Mode press the **MENU** button.
2. Select '*Color Filter*' using the **UP** or **DOWN** buttons and press the **MODE/OK** button to enter the '*Color Filter*' submenu.
3. Press the **UP** or **DOWN** buttons to navigate the menu and press the **MODE/OK** button to confirm your selected filter (*Normal, Black & White, Sepia*).
4. You can also press the **MENU** button to exit the submenu without making a selection.

3.2.5 Photo Burst

This function allows to you capture 3 consecutive photos with one click of the **SHUTTER** button.

1. In Photo Mode press the **MENU** button.
2. Select '*Photo Burst*' using the **UP** or **DOWN** buttons and press the **MODE/OK** button to enter the '*Photo Burst*' submenu.
3. Press the **UP** or **DOWN** buttons to navigate the menu and press the **MODE/OK** button to confirm your selected setting (*Off, 3-Photo Burst*).
4. You can also press the **MENU** button to exit the submenu without making a selection.

3. Using the Camcorder

3.2.6 Quality

This setting determines the level of compression the camcorder uses when saving photos to your memory card. A high level of compression will produce a lower quality photo, and will also use less space when saving your photos.

1. In Photo Mode press the **MENU** button.
2. Select '*Quality*' using the **UP** or **DOWN** buttons and press the **MODE/OK** button to enter the '*Quality*' submenu.
3. Press the **UP** or **DOWN** buttons to navigate the menu and press the **MODE/OK** button to confirm your selected setting (*Fine, Normal, Economy*).
4. You can also press the **MENU** button to exit the submenu without making a selection.

3.2.7 White Balance

White Balance changes the color of light in your pictures, making it seem warmer or cooler depending on how the light you're shooting in affects the frame.

1. In Photo Mode press the **MENU** button.
2. Select '*White Balance*' using the **UP** or **DOWN** buttons and press the **MODE/OK** button to enter the '*White Balance*' submenu.
3. Press the **UP** or **DOWN** buttons to navigate the menu and press the **MODE/OK** button to confirm your selected setting (*Auto, Daylight, Cloudy, Fluorescent, Tungsten*).
4. You can also press the **MENU** button to exit the submenu without making a selection.

3. Using the Camcorder

3.2.8 ISO

This function adjusts the light sensitivity in your photograph.

1. In Photo Mode press the **MENU** button.
2. Select '*ISO*' using the **UP** or **DOWN** buttons and press the **MODE/OK** button to enter the '*ISO*' submenu.
3. Press the **UP** or **DOWN** button to navigate the menu and press the **MODE/OK** button to confirm your selected setting (*Auto, 100, 200, 400, 800, 1600*).
4. You can also press the **MENU** button to exit the submenu without making a selection.

3.2.9 Exposure

This function adjusts the frame brightness in your video.

1. In Photo Mode press the **MENU** button.
2. Select '*Exposure*' using the **UP** or **DOWN** buttons and press the **MODE/OK** button to enter the '*Exposure*' submenu.
3. Press the **UP** or **DOWN** buttons to navigate the menu and press the **MODE/OK** button to confirm your selected setting (*+3, +2, +1, 0, -1, -2, -3*).
4. You can also press the **MENU** button to exit the submenu without making a selection.

3.2.10 Metering

Metering mode refers to the way in which a camcorder determines the appropriate exposure (quantity of light reaching the camcorder lens). Spot metering will only base the exposure setting on a very small area of the scene. Center metering will use the light from the center of the LCD and the Multi setting measures the light at several points on the screen.

1. In Photo Mode press the **MENU** button.
2. Select '*Metering*' using the **UP** or **DOWN** buttons and press the **MODE/OK** button to enter the '*Metering*' submenu.
3. Press the **UP** or **DOWN** buttons to navigate the menu and press the **MODE/OK** button to confirm your selected setting (*Average, Center-Weighted, Spot*).
4. You can also press the **MENU** button to exit the submenu without making a selection.

3. Using the Camcorder

3.3 Playback Mode

Videos and photos captured on your camcorder can be easily played back.

1. Press the **MODE/OK** button until you enter Playback mode.
2. Press the **UP** or **DOWN** buttons to cycle through the captured files stored on the memory card.
2. While viewing a recorded video, press the **SHUTTER** button to start playing a recorded video, press the **MODE/OK** button again to pause the video and press the **SHUTTER** button to stop the video. While playing, press the **ZOOM-IN** button to increase the volume and press the **ZOOM-OUT** button to decrease the volume, press the **UP** button to rewind and press the **DOWN** button to fast forward.

In Playback Mode the following options are available:

3.3.1 Delete

This function is used to delete captured files. Files can be deleted singly or all at once. **Deleted files are permanently deleted and cannot be recovered.**

1. In Playback Mode press the **MENU** button.
2. Use the **UP** or **DOWN** buttons to select '*Delete*'. Press the **MODE/OK** button to enter the '*Delete*' submenu.
3. Press the **UP** or **DOWN** buttons to navigate the menu, and press the **MODE/OK** button for your selected setting (*Delete Current, Delete All*).
4. Press the **MENU** button to exit the menu without deleting any files.

3.3.2 Protect

This function protects files. The file will be protected from being deleted accidentally. Files must be unprotected to be deleted.

1. In Playback Mode press the **MENU** button.
2. Use the **UP** or **DOWN** buttons to select '*Protect*'. Press the **MODE/OK** button to enter the '*Protect*' submenu.
3. Press the **UP** or **DOWN** buttons to navigate the menu, and press the **MODE/OK** button for your selected setting (*Lock Current, Unlock Current, Lock All, Unlock All*).

3. Using the Camcorder

4. Press the **MENU** button to exit the menu without protecting any videos.

3.3.3 Slide Show

Photographs can be viewed as a slideshow on the camcorder.

1. In Playback Mode press the **MENU** button.
2. Use the **UP** or **DOWN** buttons to select '*Slide Show*'. Press the **MODE/OK** button to enter the '*Slide Show*' submenu.
3. Press the **UP** or **DOWN** buttons to navigate the menu, and press the **MODE/OK** button for your selected setting and to start the slide show (*2 Seconds, 5 Seconds, 8 Seconds*).
4. Press the **MODE/OK** button to pause the slide show and press the **SHUTTER** button stop the slide show.
5. You can also press the **MENU** button to exit the submenu without making a selection.

3. Using the Camcorder

3.4 Setup Mode

Basic settings can be changed in the Setup menu. These include date & time, language and sound options. Power the camcorder on and rotate the mode dial to enter the Settings mode. A menu will display on the screen.

3.4.1 Date and Time Set

This function allows you to set the current Date and Time on your recorded video clips and captured photos.

1. In Video or Photo Mode press the **MENU** button to enter the settings mode.
2. Then press the **MENU** button again to enter the Setup mode.
3. Use the **UP** or **DOWN** buttons to select '*Date and Time Set*' and press the **MODE/OK** button to enter the '*Date and Time Set*' submenu.
4. Press the **UP** or **DOWN** buttons to change the highlighted value.
5. Press the **MODE/OK** button to change the selected value.
6. Press the **MODE/OK** button to exit the submenu after setting the date and time.
7. Press the **MENU** button to exit the submenu without making any changes.

3.4.2 Date and Time Stamp

This setting allows you to imprint a date & time onto your captured image files. Once an image file is captured with the imprint, the imprint cannot be removed.

1. In Video or Photo Mode press the **MENU** button to enter the settings mode.
2. Then press the **MENU** button again to enter the Setup mode.
3. Use the **UP** or **DOWN** buttons to select Function and press the **MODE/OK** button to enter the menu.
4. Select '*Date Stamp*' using the **UP** or **DOWN** buttons and press the **MODE/OK** button to enter the '*Date Stamp*' submenu.
5. Press the **UP** or **DOWN** buttons to navigate the menu and press the **MODE/OK** button to confirm your selected setting (*Off, Date and Time*).
6. You can also press the **MENU** button to exit the submenu without making a selection.

3. Using the Camcorder

3.4.3 Auto Power Off

This function sets the duration of time in which the camcorder will wait with no user input before automatically powering off.

1. In Video or Photo Mode press the **MENU** button to enter the settings mode.
2. Then press the **MENU** button again to enter the Setup mode.
3. Use the **UP** or **DOWN** buttons to navigate and select '*Auto Power Off*' and press the **MODE/OK** button to enter the '*Auto Power Off*' submenu.
4. Press the **UP** or **DOWN** buttons to navigate the menu and then press the **MODE/OK** button to confirm your selected setting (*Off, 1 Minute, 2 Minutes, 3 Minutes, 5 Minutes, 10 Minutes*).
5. You can also press the **MENU** button to exit the submenu without making a selection.

3.4.4 Screen Saver

This setting allows you to set the length of time before the LCD Screen turns off automatically. The camcorder will remain powered on while the screen turns off. Press any button to turn the screen back on.

1. In Video or Photo Mode press the **MENU** button to enter the settings mode.
2. Then press the **MENU** button again to enter the Setup mode.
3. Use the **UP** or **DOWN** buttons to select '*Screen Saver*' and press the **MODE/OK** button to enter the '*Screen Saver*' submenu.
4. Press the **UP** or **DOWN** buttons to select your desired setting (*Off, 5 Minutes, 10 Minutes*), Then press the **MODE/OK** button to confirm your selection.
5. You can also press the **MENU** button to exit the submenu without making a selection.

3.4.5 Button Sound

This function can turn the sound the camcorder makes after pressing a button, on or off.

1. In Video or Photo Mode press the **MENU** button to enter the settings mode.
2. Then press the **MENU** button again to enter the Setup mode.
3. Use the **UP** or **DOWN** buttons to select '*Button Sound*' and press the

3. Using the Camcorder

MODE/OK button to enter the '*Button Sound*' submenu.

4. Press the **UP** or **DOWN** buttons to select your desired setting (*Off, On*), Then press the **MODE/OK** button to confirm your selection.
5. You can also press the **MENU** button to exit the submenu without making a selection.

3.4.6 Language

This function allows you to set the camcorder's interface language.

1. In Video or Photo Mode press the **MENU** button to enter the settings mode.
2. Then press the **MENU** button again to enter the Setup mode.
3. Use the **UP** or **DOWN** buttons to select '*Language*' and press the **MODE/OK** button to enter the '*Language*' submenu.
4. Press the **UP** or **DOWN** buttons to select your desired language. Then press the **MODE/OK** button to confirm your selection.
5. You can also press the **MENU** button to exit the submenu without making a selection.

3.4.7 Frequency

This function sets the frequency of the camcorder from 50Hz to 60Hz.

Please check the frequency of your location and set accordingly.

1. In Video or Photo Mode press the **MENU** button to enter the settings mode.
2. Then press the **MENU** button again to enter the Setup mode.
3. Use the **UP** or **DOWN** buttons to select '*Frequency*' and press the **MODE/OK** button to enter the '*Frequency*' submenu.
4. Press the **UP** or **DOWN** buttons to select your desired frequency. Then press the **MODE/OK** button to confirm your selection (*50Hz, 60Hz*). The default frequency for the United States is 60Hz.
5. You can also press the **MENU** button to exit the submenu without making a selection.

3.4.8 Format Memory Card

The format setting erases all photos, videos and data stored on your memory card.

1. In Video or Photo Mode press the **MENU** button to enter the settings mode.

3. Using the Camcorder

2. Then press the **MENU** button again to enter the Setup mode.
 3. Use the **UP** or **DOWN** buttons to select '*Format Memory Card*' and press the **MODE/OK** button to enter the submenu.
 4. Press the **UP** or **DOWN** buttons to select your desired selection, press the **MODE/OK** button for your selected setting (*Cancel, OK*).
- NOTE: This will delete all of your media and cannot be undone.**
5. You can also press the **MENU** button to exit the submenu without making a selection.

3.4.9 Default Settings

Factory default settings can be restored in this menu. This function will not delete the media stored on the memory card, and will only restore all of the menu's setting back to factory default settings.

1. In Video or Photo Mode press the **MENU** button to enter the settings mode.
2. Then press the **MENU** button again to enter the Setup mode.
3. Use the **UP** or **DOWN** buttons to select '*Default Settings*' and press the **MODE/OK** button to enter the '*Default Settings*' submenu.
4. Press the **UP** or **DOWN** buttons to select your desired option, then press the **MODE/OK** button to confirm your selection (*Cancel, OK*).
5. Press the **MENU** button to exit the submenu without making a selection.

3.4.10 Version

The firmware version of the camcorder can be viewed here.

1. In Video or Photo Mode press the **MENU** button to enter the settings mode.
2. Then press the **MENU** button again to enter the Setup mode.
3. Use the **UP** or **DOWN** buttons to select '*Version*'.
4. The firmware version will be shown on the screen.

4. Technical Specifications

Model Number	Minolta MN4K300WP
Lens	Fixed Focus • f=7.0mm • F/2.4 • 37mm Front Threading for Lens Accessory Attachments
Zoom	18X Digital Zoom
Image Sensor	13MP CMOS Sensor • Digital Stabilization
Shutter	Electronic
Pixels (photo)	JPEG: 56MP • 48MP • 30MP • 24MP • 20MP • 16MP • 12MP • 8MP • 5MP
Pixels (video)	MP4: 4K(30fps) • 2.7K(30fps) • 1080P(60fps) • 1080P(30fps) • 720P(60fps) • 720P(30fps)
ISO Sensitivity	Auto • 100 • 200 • 400 • 800 • 1600
LCD Monitor	3.0 Inch IPS High Resolution LCD
Waterproof Rating	IPX7 Up to 16 feet for 1 hour
Power Saving Mode	OFF • 3 Minutes • 5 Minutes • 10 Minutes
White Balance Control	Auto • Daylight • Cloudy • Tungsten • Fluorescent
Special Features	Photo Burst • Self-Timer • Photo Color Filters • Loop Recording • Motion Detection
Recording Media	MicroSD • MicroSDXC; Maximum: 128GB
I/O Ports	USB-C • Mini HDMI-d
Power	P16 Lithium-Polymer; 3.8v, 3,400mAH
Dimensions	5.33 x 2.51 x 2.64 in. • 12.9 oz.



*Minolta is a registered trademark of JMM Lee Properties, LLC
and is used in the United States by Elite Brands Inc. under license.*

*40 Wall Street, 61st Floor, New York, NY 10005 USA • Tel: 800-441-1100
www.minoltadigital.com • www.elitebrands.com
Copyright © 2023 Elite Brands Inc.*

***If you're having difficulties with your camcorder, or would like further
assistance, please call our toll-free technical support hotline at 800-441-1100.
Please be sure to have your camcorder handy when calling.***





MINOLTA®

MN4K300WP

