

— WORLD EQUESTRIAN CENTER® —

# CHAMPIONSHIP SHOW | AQHA & NSBA

— SEPTEMBER 6-15 —

**OVER \$1,000,000  
IN CASH AWARDS  
BELT BUCKLES & PRIZES**



**GPS Address:** 1750 NW 80<sup>th</sup> Ave, Ocala, FL 34482

**Package Address:** 8105 NW 21<sup>st</sup> Ocala, FL 33482 (will arrive to the general store. Freight address differs.)

**Fall Championship Judging Pool:** Eric Petersen, Jeff Greaves, Lisa Ligon, Mark Russell, Buddy Fisher, Lynda Danielson, Terry Cross, Stephen Stephens, Pierre Briere, Nancie Wright, Tom McBeath, David Denniston, Bob Johnson, Melissa Sexton, Jodi Finkenbinder, Sara Simons, Andrea Simons, Jennifer Goss, Gayle Lampinen, Valerie Kearns, Shannon Walker, Jonathan Meilleur, Dolly Chayer, Alex Bryner

**Friday, September 6**

**Arena 5 - Covered - 8:00 am**

**Blocked for Round 1 of AQHA till Rail**

- 101/501. AQHA L1 Ranch Trail & \*NSBA Jackpot
- 102/502. AQHA Junior Ranch Trail & \*NSBA Jackpot
- 103/503. AQHA L1 Amateur & \*NSBA Jackpot
- 104/504. AQHA L1 Select Ranch Trail Ranch Trail & \*NSBA Jackpot
- 105/505. AQHA L1 Youth Ranch Trail & \*NSBA Jackpot
- 106/506. Green Working Western Rail (Non AQHA) & \*NSBA Jackpot
- 107/507. AQHA Senior Working Western Rail & \*NSBA Jackpot
- 108/508. AQHA Amateur Working Western Rail & \*NSBA Jackpot
- 109/509. AQHA Select Working Western Rail & \*NSBA Jackpot
- 110/510. AQHA Youth Working Western Rail & \*NSBA Jackpot
- 111/511. AQHA Junior Working Western Rail & \*NSBA Jackpot

**Arena 5 - 9 am - blocked till 3-year-old**

- 112/512. AQHA L1 Ranch Riding & \*NSBA Jackpot
- 113/513. AQHA Junior Ranch Riding & \*NSBA Jackpot
- 114/514. AQHA L1 Amateur Ranch Riding & \*NSBA Jackpot
- 115/515. AQHA L1 Select Ranch Riding & \*NSBA Jackpot
- 116/516. AQHA L1 Youth Ranch Riding & \*NSBA Jackpot
- 1000. \$35,000 NSBA 3-year-old Ranch Riding

**Hunter Arena 3 - Blocked 8:00 am**

- 117/517. AQHA L1 Working Hunter & \*NSBA Jackpot
- 118/518. AQHA Progressive Working Hunter & \*NSBA Jackpot
- 119/519. AQHA Junior Working Hunter & \*NSBA Jackpot
- 120/520. AQHA L1 Amateur Working Hunter & \*NSBA Jackpot
- 121/521. AQHA L1 Youth Working Hunter & \*NSBA Jackpot
- 122/522. AQHA Select Working Hunter & \*NSBA Jackpot

**Block B - to follow Block A**

- 123/523. AQHA Senior Working Hunter & \*NSBA Jackpot
- 124/524. AQHA Amateur Working Hunter & \*NSBA Jackpot
- 125/525. AQHA Youth Working Hunter & \*NSBA Jackpot

**Grand Arena - Hotel Side - 8:00 am**

- 1001. \$15,000 NSBA Open Maturity Western Pleasure
- 1002. \$15,000 NSBA Maturity Open Hunter Under Saddle
- 1003. \$15,000 NSBA 3-year-old Open Western Pleasure
- 1004/7004. \$10,000 NSBA 4-year-old Open Hunter Under Saddle & \$2500 Super Sires 4-year-old Open Hunter Under Saddle (Breeders Purse)
- 1005. \$5000 NSBA Color Open Western Pleasure
- 1006. \$15,000 NSBA 3-year-old Open Hunter Under Saddle
- 1007. \$2000 NSBA \$1000 Novice Horse Western Pleasure
- 1008. \$10,000 NSBA Open Maturity Western Pleasure - Limited Rider

**Grand Arena - B - 8:00 am**

- 126/526. AQHA Green Senior Trail & \*NSBA Jackpot
- 127/527. AQHA Novice Youth 13 & under Trail & \*NSBA Jackpot
- 128/528. AQHA Novice 14-18 Trail & \*NSBA Jackpot
- 129/529. Small Fry & \*NSBA Jackpot
- 130/530. AQHA Novice Amateur Walk/Jog Trail & \*NSBA Jackpot
- 131/531. AQHA Novice Youth Walk/Jog Trail & \*NSBA Jackpot
- 1009/1010. \$5000 NSBA 4 & 5 year old Open Trail & \$1000 Limited Rider **Bonus**

*All arenas & schedules subject to change.*

## Saturday, September 7

### Arena 5 - Covered – 8:00 am blocked

*If weather permits, the Tree Arena may be used for Ranch Trail.  
Watch for announcements.*

- 132/133/533. AQHA L2/L3 Senior Ranch Trail & \*NSBA Jackpot
- 134/534. AQHA Amateur Ranch Trail & \*NSBA Jackpot
- 135/535. AQHA Select Ranch Trail & \*NSBA Jackpot
- 136/536. AQHA Youth 13 & under Ranch Trail & \*NSBA Jackpot
- 137/537. AQHA 14-18 Ranch Trail & \*NSBA Jackpot

### Arena 5 – 8:00 am - blocked

- 138/538. AQHA 13 & under Ranch Riding & \*NSBA Jackpot
- 139/539. AQHA 14-18 Ranch Riding & \*NSBA Jackpot
- 140/540. AQHA Amateur Ranch Riding & \*NSBA Jackpot
- 141/541. AQHA Select Ranch Riding & \*NSBA Jackpot
- 142/143/543. AQHA L2/L3 Senior Ranch Riding & \*NSBA Jackpot

### Hunter 3 – 8:00 am

- 144/544. AQHA L1 Youth Equitation Over Fences & \*NSBA Jackpot
- 145/545. AQHA L1 Amateur Equitation Over Fences & \*NSBA Jackpot
- 146/546. AQHA Select Equitation Over Fences & \*NSBA Jackpot
- 147/547. AQHA Youth Equitation Over Fences & \*NSBA Jackpot
- 148/548. AQHA Amateur Equitation Over Fences & \*NSBA Jackpot

### Following Equitation Over Fences – Hunter 4

- 149/549. AQHA L1 Hunter Hack & \*NSBA Jackpot
- 150/550. AQHA Junior Hunter Hack & \*NSBA Jackpot
- 151/551. AQHA L1 Youth Hunter Hack & \*NSBA Jackpot
- 152/552. AQHA L1 Amateur Hunter Hack & \*NSBA Jackpot
- 153/553. AQHA Select Hunter Hack & \*NSBA Jackpot
- 154/554. AQHA Youth Hunter Hack & \*NSBA Jackpot
- 155/555. AQHA Amateur Hunter Hack & \*NSBA Jackpot
- 156/556. AQHA Senior Hunter Hack & \*NSBA Jackpot

### Grand Arena – Hotel Side - (Showmanship – 2 judges, Halter – 4 judges) – 8 am

- 157/557. AQHA L1 13 & under Youth Showmanship & \*NSBA Jackpot
- 158/558. AQHA L1 14-18 Showmanship & \*NSBA Jackpot
- 159/559. AQHA 13 & under Showmanship & \*NSBA Jackpot
- 160/161/561. AQHA L2/L3 14-18 Showmanship & \*NSBA Jackpot
- 162/562. Small Fry Showmanship & \*NSBA Jackpot
- 163/563. AQHA L1 Amateur Showmanship & \*NSBA Jackpot
- 164/165/565. AQHA L2/L3 Amateur Showmanship & \*NSBA Jackpot
- 167/567. AQHA L1 Select Showmanship & \*NSBA Jackpot
- 168/169/569. AQHA L2/L3 Select Showmanship & \*NSBA Jackpot
- 170/570. AQHA Am Performance Halter Geldings & \*NSBA Jackpot
- 171/571. AQHA Youth Performance Halter Geldings & \*NSBA Jackpot
- 172/572. AQHA Performance Halter Geldings & \*NSBA Jackpot
- 173/573. AQHA Amateur Performance Halter Mares & \*NSBA Jackpot
- 174/574. AQHA Youth Performance Halter Mares & \*NSBA Jackpot
- 175/575. AQHA Performance Halter Mares & \*NSBA Jackpot
- 176/576. AQHA Am. Performance Halter Stallions & \*NSBA Jackpot
- 177/577. AQHA Performance Halter Stallions & \*NSBA Jackpot
- 178. AQHA Amateur Yearling Geldings
- 179. AQHA Amateur 2-year-old Geldings
- 180. AQHA Amateur 3-year-old Geldings
- 181. AQHA Amateur Aged Geldings
- 182/183. **Grand/Reserve Amateur Geldings**
- 184. AQHA Youth Yearling Geldings
- 185. AQHA Youth 2-year-old Geldings
- 186. AQHA Youth 3-year-old Geldings
- 187. AQHA Youth Aged Geldings
- 188/189. **Grand/Reserve Youth Geldings**
- 190. AQHA Yearling Geldings
- 191. AQHA 2-year-old Geldings
- 192. AQHA 3-year-old Geldings
- 193. AQHA Aged Geldings
- 194/195. **Grand/Reserve Geldings**
- 196. AQHA Amateur Yearling Mares
- 197. AQHA Amateur 2-year-old Mares
- 198. AQHA Amateur 3-year-old Mares
- 199. AQHA Amateur Aged Mares
- 200/201. **Grand/Reserve Amateur Mares**
- 202. AQHA Youth Yearling Mares
- 203. AQHA Youth 2-year-old Mares
- 204. AQHA Youth 3-year-old Mares
- 205. AQHA Youth Aged Mares
- 206/207. **Grand/Reserve Youth Mares**
- 208. AQHA Yearling Mares
- 209. AQHA 2-year-old Mares
- 210. AQHA 3-year-old Mares
- 211. AQHA Aged Mares
- 212/213. **Grand/Reserve Mares**
- 214. AQHA Amateur Yearling Stallions
- 215. AQHA Amateur 2-year-old Stallions
- 216. AQHA Amateur 3-year-old Stallions
- 217. AQHA Amateur Aged Stallions
- 218/219. **Grand/Reserve Amateur Stallions**
- 220. AQHA Yearling Stallions
- 221. AQHA 2-year-old Stallions
- 222. AQHA 3-year-old Stallions
- 223. AQHA Aged Stallions
- 224/225. **Grand/Reserve Stallions**

*All arenas & schedules subject to change.*

### Grand Side - B - 8:00 am

- 226/626. AQHA Green Junior Trail & \*NSBA Jackpot  
227/228/628. AQHA L2/L3 Junior Trail & \*NSBA Jackpot  
229/629. AQHA Novice Amateur Trail & \*NSBA Jackpot  
230/630. AQHA Novice Select Trail & \*NSBA Jackpot  
231/631. AQHA 13 & under Trail & \*NSBA Jackpot  
232/632. AQHA 14-18 Trail & \*NSBA Jackpot

### Sunday, September 8

#### Arena 5 - 8:00 am

1012. \$10,000 NSBA 3-year-old Non-Pro Ranch Riding  
1013. \$10,000 NSBA All Age Non-Pro Ranch Riding  
1014/106. \$2000 NSBA Green Working Western Rail & Non AQHA Green Working Western Rail

#### Following Rail

*If weather permits, the Tree Arena may be used for Ranch Trail. Watch for announcements.*

- 1015/132/133. \$5000 NSBA Senior Ranch Trail & L2/L3 AQHA

#### Hunter 2 - 8:00 am

1016. \$10,000 NSBA Open Hunter Derby  
**Move to Hunter 4**  
1017/149. \$2000 NSBA L1 Hunter Hack & AQHA  
1018/150. \$2000 NSBA Junior Hunter Hack & AQHA  
1019/151. \$2000 NSBA L1 Youth Hunter Hack & AQHA  
1020/152. \$2000 NSBA L1 Amateur Hunter Hack & AQHA  
1021/153. \$2000 NSBA Select Hunter Hack & AQHA  
1022/154. \$2000 NSBA Youth Hunter Hack & AQHA  
1023/155. \$2000 NSBA Amateur Hunter Hack & AQHA  
1024/156. \$2000 NSBA Senior Hunter Hack & AQHA  
233/633. AQHA Am Working Hunter Under Saddle & \*NSBA Jackpot  
234/634. AQHA YA Working Hunter Under Saddle & \*NSBA Jackpot  
235/635. AQHA Open Working Hunter Under Saddle & \*NSBA Jackpot

#### Grand Hotel Side - 8:00 am

- 236/636. AQHA Junior Hunter Under Saddle & \*NSBA Jackpot  
1025. \$10,000 Maturity \$10,000 Limited Horse Open Western Pleasure  
237/637. AQHA L1 13 & under Youth Hunter Under Saddle & \*NSBA Jackpot  
238/638. AQHA L1 14-18 Youth Hunter Under Saddle & \*NSBA Jackpot  
239/639. AQHA L1 Select Hunter Under Saddle & \*NSBA Jackpot  
240/640. AQHA L1 Amateur Hunter Under Saddle & \*NSBA Jackpot  
241/641. AQHA L1 Hunter Under Saddle & \*NSBA Jackpot  
1026. \$10,000 Maturity \$25,000 Limited Horse Open Western Pleasure  
242/642. AQHA Amateur Hunter Under Saddle & \*NSBA Jackpot  
243/643. AQHA Select Hunter Under Saddle & \*NSBA Jackpot  
244/644. AQHA 13 & under Youth Hunter Under Saddle & \*NSBA Jackpot  
1027/7027. \$20,000 4-year-old Open Western Pleasure & \$2500 Super Sires 4-year-old Open Western Pleasure (Breeders Purse)  
245/645. AQHA 14-18 Youth Hunter Under Saddle & \*NSBA Jackpot  
246/646. AQHA Senior Hunter Under Saddle & \*NSBA Jackpot

#### Grand Side B

##### Left Side - 8:00 am

- 1028/1029. \$30,000 NSBA 3-year-old Open Trail & \$3000 Limited  
Rider Bonuses  
247/647. AQHA Senior L2 Trail (Round 1) & \*NSBA Jackpot

##### Right Side - 8:30 am

- 1030/127. \$1000 NSBA L1 Youth 13 & under Trail & AQHA  
1031/128. \$1000 NSBA L1 Youth 14-18 Trail & AQHA  
129/529. Small Fry & \*NSBA Jackpot  
1032/130. \$1000 NSBA L1 Amateur Walk/Jog Trail & AQHA  
1033/131. \$1000 NSBA L1 Youth Walk/Jog Trail & AQHA



**Show Management Services:**  
Kathy Avolt – 765-714-4324  
[www.AnEquineProduction.com](http://www.AnEquineProduction.com)  
[AnEquineProduction@gmail.com](mailto:AnEquineProduction@gmail.com)

*All arenas & schedules subject to change.*

## Monday, September 9

### Jumper 3- 8:00 am

*If weather permits, the Tree Arena may be used for Ranch Trail.*

*Watch for announcements.*

- 1035/101. \$2000 NSBA L1 Ranch Trail & AQHA
- 1036/102. \$5000 NSBA Junior Ranch Trail & AQHA
- 1037/103. \$2000 NSBA L1 Amateur Ranch Trail & AQHA
- 1038/104. \$2000 NSBA L1 Select Ranch Trail & AQHA
- 1039/105. \$2000 NSBA L1 Youth Ranch Trail & AQHA
- 1040/107. \$3000 NSBA Senior Working Western Rail & AQHA
- 1041/108. \$2000 NSBA Amateur Working Western Rail & AQHA
- 1042/109. \$2000 NSBA Select Working Western Rail & AQHA
- 1043/110. \$2000 NSBA Youth Working Western Rail & NSBA
- 1044/111. \$3000 NSBA Junior Working Western Rail & AQHA

### Arena 5 - 10 am

- 1045/112. \$5000 NSBA L1 Ranch Riding & AQHA
- 1046/113. \$10,000 NSBA Junior Ranch Riding & AQHA
- 1047/114. \$2000 NSBA L1 Amateur Ranch Riding & AQHA
- 1048/115. \$2000 NSBA L1 Select Ranch Riding & AQHA
- 1049/116. \$2000 NSBA L1 Youth Ranch Riding & AQHA

### Hunter 3 - 8:00 am

- 1050/117. \$2000 NSBA L1 Working Hunter & AQHA
- 1051/118. \$2000 NSBA Progressive Working Hunter & AQHA
- 1052/119. \$5000 NSBA Junior Working Hunter & AQHA
- 1053/120. \$2000 NSBA L1 Amateur Working Hunter & AQHA
- 1054/121. \$2000 NSBA L1 Youth Working Hunter & AQHA

- 1055/122. \$5000 NSBA Select Working Hunter & AQHA

### Hunter 4 - following Working Hunter

- 248/648. AQHA Amateur Jumping & \*NSBA Jackpot
- 249/649. AQHA Youth Jumping & \*NSBA Jackpot
- 250/650. AQHA Jumping & \*NSBA Jackpot

### Grand Arena - Hotel Side - 8:00 am

- 1056. \$10,000 NSBA Maturity \$5000 Limited Horse Open Western Pleasure
  - 251/651. Small Fry Hunter Under Saddle & \*NSBA Jackpot
  - 252/652. AQHA L1 Youth Walk-Trot Hunter Under Saddle & \*NSBA Jackpot
  - 253/653. AQHA L1 Walk-Trot Amateur Hunter Under Saddle & \*NSBA Jackpot
- 1057. \$5000 NSBA Maturity Hunter Under Saddle - Limited Rider
  - 254/654. Small Fry Hunt Seat Equitation & \*NSBA Jackpot
  - 255/655. AQHA L1 Youth Walk-Trot Hunt Seat Equitation & \*NSBA Jackpot
  - 256/656. AQHA L1 Amateur Walk-Trot Hunt Seat Equitation & \*NSBA Jackpot
- 1058. \$10,000 NSBA 3-year-old Non-Pro Western Pleasure
  - 257/657. AQHA L1 13 & under Youth Hunt Seat Equitation & \*NSBA Jackpot
  - 258/658. AQHA L1 14-18 Youth Hunt Seat Equitation & \*NSBA Jackpot
  - 259/659. AQHA L1 Amateur Hunt Seat Equitation & \*NSBA Jackpot
  - 260/660. AQHA L1 Select Hunt Seat Equitation & \*NSBA Jackpot
  - 261/661. AQHA 13 & under Youth Hunt Seat Equitation & \*NSBA Jackpot
  - 262/662. AQHA 14-18 Youth Hunt Seat Equitation & \*NSBA Jackpot
  - 263/663. AQHA Amateur Hunt Seat Equitation & \*NSBA Jackpot
  - 264/664. AQHA Select Hunt Seat Equitation & \*NSBA Jackpot

### Grand Arena - Side B

#### Left Side - 8:00 am

- 265/266/666. AQHA Amateur Trail - L2/L3 & \*NSBA Jackpot
- 267/268/668. AQHA Select Trail - L2/L3 & \*NSBA Jackpot
- 1060/231. \$2000 NSBA 13 & under Trail & AQHA
- 1061/232. \$2000 NSBA 14-18 Trail & AQHA

#### Right Side - 8:30 am

- 1062. \$10,000 NSBA 1<sup>st</sup> year Green Trail - *must be green as of August 1*
- 1063/1064/226. \$15,000 NSBA Green Junior & \$1000 Limited Green Rider Trail Bonus & AQHA
- 1065/1066/227/228. \$50,000 NSBA Junior Trail & \$5,000 Limited Rider Junior Trail Bonuses & L2/L3 AQHA

## Tuesday, September 10

### Jumper 3 - 8:00 am

- 1067/134. \$2000 NSBA Amateur Ranch Trail & AQHA
- 1068/135. \$2000 NSBA Select Ranch Trail & AQHA
- 1069/136. \$1000 NSBA Youth 13 & under Ranch Trail & AQHA
- 1070/137. \$1000 NSBA 14-18 Ranch Trail & AQHA

### Arena 5 - 9:00 am

- 1071/138. \$2000 NSBA 13 & under Ranch Riding & AQHA
- 1072/139. \$2000 NSBA 14-18 Ranch Riding & AQHA
- 1073/140. \$10,000 NSBA Amateur Ranch Riding & AQHA
- 1074/141. \$10,000 NSBA Select Ranch Riding & AQHA

### Hunter 3 – 8:00 am

- 1075/144. \$2000 NSBA L1 Youth Equitation Over Fences & AQHA
- 1076/145. \$2000 NSBA L1 Am Equitation Over Fences & AQHA
- 1077/146. \$2000 NSBA Select Equitation Over Fences & AQHA
- 1078/147. \$2000 NSBA Youth Equitation Over Fences & AQHA
- 1079/148. \$2000 NSBA Amateur Equitation Over Fences & AQHA

### Hunter 4 – following EOF

- 1080/248. \$1000 NSBA Amateur Jumping & AQHA
- 1081/249. \$1000 NSBA Youth Jumping & AQHA
- 1082/250. \$1000 NSBA Jumping & AQHA

### Hunter 2 – Following Jumping

- 1083. \$10,000 NSBA Non-Pro Hunter Derby

### Grand Arena – Hotel Side – 8:00 am

- 1084. \$20,000 NSBA Maturity Western Pleasure - Non-Pro Rider
- 1085. \$5000 NSBA 4-year-old Limited Rider Open Western Pleasure
- 1086. \$10,000 NSBA 3-year-old Hunter Under Saddle - Limited Rider
- 1087. \$20,000 NSBA 3 & over \$2500 Limited Horse Western Pleasure
- 1088. \$5000 NSBA Color Non-Pro Western Pleasure
- 1089. \$5000 NSBA 3-year-old Limited Rider Open Western Pleasure
- 1090. \$10,000 NSBA \$25,000 Limited Horse Maturity Western Pleasure Non-Pro Rider

### Grand Arena Side B

#### Left Side – 8:00 am

- 1091/1092. \$15,000 NSBA 3-year-old Non-Pro Trail & \$1000 Limited Rider Non-Pro - Bonus
- 1093/247. \$40,000 NSBA Limited Rider Sr Trail & AQHA L2 Sr Trail (Round 2)

#### Right Side – Following 3-year-old Non-Pro

- 1094. \$5000 NSBA Color Open Trail
- 1095/1096/126. \$15,000 NSBA Green Senior Trail & \$1000 Limited Rider Bonus & AQHA

## Wednesday, September 11

### Stadium – 7:30 am

- 270/670. AQHA Junior Pleasure Driving & \*NSBA Jackpot
- 271/671. AQHA Amateur Pleasure Driving & \*NSBA Jackpot
- 272/672. AQHA Senior Pleasure Driving & \*NSBA Jackpot

### Hunter 3 – 30 minutes Following Senior Pleasure Driving

- 1100/123. \$5000 NSBA Senior Working Hunter & AQHA
- 1101/124. \$5000 NSBA Amateur Working Hunter & AQHA
- 1102/125. \$2000 NSBA Youth Working Hunter & AQHA
- 1103/233. \$1000 NSBA Amateur Working Hunter Under Saddle & AQHA
- 1104/234. \$1000 NSBA Youth Working Hunter Under Saddle & AQHA
- 1105/235. \$1000 NSBA Working Hunter Under Saddle & AQHA

### Indoor 1 – 8:00 am

- 1106. \$500 Green Non-Pro Showmanship
- 1107/157. \$1000 NSBA L1 13 & under Youth Showmanship & AQHA
- 1108/158. \$1000 NSBA L1 14-18 Showmanship & AQHA
- 1109/159. \$2000 NSBA 13 & under Showmanship & AQHA
- 1110/160/161. \$2000 NSBA 14-18 Showmanship & L2/L3 AQHA
- 162/562. Small Fry Showmanship & \*NSBA Jackpot
- 1111/163. \$1000 NSBA L1 Amateur Showmanship & AQHA
- 1112/164/165. \$2000 NSBA Amateur Showmanship & L2/L3 AQHA
- 1113/167. \$1000 NSBA L1 Select Showmanship & AQHA
- 1114/168/169. \$2000 NSBA Select Showmanship & L2/L3 AQHA

### Grand – Hotel Side – following SMS

- 1115. \$10,000 NSBA Maturity Western Pleasure - Limited Non-Pro Rider
- 1116. \$5000 NSBA Color Hunter Under Saddle
- 1117. \$10,000 NSBA 3-year-old Select Non-Pro Western Pleasure

### Grand – Hotel Side – not before 6 pm

- 1118/1119. \$20,000 Non-Pro Ranch Riding Challenge

The top 10 from the Amateur, Select & Both Youth NSBA classes will come back for a clean slate finals. \$1000 bonus for the highest placing youth. Pattern will be provided at 5 pm. No schooling the course.

**Enjoy the Reception Experience on the Hotel Patio – Beer & Boards**

### Indoor 3 – 9:00 am - **BLOCKED**

- 275/675. AQHA L1 Western Riding & \*NSBA Jackpot
- 276/676. AQHA Junior Western Riding & \*NSBA Jackpot
- 277/278/678. AQHA L2/L3 Senior Western Riding & \*NSBA Jackpot
- 279/679. AQHA L1 Youth Western Riding & \*NSBA Jackpot
- 280/680. AQHA L1 Amateur Western Riding & \*NSBA Jackpot
- 281/282/682. AQHA L2/L3 Youth Western Riding & \*NSBA Jackpot
- 283/284/684. AQHA L2/L3 Am. Western Riding & \*NSBA Jackpot
- 285/286/686. AQHA L2/L3 Select Western Riding & \*NSBA Jackpot

**Grand Side B (Left) – 8:00 am**

- 1120/1121. \$15,000 NSBA 4 & 5 year old Non-Pro Trail & \$1000 Ltd Rider Bonus  
1122/229. \$2000 NSBA Novice Amateur Trail & AQHA  
1123/230. \$2000 NSBA Novice Select Trail & AQHA

**Grand Side B (Right) – 8:00 am**

- 288/688. AQHA L3 Senior Trail (Round 1) & \*NSBA Jackpot

**Arena 5 – 8:00 am**

- 1124/142/143. \$50,000 NSBA Senior Ranch Riding & AQHA L2/L3

**Thursday, September 12**

**Indoor 3 – 8:00 am**

- 290/690. AQHA L1 Amateur Horsemanship & \*NSBA Jackpot  
291/292/692. AQHA Amateur L2/L3 Horsemanship & \*NSBA Jackpot  
293/693. AQHA L1 Select Horsemanship & \*NSBA Jackpot  
294/295/695. AQHA Select L2/L3 Horsemanship & \*NSBA Jackpot  
296/696. Small Fry Horsemanship & \*NSBA Jackpot  
297/697. AQHA L1 Youth Walk/Jog Horsemanship & \*NSBA Jackpot  
298/698. AQHA L1 Amateur Walk/Jog Horsemanship & \*NSBA Jackpot  
299/699. Small Fry Western Pleasure & \*NSBA Jackpot  
300/700. AQHA L1 Amateur Walk/Jog Western Pleasure & \*NSBA Jackpot  
301/701. AQHA L1 Youth Walk/Jog Western Pleasure & \*NSBA Jackpot  
302/702. AQHA L1 13 & under Youth Horsemanship & \*NSBA Jackpot  
303/703. AQHA L1 14-18 Youth Horsemanship & \*NSBA Jackpot  
304/704. AQHA 13 & under Youth Horsemanship & \*NSBA Jackpot  
305/306/706. AQHA L2/L3 14-18 Youth Horsemanship & \*NSBA Jackpot

**Grand Arena – Hotel Side – 8:00 am**

- 307/707. AQHA Junior Western Pleasure & \*NSBA Jackpot  
**1126. \$10,000 NSBA 3-year-old Hunter Under Saddle – Non-Pro Rider**  
308/708. AQHA L1 Youth 13 & under Western Pleasure & \*NSBA Jackpot  
309/709. AQHA L1 14-18 Youth Western Pleasure & \*NSBA Jackpot  
310/710. AQHA L1 Amateur Western Pleasure & \*NSBA Jackpot  
**1127. \$2000 NSBA Maturity Hunter Under Saddle Ltd Non-Pro Rider**  
311/711. AQHA L1 Select Western Pleasure & \*NSBA Jackpot  
312/712. AQHA L1 Western Pleasure & \*NSBA Jackpot  
313/713. AQHA Amateur Western Pleasure & \*NSBA Jackpot  
314/714. AQHA Select Western Pleasure & \*NSBA Jackpot  
315/715. AQHA 13 & under Youth Western Pleasure & \*NSBA Jackpot  
**1128. \$5,000 NSBA 4-year-old Hunter Under Saddle – Non-Pro Rider**  
316/716. AQHA 14-18 Western Pleasure & \*NSBA Jackpot  
317/717. AQHA Senior Western Pleasure & \*NSBA Jackpot

**Grand – Hotel Side - not before 6 pm**

- 1129/1130. \$35,000 Open Ranch Riding Challenge

Top 15 horses from the NSBA Junior & NSBA Senior Ranch Riding will advance for a clean slate finals. \$1000 bonus to the highest placing Non-Pro Rider. (Non-Pro Rider must have shown the Junior or Senior to advance to the Challenge. No limit to the number of horses an open rider can show.

Pattern will be provided at 5 pm. No schooling of the pattern

**Enjoy the Reception Experience on the Hotel Patio – Beer & Boards**

**Grand Arena – Side B – 8:00 am**

- 1131/288. \$100,000 NSBA Senior Trail Prelims & L3 AQHA Senior Trail (Round 2 – AQHA)

**Friday, September 13**

**Grand Hotel Side – 8:00 am**

- 1132/236. \$2000 NSBA Junior Hunter Under Saddle & AQHA  
**1133. \$10,000 NSBA Limited \$5000 Horse Western Pleasure Maturity – Non-Pro**  
1134/237. NSBA \$1000 L1 13 & under Youth Hunter Under Saddle & AQHA  
1135/238. NSBA \$1000 L1 14-18 Youth Hunter Under Saddle & AQHA  
1136/239. NSBA \$1000 L1 Select Hunter Under Saddle & AQHA

- 1137/240. NSBA \$1000 L1 Amateur Hunter Under Saddle & AQHA  
 1138. \$10,000 NSBA Maturity \$10,000 Horse Western Pleasure – Non-Pro  
 1139/241. NSBA \$2000 L1 Hunter Under Saddle & AQHA  
 1140/242. NSBA \$2000 Amateur Hunter Under Saddle & AQHA  
 1141/243. NSBA \$2000 Select Hunter Under Saddle & AQHA  
 1142/244. NSBA \$1000 13 & under Youth Hunter Under Saddle & AQHA  
 1143. \$5,000 NSBA 3-year-old Non-Pro Western Pleasure – Limited Non-Pro  
 1144/245. NSBA \$1000 14-18 Youth Hunter Under Saddle & AQHA  
 1145/246. NSBA \$5000 Senior Hunter Under Saddle & AQHA

### Grand Side B – 8:00 am

1146. \$5000 NSBA Color Non-Pro Trail  
 1147/1148/265/266. \$10,000 NSBA Amateur & \$2,500 Limited Amateur Trail Bonuses & AQHA L2/L3  
 1149/1150/267/268. \$10,000 NSBA Select & \$2,500 Limited Rider Select Trail Bonuses & L2/L3 Select Trail

### Indoor 3 – 9:00 am

- 251/651. Small Fry Hunter Under Saddle & \*NSBA Jackpot  
 1151/252. NSBA \$1000 L1 Youth Walk-Trot Hunter Under Saddle & AQHA  
 1152/253. NSBA \$1000 L1 Walk-Trot Amateur Hunter Under Saddle & AQHA  
 1153. \$500 Green Non-Pro Equitation  
 254/654. Small Fry Hunt Seat Equitation & \*NSBA Jackpot  
 1154/255. NSBA \$1000 L1 Youth Walk-Trot Hunt Seat Equitation & AQHA  
 1155/256. NSBA \$1000 L1 Amateur Walk-Trot Hunt Seat Equitation & AQHA  
 1156/257. NSBA \$1000 L1 13 & under Youth Hunt Seat Equitation & AQHA  
 1157/258. NSBA \$1000 L1 14-18 Youth Hunt Seat Equitation & AQHA  
 1158/259. NSBA \$1000 L1 Amateur Hunt Seat Equitation & AQHA  
 1159/260. NSBA \$1000 L1 Select Hunt Seat Equitation & AQHA  
 1160/261. NSBA \$2000 13 & under Youth Hunt Seat Equitation & AQHA  
 1161/262. NSBA \$2000 14-18 Youth Hunt Seat Equitation & AQHA  
 1162/263. NSBA \$2000 Amateur Hunt Seat Equitation & AQHA  
 1163/264. NSBA \$2000 Select Hunt Seat Equitation & AQHA

## Saturday, September 14

### Indoor 3 – Following Driving

1165. \$500 Green Non-Pro Horsemanship  
 296/696. Small Fry Horsemanship & \*NSBA Jackpot  
 1166/297. \$1000 NSBA L1 Youth Walk/Jog Horsemanship & AQHA  
 1167/298. \$1000 NSBA L1 Amateur Walk/Jog Horsemanship & AQHA  
 1168/302. \$1000 NSBA L1 13 & under Youth Horsemanship & AQHA  
 1169/303. \$1000 NSBA L1 14-18 Youth Horsemanship & AQHA  
 1170/304. \$2000 NSBA 13 & under Youth Horsemanship & AQHA  
 1171/305/306. \$2000 NSBA 14-18 Youth Horsemanship & L2/L3 AQHA  
 1172/290. \$1000 NSBA L1 Amateur Horsemanship & AQHA  
 1173/291/292. \$2000 NSBA Amateur Horsemanship & L2/L3 AQHA  
 1174/293. \$1000 NSBA L1 Select Horsemanship & AQHA  
 1175/294/295. \$2000 NSBA Select Horsemanship & L2/L3 AQHA

### Stadium – 8:00 am

- 1176/270. \$2000 NSBA Junior Pleasure Driving & AQHA  
 1177/271. \$2000 NSBA Amateur Pleasure Driving & AQHA  
 1178/272. \$2000 NSBA Senior Pleasure Driving & AQHA

### Grand – Side B – 8:00 am

- 1179/275. \$2000 NSBA L1 Western Riding & AQHA  
 1180/276. \$2000 NSBA Junior Western Riding & AQHA  
 1181/277/278. \$2000 NSBA Senior Western Riding & L2/L3 AQHA

### Grand – Hotel Side – not before 6 pm

1131. \$100,000 NSBA Senior Trail Finals – **Winner receives \$40,000**

Clean Slate Finals – will receive the pattern at 5 pm. No schooling. No warm up poles. All horses must be in the arena by 6 pm  
 No limit to the number of horses a rider can show.

**VIP Dinner Experience – Hotel Patio – Watch for additional details – 3-course dinner, Beer & Wine!**



## Sunday, September 15

### Grand Side A – 8:00 am

#### Lead Line – Free – enter in the office.

- 1182/307. NSBA \$2000 Junior Western Pleasure & AQHA  
1183. \$10,000 NSBA Maturity Hunter Under Saddle Non-Pro Rider  
299/699. Small Fry Western Pleasure & \*NSBA Jackpot  
1184/300. NSBA \$1000 L1 Amateur Walk/Jog Western Pleasure & AQHA  
1185/301. NSBA \$1000 L1 Youth Walk/Jog Western Pleasure & AQHA  
1186. \$5000 NSBA Color Non-Pro Hunter Under Saddle  
**1202. Pony Pleasure – FREE – ponies 56" & under**  
1187/308. NSBA \$1000 L1 Youth 13 & under Western Pleasure & AQHA  
1188/309. NSBA \$1000 L1 14-18 Youth Western Pleasure & AQHA  
1189/310. NSBA \$1000 L1 Amateur Western Pleasure & AQHA  
1190. \$10,000 NSBA 3-year-old Hunter Under Saddle – Limited Non-Pro  
1191/311. NSBA \$1000 L1 Select Western Pleasure & AQHA  
1192/312. NSBA \$5000 L1 Western Pleasure & AQHA  
1193/313. NSBA \$2000 Amateur Western Pleasure & AQHA  
1194/314. NSBA \$2000 Select Western Pleasure & AQHA  
1195/315. NSBA \$1000 13 & under Youth Western Pleasure & AQHA  
1196/316. NSBA \$1000 14-18 Western Pleasure & AQHA  
1197/317. NSBA \$2000 Senior Western Pleasure & AQHA

### Indoor 3 – 9:00 am

- 1198/279. \$1000 NSBA L1 Youth Western Riding & AQHA  
1199/280. \$1000 NSBA L1 Amateur Western Riding & AQHA  
1200/281/282. \$2000 NSBA Youth Western Riding & L2/L3 AQHA  
1201/283/284. \$2000 NSBA Amateur Western Riding & L2/L3 AQHA  
1202/285/286. \$2000 NSBA Select Western Riding & L2/L3 AQHA

### 2024 The Championship – NSBA Money Classes, Entry Fees & Date held

Western Pleasure Classes	Purse	Entry Fee	Date
3 & over \$2500 Limited Horse Western Pleasure (1087)	\$20,000	\$450	9/10
3-year-old Open Western Pleasure (1003)	\$15,000	\$400	9/06
3-year-old Open Western Pleasure, Limited Rider (1089)	\$5000	\$250	9/10
3-year-old Western Pleasure, Non-Pro (1058)	\$10,000	\$350	9/09
3-year-old Western Pleasure, Non-Pro <b>Select</b> (1117)	\$10,000	\$350	9/11
3-year-old Western Pleasure, Non-Pro Ltd Rider (1143)	\$5000	\$250	9/13
4-year-old Open Western Pleasure (1027)	\$20,000	\$450	9/08
<b>Super Sires</b> 4-year-old Open Western Pleasure, Breeders Purse (7027)	\$2500	\$250	9/08
4-year-old Open Western Pleasure, Limited Rider (1085)	\$5000	\$250	9/10
Maturity Open Western Pleasure (1001)	\$15,000	\$400	9/06
Maturity Open Western Pleasure Maturity, Limited Rider (1008)	\$10,000	\$350	9/06
Maturity Western Pleasure, Non-Pro (1084)	\$20,000	\$450	9/10
Maturity Western Pleasure, Non-Pro Limited Rider (1115)	\$10,000	\$350	9/11
Maturity \$5000 Limited Horse Western Pleasure (1056)	\$10,000	\$350	9/09
Maturity \$5000 Limited Horse Western Pleasure, Non-Pro (1133)	\$10,000	\$350	9/13
Maturity \$10,000 Limited Horse Western Pleasure (1025)	\$10,000	\$350	9/08
Maturity \$10,000 Limited Horse Western Pleasure, Non Pro (1138)	\$10,000	\$350	9/13
Maturity \$25,000 Limited Horse Western Pleasure (1026)	\$10,000	\$350	9/08
Maturity \$25,000 Limited Horse Western Pleasure, Non Pro (1090)	\$10,000	\$350	9/10
All Age Open Color Western Pleasure (1005)	\$5000	\$250	9/06
All Age Color Western Pleasure, Non-Pro (1088)	\$5000	\$250	9/10
Novice Horse Western Pleasure (1007)	\$2000	\$175	9/06
Junior Western Pleasure (1182)	\$2000	\$175	9/15
L1 Amateur Walk/Jog Western Pleasure (1184)	\$1000	\$100	9/15
L1 Youth Walk/Jog Western Pleasure (1185)	\$1000	\$100	9/15
L1 13 & Under Western Pleasure (1187)	\$1000	\$100	9/15
L1 14-18 Western Pleasure (1188)	\$1000	\$100	9/15
L1 Amateur Western Pleasure (1189)	\$1000	\$100	9/15
L1 Select Western Pleasure (1190)	\$1000	\$100	9/15
L1/Green Western Pleasure (1192)	\$5000	\$250	9/15
Amateur Western Pleasure (1193)	\$2000	\$175	9/15

Select Western Pleasure (1194)	\$2000	\$175		9/15
13 & under Western Pleasure (1195)	\$1000	\$100		9/15
14-18 Western Pleasure (1196)	\$1000	\$100		9/15
Senior Western Pleasure (1197)	\$2000	\$175		9/15
<b>Hunter Under Saddle Classes</b>				
3-year-old Open Hunter Saddle (1006)	\$15,000	\$400		9/06
3-year-old Open Hunter Under Saddle, Limited Rider (1086)	\$10,000	\$350		9/10
3-year-old Hunter Under Saddle, Non-Pro (1126)	\$10,000	\$350		9/12
3-year-old Hunter Under Saddle, Limited Non-Pro (1190)	\$10,000	\$350		9/15
4-year-old Open Hunter Under Saddle (1004)	\$10,000	\$350		9/06
<b>Super Sires</b> 4-year-old Open Hunter Under Saddle (7004)	\$2500	\$250		9/06
4-year-old Hunter Under Saddle, Non-Pro (1128)	\$5000	\$250		9/11
Maturity Open Hunter Saddle (1002)	\$15,000	\$400		9/06
Maturity Open Hunter Under Saddle, Limited Rider (1057)	\$5000	\$250		9/09
Maturity Hunter Under Saddle, Non-Pro (1183)	\$10,000	\$350		9/15
Maturity Hunter Under Saddle, Non-Pro Limited Rider (1127)	\$2000	\$175		9/11
Color Hunter Under Saddle, Open (1116)	\$5000	\$250		9/11
Color Hunter Under Saddle, Non Pro (1186)		\$5000	\$250	9/15
Junior Hunter Under Saddle (1132)	\$2000	\$175		9/13
L1 13 & under Hunter Under Saddle (1134)	\$1000	\$100		9/13
L1 14-18 Hunter Under Saddle (1135)	\$1000	\$100		9/13
L1 Select Hunter Under Saddle (1136)	\$1000	\$100		9/13
L1 Amateur Hunter Under Saddle (1137)	\$1000	\$100		9/13
L1/Green Hunter Under Saddle (1139)	\$2000	\$175		9/13
Amateur Hunter Under Saddle (1140)	\$2000	\$175		9/13
Select Hunter Under Saddle (1141)	\$2000	\$175		9/13
13 & under Hunter Under Saddle (1142)	\$1000	\$100		9/13
14-18 Hunter Under Saddle (1144)	\$1000	\$100		9/13
Senior Hunter Under Saddle (1145)	\$5000	\$250		9/13
L1 Youth Walk/Trot Hunter Under Saddle (1151)	\$1000	\$100		9/13
L1 Amateur Walk/Trot Hunter Under Saddle (1152)	\$1000	\$100		9/13
<b>Ranch Trail</b>				
L1 Ranch Trail (1035)	\$2000	\$175		9/09
Junior Ranch Trail (1036)	\$5000	\$250		9/09
Senior Ranch Trail (1015)	\$5000	\$250		9/09
L1 Amateur Ranch Trail (1037)	\$2000	\$175		9/09
L1 Select Ranch Trail (1038)	\$2000	\$175		9/09
L1 Youth Ranch Trail (1039)	\$2000	\$175		9/09
Amateur Ranch Trail (1067)	\$2000	\$175		9/10
Select Ranch Trail (1068)	\$2000	\$175		9/10
13 & under Ranch Trail (1069)	\$1000	\$100		9/10
14-18 Ranch Trail (1070)	\$1000	\$100		9/10
<b>Ranch Riding</b>				
3-year-old Ranch Riding, Open (1000)	\$35,000	\$600		9/06
3-year-old Ranch Riding, Non Pro (1012)	\$10,000	\$350		9/08
All Age Non-Pro Ranch Riding (1013)	\$10,000	\$350		9/08
L1 Ranch Riding (1045)	\$5000	\$250		9/09
Junior Ranch Riding (1046)	\$10,000	\$350		9/09
Senior Ranch Riding (1124)	\$50,000	\$750		9/11
L1 Amateur Ranch Riding (1047)	\$2000	\$175		9/09
L1 Select Ranch Riding (1048)	\$2000	\$175		9/09
Amateur Ranch Riding (1073)	\$10,000	\$350		9/10
Select Ranch Riding (1074)	\$10,000	\$350		9/10
L1 Youth Ranch Riding (1049)	\$2000	\$175		9/09
13 & under Ranch Riding (1071)	\$2000	\$175		9/10
14-18 Ranch Riding (1072)	\$2000	\$175		9/10
Non-Pro Ranch Riding Challenge (1118)	\$20,000	Free		9/11
Non-Pro Ranch Riding Challenge, <b>Youth Bonus</b> (1119)				
Open Ranch Riding Challenge (1129)	\$35,000	Free		9/12
Open Ranch Riding Challenge, Non Pro Rider (1130)				

<b>Working Western Rail</b>			
L1/Green Working Western Rail (1014)	\$2000	\$175	9/08
Junior Working Western Rail (1044)	\$3000	\$200	9/09
Senior Working Western Rail (1040)	\$3000	\$200	9/09
Amateur Working Western Rail (1041)	\$2000	\$175	9/09
Select Working Western Rail (1042)	\$2000	\$175	9/09
Youth Working Western Rail (1043)	\$2000	\$175	9/09
<b>Working Hunter</b>			
Open Hunter Derby (1016)	\$10,000	\$350	9/08
L1 Working Hunter (1050)	\$2000	\$175	9/09
Progressive Working Hunter (1051)	\$2000	\$175	9/09
Junior Working Hunter (1052)	\$5000	\$250	9/09
L1 Amateur Working Hunter (1053)	\$2000	\$175	9/09
L1 Youth Working Hunter (1054)	\$2000	\$175	9/09
Select Working Hunter (1055)	\$5000	\$250	9/09
Non-Pro Hunter Derby (1083)	\$10,000	\$350	9/10
Senior Working Hunter (1100)	\$5000	\$250	9/11
Amateur Working Hunter (1101)	\$5000	\$250	9/11
Youth Working Hunter (1102)	\$2000	\$175	9/11
<b>Hunter Hack</b>			
L1/Green Hunter Hack (1017)	\$2000	\$175	9/08
Junior Hunter Hack (1018)	\$2000	\$175	9/08
L1/Novice Youth Hunter Hack (1019)	\$2000	\$175	9/08
L1/Novice Amateur Hunter Hack (1020)	\$2000	\$175	9/08
Select Hunter Hack (1021)	\$2000	\$175	9/08
Youth Hunter Hack (1022)	\$2000	\$175	9/08
Amateur Hunter Hack (1023)	\$2000	\$175	9/08
Senior Hunter Hack (1024)	\$2000	\$175	9/08
<b>Equitation Over Fences</b>			
L1 Youth Equitation Over Fences (1075)	\$2000	\$175	9/10
L1 Amateur Equitation Over Fences (1076)	\$2000	\$175	9/10
Select Equitation Over Fences (1077)	\$2000	\$175	9/10
Youth Equitation Over Fences (1078)	\$2000	\$175	9/10
Amateur Equitation Over Fences (1079)	\$2000	\$175	9/10
<b>Jumping</b>			
Amateur Jumping (1080)	\$1000	\$100	9/10
Youth Jumping (1081)	\$1000	\$100	9/10
Jumping (1082)	\$1000	\$100	9/10
<b>Working Hunter Under Saddle</b>			
Amateur Working Hunter Under Saddle (1103)	\$1000	\$100	9/11
Youth Working Hunter Under Saddle (1104)	\$1000	\$100	9/11
Working Hunter Under Saddle (1105)	\$1000	\$100	9/11
<b>Western Riding</b>			
L1/Green Western Riding (1179)	\$2000	\$175	9/14
Junior Western Riding (1180)	\$2000	\$175	9/14
Senior Western Riding (1181)	\$2000	\$175	9/14
L1 Youth Western Riding (1198)	\$1000	\$100	9/15
L1 Amateur Western Riding (1199)	\$1000	\$100	9/15
Youth Western Riding (1200)	\$2000	\$175	9/15
Amateur Western Riding (1201)	\$2000	\$175	9/15
Select Western Riding (1202)	\$2000	\$175	9/15
<b>Trail</b>			
3 year-old Trail (1028)	\$30,000	\$600	9/08
3-year-old Trail, Limited Rider (1029) <b>Bonuses</b>	\$3000		
3 year-old Trail, Non-Pro (1091)	\$15,000	\$450	9/10
3-year-old Trail, Limited Rider <b>Bonus</b> (1092)	\$1000		
4 & 5-year-old Trail, Open (1009)	\$5000	\$250	9/06
4 & 5 year old Trail, Limited Rider <b>Bonus</b> (1010)	\$1000		9/06

4 & 5-year-old Trail, Non-Pro (1120)	\$15,000	\$400	9/11
4 & 5 year old Trail, Non-Pro Limited Rider <b>Bonus</b> (1121)	\$1000		9/11
L1 Youth 13 & under Trail (1030)	\$1000	\$100	9/08
L1 Youth 14-18 Trail (1031)	\$1000	\$100	9/08
L1 Amateur Walk/Jog Trail (1032)	\$1000	\$100	9/08
L1 Youth Walk/Jog Trail (1033)	\$1000	\$100	9/08
13 & under Trail (1060)	\$2000	\$175	9/09
14-18 Trail (1061)	\$2000	\$175	9/09
1 <sup>st</sup> Year Green Trail (1062)	\$10,000	\$350	9/09
Green Junior Trail (1063)	\$15,000	\$400	9/09
Green Junior Trail, Limited Rider <b>Bonus</b> (1064)	\$1000		9/09
Junior Trail (1065)	\$50,000	\$750	9/09
Junior Trail, Limited Rider <b>Bonuses</b> (1066)	\$5,500		9/09
Color Trail, Open (1094)	\$5000	\$250	9/10
Color Trail, Non Pro (1146)	\$5000	\$250	9/13
Green Senior Trail (1095)	\$15,000	\$400	9/10
Green Senior Trail, Limited Rider <b>Bonus</b> (1096)	\$1000		9/10
L1 Amateur Trail (1122)	\$2000	\$175	9/11
L1 Select Trail (1123)	\$2000	\$175	9/11
Senior Trail, Limited Rider (1093)	\$40,000	\$650	9/10
Senior Trail (1131) Pre-lims (1131)	\$100,000	\$1000	9/12
Senior Trail (1131) Finals			9/14
Amateur Trail (1147)	\$10,000	\$350	9/13
Amateur Trail, Limited Rider <b>Bonuses</b> (1148)	\$2,500		9/13
Select Trail (1149)	\$10,000	\$350	9/13
Select Trail, Limited Rider <b>Bonuses</b> (1150)	\$2,500		9/13
<b>Showmanship</b>			
L1 13 & under Showmanship (1107)	\$1000	\$100	9/11
L1 14-18 Showmanship (1108)	\$1000	\$100	9/11
13 & under Showmanship (1109)	\$2000	\$175	9/11
14-18 Showmanship (1110)	\$2000	\$175	9/11
L1 Amateur Showmanship (1111)	\$1000	\$100	9/11
Amateur Showmanship (1112)	\$2000	\$175	9/11
L1 Select Showmanship (1113)	\$1000	\$100	9/11
Select Showmanship (1114)	\$2000	\$175	9/11
<b>Hunt Seat Equitation</b>			
L1 Youth Walk/Trot Hunt Seat Equitation (1154)	\$1000	\$100	9/13
L1 Amateur Walk/Trot Hunt Seat Equitation (1155)	\$1000	\$100	9/13
L1 13 & under Hunt Seat Equitation (1156)	\$1000	\$100	9/13
L1 14-18 Hunt Seat Equitation (1157)	\$1000	\$100	9/13
13 & under Hunt Seat Equitation (1160)	\$2000	\$175	9/13
14-18 Hunt Seat Equitation (1161)	\$2000	\$175	9/13
L1 Amateur Hunt Seat Equitation (1158)	\$1000	\$100	9/13
Amateur Hunt Seat Equitation (1162)	\$2000	\$175	9/13
L1 Select Hunt Seat Equitation (1159)	\$1000	\$100	9/13
Select Hunt Seat Equitation (1163)	\$2000	\$175	9/13
<b>Horsemanship</b>			
L1 Youth Walk/Trot Horsemanship (1166)	\$1000	\$100	9/14
L1 Amateur Walk/Trot Horsemanship (1167)	\$1000	\$100	9/14
L1 13 & under Horsemanship (1168)	\$1000	\$100	9/14
L1 14-18 Horsemanship (1169)	\$1000	\$100	9/14
13 & under Horsemanship (1170)	\$2000	\$175	9/14
14-18 Horsemanship (1171)	\$2000	\$175	9/14
L1 Amateur Horsemanship (1172)	\$1000	\$100	9/14
Amateur Horsemanship (1173)	\$2000	\$175	9/14
L1 Select Horsemanship (1174)	\$1000	\$100	9/14
Select Horsemanship (1175)	\$2000	\$175	9/14

## Pleasure Driving

Junior Pleasure Driving (1176)	\$2000	\$175	9/14
Amateur Pleasure Driving (1177)	\$2000	\$175	9/14
Senior Pleasure Driving (1178)	\$2000	\$175	9/14

## Green Non-Pro Classes

Green Non-Pro Showmanship (1106)	\$500	\$50	9/11
Green Non-Pro Horsemanship (1165)	\$500	\$50	9/14
Green Non-Pro Hunt Seat Equitation (1153)	\$500	\$50	9/13

# General Show Information

## Registration

All AQHA classes will be 2 judges (points) per round, for a total of 4 sets of points. And one (1) AQHA World Show qualifying event. **There are no late fees for the AQHA classes.** These classes can be entered prior to the show if desired, but no late fees apply to the AQHA classes.

All horses showing NSBA must be registered with NSBA. These are available for purchase at the show.

**SHOW OFFICE – will be located in Indoor Arena 1**

## Membership

For AQHA & NSBA, current owner **AND** exhibitor memberships will be required. Membership forms will be available at the show. It is the sole responsibility of the owner/exhibitor to be current members. If a registered owner consists of two or more people, or a company or partnership name, then it is required that a membership be recorded in the exact name of the registration papers. If an exhibitor is one of these registered owners, the exhibitor must hold a separate and individual membership as well.

## CLASS EXAMPLES:

AQHA L1 Ranch Trail & \*NSBA Jackpot

- There are two classes. The AQHA L1 Ranch Trail & Dual/Approved NSBA with Jackpot. Only AQHA horses are allowed in the Dual/Approved portion.

\$2000 NSBA L1 Ranch Trail & AQHA

- There are two classes. The NSBA Money class open for all NSBA licensed horses and the AQHA option.

## Entries

- To Enter go to: [www.AnEquineProduction.com](http://www.AnEquineProduction.com)
- Entries & Stalls will be accepted on-line between August 1 – August 23, 2024.
- **Entries due on or before August 23, 2024. AQHA class entries can be entered AT THE SHOW for no late fees.**
- Any added money class entered after **August 23** & prior to 5 pm EST the night before the class will pay double the entry fee. And entry after 5 pm the night before & up to the class entering the arena will pay an **additional** \$500 for classes with less than \$2000 added and \$750 is more than \$2000 added. None of the late fees will be added to the purses.
- AQHA & Dual/Approved NSBA classes will be able to be entered on the **HorseShowTracker.com** closer to the show OR via paper in the show office.
- Payment must be received with entry. Credit cards will be charged a 4% convenience fee. **Stalls and pre-entries will be accepted with a credit card only.** Entries made **AT** the show can be made with cash, checks or credit cards. **An OPEN form of payment will be required to secure obtain ANY back number.** regardless if making any additional entries. At the show, checks will be accepted and payable to Arena Horse Shows of Ocala LLC. No back number will be released without health papers as well.
- A W9/W8 will be required on every back number showing. Regardless if you attended the April shows.
- **Scratches – there will be NO penalty for scratches on the AQHA classes.** Enter everything and scratch the AQHA classes as needed. Please be aware this does NOT apply to the NSBA classes.
- **Novice & Walk/Jog Classes** – You must be Novice/L1 eligible in these classes to show based on NSBA, AQHA, APHA, APHC, PHBA, IBHA and ABHA.
- **Small Fry** – 9 & under as of January 1, 2024 & these classes are FREE. These classes are ALL BREED. Can cross enter into the AQHA Youth Walk/Trot classes by paying an additional entry fee. You cannot LOPE/CANTER at this show.
- **Youth Walk/Jog** – 18 & under as of January 1, 2024.
- **NOVICE/WALK/JOG/GREEN** eligibility – if you are found to be ineligible, you will be responsible to immediately return all prizes & awards.
- **PONY PLEASURE** – can be either Western or English tack/attire. Horses 56" and under. Free entry fee, prizes and watch for added money. Stall & Health requirements will apply.

## General Fees

- Office Charge – \$35/horse – includes night watch fee.
- Hunter & Trail Schooling Fee – \$35 per specialty per horse
- AQHA Classes – \$15/class/judge – 2-judges each round. **You can enter all AQHA classes at the show with no late fees.**
- AQHA Flat Rate – \$300/horse – Includes all AQHA classes. No other fees included.
- AQHA Show Administrative Fee – \$10/horse/show – 4 shows.
- NSBA Dual/Approved Classes – \$25.00/class – single judged. **Twenty-two (\$22) of each entry is added into the jackpot.** Paid on NSBA scale. See example below in payouts. **You can enter these at the show with no late fees prior to 5 pm the night before the class.** Round One (1) of the AQHA classes will feature this jackpot option. These Dual/Approved classes are for AQHA only. The second round does not feature a Dual/Approved option (except Small Fry) but the purse option at higher entry fees. The purse option is open for ANY horse licensed with NSBA. Not just AQHA.
- Green Non-Pro Classes – **Less than 10 points in THAT class as of January 1, 2024.** \$500 Jackpot in each class. Paid 40%, 30%, 20%, 10% in each. \$50 entry fee per class. Not part of the Flat Rate. Green Non-Pro classes are ALL BREED. These classes are not NSBA Approved. Will ride the posted L1/Novice Patterns.

## Awards –

- Circuits awards offered in all AQHA classes. Must show to all applicable judges.

- AQHA Champion & Reserve Champion High Point Awards - Jr Open, Sr Open, L1/Green Open, L1 Amateur, Amateur, L1 Select, Select, L1 Youth 13 & under, L1 14-18, 13 & under & 14-18 Youth. Must show in your respective halter class to qualify. When L2 offered, those classes will count within the division. Ranch & Fence classes will not count towards these High Points.
- AQHA Ranch High Points - Jr Open, Sr Open, L1 Amateur, L1 Select, L1 Youth, Amateur, Select, 13 & under & 14-18 Youth - must show in the Working Western Rail. The Youth Working Western Rail will count towards both youth divisions' high points. The L1 Youth & Amateur high points will recognize the Rail from the Youth, Amateur or Select divisions. Example - Amateur Working Western Rail will count towards the L1 Amateur Division.
- Walk/Jog High Points - Small Fry, L1 Youth and L1 Amateur Walk/Jog - no halter will count in these divisions.
- AQHA Fence High Points - Open, Amateur, Select, Youth, L1 Amateur & L1 Youth - Fence & Working Hunter Under Saddle classes only will count. Amateur Working Hunter Under Saddle will count in the Select fence division high point. The L1 Youth & L1 Amateur Fence high points will recognize the WHUS from the Youth or Amateur. No other classes will count towards these high points.

#### Refunds - Refunds will not be given for any reason

#### Substitutions

- If a veterinarian statement is received by show management stating that a horse is no longer able to show, the owner will be allowed to substitute another horse in the same classes originally entered. The substituted horse must be owned by the same person who made the original entry.

#### Rules and Regulations

- Classes will be judged in accordance with AQHA & NSBA rules as written in each association's official rulebook. This includes all class and equipment rules.
- All horses are subject to drug and/or tail testing. Any failed test will result in an automatic disqualification from the class. Any awards, titles and prize money must be returned immediately.
- No person shall treat any horse in a cruel or inhumane manner, including, but not limited to, the prohibited conduct specified in the AQHA and NSBA Handbook. Cruelty to horses included in this prohibition, as it indicates a general course of dealing with horses that is unacceptable.
- Every horse shall always be treated humanely and with dignity, respect, and compassion. Abuse is defined as an action, or failure to act, which a reasonable, prudent person, informed and experienced in the customs, accepted training techniques and exhibition procedures, or veterinary standards would determine to be cruel, abusive, inhumane, or detrimental to the horses' health.

#### Health Papers

Please bring the following health documents to the Show Office (Indoor Arena 1 lobby) or email [AEPHealthPapers@gmail.com](mailto:AEPHealthPapers@gmail.com) the following health papers, upon arrival. In the email, please include the horse's registered name and trainer/stalling agent's name. Please do not put photos in the body of the email. All documents should be added as attachments. *Please note, the registered name must be used on all health documents.*

- A 30-day statement of health, certificate of veterinary inspection or a health certificate, is required for all horses arriving from in-state or outside the state of Florida. The statement of health must be dated within **30** days of check in, affirming that the horses entering the facility have not had an elevated temperature, been to a facility where there has been a positive or suspected positive case of EHV, been in a close proximity to an ill horse and receive routine vet care and vaccinations. The Statement of Health must be signed by a licensed veterinarian and on the vet's letterhead.
- Negative Coggins dated within one year.
- Trainer/Owner Health Declaration (New for 2024) - Signed by an owner/trainer confirming that the horse has not experienced a fever exceeding 101.5 degrees or any disease in the 72 hours leading up to its arrival. Additionally, the horse must not have been exposed to or treated for an unexplained fever in the past 28 days and should have tested negative for any disease at least 30 days prior to arrival. If the horse has tested positive within the last six months for any infectious diseases, this information should also be disclosed. See form.
- Vaccine records of Flu/Rhino within the span of six months.
- Any non-showing horse, including ride-around horses and/or ponies, must also provide the health papers above.

#### Final Decision- Decisions of the judges will be final

#### Disputes

- Any dispute as to the operation of classes, matters of protocol, procedures in drug testing, show management issues and all other issues shall be decided by the show manager in consultation with show producers. The show manager's decision shall be final and considered acceptable to all exhibitors.

#### Conflicts

- Any conflicts between arenas will be handled as long as arena managers are made aware.

#### Scoring

- A minimum of three (3) judges in each NSBA class will be used. In classes with 3 judges, all placings/scores will be kept. All AQHA classes will feature 2 judges per round. Be aware that the AQHA judges may differ from the NSBA judges.
- In classes with purses of \$2500 or more, four (4) judges will be used with a low dropped.
- The Hunter Derbies will feature two (2) judges.

#### Payback

- Payback will follow the payback schedule as listed below.
- The number of places paid is based on the number of fully paid entries and not the number of horses shown.
- Must have at least 3 horses in the class for the added money. If the class does not meet the 3 entries required, entry fees will be refunded.
- NSBA Dual/Approved Jackpots - paid off those entered in the Dual/Approved classes only as marked by 'NSBA \*Jackpot.' Each class is \$25/each. Twenty-two (\$22) of each entry will be jackotted. Paid on NSBA scale. An example - 10 entries x \$22 = \$220. Paid - 1 - \$74.80, 2 - \$59.40, 3 - \$44, 4 - \$22, 5 - \$19.80. These Dual/Approved classes are for AQHA registered horses only. Offered during one round only of the AQHA concurrent classes. You may enter the NSBA Dual/Approved classes with NO LATE fee at the horse show up till 5 pm the night before. If composite placings involve a tie, monies will be split.

\$1000 purse - \$100 EF		\$2000 purse - \$175 EF		\$3000 purse - \$200 EF		\$5000 purse - \$250		\$10,000 purse - \$350 EF	
1	\$375.00	1	\$650.00	1	\$775.00	1	\$1,250.00	1	\$3,700.00
2	\$250.00	2	\$425.00	2	\$625.00	2	\$1,000.00	2	\$2,000.00
3	\$150.00	3	\$300.00	3	\$500.00	3	\$775.00	3	\$1,500.00
4	\$100.00	4	\$225.00	4	\$400.00	4	\$625.00	4	\$1,000.00
5	\$75.00	5	\$175.00	5	\$300.00	5	\$500.00	5	\$750.00
6	\$50.00	6	\$125.00	6	\$200.00	6	\$400.00	6	\$500.00
		7	\$100.00	7	\$125.00	7	\$250.00	7	\$350.00
				8	\$75.00	8	\$200.00	8	\$200.00

\$15,000 purse - \$400 EF		\$20,000 purse - \$450 EF		\$25,000 purse - \$500 EF		\$30,000 purse - \$550 EF		\$35,000 purse - \$600 EF	
1	\$5,000.00	1	\$6,000.00	1	\$7,000.00	1	\$8,000.00	1	\$9,000.00
2	\$3,000.00	2	\$4,000.00	2	\$5,000.00	2	\$7,000.00	2	\$8,000.00
3	\$2,200.00	3	\$3,500.00	3	\$4,000.00	3	\$5,000.00	3	\$7,000.00
4	\$1,700.00	4	\$2,500.00	4	\$3,000.00	4	\$3,500.00	4	\$4,000.00
5	\$1,200.00	5	\$1,500.00	5	\$2,500.00	5	\$2,750.00	5	\$3,000.00
6	\$1,000.00	6	\$1,250.00	6	\$1,750.00	6	\$1,750.00	6	\$2,000.00
7	\$600.00	7	\$750.00	7	\$1,000.00	7	\$1,250.00	7	\$1,250.00
8	\$300.00	8	\$500.00	8	\$750.00	8	\$750.00	8	\$750.00
\$40,000 purse - \$650 EF		\$50,000 purse - \$750 EF		\$100,000 purse - \$1000 EF					
1	\$10,000.00	1	\$15,000.00	1	\$40,000.00				
2	\$8,500.00	2	\$10,000.00	2	\$20,000.00				
3	\$7,500.00	3	\$8,500.00	3	\$12,500.00				
4	\$5,000.00	4	\$7,000.00	4	\$9,000.00				
5	\$3,750.00	5	\$4,000.00	5	\$7,500.00				
6	\$2,750.00	6	\$2,750.00	6	\$4,250.00				
7	\$1,750.00	7	\$1,750.00	7	\$2,750.00				
8	\$750.00	8	\$1,000.00	8	\$1,750.00				
				9	\$1,250.00				
				10	\$1000.00				

**\$40,000 Limited Rider Senior Trail & \$100,000 Senior Trail** - A horse may be entered into both the NSBA (only) Limited Rider Senior Trail and NSBA Senior Trail by paying two entry fees. The \$100,000 NSBA Senior Trail finals - the same rider must show the qualifying round. The Limited Riders will not qualify for the finals unless also shown in the 'Open' portion and qualify. Be aware that a horse can only be entered into one Level (L2 or L3 for the AQHA portion per round.)

**3-year-old Non Pro & 3-year-old Select Non Pro Western Pleasure** - the HORSE may only do one of these classes. The rider, if two horses, is eligible.

**Non Pro Ranch Riding Challenge** - \$20,000 purse. The top 10 horse/rider combinations from that previous day's NSBA Amateur, Select and both Youth NSBA Ranch Riding classes will be invited back. There is no additional entry fee. Will be paid on the following: 1 - \$6,000, 2 - \$3,500, 3 - \$2,750, 4 - \$2,000, 5 - \$1750, 6 - \$1500, 7 - \$1,000, 8 - \$750, 9 - \$500, 10 - \$250. The top Youth Rider will receive a \$1000 bonus. Youth must have shown the qualifying class to be eligible for the bonus.

**Open Ranch Riding Challenge** - \$35,000 purse - The top 15 horse/rider combinations from that day's Junior & Senior NSBA classes will be invited back. There is no additional entry fee. Will be paid the following: 1 - \$10,000, 2 - \$7,000, 3 - \$5,000, 4 - \$4,000, 5 - \$3,000, 6 - \$2,250, 7 - \$1,500, 8 - \$1,000, 9 - \$700, 10 - \$500. The top placing Non Pro will receive a \$1000 bonus. **The Non Pro must have shown the Preliminary class.** There is no limit to the number of horses a rider can show.

**Trail Limited Rider Bonuses** - Unless listed below, the Limited Rider Bonus is \$1000 & automatically entered if limited eligible.

- 3-year-old Open, Limited Rider - 1 - \$2000, 2 - \$1000
- Junior, Limited Rider - 1 - \$2500, 2 - \$1500, 3 - \$1000, 4 - \$500
- Amateur, Limited Rider - \$1500, 2 - \$1000
- Select, Limited Rider - \$1500, 2 - \$1000

**First year Green Trail** - must be eligible for First Year as of August 1.

**AQHA Gate Adds** - if you add at the gate and the class is leveled, you are added into the Level 3. You may not add ANY NSBA class at the gate. It must be done in the office.

**Limited Bonuses**

- If the Limited is concurrent with the 'open' portion, there is no additional entry fee for the Limited, but you must enter the open portion. You will be automatically entered into the concurrent Limited portion once eligibility verified.

## Ties

- In the event of a tie, the monies for the placing involved will be totaled and divided equally among those that are tied.
- In the event of a tie in any final placing, a predetermined tie breaker judge will be used to determine the awarding of ribbons, buckles, trophies, saddles, and other prizes.
- The tie-break judge will rotate in each pairing.

## Categories

- **Limited Rider** – All limited rider status will be determined by NSBA's Rider List as of NSBA as of January 1, 2024.
- **Novice Horse** must not have won \$1,000 or more in the event/discipline\*
- **Limited Horse** must not have won more than \$2,500 the event/discipline\*
- **Maturity Horses** must be Four years old or older.
- **Maturity Limited Horses** must be Four years old or older and not have won more than applicable amount of money for the class in which they are competing
- **There is NO LIMIT to the number of classes a horse/rider can show in based on the above divisions.**

## Color Horse

Any horse that is registered with IBHA, PHBA, PtHA, ABRA, ApHC, APHA, POA. Eligibility of solid bred and/or breeding stock horses follow NSBA rules. Proof of color breed papers will be required for entry.

## Green Horse/L1

Any horse that has not earned more than 25 points in its respective class (i.e., Western Pleasure, Hunter Under Saddle etc.) in any NSBA recognized breed association, or more than \$2,500 in earnings in its respective class as of **January 1, 2024**.

All monies are considered as of **January 1, 2024**, recorded by NSBA, the recognized breed alliance partners, EquiStat and Qdata (formerly Robin Glenn Pedigrees.)

## SUPER SIREs – [www.Supersires.org](http://www.Supersires.org)

- Breeders Purses – exclusive to foals by stallions enrolled in 2020 Super Sires Program.
- Stakes Purses – horses by ANY current or previous Super Sires are eligible.
- Super Sires entries will be able entered with all The Championship entries. August 23, 2024 deadline to apply. \$250/class. Late entries accepted after for an additional \$100/class.
- Payback will be according to NSBA scale, must have 3 entries in each class & win monies will be paid from Super Sires Office after the show. 80% of the entry fee jackpotted.
- The Super Sires classes are NSBA approved.

## Winnings

- All winnings will be paid within 30 days of conclusion of the show.
- All winnings will require a SSN/EIN with entry to be paid.
- All winnings will be paid to the owner at time of entry or leasor if leased.

## VENDORS & SPONSORSHIPS –

- Please download and return forms found at [www.AnEquineProduction.com](http://www.AnEquineProduction.com)

## RV Camping

There are 2 beautiful campgrounds with 278 RV camping sites as well as several restaurants, laundry mat, gas station and convenience store on site. Reserve RV online - **Direct link on An Equine Production's website.**

## Stabling

- The stalls are very spacious, measuring 12×14 and 12×12, and come equipped with matted floors.
- Horse and Tack Stalls are \$400.
- Stalls reserved after August 23, 2024, are \$500.
- Full payment is required to reserve stalls. Credit cards will be deposited upon receipt.
- **All stall reservations must be received together and will be filed under ONE stall agent. Please have ONE person serve as the stalling agent. Stalls not received together, will not be stalled together.**
- Stalling reservations will continue to be accepted as long as stalls are available.
- **Single Night Stalls available – based upon availability and placed in specific barns only. \$100/stall/night. You may only stay for one (1) night. More than one night will require a circuit stall. Stalling Agents – if a customer is coming for one night only, they may or may not be stalled with your circuit block.**
- ALL Horses must have at least a single night stall. No showing off of the trailer.
- If you are stalled in barns **R, S, T, U, V, W, X, Y** – there are no tack ROOMS, only stalls. Be prepared with the appropriate hooks & hanging needs.

## Stall will be assigned based on

- Sponsorship level
- Date received
- Number of stalls reserved

## Cancellations

- Stall(s) canceled by August 23, 2024 will receive a full refund minus processing fee of \$35/stall
- Stall Cancellations made between August 24 & September 3, 2024, will be charged a 25% fee of each stall
- No refund for stall cancellations after September 3, 2024

## Shavings

- Shavings are \$10.00/bag
- Preorders are preferred for your convenience at move in. The online ordering site can be found at [www.WEC.net](http://www.WEC.net) under Feed & Bedding.
- No outside shavings are permitted.
- Any off-site shavings will result in an additional \$25 manure disposal fee per stall.



#### Golf Carts

- Available for rent at the General Store. A link can be found <https://www.wecgolfcarts.com/>

#### Dogs

- Leash Law – Dogs and other pets must be always on a leash while on the show grounds. Fines for dogs found without a leash will result in a \$100 fine. No dog pens are allowed outside of the barns or in shared aisles. No dogs in stalls overnight.

#### Subletting

- Selling stalls is discouraged. The World Equestrian Center has over 3,000 stalls
- Notify Show Management of any stalls that are not needed via email at [AnEquineProduction@gmail.com](mailto:AnEquineProduction@gmail.com)
- Show management may approve refund if vacant stalls are filled by another party

#### Move in

- Stall move in begins on **Monday, September 2, 2024 at 8:00 AM**

#### Departure

- Horses must be removed from the premises by **September 16 at 8:00 am** unless special arrangement has been made with show management.
- Additional costs may be incurred. **Any lavovers, will be moved to Arena 5 stalls**

#### Class Locations

- All arenas are subject to change.

### World Equestrian Center – Ocala Lodging Options:

World Equestrian Center – Ocala offers several on-site lodging options. Make reservations now at The Equestrian Hotel, featuring 248 rooms, restaurants, luxury shopping and resort spa.

Exhibitors may choose to reserve a Home Away from Home rental unit, or reserve an RV space with 278 slots including a General Store, laundry mat, gas station and several restaurants. Reserve RV and Home Away from Home online – **Direct link on An Equine Production’s website.**

#### The Equestrian Hotel

8510 NW 17th Lane, Ocala, FL 34482 | 866.478.9267 | <https://equestrianhotel.com>

#### The Riding Academy Hotel

1615 NW 81st Terrace Rd., Ocala, FL 34482 | 352.325.9935 | <https://ridingacademyhotel.com> Opened spring of 2024, 390 pet-friendly studios and suites available at The Riding Academy Hotel for advanced booking. Pet deposit fee. Direct link on An Equine Production’s website.

#### Home Away from Home

Check-in at 8105 NW 21st Street, Ocala, FL 34482 | 352.414.7900 | Direct link on An Equine Production’s website.

#### RV Park

8105 NW 21st Street, Ocala, FL 34482 | 352.414.7900 | Direct link on An Equine Production’s website.

### Sponsorship Initiative

Returning for The Championship – all sponsorships received, will be put back into random drawings in the various NSBA Money classes for those not in the paybacks.

*We thank you for your support.*



# The Championship Show

September 6-15, 2024

World Equestrian Center – Ocala.

## Sponsorship Opportunities

### **Diamond (\$10,000+)**

Complimentary Golf Cart

Complimentary Restaurant Vouchers (40)

*Only redeemable at Ralphs, Tilly's, Filo's,*

*Viola's and Dots*

Preferred Stalling

Digital Recognition in Arenas

*Solo recognition; 15 second impression*

*90 Second Video*

*Esp Logo File*

*white or transparent background*

Daily Announcements

### **Platinum Sponsor (\$5,000-\$9,999)**

Complimentary Restaurant Vouchers (20)

*Only redeemable at Ralphs, Miss Tilly's, Filo's,*

*Viola's and Dots*

Preferred Stalling

*After Diamond Sponsors*

Digital Recognition in Arenas

*Solo Impression; 15 seconds*

*Esp Logo File*

*white or transparent background*

Daily Announcements

### **Gold Sponsor (\$1,500-\$4,999)**

Preferred Stalling

*After Platinum Sponsors*

Digital Recognition in Arenas

*Solo Impression; 10 seconds*

*Esp Logo File;*

*white or transparent background*

Daily Announcements

### **Silver Sponsor (\$1,500-2,499)**

Preferred Stalling

*After Gold Sponsors*

Digital Recognition in Arenas

*Shared Impression; 15 seconds*

*Esp Logo File; white or transparent background*

Daily Announcements

### **Bronze Sponsor (\$1,000)**

Preferred Stalling

*After Silver Sponsors*

Digital Recognition in Arenas

*Shared Impression; 10 seconds*

*Esp Logo File; white or transparent background*

Daily Announcements

### **Contributor Sponsor (\$500)**

Preferred Stalling

*After All Other Sponsors*

Digital Recognition in Arenas

*Shared Impression; 10 seconds*

*Esp Logo File*

*white or transparent background*

Daily Announcements

**PAYMENT, ANNOUNCEMENTS, AND ALL DIGITAL ASSETS ARE DUE BY AUGUST 23, 2024**

For any questions about sponsorship or to submit your assets please contact:

Karla Campbell

Sponsorship & Advertising Manager

karla.campbell@wec.net

412.326.7325



VIEW OUR DIGITAL MAP

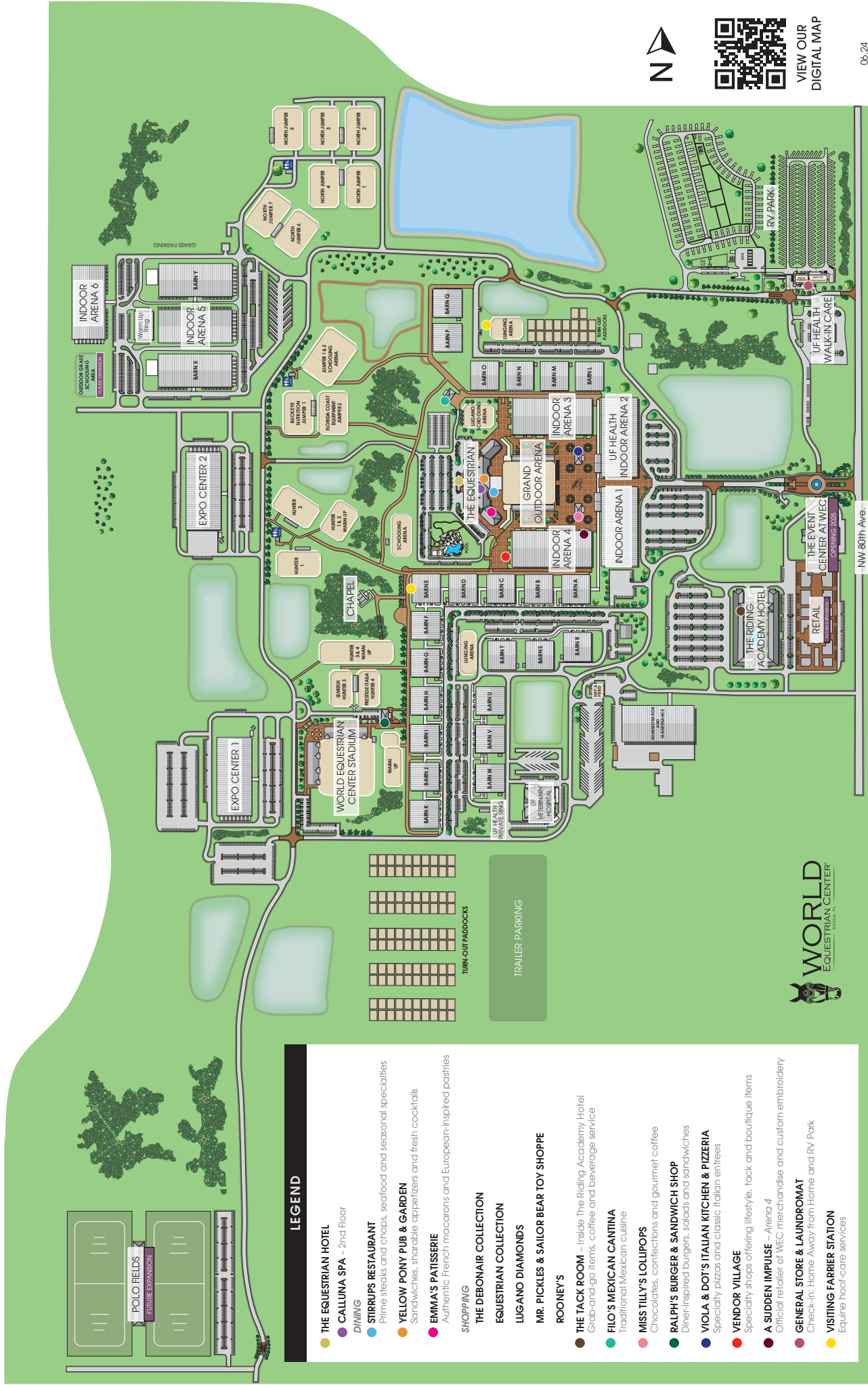

**LEGEND**

- THE EQUESTRIAN HOTEL**
- DINING**
- CALLUNA SPA** - 2nd Floor
- STIRRUPS RESTAURANT** - Prime steaks and chops, seafood and seasonal specialties
- YELLOW PONY PUB & GARDEN** - Sandwiches, sharable appetizers and fresh cocktails
- EMMA'S PATISSERIE** - Authentic French macarons and European-inspired pastries
- SHOPPING**
- THE DEBONAIR COLLECTION**
- EQUESTRIAN COLLECTION**
- LUGANO DIAMONDS**
- MR. PICKLES & SAILOR BEAR TOY SHOPPE**
- ROONEY'S**
- THE TACK ROOM** - Inside The Riding Academy Hotel  
Grab-and-go items, coffee and beverage service
- FILO'S MEXICAN CANTINA** - Traditional Mexican cuisine
- MISS TILLY'S LOLLIPOPS** - Chocolates, confections and gourmet coffee
- RALPH'S BURGER & SANDWICH SHOP** - Diner-inspired burgers, salads and sandwiches
- VIOLA & DOT'S ITALIAN KITCHEN & PIZZERIA** - Specialty pizzas and classic Italian entrees
- VENDOR VILLAGE** - Specialty shops offering lifestyle, tack and boutique items
- A SUDDEN IMPULSE** - Arena 4  
Official retailer of WEC merchandise and custom embroidery
- GENERAL STORE & LAUNDROMAT** - Check-in: Home Away from Home and RV Park
- VISITING FARRIER STATION** - Equine hoof-care services



**WORLD**  
EQUESTRIAN CENTER  
CORP., L.L.C.

NW 80th Ave.

# THANK YOU

## FOR YOUR SUPPORT

### FOUNDING PARTNERS



### PARTNERS



### SPONSORS

