



Celeron Square Apartments

Each Celeron Square Apartments offers

- On-site management
- On-site maintenance
- 24/7 Emergency maintenance
- Celeron Square Site Monitors manage site/parking Thurs-Sun
- Free Parking with Celeron Square Apartments Resident Sticker
- Free Guest Parking with valid Visitor Pass
- Well lit parking areas
- Wall-to-wall carpeting
- Electric range, refrigerator, microwave, dishwasher and garbage disposal
- Electric Heat & Central Air with heat pump system

Tenants are responsible for activation and payment of their own utilities (electricity and internet/cable services).

ONE BEDROOM ~ 576 Square Feet

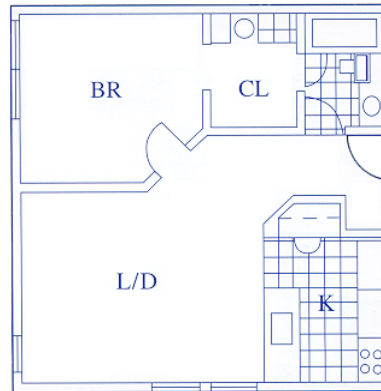

General Information

- Central area coin-op laundry
- Second floor units have cathedral ceilings
- All units are unfurnished
- NO PETS allowed

TWO BEDROOM ~ 675 Square Feet

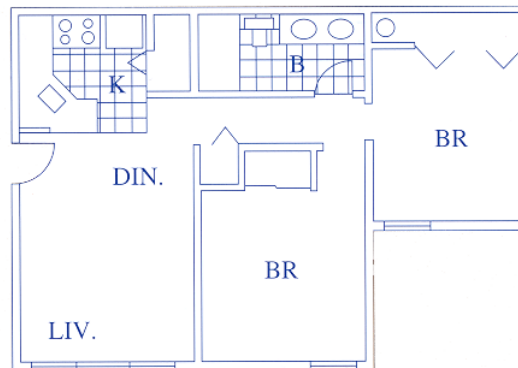

(Drawings are Not to Scale)

TWO BEDROOM LARGE ~ 755 Square Feet

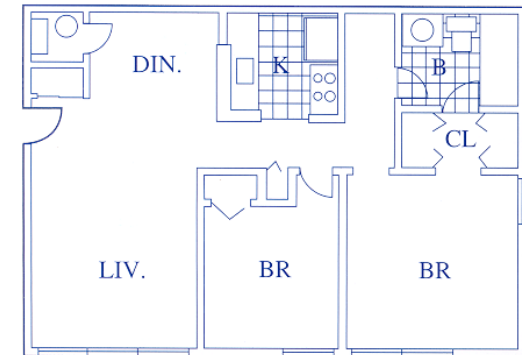

Celeron Square Apartments has direct access to:

- Public Bicycle/Pedestrian Pathway to UConn
- UConn Shuttle Bus Stop at Celeron Square Apartments entrance

THREE BEDROOM ~ 794 Square Feet

