

1439 W. ST PAUL AVE FOR LEASE

- 56,600-square-feet, divisible
- 2.12 acres
- 4 floors + basement
- 12-13' ceilings
- Available for industrial/commercial
- Ample parking - 147 spaces per development plan

PRIME LOCATION

- Located in the heart of Milwaukee in the Menomonee River Valley.
- Next to Third Space Brewing, near BBC Lighting, Bachman Furniture, Sobelman's, Brass Light Gallery, & more!
- Down the street from the Historic Third Ward shopping district
- Great visibility of 163,000 vehicles/day on I-94
- More than \$15M in investments on the street in the last 8 years
- Active Business Association & Business Improvement District
- With American Family Field, Potawatomi Casino Hotel, and the Harley-Davidson Museum® as neighbors, the amenities are unparalleled.

"St Paul Avenue is a great place for business! Our showroom is so full on the weekend that you can hardly walk around."
— Hank Albert of BBC Lighting



DESIGN DISTRICT
St. Paul Avenue

- Antiques
- Art Services
- Cabinetry
- Flooring
- Furniture
- Lighting
- Stone
- And More!

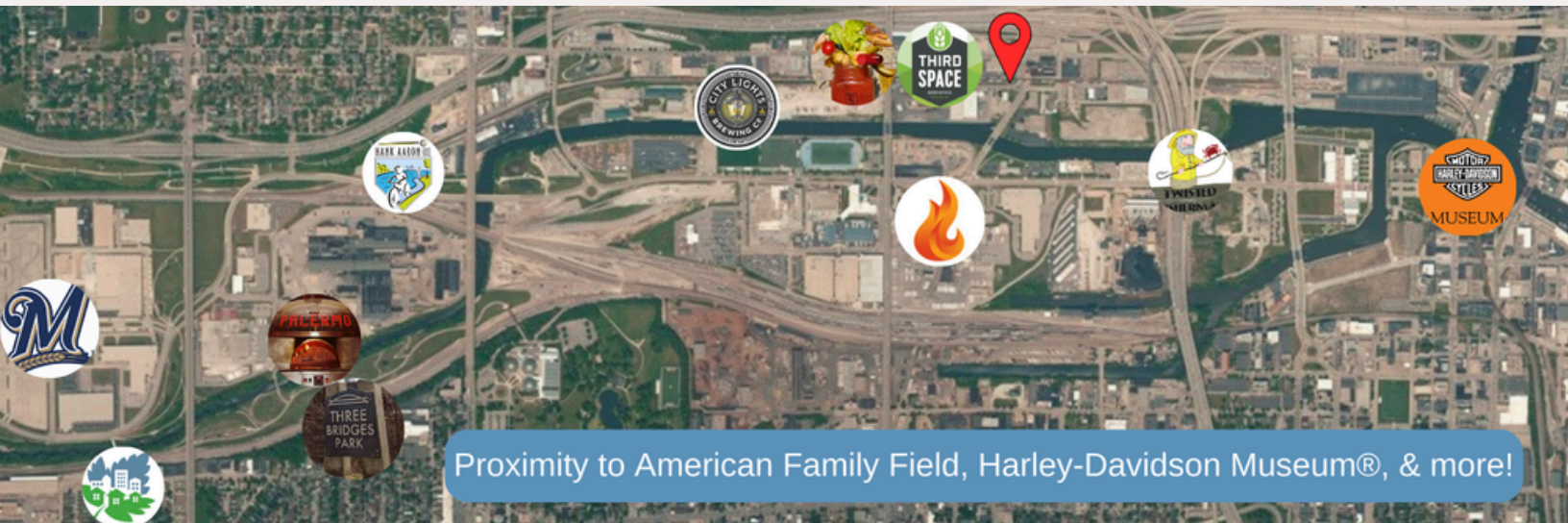

Proximity to American Family Field, Harley-Davidson Museum®, & more!

CONTACT US FOR MORE INFORMATION:

Corey Zetts

Corey@TheValleyMKE.org | 414.467.0854



TheValleyMKE.org



MENOMONEE VALLEY
PARTNERS



ABOUT THE PROPERTY

- 56,600-square-feet
- 2.12 acres
- 4 floors + basement
- 12-13' ceilings
- Available for office/commercial
- Ample parking - 147 spaces per development plan

Visit Broker Listing

[CLICK HERE](#)



FINANCING OPPORTUNITIES

[CLICK HERE](#)

- Pre-Approved for State & Historic Federal Tax Credits - [See Building History](#).
- New Market Tax Credits
- Green Infrastructure Grants
- PACE Financing
- Exterior Enhancement Grant provided by Menomonee Valley Partners & the City of Milwaukee
- And more!

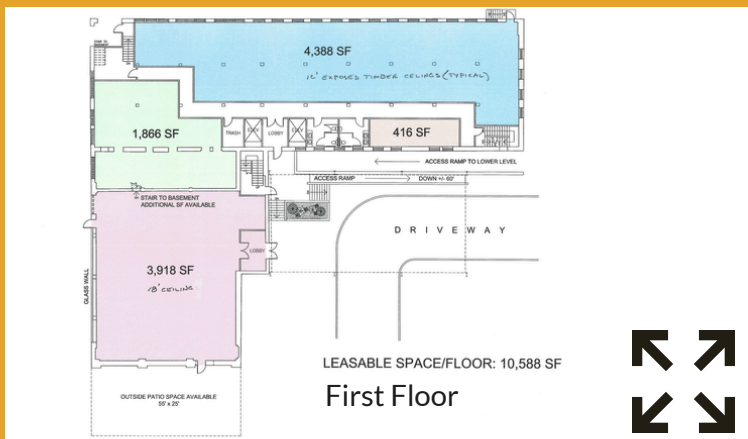

[CLICK HERE](#)

SUPPORT

Menomonee Valley Partners is here to support you on your journey to join the Valley community. With 25 years of redevelopment experience in the Valley, we are here to connect you to information, current business owners, financing opportunities, technical expertise, and more.

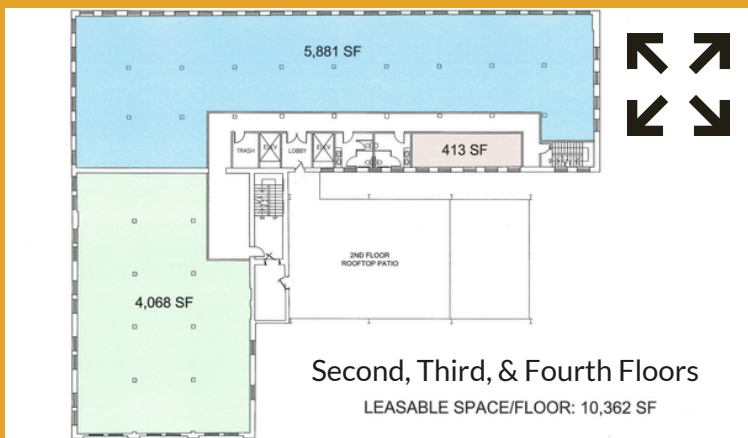

The Valley is a special place and any experience we've had with other businesses has always come with a cool sense of camaraderie you don't necessarily always get elsewhere. We always jump on any chance to support or collaborate with other Valley businesses.

— Jimmy Gohsman, City Lights Owner, Founder, and Brewmaster

CONTACT US FOR MORE INFORMATION:

Corey Zetts
Corey@TheValleyMKE.org | 414.467.0854

TheValleyMKE.org

